

NDCRS ARCHITECTURAL SITE FORM PAGE 1

SITS# 32 BA 321

SITE IDENTIFICATION

Field Code Bower School Site Name _____
Map Quad Clements ville Site Name _____

Map Quad _____
Map Quad _____

LTL	TWP	<u>142</u>	R	<u>61</u>	SEC	<u>33</u>	QQQ	<u>6</u>	QQ	<u>5</u>	Q	<u>6</u>
LTL	TWP	_____	R	_____	SEC	_____	QQQ	_____	QQ	_____	Q	_____
LTL	TWP	_____	R	_____	SEC	_____	QQQ	_____	QQ	_____	Q	_____
LTL	TWP	_____	R	_____	SEC	_____	QQQ	_____	QQ	_____	Q	_____

UTM _____ 5213318 _____ N ZONE 14N
UTM _____ 545077 _____ E NAD 1927 _____ NAD 1983

Subsection:
1 = N $\frac{1}{2}$
2 = E $\frac{1}{2}$
3 = S $\frac{1}{2}$
4 = W $\frac{1}{2}$
5 = NE $\frac{1}{4}$
6 = SE $\frac{1}{4}$
7 = SW $\frac{1}{4}$
8 = NW $\frac{1}{4}$

City: Wimbledon
Street Number: _____
Street Name: 99th Ave SE
Urban Legal Description: _____

SITE DATA

Total # **Architectural** Features: 1
Fieldwork Date: 5/17/2016
Reconnaissance Survey Intensive Survey _____
Project Title & Supervisor:
Country Schoolhouse Project
Report Title & Author(s):

Additional Information: _____

SHSND USE	<u>2</u>	Ecozone	<u>18</u>	Verified Site	<u>1</u>	CR Type	<u>2</u>
Area of Significance	_____	Ecozone	_____	Non-Site	_____		
Area of Significance	_____						

Recorded By Kathy Wilner Date Recorded 1/15/2017
(First Name & Last Name) (mm/dd/year)

Instructions to complete a digital version of this form: (1) Download a copy to your hard drive; (2) Open the saved blank copy; (3) Fill out the form; (4) Use the Save As command to rename the form appropriately and save; (5) Print and submit to SHSND.

**NDCRS ARCHITECTURAL SITE FORM
PAGE 2—Feature Data**

Field Code Bower School

SITS# 32 BA

Complete one Page 2 for each architectural feature at the site.

Architectural Feature # 1

Construction Date _____

Feature Type 9

Condition 6

Feature Date 2

Context 7

Plan Shape 5

Structural System 25

Primary Exterior 26

Style Other Style

Original Owner's Ethnicity _____

Secondary Exterior _____

Architect/Builder _____

Other Information:

Foundation Concrete Stories 1

Roof/Cornice Hip

Window Double hung, various sizes

Dating Method(s): Estimate

Feature Preservation Recommendation(s) (Check all that apply):

Individual nomination

Contributes to a potential district

No nomination potential

Will not contribute to a district

Potential district—feature would be a contributing element if other properties constitute a district

Thematic nomination potential

Component of a historic site or landscape

Moved (specify all applicable choices)—a) relocation occurred within a historic period; b) recreates original site, orientation, landscape, & spatial relationships; c) compatible in context with neighboring structures; d) relocation has damaged eligibility

Historical associations require further investigation

Recorded By Kathy Wilner
(First Name & Last Name)

Date Recorded 1/15/2017
(mm/dd/year)

Instructions to complete a digital version of this form: (1) Download a copy to your hard drive; (2) Open the saved blank copy; (3) Fill out the form; (4) Use the Save As command to rename the form appropriately and save; (5) Print and submit to SHSND.

**NDCRS ARCHITECTURAL SITE FORM
PAGE 3—Feature Data**Field Code Bower SchoolSITS# 32 BA**Complete a Page 3 for each feature.****1. Feature Description, Integrity, Eligibility:**

The feature is a large one room prairie school sitting on a concrete foundation. This building was moved to this location for use as a dwelling. The hip roof of the main building has asphalt shingle and a red brick chimney near the east end on the north facing slope. There is a half hip roof on the porch, also covered with asphalt shingles. There is an addition on the north side of the school, also covered with asphalt shingles, and there are bedrooms located here. The soffits are closed with beadboard. The main building measures 40 feet west to east and 20 feet north to south. The addition measures 8 feet north to south and 32 feet east to west. The open porch measures 8 1/2 feet north to south by 5 feet east to west. There is a vent pipe from the bathroom.

A wide trim board under all four sides of the hip roof begin the wall covering on the main part of the school. The remainder is 6 inch wood lap with metal corner capping. The addition has vertical wood siding. The addition has one window and door facing north, both newer as well as one small window on the west wall. The east wall of the school has two large, 4 pane, 2 over 2 windows with a new, solid core door at the entry. On the west side there are two more large 4 pane, 2 over 2 windows. On the south wall there is one small, double hung window near the east end and a bank of 5 large multipane, double hung windows. All glass is intact. Also on the south wall are electrical cords and meter, with a entry light at the porch and more light inside to show electricity is present. The porch is on a concrete pad and there are four posts holding the roof up. The interior walls are lathe and plaster in the main body of the school with rail trim and a wide, trim board at the bottom. The ceiling is lather and plaster as well. The floor is tongue and groove hardwood. There is a blackboard in the school, on the north wall. It is broken up by two doors leading into the addition. The addition is finished with sheetrock. The fuel for this building today is a wood stove.

Recorded By Kathy Wilner Date Recorded 1/15/2017
(First Name & Last Name) (mm/dd/year)

Instructions to complete a digital version of this form: (1) Download a copy to your hard drive; (2) Open the saved blank copy; (3) Fill out the form; (4) Use the Save As command to rename the form appropriately and save; (5) *Print* and submit to SHSND.

**NDCRS ARCHITECTURAL SITE FORM
PAGE 4—SITE DESCRIPTION**Field Code Bower SchoolSITS# 32 BA**Complete one Page 4 for the entire site.**

2. Owner's Contact Information:

Linda & Dick Grotberg
2333 99th Ave SE
Wimbledon ND 58492

3. Access (to rural areas):

From Wimbledon, follow Highway 9 south about 4 miles and curve to the east and go two more miles to 99th Ave SE. Turn right onto 99th Ave SE and drive about 1 1/2 miles south to a large farm on the right. The second driveway into the farm will take you right to the school building.

4. Site Area (ft²): _____5. Description of **SETTING**:

The school sits on a farm site/Little Village with a church to the northwest (also moved in) and a house to the northeast. Tree all around the farm site.

Recorded By Kathy Wilner Date Recorded 1/15/2017
(First Name & Last Name) (mm/dd/year)

Instructions to complete a digital version of this form: (1) Download a copy to your hard drive; (2) Open the saved blank copy; (3) Fill out the form; (4) Use the Save As command to rename the form appropriately and save; (5) *Print* and submit to SHSND.

**NDCRS ARCHITECTURAL SITE FORM
PAGE 5—SITE DESCRIPTION**

Field Code Bower School

SITS# 32 BA

6. Summary of ALL Site Features & Evaluation of Significance:

7. References/Comments:

Kathy Wilner
366 43rd Ave SE
Bowdon ND 58418

Recorded By Kathy Wilner Date Recorded 1/15/2017
(First Name & Last Name) (mm/dd/year)

Instructions to complete a digital version of this form: (1) Download a copy to your hard drive; (2) Open the saved blank copy; (3) Fill out the form; (4) Use the Save As command to rename the form appropriately and save; (5) *Print* and submit to SHSND.



East Side

Bower School

5/17/2016

Kathy Wilner

BA

South Side





West Side

Bower School

5/17/2016

Kathy Wilner

BA

North Side



bing maps

Notes

Bower School

5/17/2016

Kathy Wilner

BA

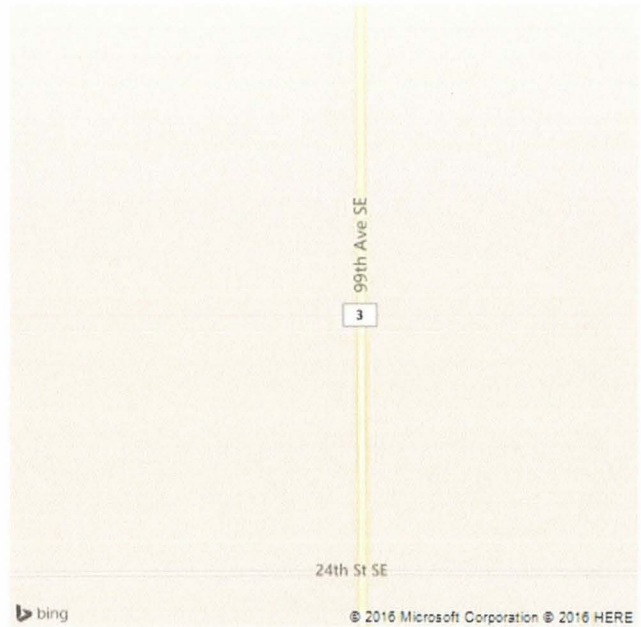

Feature