

NDCRS ARCHITECTURAL SITE FORM PAGE 1

SITS# 32 BA 323

SITE IDENTIFICATION

Field Code Svea Township School Site Name _____

Map Quad Eckelson SE Site Name _____

Map Quad _____

LTL	TWP	<u>138</u>	R	<u>60</u>	SEC	<u>16</u>	QQQ	<u>6</u>	QQ	<u>6</u>	Q	<u>6</u>
LTL	TWP	_____	R	_____	SEC	_____	QQQ	_____	QQ	_____	Q	_____
LTL	TWP	_____	R	_____	SEC	_____	QQQ	_____	QQ	_____	Q	_____
LTL	TWP	_____	R	_____	SEC	_____	QQQ	_____	QQ	_____	Q	_____

UTM _____ N ZONE _____
 UTM _____ E NAD 1927 _____ NAD 1983 _____

Subsection:
1 = N $\frac{1}{2}$
2 = E $\frac{1}{2}$
3 = S $\frac{1}{2}$
4 = W $\frac{1}{2}$
5 = NE $\frac{1}{4}$
6 = SE $\frac{1}{4}$
7 = SW $\frac{1}{4}$
8 = NW $\frac{1}{4}$

City: _____

Street Number: _____

Street Name: 150th Ave SE

Urban Legal Description: _____

SITE DATA

Total # **Architectural** Features: 1

Fieldwork Date: 5/6/2016

Reconnaissance Survey Intensive Survey

Project Title & Supervisor:
Country Schoolhouse Project

Report Title & Author(s):

Additional Information: _____

SHSND USE

Area of Significance <u>2</u>	Ecozone <u>18</u>	Verified Site <u>1</u>	CR Type <u>2</u>
Area of Significance _____	Ecozone _____	Non-Site _____	
Area of Significance _____			

Recorded By Kathy Wilner Date Recorded 1/15/2017
(First Name & Last Name) (mm/dd/year)

Instructions to complete a digital version of this form: (1) Download a copy to your hard drive; (2) Open the saved blank copy; (3) Fill out the form; (4) Use the Save As command to rename the form appropriately and save; (5) Print and submit to SHSND.

NDCRS ARCHITECTURAL SITE FORM PAGE 2—Feature Data

Field Code Svea Township School

SITS# 32 BA

Complete one Page 2 for each architectural feature at the site.

Architectural Feature # 1

Construction Date _____

Feature Type 9

Condition 6

Feature Date 4

Context 7

Plan Shape 6

Structural System 25

Primary Exterior 26

Style Hipped Roof Box

Original Owner's Ethnicity _____

Secondary Exterior _____

Architect/Builder _____

Other Information:

Foundation Concrete Stories 1

Roof/Cornice Hip

Window Double hung, different sizes, glass intact

Dating Method(s): Estimate

Feature Preservation Recommendation(s) (Check all that apply):

- Individual nomination
- Contributes to a potential district
- No nomination potential
- Will not contribute to a district
- Potential district—feature would be a contributing element if other properties constitute a district
- Thematic nomination potential
- Component of a historic site or landscape
- Moved (specify all applicable choices)—a) relocation occurred within a historic period; b) recreates original site, orientation, landscape, & spatial relationships; c) compatible in context with neighboring structures; d) relocation has damaged eligibility
- Historical associations require further investigation

Recorded By Kathy Wilner Date Recorded 1/15/2017
(First Name & Last Name) (mm/dd/year)

Instructions to complete a digital version of this form: (1) Download a copy to your hard drive; (2) Open the saved blank copy; (3) Fill out the form; (4) Use the Save As command to rename the form appropriately and save; (5) Print and submit to SHSND.

**NDCRS ARCHITECTURAL SITE FORM
PAGE 3—Feature Data**Field Code Svea Township SchoolSITS# 32 BA**Complete a Page 3 for each feature.****1. Feature Description, Integrity, Eligibility:**

The feature is a one room prairie school sitting on a concrete foundation. The hip roof is covered with asphalt shingles and soffits are closed with beadboard. The concrete block chimney has fallen off the roof and lies in the yard. The building measures 28 1/2 feet north to south and 28 1/2 feet east to west.

The siding begins under the soffits with a wide trim board. The remainder of the siding is 6 inch wood lap with 6 inch corner trim and as a finish at the bottom of the walls there is a skirting board with water table. There are two nonconforming double hung windows on the east wall with visible seams where siding filled in other openings, perhaps larger windows. On the south side there is one nonconforming double hung window. On the west side there are two double hung windows that might be original to the school, also on the wall is a 5 panel wood door for entry into the school. Above the door there is an outside light fixture suggesting the presence of electricity. The north wall had three areas that were filled in and may have been windows. Entering the school from a concrete apron there is a small entry with a second 5 panel wood door giving access to the main room of the school. Inside the school the walls are a mixture of lathe and plaster and sheet rock. The sheet rock was used in the areas where windows were closed in. There is picture molding about 2 feet down from the ceiling. At the bottom of the walls there is a wide decorative trim board. Decorative moldings can be see above the interior doors. There are two small room on the west side of the school, used for a fuel oil barrel and storage. The floor is tongue and groove hardwood and the ceiling is wallboard. There is blackboard on the south wall. No wainscot.

Recorded By Kathy Wilner Date Recorded 1/15/2017
(First Name & Last Name) (mm/dd/year)

Instructions to complete a digital version of this form: (1) Download a copy to your hard drive; (2) Open the saved blank copy; (3) Fill out the form; (4) Use the Save As command to rename the form appropriately and save; (5) Print and submit to SHSND.

**NDCRS ARCHITECTURAL SITE FORM
PAGE 4—SITE DESCRIPTION**

Field Code Svea Township School

SITS# 32 BA

Complete one Page 4 for the entire site.

2. Owner's Contact Information:

Sidney Peterson
10421 45th St SE
Litchville ND 58461

3. Access (to rural areas):

South of I94 at Exit 281, on 106th Ave SE, drive 10 miles to 45th St SE, turn left (west) and drive one mile to see the school at the northwest corner of the intersection.

4. Site Area (ft²): _____

5. Description of **SETTING**:

Farm site southwest, farm fields east and north and trees to the west.

Recorded By Kathy Wilner Date Recorded 1/15/2017
(First Name & Last Name) (mm/dd/year)

Instructions to complete a digital version of this form: (1) Download a copy to your hard drive; (2) Open the saved blank copy; (3) Fill out the form; (4) Use the Save As command to rename the form appropriately and save; (5) Print and submit to SHSND.

**NDCRS ARCHITECTURAL SITE FORM
PAGE 5—SITE DESCRIPTION**

Field Code Svea Township School

SITS# 32 BA

6. Summary of ALL Site Features & Evaluation of Significance:

7. References/Comments:

Kathy Wilner
366 43rd Ave SE
Bowdon ND 58418

Recorded By Kathy Wilner Date Recorded 1/15/2017
(First Name & Last Name) (mm/dd/year)

Instructions to complete a digital version of this form: (1) Download a copy to your hard drive; (2) Open the saved blank copy; (3) Fill out the form; (4) Use the Save As command to rename the form appropriately and save; (5) Print and submit to SHSND.



East Side

Svea Township School

5/6/2016

Kathy Wilner

BA

North Side





West Side

Svea Township School

5/6/2016

Kathy Wilner

BA

South Side



bing maps

Notes

Svea Township School

5/6/2016

Kathy Wilner

BA

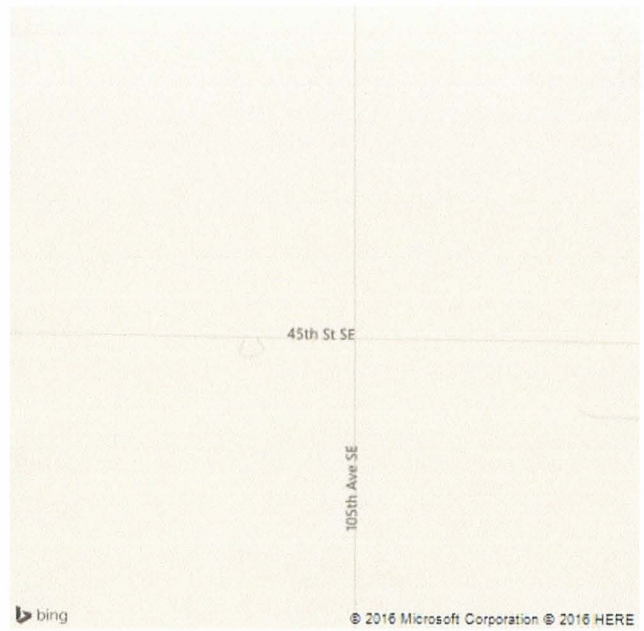

Feature