

NDCRS ARCHITECTURAL SITE FORM
PAGE 1

SITS# 32 BA 324

SITE IDENTIFICATION

Field Code Hemen Township School

Site Name Hemen Township School

Map Quad Moon Lake

LTL TWP 139 R 60 SEC 15 QQQ 6 QQ 5 Q 6
LTL TWP R SEC QQQ QQ Q
LTL TWP R SEC QQQ QQ Q
LTL TWP R SEC QQQ QQ Q

UTM N ZONE
UTM E NAD 1927 NAD 1983

Subsection:
1 = N 1/2
2 = E 1/2
3 = S 1/2
4 = W 1/2
5 = NE 1/4
6 = SE 1/4
7 = SW 1/4
8 = NW 1/4

City:

Street Number:

Street Name: 106th Ave SE

Urban Legal Description:

SITE DATA

Total # Architectural Features: 1

Fieldwork Date: 5/6/2016

Reconnaissance Survey [checked] Intensive Survey

Project Title & Supervisor:
Country Schoolhouse Project

Report Title & Author(s):

Additional Information:

SHSND USE
Area of Significance 2 Ecozone 18 Verified Site 1 CR Type 2
Area of Significance Non-Site
Area of Significance

Recorded By Kathy Wilner Date Recorded 1/15/2017
(First Name & Last Name) (mm/dd/year)

Instructions to complete a digital version of this form: (1) Download a copy to your hard drive; (2) Open the saved blank copy; (3) Fill out the form; (4) Use the Save As command to rename the form appropriately and save; (5) Print and submit to SHSND.

NDCRS ARCHITECTURAL SITE FORM
PAGE 2—Feature Data

Field Code Hemen Township School

SITS# 32 BA

Complete one Page 2 for each architectural feature at the site.

Architectural Feature # 1

Construction Date 1895

Feature Type 9

Condition 5

Feature Date 2

Context 7

Plan Shape 5

Structural System 24 25

Primary Exterior 26

Style Other Style

Original Owner's Ethnicity

Secondary Exterior

Architect/Builder

Other Information:

Foundation Concrete Stories 1

Roof/Cornice Gable

Window Double hung, some filled in, some broken glass

Dating Method(s): Sign on the building

Feature Preservation Recommendation(s) (Check all that apply):

- Individual nomination
Contributes to a potential district
No nomination potential
Will not contribute to a district
Potential district—feature would be a contributing element if other properties constitute a district
Thematic nomination potential
Component of a historic site or landscape
Moved (specify all applicable choices)—a) relocation occurred within a historic period; b) recreates original site, orientation, landscape, & spatial relationships; c) compatible in context with neighboring structures; d) relocation has damaged eligibility
Historical associations require further investigation

Recorded By Kathy Wilner Date Recorded 1/15/2017
(First Name & Last Name) (mm/dd/year)

Instructions to complete a digital version of this form: (1) Download a copy to your hard drive; (2) Open the saved blank copy; (3) Fill out the form; (4) Use the Save As command to rename the form appropriately and save; (5) Print and submit to SHSND.

**NDCRS ARCHITECTURAL SITE FORM**  
**PAGE 3—Feature Data**Field Code Hemen Township SchoolSITS# 32 BA**Complete a Page 3 for each feature.****1. Feature Description, Integrity, Eligibility:**

The feature is a one room prairie school sitting on a concrete foundation. The gable roof of this school is covered with wood shakes and the peak is finishes with metal capping with finials. Many of the wood shakes are missing. there is a red brick chimney located at the west end of the school at the peak of the roof. The half hip roof of the entry is also covered with wood shakes with metal capping and a finial at the east end. The building measures 28 feet east to west and 18 feet north to south. The entry measures 8 feet by 8 feet.

The walls of the school begin with a wide trim board under the peak ends of the roof. The remainder of the siding is 6 inch wood lap with 4 inch corner trim again with a skirting board and water table to complete the bottom of the siding. Originally there were 6 dindows on both the north and south sides. The middle window on the south side was boarded up with siding and the left and right windows on the north side were filled in as well. The remaining windows appear to be original windows, double hung with some glass. There is one small, fixed pane window in the entry. The entry door to the school is a broken 5 panel wood door. There is a small concrete pad just approaching the door. The small entry allows access to the school room through a newer wood door. The walls ceiling in the school are lathe and plaster with some of the plaster falling away from the ceiling. The floor is tongue and groove hardwood. There is a small black board on the west wall of the school room and there is also a fuel oil stove at that end of the room. There is a fuel oil barrel outside the west end of the school and there is also one outhouse to the northwest of the school. An electric meter and conduit suggests the presence of electricity.

Recorded By Kathy Wilner Date Recorded 1/15/2017  
(First Name & Last Name) (mm/dd/year)

*Instructions to complete a digital version of this form: (1) Download a copy to your hard drive; (2) Open the saved blank copy; (3) Fill out the form; (4) Use the Save As command to rename the form appropriately and save; (5) Print and submit to SHSND.*

**NDCRS ARCHITECTURAL SITE FORM  
PAGE 4—SITE DESCRIPTION**

Field Code Hemen Township School

SITS# 32 BA

**Complete one Page 4 for the entire site.**

2. Owner's Contact Information:

Keith McCleary  
4421 101th Ave SE  
Marion ND 58466

3. Access (to rural areas):

South of I 94 at Exit 281 drive south on 106th Ave SE 5 1/2 miles to see the school on your left.

4. Site Area (ft<sup>2</sup>): \_\_\_\_\_

5. Description of **SETTING**:

There is a large slough to the west, farmland to the east and south and a farmstead to the north.

Recorded By Kathy Wilner Date Recorded 1/15/2017  
(First Name & Last Name) (mm/dd/year)

*Instructions to complete a digital version of this form:* (1) Download a copy to your hard drive; (2) Open the saved blank copy; (3) Fill out the form; (4) Use the Save As command to rename the form appropriately and save; (5) *Print* and submit to SHSND.

**NDCRS ARCHITECTURAL SITE FORM  
PAGE 5—SITE DESCRIPTION**

Field Code Hemen Township School

SITS# 32 BA

**6. Summary of ALL Site Features & Evaluation of Significance:**

7. References/Comments:

Kathy Wilner  
366 43rd Ave SE  
Bowdon ND 58418

Recorded By Kathy Wilner Date Recorded 1/15/2017  
(First Name & Last Name) (mm/dd/year)

*Instructions to complete a digital version of this form:* (1) Download a copy to your hard drive; (2) Open the saved blank copy; (3) Fill out the form; (4) Use the Save As command to rename the form appropriately and save; (5) *Print* and submit to SHSND.





East Side

Hemen Township School

5/6/2016

Kathy Wilner

BA

North Side







South Side

Hemen Township School

5/6/2016

Kathy Wilner

BA

West Side





bing maps

Notes

Hemen Township School

5/6/2016

Kathy Wilner

BA

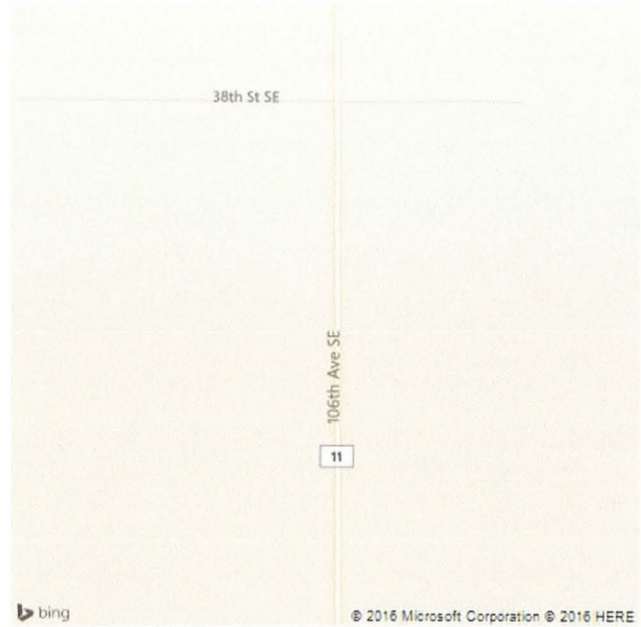

Feature