

NDCRS ARCHITECTURAL SITE FORM PAGE 1

SITS# 32 BA 329

SITE IDENTIFICATION

Field Code Ellis-Nelson School Site Name _____

Map Quad Fingal SW Site Name _____

Map Quad _____

| | | | | | | | | | | | | |
|-----|-----|------------|---|-----------|-----|-----------|-----|----------|----|----------|---|----------|
| LTL | TWP | <u>139</u> | R | <u>58</u> | SEC | <u>10</u> | QQQ | <u>8</u> | QQ | <u>6</u> | Q | <u>8</u> |
| LTL | TWP | _____ | R | _____ | SEC | _____ | QQQ | _____ | QQ | _____ | Q | _____ |
| LTL | TWP | _____ | R | _____ | SEC | _____ | QQQ | _____ | QQ | _____ | Q | _____ |
| LTL | TWP | _____ | R | _____ | SEC | _____ | QQQ | _____ | QQ | _____ | Q | _____ |

UTM _____ 5191562 _____ N ZONE 14N
 UTM _____ 576909 _____ E NAD 1927 _____ NAD 1983

Subsection:
 1 = N $\frac{1}{2}$
 2 = E $\frac{1}{2}$
 3 = S $\frac{1}{2}$
 4 = W $\frac{1}{2}$
 5 = NE $\frac{1}{4}$
 6 = SE $\frac{1}{4}$
 7 = SW $\frac{1}{4}$
 8 = NW $\frac{1}{4}$

City: Valley City

Street Number: _____

Street Name: 118th Ave SE

Urban Legal Description: _____

SITE DATA

Total # **Architectural** Features: 1

Fieldwork Date: 5/6/2016

Reconnaissance Survey Intensive Survey

Project Title & Supervisor:
Country Schoolhouse Project

Report Title & Author(s): _____

Additional Information: _____

SHSND USE

| | | | |
|-------------------------------|-------------------|------------------------|------------------|
| Area of Significance <u>2</u> | Ecozone <u>15</u> | Verified Site <u>1</u> | CR Type <u>2</u> |
| Area of Significance _____ | Ecozone _____ | Non-Site _____ | |
| Area of Significance _____ | | | |

Recorded By Kathy Wilner Date Recorded 1/15/2017
 (First Name & Last Name) (mm/dd/year)

Instructions to complete a digital version of this form: (1) Download a copy to your hard drive; (2) Open the saved blank copy; (3) Fill out the form; (4) Use the Save As command to rename the form appropriately and save; (5) Print and submit to SHSND.

NDCRS ARCHITECTURAL SITE FORM PAGE 2—Feature Data

Field Code Ellis-Nelson School

SITS# 32 BA

Complete one Page 2 for each architectural feature at the site.

Architectural Feature # 1

Construction Date _____

Feature Type 9

Condition 7

Feature Date 3

Context 7

Plan Shape 5

Structural System 25

Primary Exterior 26

Style Other Style

Original Owner's Ethnicity _____

Secondary Exterior _____

Architect/Builder _____

Other Information:

Foundation Poured concrete Stories 1

Roof/Cornice Hip

Window Multi pane double hung

Dating Method(s): estimate

Feature Preservation Recommendation(s) (Check all that apply):

- Individual nomination
- Contributes to a potential district
- No nomination potential
- Will not contribute to a district
- Potential district—feature would be a contributing element if other properties constitute a district
- Thematic nomination potential
- Component of a historic site or landscape
- Moved (specify all applicable choices)—a) relocation occurred within a historic period; b) recreates original site, orientation, landscape, & spatial relationships; c) compatible in context with neighboring structures; d) relocation has damaged eligibility
- Historical associations require further investigation

Recorded By Kathy Wilner Date Recorded 1/15/2017
(First Name & Last Name) (mm/dd/year)

Instructions to complete a digital version of this form: (1) Download a copy to your hard drive; (2) Open the saved blank copy; (3) Fill out the form; (4) Use the Save As command to rename the form appropriately and save; (5) Print and submit to SHSND.

**NDCRS ARCHITECTURAL SITE FORM
PAGE 3—Feature Data**Field Code Ellis-Nelson SchoolSITS# 32 BA**Complete a Page 3 for each feature.****1. Feature Description, Integrity, Eligibility:**

The feature is a one room prairie school sitting on a poured concrete foundation. Painted plywood covers that foundation. This school was built in 1937 as a replacement for the original school. It was named Ellis school in honor of Benjamin Ellis, Civil War Veteran and pioneer homesteader. In 1951 the Ellis school merged with Nelson School District and became known at the Ellis-Nelson school.

The hip roof of the school is covered with asphalt shingles and all soffits are closed with beadboard. There is a red brick, chimney on the south slope of the roof of the school. There is also a vent pipe near the chimney for the bathroom. The building measures 36 feet east to west and 20 feet north to south with an entry that measures 5 feet east to west by 8 feet north to south.

There is a wide trim board just under the soffits on all four sides of the school with the remainder of the wall covered with 6 inch wood lap. The corner trim is metal corner caps. There is a bank of 5 large, multipane double hung windows on the north wall with a much smaller, multipane window to the west of the large ones. Two smaller, multipane double hung windows are either side of the entry on the north wall and one more multipane window on the south side. The glass is all intact. There is a large wood porch on the west side of the building that wraps around to the south and is ramped for handicapped access. Wood railings complete the porch. There is a small entry porch with multipane windows on the north and south walls and an arched opening giving access to the 3 panel wood door with a 4 pane window at the top 1/3. The interior of the entry porch is beadboard. Entering the school you find a new furnace located to your left. The walls in the entry are lathe and plaster with stained and varnished plywood creating the wainscot. Inside the main school room, which has been modified to allow a bedroom in the southeast corner. The walls in this room are also a mix of lathe and plaster and stained and varnished plywood used as wainscot as well as rimming the room near the ceiling and/or totally finishing most of one wall. The ceiling is wallboard and there are light fixtures in all rooms. In the southwest corner they have created a bathroom with modern plumbing. There is a blackboard on the east wall, half in the main room and the other half in the bedroom.

Recorded By Kathy Wilner Date Recorded 1/15/2017
(First Name & Last Name) (mm/dd/year)

Instructions to complete a digital version of this form: (1) Download a copy to your hard drive; (2) Open the saved blank copy; (3) Fill out the form; (4) Use the Save As command to rename the form appropriately and save; (5) *Print* and submit to SHSND.

**NDCRS ARCHITECTURAL SITE FORM
PAGE 4—SITE DESCRIPTION**Field Code Ellis-Nelson SchoolSITS# 32 BA**Complete one Page 4 for the entire site.**

2. Owner's Contact Information:

Bob Tieth
3716 117th Ave SE
Valley City ND 58072

3. Access (to rural areas):

The school is located south of Interstate 94 on 118th Ave SE 2 miles. The school is off the east side of the road and down near the river.

4. Site Area (ft²): _____5. Description of **SETTING**:

Sheyenne Riverbend Farm, the river is in the backyard of the school, there is a church to the northeast and other building further north. There are trees around the school.

Recorded By Kathy Wilner Date Recorded 1/15/2017
(First Name & Last Name) (mm/dd/year)

Instructions to complete a digital version of this form: (1) Download a copy to your hard drive; (2) Open the saved blank copy; (3) Fill out the form; (4) Use the Save As command to rename the form appropriately and save; (5) *Print* and submit to SHSND.

**NDCRS ARCHITECTURAL SITE FORM
PAGE 5—SITE DESCRIPTION**

Field Code Ellis-Nelson School

SITS# 32 BA

6. Summary of ALL Site Features & Evaluation of Significance:

7. References/Comments:

Kathy Wilner
366 43rd Ave SE
Bowdon ND 58418

Recorded By Kathy Wilner Date Recorded 1/15/2017
(First Name & Last Name) (mm/dd/year)

Instructions to complete a digital version of this form: (1) Download a copy to your hard drive; (2) Open the saved blank copy; (3) Fill out the form; (4) Use the Save As command to rename the form appropriately and save; (5) *Print* and submit to SHSND.



West Side

Ellis-Nelson School

5/6/2016

Kathy Wilner

BA

South Side



bing maps

Notes

Ellis-Nelson School

5/6/2016

Kathy Wilner

BA

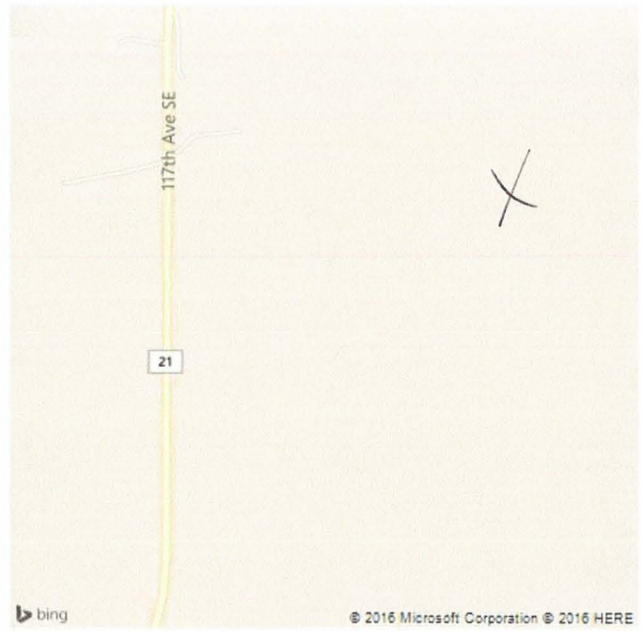

Feature