

NDCRS ARCHITECTURAL SITE FORM PAGE 1

UPDATE

SITS# 32 BA 750

SITE IDENTIFICATION

Field Code Heimes School #2

Site Name Heimes No. 10

Site Name _____

Map Quad _____

Map Quad _____

LTL	TWP	140	R	58	SEC	21	QQQ	____	QQ	____	Q	____
LTL	TWP	____	R	____	SEC	____	QQQ	____	QQ	____	Q	____
LTL	TWP	____	R	____	SEC	____	QQQ	____	QQ	____	Q	____
LTL	TWP	____	R	____	SEC	____	QQQ	____	QQ	____	Q	____

UTM _____ N
UTM _____ E

ZONE _____
NAD 1927 _____ NAD 1983 _____

Subsection:
1 = N $\frac{1}{2}$
2 = E $\frac{1}{2}$
3 = S $\frac{1}{2}$
4 = W $\frac{1}{2}$
5 = NE $\frac{1}{4}$
6 = SE $\frac{1}{4}$
7 = SW $\frac{1}{4}$
8 = NW $\frac{1}{4}$

City: Valley City

Street Number: _____

Street Name: 9th Ave NW and 4th St NW

Urban Legal Description: _____

SITE DATA

Total # **Architectural** Features: 1

Fieldwork Date: 5/3/2016

Reconnaissance Survey Intensive Survey _____

Project Title & Supervisor:
Country Schoolhouse Project

Report Title & Author(s): _____

Additional Information: _____

SHSND USE

Area of Significance _____	Ecozone _____	Verified Site _____	CR Type _____
Area of Significance _____	Ecozone _____	Non-Site _____	
Area of Significance _____			

Recorded By Kathy Wilner Date Recorded 1/13/2017
(First Name & Last Name) (mm/dd/year)

Instructions to complete a digital version of this form: (1) Download a copy to your hard drive; (2) Open the saved blank copy; (3) Fill out the form; (4) Use the Save As command to rename the form appropriately and save; (5) Print and submit to SHSND.

NDCRS ARCHITECTURAL SITE FORM
PAGE 2—Feature Data

UPDATE

Field Code Heimes School #2

SITS# 32 BA 750

Complete one Page 2 for each architectural feature at the site.

Architectural Feature # 1

Construction Date Feature Type 9 Condition 6
Feature Date Context 7 Plan Shape 5
Structural System 25 Primary Exterior 26 Style Other Style
Original Owner's Ethnicity Secondary Exterior Architect/Builder

Other Information:

Foundation Poured Concrete Stories 1
Roof/Cornice
Window
Dating Method(s):

Feature Preservation Recommendation(s) (Check all that apply):

- Individual nomination
Contributes to a potential district
No nomination potential
Will not contribute to a district
Potential district—feature would be a contributing element if other properties constitute a district
Thematic nomination potential
Component of a historic site or landscape
Moved (specify all applicable choices)—a) relocation occurred within a historic period; b) recreates original site, orientation, landscape, & spatial relationships; c) compatible in context with neighboring structures; d) relocation has damaged eligibility
Historical associations require further investigation

Recorded By Kathy Wilner Date Recorded 1/13/2017
(First Name & Last Name) (mm/dd/year)

Instructions to complete a digital version of this form: (1) Download a copy to your hard drive; (2) Open the saved blank copy; (3) Fill out the form; (4) Use the Save As command to rename the form appropriately and save; (5) Print and submit to SHSND.

**NDCRS ARCHITECTURAL SITE FORM
PAGE 3—Feature Data****UPDATE**Field Code Heimes School #2SITS# 32 BA 750**Complete a Page 3 for each feature.****1. Feature Description, Integrity, Eligibility:**

This feature has been previously recorded so I will add additional notes for small changes. The bell tower showed openings on all sides and that is now closed. The double hung windows have half or more covered for protection. The interior, as viewed through the windows, show wood walls with colorful murals painted on them. The floor has been covered with rubber matting to protect the wood floor and it is now used as a warming house for the ice rink. There are old light fixtures inside.

Recorded By Kathy Wilner Date Recorded 1/13/2017
(First Name & Last Name) (mm/dd/year)

Instructions to complete a digital version of this form: (1) Download a copy to your hard drive; (2) Open the saved blank copy; (3) Fill out the form; (4) Use the Save As command to rename the form appropriately and save; (5) *Print* and submit to SHSND.

**NDCRS ARCHITECTURAL SITE FORM
PAGE 4—SITE DESCRIPTION**

UPDATE

Field Code Heimes School #2

SITS# 32 BA 750

Complete one Page 4 for the entire site.

2. Owner's Contact Information:

Valley City Park District

3. Access (to rural areas):

At the corner of 9th Ave NW and 4th St NW in Valley City.

4. Site Area (ft²): _____

5. Description of **SETTING**:

In a park.

Recorded By Kathy Wilner Date Recorded 1/13/2017
(First Name & Last Name) (mm/dd/year)

Instructions to complete a digital version of this form: (1) Download a copy to your hard drive; (2) Open the saved blank copy; (3) Fill out the form; (4) Use the Save As command to rename the form appropriately and save; (5) Print and submit to SHSND.

**NDCRS ARCHITECTURAL SITE FORM
PAGE 5—SITE DESCRIPTION**

UPDATE

Field Code Heimes School #2

SITS# 32 BA 750

6. Summary of ALL Site Features & Evaluation of Significance:

7. References/Comments:

Kathy Wilner
366 43rd Ave SE
Bowdon ND 58418

Recorded By Kathy Wilner **Date Recorded** 1/13/2017
(First Name & Last Name) (mm/dd/year)

Instructions to complete a digital version of this form: (1) Download a copy to your hard drive; (2) Open the saved blank copy; (3) Fill out the form; (4) Use the Save As command to rename the form appropriately and save; (5) *Print* and submit to SHSND.



East Side

Heimes School #2

5/3/2016

Kathy Wilner

BA

North Side





South Side

Heimes
School #2

5/3/2016

Kathy Wilner

BA

West Side



bing maps

Notes

Heimes School

5/3/2016

Kathy Wilner

BA

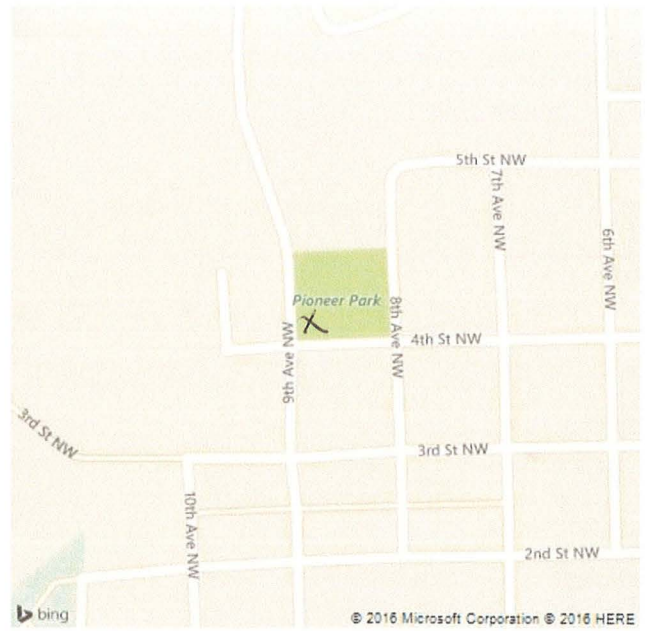

Feature