

NDCRS ARCHITECTURAL FORM

PAGE 1

UPDATE

Field Code Plainview School #2

SITS# 32BE 49

Map Quad Crow Hill
Map Quad

Site Name Plainview School #2
Site Name

LTL T. 151 N., R. 66 W., Sec. 4 QQQ 6 of the QQ 6 of the Q 6
LTL T. N., R. W., Sec. QQQ of the QQ of the Q
LTL T. N., R. W., Sec. QQQ of the QQ of the Q
LTL T. N., R. W., Sec. QQQ of the QQ of the Q

Table with Subsection header and rows 1-8: 1 = N 1/2, 2 = E 1/2, 3 = S 1/2, 4 = W 1/2, 5 = NE 1/4, 6 = SE 1/4, 7 = SW 1/4, 8 = NW 1/4

NAD 1983 UTM 5307490 Zone 14N
NAD 1983 UTM 492247

City:

Street Number:

Street Name: 35th St NE

Urban Legal Description:

Total Number of Architectural Features: 1

Fieldwork Date: 8/24/2021

Reconnaissance Survey [checked] Intensive Survey

Project & Principal Investigator:
Country School House Project
Kathy Wilner
366 43rd Ave SE
Bowdon ND 58418

Contracting Firm or Agency Completing the Form:

Additional Information:

SHSND USE
Component Study Unit Verified Site CR Type
Component
Component

Recorded By: Kathy Wilner Date Recorded: 10/21/2021

Form instructions: (1) Download; (2) Save A Copy; (3) Submit a paper copy of the form to the SHSND and upload the PDF version of the form and corresponding GIS shapefiles to the ND SHPO-run FTP site.

NDCRS ARCHITECTURAL FORM

PAGE 2 – Feature Data

Field Code Plainview School #2

SITS# 32 BE

Complete one Page 2 for each architectural feature at the site.

Architectural Feature # 1

Construction Date _____

Feature Date 1930-1945

Structural System Wood Frame

Original Owner's Ethnicity _____

Feature Type 9 - School; Church school

Context Education

Primary Exterior Wood, Horizontal Siding

Secondary Exterior _____

Condition Fair

Plan Shape Rectangular

Style Other Style

Architect/Builder _____

Foundation Concrete Stories 1

Roof/Cornice Hip, Gable entry

Window One not boarded up, double hung, no glass

Dating Method(s) Previous documentation

Miscellaneous Information _____

Feature Preservation Recommendation(s) (Check all that apply):

Individual nomination

Contributes to a potential district

No nomination potential

Will not contribute to a district

Potential district—feature would be a contributing element if other properties constitute a district

Thematic nomination potential

Component of a historic site or landscape

Moved (specify all applicable choices)—a) relocation occurred within a historic period; b) recreates original site, orientation, landscape, and spatial relationships; c) compatible in context with neighboring structures; d) relocation has damaged eligibility

Historical associations require further investigation

Recorded By: Kathy Wilner Date Recorded: 10/21/2021

NDCRS ARCHITECTURAL FORM

PAGE 3 – Feature Data

Field Code Plainview School #2

SITS# 32 BE 49

Complete one Page 3 for each architectural feature at the site.

1. Feature Description, Integrity, Eligibility:

This feature is a one room prairie school on a concrete foundation. The hip roof of the school and gable roof of the entry are covered with asphalt shingles with metal capping and finials. The chimney is gone.

The interior of the school was referenced in previous documentation.

2. Owner's Contact Information:

Unknown

Recorded By: Kathy Wilner **Date Recorded:** 10/21/2021

NDCRS ARCHITECTURAL FORM
PAGE 4 – Site Description

Field Code Plainview School #2

SITS# 32 BE 49

3. Site Area (ft²):

4. Description of Access and Site Setting:

Highway 281 north of Sheyenne 6 miles to 35th St NE. Go east 1 mile to see the school on the north side of the road. There are farm fields and pasture all directions.

5. Summary of ALL Site Features and Evaluation of Significance:

6. References/Comments:

Kathy Wilner
366 43rd Ave SE
Bowdon ND 58418

Recorded By: Kathy Wilner **Date Recorded:** 10/21/2021

Form instructions: (1) Download; (2) Save A Copy; (3) Submit a paper copy of the form to the SHSND and upload the PDF version of the form and corresponding GIS shapefiles to the ND SHPO-run FTP site.



West Side

Plainview School #2

8/24/2021

Kathy Wilner

BE

South
Side





East Side

Plainview School #2

8/24/2021

Kathy Wilner

BE



Imagery ©2021 Maxar Technologies, USDA Farm Service Agency, Map data ©2021 200 ft

Feature

NDCRS SITE FORM
ARCHITECTURAL SITES
Page 1

SITS # 32 B.E. 49

Field Code MAC-M- Site Name Plainview School #2
Field Code _____ Site Name _____

Map Quad Crow Hill
Map Quad _____

1. N $\frac{1}{2}$
2. E $\frac{1}{2}$
3. S $\frac{1}{2}$
4. W $\frac{1}{2}$
5. NE $\frac{1}{4}$
6. SE $\frac{1}{4}$
7. SW $\frac{1}{4}$
8. NW $\frac{1}{4}$
9. C

LTL <input type="checkbox"/>	Twp <u>151</u>	R <u>166</u>	Sec <u>4</u>	QQQ <u>6</u>	QQ <u>6</u>	Q <u>6</u>
LTL <input type="checkbox"/>	Twp _____	R _____	Sec _____	QQQ _____	QQ _____	Q _____
LTL <input type="checkbox"/>	Twp _____	R _____	Sec _____	QQQ _____	QQ _____	Q _____
LTL <input type="checkbox"/>	Twp _____	R _____	Sec _____	QQQ _____	QQ _____	Q _____
LTL <input type="checkbox"/>	Twp _____	R _____	Sec _____	QQQ _____	QQ _____	Q _____
LTL <input type="checkbox"/>	Twp _____	R _____	Sec _____	QQQ _____	QQ _____	Q _____

City _____

Street # _____

Street # _____

Street Name _____

Street Name _____

of Features 1

<u>1</u> Feature #	<u>9</u> Feature Type	<u>4</u> Condition
_____ Construction Date	<u>7</u> Context *	
<u>5</u> Feature Date	<u>26</u> Primary Exterior *	<u>5</u> Plan Shape *
<u>25</u> Structural System **	_____ Style *	_____ Secondary Exterior
<u>0</u> Ethnic		_____ Architect/Builder
<u>9</u> 19 <u>5</u> Fieldwork Date		_____ Other Information

<u>62</u> Soil Association	<u>17</u> Ecozone	<u>2</u> Area Signf	_____ MS Number
_____ Soil Association	_____ Ecozone	_____ Area Signf	_____ MS Number
<u>2</u> CR Type	<u>1</u> Verified Site	_____ Non-Site	<u>2</u> E C F <u>3</u> T F
_____ State Registry		_____ National Register	

Coder _____

Date Coded 9-6-95

Reconnaissance Survey _____

Intensive Survey X

Manuscript/Report Title: American Contracting's Thors Lake Borrow Area;
A Class III Cultural Resource Inventory in Benson County, North Dakota.
Author(s): Andrea Kulevsky

SITE DATA

FEATURE DATA

SHSND USE

NDCRS ARCHITECTURAL SITE FORM
page 1A

Field Code MAC-M-1

Feature Number 1

SITS# 32BE

DESCRIPTIVE SECTION

FOUNDATION:

Concrete

STORIES:

1

ROOF TYPE/CORNICE:

Hip

WINDOW CONDITION:

Glass absent most windows boarded over

DATING METHOD:

see attached Deeds Search

PRESERVATION RECOMMENDATION (check all that apply):

- 1) Individual Nomination
- 2) Contributes to a potential district
- 3) No nomination potential
- 4) Will not contribute to district
- 5) Potential district not known at this time: feature would be a contributing element if neighboring properties constitute a district
- 6) Thematic nomination potential
- 7) Component of historic site/landscape
- *****
- 8) Feature has an important physical, spatial, functional, historic, or architectural relationship to the site/complex/farmstead
- 9) Moved: A) relocation occurred within historic period. B) recreates original site, orientation, landscape and spatial relationships. C) compatible in context with neighboring structures. D) relocation has damaged eligibility.
- 10) Request comparative study of neighboring properties
- 11) Historical associations require further investigation

DESCRIPTION/INTEGRITY/ELIGIBILITY: The main room of this one room schoolhouse measured 6 m north-south by 8 m east-west (exterior dimensions). An entryway is attached to the west end, faces south and measures 3 m north-south by 2 m east-west. The whole structure, including the entryway, sits on a concrete foundation. There are three concrete steps leading to the entryway.

The chimney is absent and all openings - coal chute, chimney exit and windows - have been sealed and painted. The structure has been re-roofed with asphalt shingles; these have deteriorated and no longer offer much protection. The building was gutted and has been used to store sunflower seeds. According to the landowner, cattle using the field as pasture had gotten into the school and broken through the floor boards and caused other damage. The building is no longer used for seed storage and has further deteriorated. Some windows have been allowed to re-open and extensive weathering has resulted. Barn swallows use the interior for nests and the original plaster lathe walls are crumbling. The building and boarded up openings have been painted white, but the paint is flaking away. All the wood is quite weathered, some of it in very poor shape. Although the site retains integrity of location, it is otherwise lacking integrity. This type of one room school building is still common in rural North Dakota, but other examples of this type have more integrity.

This site does not meet National Register criteria. It is not associated with events that have made a significant contribution to the broad patterns of history (Criterion A). It is not known to be associated with a person important to history (Criterion B). It does not embody distinctive or unique characteristics (Criterion C). This site will not yield information important in history (Criterion D).

Urban Legal Description: _____

NDCRS ARCHITECTURAL SITE FORM

page 2

Field Code MAC-M-1SITS # 32BE

Results of Deeds Search

VOL/PAGE	GRANTOR	GRANTEE	DATE
U/397	US of America	Arthur B Atkins	6/2/1908
5P/619	US of America	Arthur B Atkins	12/28/1908
X-206	Arthur B Atkins	M A Liles & M H Oliver	7/13/1909
18/44	The Farm Mtg Loan & Trust Co	Mary E Ross	3/28/1924
18/45	John F Randall, Sheriff	The Farm Mtg Loan & Trust Co	8/2/1922
18/307	Mary E Ross	F A Chaldbourn	2/25/1926
28/71	F A Chaldbourn & Gertrude Chaldbourn	Plainview School Dist #31 2 acres	9/4/1937
39/377	F A Chaldbourn & Gertrude Chaldbourn	Ernest Hanson	12/12/1945
53/185	Maxine & Ernest T Hanson	Marvin B Logan	3/24/1958
81/110	Michael N Steffan & Gary Hegland Co PR	Marvin Logan Ranch L.L.C.	1/31/1995

NDCRS ARCHITECTURAL SITE FORM

Field Code MAC-M-1

Page 3

SITS # 32BEOWNER'S NAME, ADDRESS, PHONE # _____
_____PROJECT TITLE: American Contracting's Thors Lake Borrow Area: A Class III Cultural Resources Inventory in Benson County, North DakotaREPORT TITLE: same as aboveSITE AREA 7275 (in square feet)

ACCESS: From the village of Oberon proceed east for 4.8 miles. The school is visible approximately 50 meters north of the road at this point. (Note: USGS maps depict the site in Section 3. County highway maps depict the site in Section 4. Fence lines indicate it is indeed in Section 4).

DESCRIPTION: This one room school sits on two acres of land deeded to the school district in 1937. An extremely sparse cultural material scatter surrounds the structure. The scatter is composed primarily of bricks although several pieces of miscellaneous metal, some glass fragments and two pieces of ceramic were also noted.

SUMMARY OF SITE FEATURES & SIGNIFICANCE

Comments/References:

NDCRS ARCHITECTURAL SITE FORM

page 6

Field Code MAC-M-1

Feature Number

SITS# 32BE

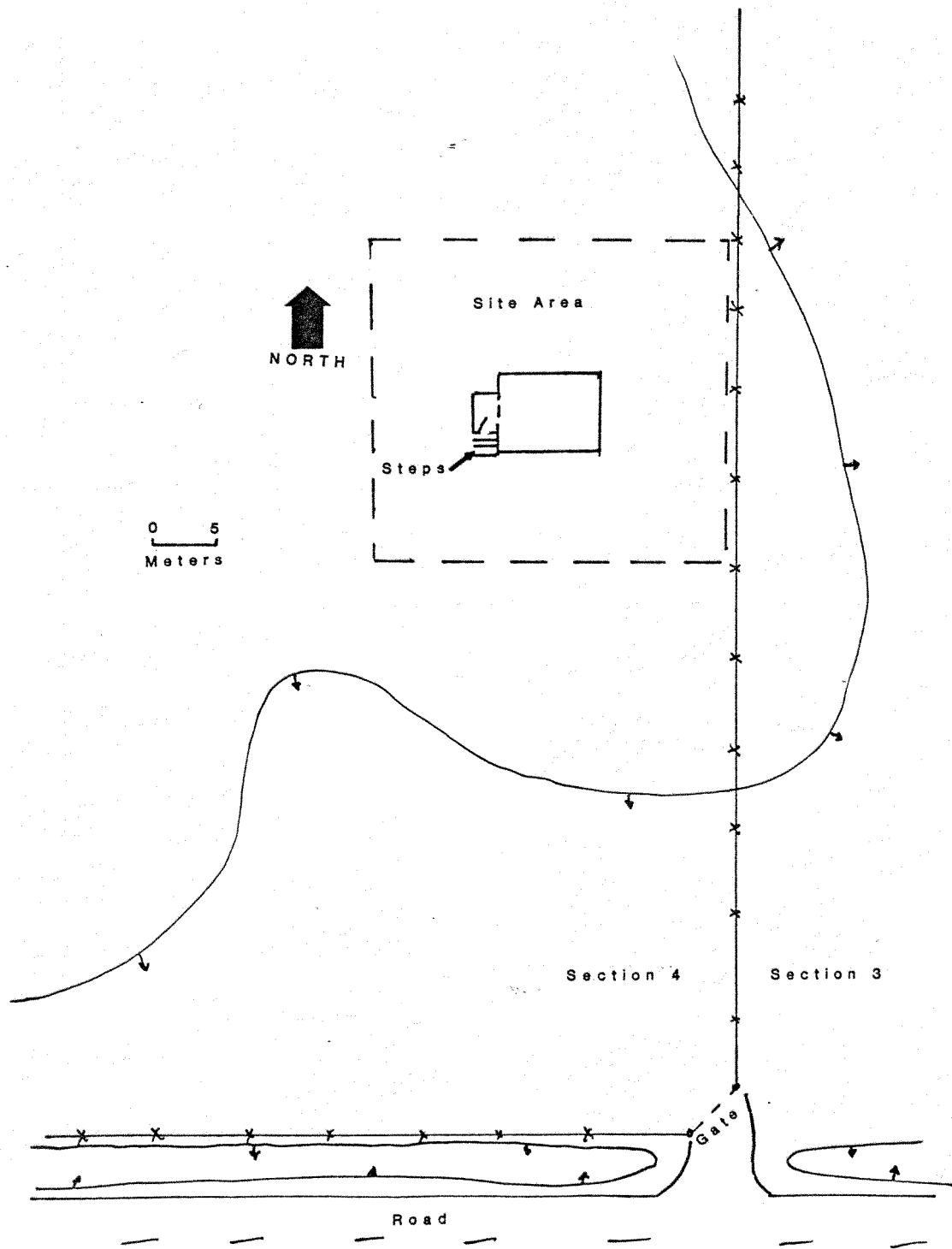

Sketch map of site.

NDCRS ARCHITECTURAL SITE FORM

page 7

Field Code MAC-M-1

Feature Number

SITS# 32BE



View to north over Plainview School #2 (roll #8-31-95, exposure #13).



View to northeast over Plainview School #2 (roll #8-31-95, exposure #14).

NDCRS ARCHITECTURAL SITE FORM

page 5

Field Code MAC-M-1

Feature Number

SITS# 32BE

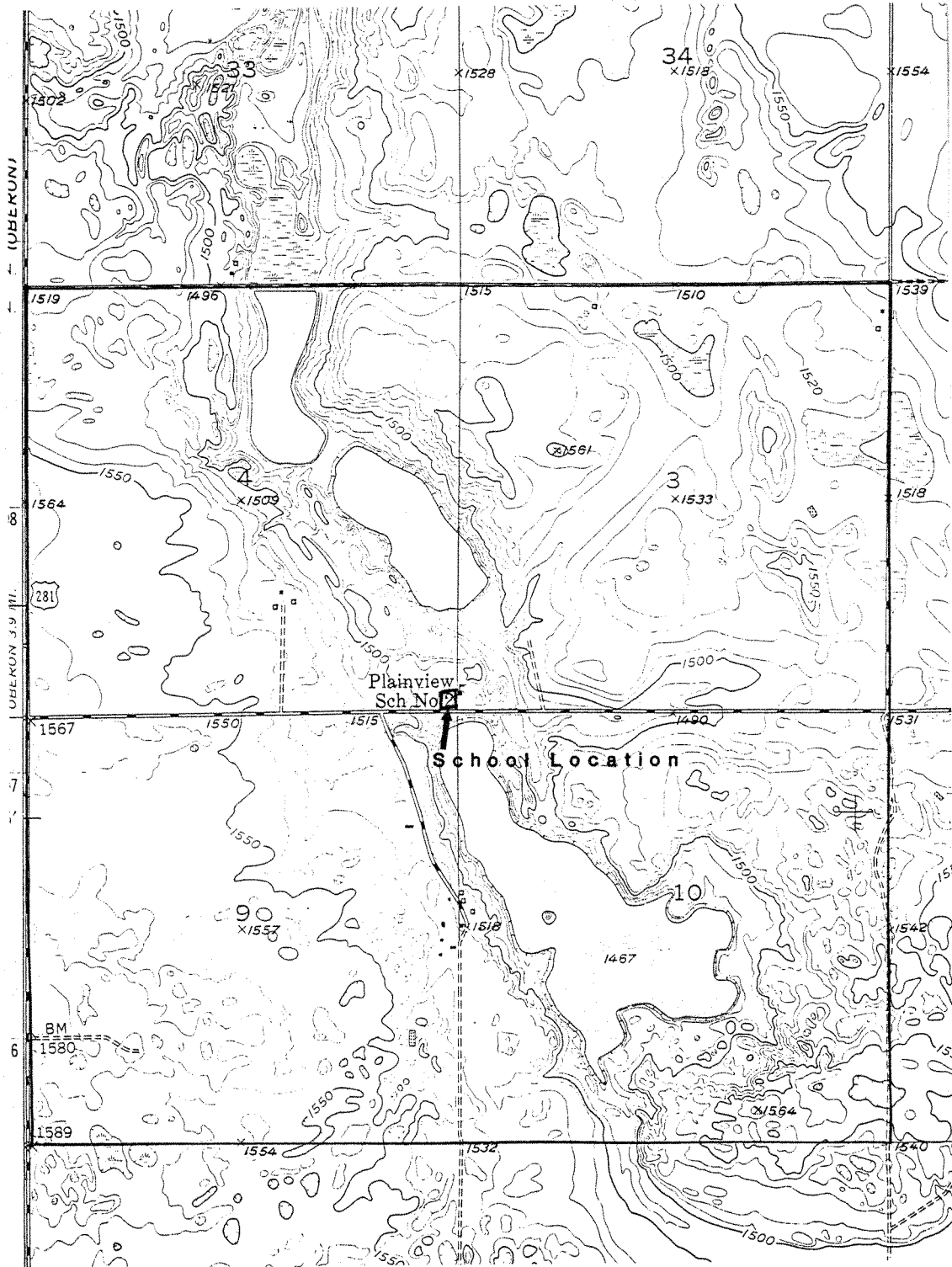

Location of site (USGS, 7.5', Crow Hill, 1951, photorevised 1975).