

NDCRS ARCHITECTURAL SITE FORM PAGE 1

SITS# 32 BE 213

SITE IDENTIFICATION

Field Code ABMIN4

Site Name School House

Site Name Riggin School

Map Quad Minnewaukan East

Map Quad ~~Minnewaukan West~~

LTL ___ TWP 153 R 67 SEC 22 QQQ 5 QQ 8 Q 5

LTL ___ TWP ___ R ___ SEC ___ QQQ ___ QQ ___ Q ___

LTL ___ TWP ___ R ___ SEC ___ QQQ ___ QQ ___ Q ___

LTL ___ TWP ___ R ___ SEC ___ QQQ ___ QQ ___ Q ___

UTM 5323930 N

ZONE 14N

UTM 481355 E

NAD 1927 ___ NAD 1983

Subsection:
1 = N½
2 = E½
3 = S½
4 = W½
5 = NE¼
6 = SE¼
7 = SW¼
8 = NW¼

City: _____

Street Number: _____

Street Name: _____

Urban Legal Description: _____

SITE DATA

Total # **Architectural** Features: 1

Fieldwork Date: 8/11/2011

Reconnaissance Survey ___ Intensive Survey

Project Title & Supervisor:

Project Title: Minnewaukan, Benson County, North Dakota

Supervisor: Becky Rude and Jennifer Harty

Report Title & Author(s):

Report Author and Title: Aaron L. Barth, "Mitigative Recording and History of Minnewaukan, North Dakota: An Intensive Class III Architectural Survey of Thirty-One Buildings in Benson County"

Additional Information: _____

SHSND USE

Area of Significance 2

Ecozone 17

Verified Site 1

CR Type 2

Area of Significance ___

Ecozone ___

Non-Site ___

Area of Significance ___

Recorded By Aaron L. Barth Date Recorded 8/24/2011
(First Name & Last Name) (mm/dd/year)

Instructions to complete a digital version of this form: (1) Download a copy to your hard drive; (2) Open the saved blank copy; (3) Fill out the form; (4) Use the Save As command to rename the form appropriately and save; (5) Print and submit to SHSND.

NDCRS ARCHITECTURAL SITE FORM PAGE 2—Feature Data

Field Code ABMIN4SITS# 32 BE

Complete one Page 2 for each architectural feature at the site.

Architectural Feature # 1

Construction Date _____

Feature Type 9Condition 6Feature Date 3Context 7Plan Shape 5Structural System 25Primary Exterior 26Style ~~Prairie Style~~ Other Style

Original Owner's Ethnicity _____

Secondary Exterior _____

Architect/Builder _____

Other Information:

Foundation Concrete Stories 1Roof/Cornice GableWindow Most original windows and openings intact.Dating Method(s): Professional estimate.

Feature Preservation Recommendation(s) (Check all that apply):

 Individual nomination Contributes to a potential district No nomination potential Will not contribute to a district Potential district—feature would be a contributing element if other properties constitute a district Thematic nomination potential Component of a historic site or landscape

Moved (specify all applicable choices)—a) relocation occurred within a historic period; b) recreates original site, orientation, landscape, & spatial relationships; c) compatible in context with neighboring structures; d) relocation has damaged eligibility

 Historical associations require further investigation

Recorded By Aaron L. Barth Date Recorded 8/24/2011
(First Name & Last Name) (mm/dd/year)

Instructions to complete a digital version of this form: (1) Download a copy to your hard drive; (2) Open the saved blank copy; (3) Fill out the form; (4) Use the Save As command to rename the form appropriately and save; (5) Print and submit to SHSND.

NDCRS ARCHITECTURAL SITE FORM
PAGE 3—Feature DataField Code ABMIN4SITS# 32 BE**Complete a Page 3 for each feature.****1. Feature Description, Integrity, Eligibility:**

Description: Feature 1 measures approximately 50' east-west and 30' north-south. It has a concrete foundation and the wood frame structure is covered in wood horizontal drop-siding. The east side has a door and one four-light window. The south side has an automotive rolling door, two four-light single-hung windows, and one four-light window. The north side has two four-light windows, and one four-light, single hung window. The gable roof has closed soffits, and a slight relief on the eastern side. This drops down approximately 1' to another gable roof. The roof itself is covered with wood shingles. A concrete block chimney extends up out of the taller gable roof.

Integrity: Feature 1 appears to retain its seven aspects of integrity to varying degrees, including Location, Design, Setting, Materials, Workmanship, Feeling and Association (NRB #15, 1997:44-45).

Eligibility: Feature 1 is recommended as eligible for nomination to the National Register of Historic Places under criterion A: Event, and C: Design/Construction. Feature 1 has an important association with rural schools in North Dakota, and its construction is a typical representation of the one room school house.

On May 22, 2010, Architectural Historian Lorna Meidinger (SHSND) and Research Archaeologist Amy Bleier (SHSND) held a workshop titled "Historic Preservation - Country Schoolhouses" at the Myra Museum in Grand Forks, North Dakota. Meidinger and Bleier discussed methods and techniques in recording schoolhouses for the North Dakota Cultural Resources Survey.

Recorded By Aaron L. Barth Date Recorded 8/24/2011
(First Name & Last Name) (mm/dd/year)

Instructions to complete a digital version of this form: (1) Download a copy to your hard drive; (2) Open the saved blank copy; (3) Fill out the form; (4) Use the Save As command to rename the form appropriately and save; (5) *Print* and submit to SHSND.

**NDCRS ARCHITECTURAL SITE FORM
PAGE 4—SITE DESCRIPTION**Field Code ABMIN4SITS# 32 BE**Complete one Page 4 for the entire site.**

2. Owner's Contact Information:

N/A.

3. Access (to rural areas):

N/A.

4. Site Area (ft²): 1,5005. Description of **SETTING**:

This school house is set in the southern edge of Minnewaukan on the western shore of Devils Lake in Benson County, North Dakota. Devils Lake is a closed drainage lake, and is the largest body of natural water in North Dakota. The remaining surrounding setting is farmland used for agricultural purposes. This area falls within the larger Sheyenne River Study Unit (SRSU), an area primarily in the Drift Prairie physiographic zone of the Central Lowlands physiographic province. In all, the SRSU covers approximately 10,996 square miles (SHSND, 2008:12.1).

Recorded By Aaron L. Barth Date Recorded 8/24/2011
(First Name & Last Name) (mm/dd/year)

Instructions to complete a digital version of this form: (1) Download a copy to your hard drive; (2) Open the saved blank copy; (3) Fill out the form; (4) Use the Save As command to rename the form appropriately and save; (5) *Print* and submit to SHSND.

**NDCRS ARCHITECTURAL SITE FORM
PAGE 5—SITE DESCRIPTION**

Field Code ABMIN4

SITS# 32 BE

6. Summary of ALL Site Features & Evaluation of Significance:

Feature 1, Schoolhouse -- recommended eligible, criterion A and C.

7. References/Comments:

See continuation sheet.

Recorded By Aaron L. Barth Date Recorded 8/24/2011
(First Name & Last Name) (mm/dd/year)

Instructions to complete a digital version of this form: (1) Download a copy to your hard drive; (2) Open the saved blank copy; (3) Fill out the form; (4) Use the Save As command to rename the form appropriately and save; (5) Print and submit to SHSND.

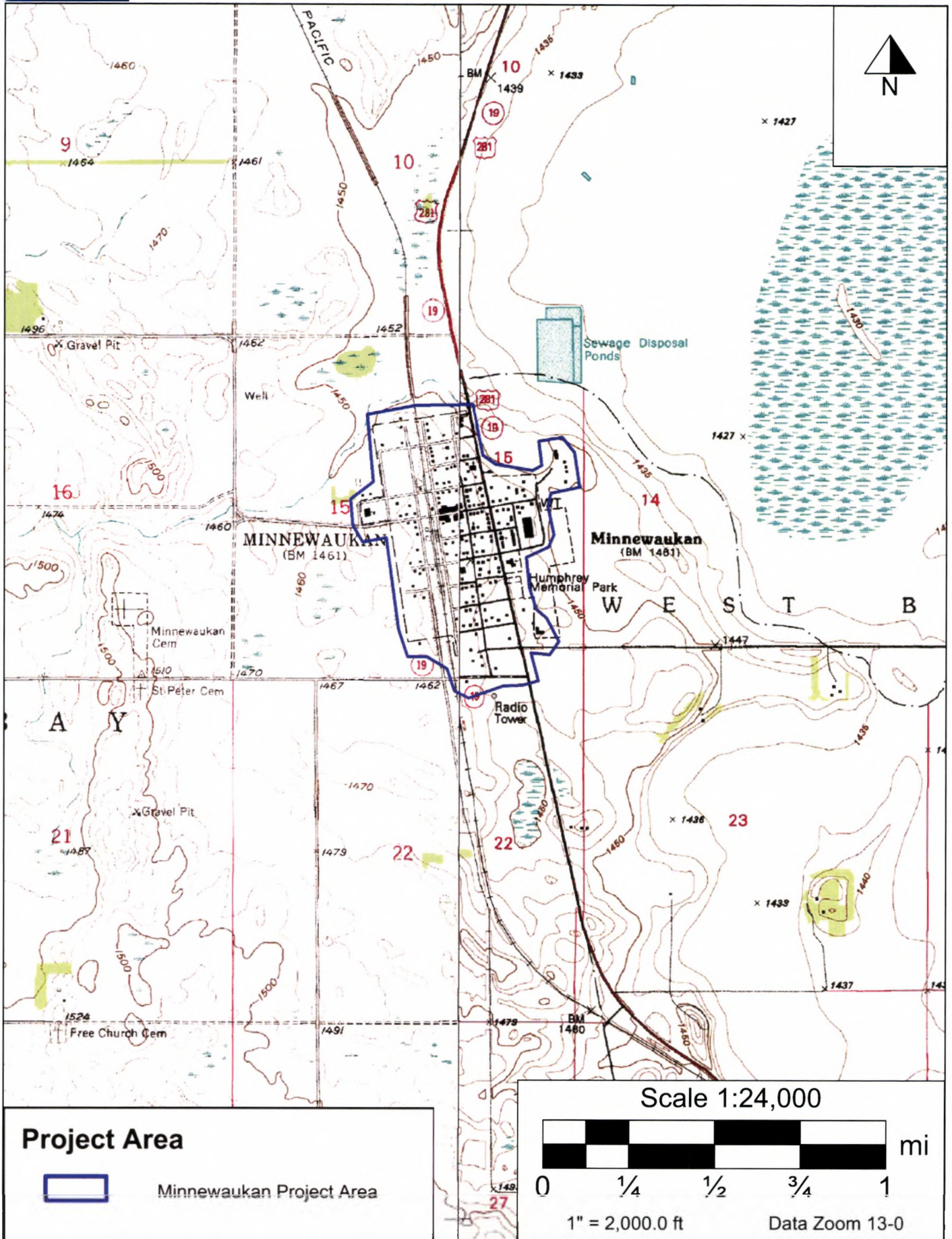

Project Area



Minnewaukan Project Area

Scale 1:24,000



mi

0 1/4 1/2 3/4 1

1" = 2,000.0 ft

Data Zoom 13-0

NDCRS SITE FORM ATTACHMENTS SECTION

Field Code: ABMIN4

SITS# 32BE



Google Earth map of Feature 1, a schoolhouse on the south edge of Minnewaukan.

Bibliography:

State Historical Society of North Dakota (SHSND)
2009 *NDCRS Site Form Training Manuel: Architectural Sites*. Bismarck, ND.

SHSND
2008 *The North Dakota Comprehensive Plan for Historic Preservation: Archaeological Component*. Bismarck ND.

United States Department of the Interior
1997 *National Register Bulletin #15: How to Apply the National Register Criteria for Evaluation*. National Park Service, Washington, D.C

Recorded By: Aaron L. Barth
(First Name & Last Name)

Date Recorded: 08/24/2011
(mm/dd/year)

**NDCRS SITE FORM
ATTACHMENTS SECTION**

Field Code: ABMIN4

SITS# 32BE



Photo 1: Northeast corner of Feature 1.



Photo 2: Southwest corner of Feature 1.

Recorded By: Aaron L. Barth
(First Name & Last Name)

Date Recorded: 08/24/2011
(mm/dd/year)