

NDCRS ARCHITECTURAL SITE FORM PAGE 1

SITS# 32 BI 1165

SITE IDENTIFICATION

Field Code Billings School #2 Site Name _____

Map Quad Fairfield SE Site Name _____

Map Quad _____

LTL	TWP	<u>142</u>	R	<u>98</u>	SEC	<u>14</u>	QQQ	<u>6</u>	QQ	<u>7</u>	Q	<u>6</u>
LTL	TWP	_____	R	_____	SEC	_____	QQQ	_____	QQ	_____	Q	_____
LTL	TWP	_____	R	_____	SEC	_____	QQQ	_____	QQ	_____	Q	_____
LTL	TWP	_____	R	_____	SEC	_____	QQQ	_____	QQ	_____	Q	_____

UTM _____ 5219384 _____ N ZONE 13N
 UTM _____ 647066 _____ E NAD 1927 _____ NAD 1983 _____

Subsection:
1 = N½
2 = E½
3 = S½
4 = W½
5 = NE¼
6 = SE¼
7 = SW¼
8 = NW¼

City: _____

Street Number: _____

Street Name: 21st St SW

Urban Legal Description: _____

SITE DATA

Total # *Architectural* Features: 1

Fieldwork Date: 4/13/2016

Reconnaissance Survey Intensive Survey _____

Project Title & Supervisor:
Country Schoolhouse Project

Report Title & Author(s):

Additional Information: _____

SHSND USE

Area of Significance 2 Ecozone 22 Verified Site 1 CR Type 2
 Area of Significance _____ Ecozone _____ Non-Site _____
 Area of Significance _____

Recorded By Kathy Wilner Date Recorded 1/23/2017
 (First Name & Last Name) (mm/dd/year)

Instructions to complete a digital version of this form: (1) Download a copy to your hard drive; (2) Open the saved blank copy; (3) Fill out the form; (4) Use the Save As command to rename the form appropriately and save; (5) Print and submit to SHSND.

NDCRS ARCHITECTURAL SITE FORM
PAGE 2—Feature Data

Field Code Billings School #2SITS# 32 BI

Complete one Page 2 for each architectural feature at the site.

Architectural Feature # 1

Construction Date _____

Feature Type 9Condition 5Feature Date 3Context 7Plan Shape 5Structural System 24-25Primary Exterior 26Style Other Style

Original Owner's Ethnicity _____

Secondary Exterior _____

Architect/Builder _____

Other Information:

Foundation _____ Stories 1Roof/Cornice GableWindow Double hungDating Method(s): estimate

Feature Preservation Recommendation(s) (Check all that apply):

 Individual nomination Contributes to a potential district No nomination potential Will not contribute to a district Potential district—feature would be a contributing element if other properties constitute a district Thematic nomination potential Component of a historic site or landscape

Moved (specify all applicable choices)—a) relocation occurred within a historic period; b) recreates original site, orientation, landscape, & spatial relationships; c) compatible in context with neighboring structures; d) relocation has damaged eligibility

 Historical associations require further investigation

Recorded By Kathy Wilner Date Recorded 1/23/2017
 (First Name & Last Name) (mm/dd/year)

Instructions to complete a digital version of this form: (1) Download a copy to your hard drive; (2) Open the saved blank copy; (3) Fill out the form; (4) Use the Save As command to rename the form appropriately and save; (5) *Print* and submit to SHSND.

**NDCRS ARCHITECTURAL SITE FORM
PAGE 3—Feature Data**Field Code Billings School #2SITS# 32 BI**Complete a Page 3 for each feature.****1. Feature Description, Integrity, Eligibility:**

The feature is a one room prairie school. Foundation unknow since we did not enter this farm yard. The gable roof of the school is covered with wood shakes and the entry has asphalt shingles. The chimney is gone. The soffits are closed.

There is a wide trim board under the soffits at the peak ends of the school with the remainder of the siding 6 inch wood lap with 4 inch wood corner trim. There is broken wood door at the entry. There are two small fixed glass windows to either side of the entry door. One double hung, two over two, window is on the west wall and there are three more on the east wall, glass intact. Wiring going to the building suggest electricity.

Recorded By Kathy Wilner Date Recorded 1/23/2017
(First Name & Last Name) (mm/dd/year)

Instructions to complete a digital version of this form: (1) Download a copy to your hard drive; (2) Open the saved blank copy; (3) Fill out the form; (4) Use the Save As command to rename the form appropriately and save; (5) Print and submit to SHSND.

**NDCRS ARCHITECTURAL SITE FORM
PAGE 4—SITE DESCRIPTION**

Field Code Billings School #2

SITS# 32 BI

Complete one Page 4 for the entire site.

2. Owner's Contact Information:

Wayne Hecker ETAL for Kathryn Hecker Estate
Po Box 1282
Dickinson ND 58601

3. Access (to rural areas):

North of Belfield on Highway 85 12 plus miles to 23rd St SW. Turn right and drive east 5 miles and turn left to drive north on 123rd Ave SW two miles and then right again to drive 1 3/4 miles to see the school on the left or north side of the road. It is part of a farm site.

4. Site Area (ft²): _____

5. Description of *SETTING*:

This building sits in an abandoned farm yard with some crop land to the south and east and hilly pasture to the north. There is a house to the southeast and a barn to the northwest.

Recorded By Kathy Wilner **Date Recorded** 1/23/2017
(First Name & Last Name) (mm/dd/year)

Instructions to complete a digital version of this form: (1) Download a copy to your hard drive; (2) Open the saved blank copy; (3) Fill out the form; (4) Use the Save As command to rename the form appropriately and save; (5) *Print* and submit to SHSND.

**NDCRS ARCHITECTURAL SITE FORM
PAGE 5—SITE DESCRIPTION**

Field Code Billings School #2

SITS# 32 BI

6. Summary of ALL Site Features & Evaluation of Significance:

7. References/Comments:

Kathy Wilner
366 43rd Ave SE
Bowdon ND 58418

Recorded By Kathy Wilner Date Recorded 1/23/2017
(First Name & Last Name) (mm/dd/year)

Instructions to complete a digital version of this form: (1) Download a copy to your hard drive; (2) Open the saved blank copy; (3) Fill out the form; (4) Use the Save As command to rename the form appropriately and save; (5) Print and submit to SHSND.

Billings School #2

4/13/2016

Kathy Wilner

BI

East Side





South Side

Billings School #2

4/13/2016

Kathy Wilner

BI

West Side



bing maps

Notes

Billings School #2

4/13/2016

Kathy Wilner

BI

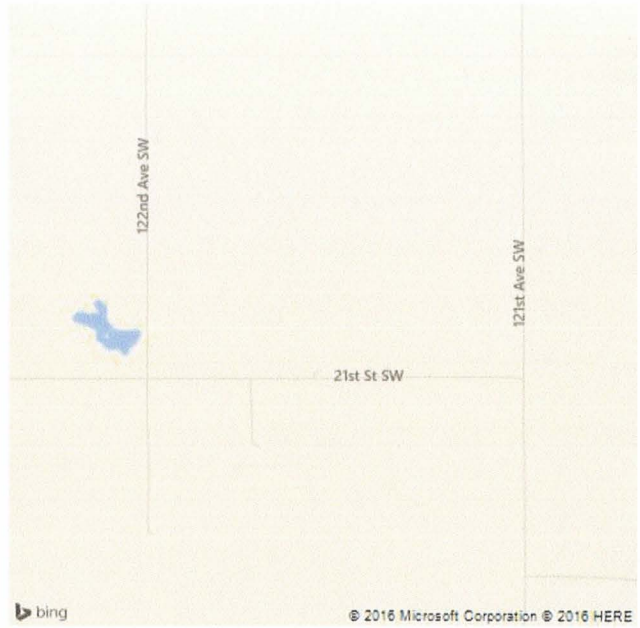

feature