

# NDCRS ARCHITECTURAL SITE FORM PAGE 1

SITS# 32 BK 190

### SITE IDENTIFICATION

Field Code Dale Township School Site Name \_\_\_\_\_

Map Quad Woburn Site Name \_\_\_\_\_

Map Quad \_\_\_\_\_

LTL	TWP	<u>162</u>	R	<u>91</u>	SEC	<u>23</u>	QQQ	<u>6</u>	QQ	<u>6</u>	Q	<u>7</u>
LTL	TWP	_____	R	_____	SEC	_____	QQQ	_____	QQ	_____	Q	_____
LTL	TWP	_____	R	_____	SEC	_____	QQQ	_____	QQ	_____	Q	_____
LTL	TWP	_____	R	_____	SEC	_____	QQQ	_____	QQ	_____	Q	_____

UTM \_\_\_\_\_ N ZONE \_\_\_\_\_  
UTM \_\_\_\_\_ E NAD 1927 \_\_\_\_\_ NAD 1983 \_\_\_\_\_

City: \_\_\_\_\_

Street Number: \_\_\_\_\_

Street Name: 98th St NW

Urban Legal Description: \_\_\_\_\_

Subsection:
1 = N $\frac{1}{2}$
2 = E $\frac{1}{2}$
3 = S $\frac{1}{2}$
4 = W $\frac{1}{2}$
5 = NE $\frac{1}{4}$
6 = SE $\frac{1}{4}$
7 = SW $\frac{1}{4}$
8 = NW $\frac{1}{4}$

### SITE DATA

Total # *Architectural* Features: 1

Fieldwork Date: 7/14/2016

Reconnaissance Survey  Intensive Survey

Project Title & Supervisor:  
Country Schoolhouse Project

Report Title & Author(s):

Additional Information: \_\_\_\_\_

### SHSND USE

Area of Significance <u>2</u>	Ecozone <u>20</u>	Verified Site <u>1</u>	CR Type <u>2</u>
Area of Significance _____	Ecozone _____	Non-Site _____	
Area of Significance _____			

Recorded By Kathy Wilner Date Recorded 1/29/2017  
(First Name & Last Name) (mm/dd/year)

*Instructions to complete a digital version of this form:* (1) Download a copy to your hard drive; (2) Open the saved blank copy; (3) Fill out the form; (4) Use the Save As command to rename the form appropriately and save; (5) *Print* and submit to SHSND.

**NDCRS ARCHITECTURAL SITE FORM**  
**PAGE 2—Feature Data**

Field Code Dale Township SchoolSITS# 32 BK

**Complete one Page 2 for each architectural feature at the site.**

Architectural Feature # 1

Construction Date \_\_\_\_\_

Feature Type 9Condition 6Feature Date 3Context 7Plan Shape 5Structural System 25Primary Exterior 26Style Other Style

Original Owner's Ethnicity \_\_\_\_\_

Secondary Exterior 5

Architect/Builder \_\_\_\_\_

Other Information:

Foundation Poured concrete Stories 1Roof/Cornice GableWindow Double hung, many shutteredDating Method(s): Estimate

**Feature Preservation Recommendation(s) (Check all that apply):**

 Individual nomination Contributes to a potential district No nomination potential Will not contribute to a district Potential district—feature would be a contributing element if other properties constitute a district Thematic nomination potential Component of a historic site or landscape

Moved (specify all applicable choices)—a) relocation occurred within a historic period; b) recreates original site, orientation, landscape, & spatial relationships; c) compatible in context with neighboring structures; d) relocation has damaged eligibility

 Historical associations require further investigation

Recorded By Kathy Wilner Date Recorded 1/29/2017  
(First Name & Last Name) (mm/dd/year)

*Instructions to complete a digital version of this form:* (1) Download a copy to your hard drive; (2) Open the saved blank copy; (3) Fill out the form; (4) Use the Save As command to rename the form appropriately and save; (5) *Print* and submit to SHSND.

**NDCRS ARCHITECTURAL SITE FORM  
PAGE 3—Feature Data**

Field Code Dale Township School

SITS# 32 BK

**Complete a Page 3 for each feature.**

**1. Feature Description, Integrity, Eligibility:**

The features is a one room prairie school on a poured concrete foundation. The gable roof of the entry and main body are covered with wood shakes with metal capping with finials. The shed roof of the north addition is covered with asphalt shingles. A crumbling chimney sits at the peak of the roof at the north end. The soffits are closed. The school measures 26 feet north to south and 16 feet east to west. The shed measures 12 feet east to west by 8 feet north to south and the entry measures 12 feet east to west and 8 feet north to south.

There is a wide trim board on the wall under the soffits at the peak ends of the school. The remainder of the siding on the main body of the school is 6 inch wood lap with 6 inch wood trim. The siding on the entry is 10 inch composite siding and the addition is sided with plywood. The addition on the north side of the school has two plywood doors on the east side that swing open from the middle to give entry for stoarge. It has only studwalls. The entry is reached by way of a concrete step and a 5 panel wood door. The interior of the entry is bare to the stud walls. There are two covered windows in the entry, one south and the other west, glass intact. Another 5 panel wood door opens into the school room. There are three double hung, two over two, windows on the east and west walls, intact glass, mostly shuttered. The interior walls and ceiling are covered with wallboard, some of the panels in the ceiling are beginning to fail. There is another door on the north wall, between blackboards, that goes into the north addition. A non-functioning furnace sits in the middle of the room. The floor is tongue and groove hardwood. Light fixtures suggest electricity.

Recorded By Kathy Wilner Date Recorded 1/29/2017  
(First Name & Last Name) (mm/dd/year)

*Instructions to complete a digital version of this form: (1) Download a copy to your hard drive; (2) Open the saved blank copy; (3) Fill out the form; (4) Use the Save As command to rename the form appropriately and save; (5) Print and submit to SHSND.*

**NDCRS ARCHITECTURAL SITE FORM  
PAGE 4—SITE DESCRIPTION**

Field Code Dale Township School

SITS# 32 BK

**Complete one Page 4 for the entire site.**

2. Owner's Contact Information:

3. Access (to rural areas):

From Lignite, go south on Highway 89 4 miles to County Road 4 or 98th St NW, turn left and go east 5 1/2 miles to see the school on the left side of the road.

4. Site Area (ft<sup>2</sup>): \_\_\_\_\_

5. Description of **SETTING**:

There are trees and an old farm site to the east, more tree and a slough to the north, farm fields all other directions.

Recorded By Kathy Wilner Date Recorded 1/29/2017  
(First Name & Last Name) (mm/dd/year)

*Instructions to complete a digital version of this form:* (1) Download a copy to your hard drive; (2) Open the saved blank copy; (3) Fill out the form; (4) Use the Save As command to rename the form appropriately and save; (5) *Print* and submit to SHSND.

**NDCRS ARCHITECTURAL SITE FORM  
PAGE 5—SITE DESCRIPTION**

Field Code Dale Township School

SITS# 32 BK

**6. Summary of ALL Site Features & Evaluation of Significance:**

7. References/Comments:

Kathy Wilner  
366 43rd Ave SE  
Bowdon ND 58418

Recorded By Kathy Wilner Date Recorded 1/29/2017  
(First Name & Last Name) (mm/dd/year)

*Instructions to complete a digital version of this form: (1) Download a copy to your hard drive; (2) Open the saved blank copy; (3) Fill out the form; (4) Use the Save As command to rename the form appropriately and save; (5) Print and submit to SHSND.*



South Side

Dale Township School

7/14/2016

Kathy Wilner

BK



West Side



East Side

Dale Township School

7/14/2016

Kathy Wilner

BK

North Side



bing maps

Notes

Dale Township School

7/14/2016

Kathy Wilner

BK

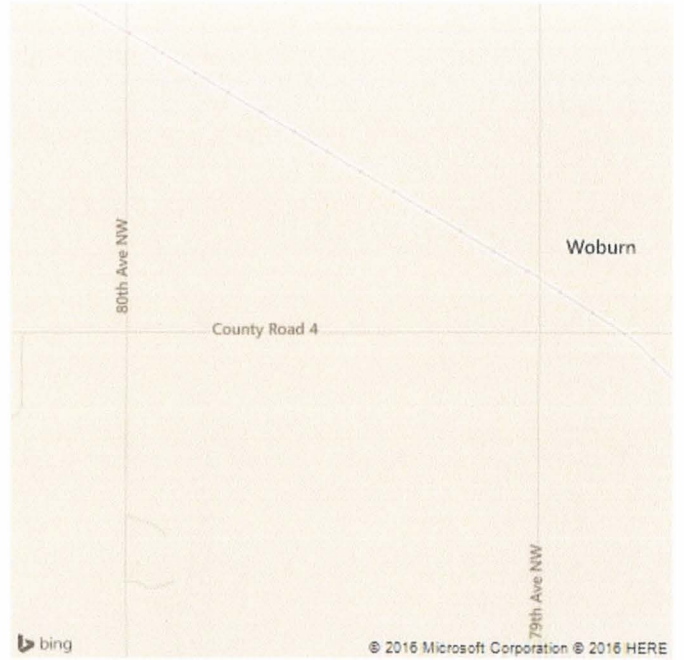

Feature