

# NDCRS ARCHITECTURAL SITE FORM PAGE 1

SITS# 32 BK 195

### SITE IDENTIFICATION

Field Code Lucy Township School Site Name \_\_\_\_\_

Map Quad Helde Lake Site Name \_\_\_\_\_

Map Quad \_\_\_\_\_

LTL	TWP	<u>160</u>	R	<u>92</u>	SEC	<u>4</u>	QQQ	<u>7</u>	QQ	<u>8</u>	Q	<u>8</u>
LTL	TWP	_____	R	_____	SEC	_____	QQQ	_____	QQ	_____	Q	_____
LTL	TWP	_____	R	_____	SEC	_____	QQQ	_____	QQ	_____	Q	_____
LTL	TWP	_____	R	_____	SEC	_____	QQQ	_____	QQ	_____	Q	_____

UTM \_\_\_\_\_ N ZONE \_\_\_\_\_  
 UTM \_\_\_\_\_ E NAD 1927 \_\_\_\_\_ NAD 1983 \_\_\_\_\_

Subsection:
1 = N½
2 = E½
3 = S½
4 = W½
5 = NE¼
6 = SE¼
7 = SW¼
8 = NW¼

City: \_\_\_\_\_

Street Number: \_\_\_\_\_

Street Name: 90th St NW

Urban Legal Description: \_\_\_\_\_

### SITE DATA

Total # *Architectural* Features: 1

Fieldwork Date: 8/21/2016

Reconnaissance Survey  Intensive Survey

Project Title & Supervisor:  
Country Schoolhouse Project

Report Title & Author(s):

Additional Information: \_\_\_\_\_

### SHSND USE

Area of Significance <u>2</u>	Ecozone <u>20</u>	Verified Site <u>1</u>	CR Type <u>2</u>
Area of Significance _____	Ecozone _____	Non-Site _____	
Area of Significance _____			

Recorded By Kathy Wilner Date Recorded 1/29/2017  
 (First Name & Last Name) (mm/dd/year)

*Instructions to complete a digital version of this form:* (1) Download a copy to your hard drive; (2) Open the saved blank copy; (3) Fill out the form; (4) Use the Save As command to rename the form appropriately and save; (5) Print and submit to SHSND.

**NDCRS ARCHITECTURAL SITE FORM**  
**PAGE 2—Feature Data**

Field Code Lucy Township SchoolSITS# 32 BK

**Complete one Page 2 for each architectural feature at the site.**

Architectural Feature # 1

Construction Date \_\_\_\_\_

Feature Type 9Condition 4Feature Date 3Context 7Plan Shape 5Structural System 25Primary Exterior 26Style Other Style

Original Owner's Ethnicity \_\_\_\_\_

Secondary Exterior \_\_\_\_\_

Architect/Builder \_\_\_\_\_

Other Information:

Foundation POured concrete Stories 1Roof/Cornice GableWindow Double hung, mostly empty openings with a bit of framing, no glassDating Method(s): Estimate

**Feature Preservation Recommendation(s) (Check all that apply):**

 Individual nomination Contributes to a potential district No nomination potential Will not contribute to a district Potential district—feature would be a contributing element if other properties constitute a district Thematic nomination potential Component of a historic site or landscape

Moved (specify all applicable choices)—a) relocation occurred within a historic period; b) recreates original site, orientation, landscape, & spatial relationships; c) compatible in context with neighboring structures; d) relocation has damaged eligibility

 Historical associations require further investigation

Recorded By Kathy Wilner Date Recorded 1/29/2017  
 (First Name & Last Name) (mm/dd/year)

*Instructions to complete a digital version of this form:* (1) Download a copy to your hard drive; (2) Open the saved blank copy; (3) Fill out the form; (4) Use the Save As command to rename the form appropriately and save; (5) Print and submit to SHSND.

**NDCRS ARCHITECTURAL SITE FORM  
PAGE 3—Feature Data**Field Code Lucy Township SchoolSITS# 32 BK**Complete a Page 3 for each feature.****1. Feature Description, Integrity, Eligibility:**

The feature is a one room prairie school on a foundation of poured concrete. The gable roof of the school has about half the wood shakes remaining with almost none on the plank roof of the entry. There is not chimney. The soffits are closed. The chimney opening is covered with metal sheeting. The building measures 16 feet east to west by 30 feet north to south and the entry measures 12 feet by 12 feet.

There is a wide trim board on the wall under the soffits at the peak ends of the school and entry. The remainder of the siding is 6 inch wood lap with 6 inch wood trim. There is not a speck of paint on this building. The entry is two parts, the north half has flooring that is falling onto the ground with a small window opening to the east, no glass and stripped walls. The south part of the entry has gravel flooring, stud walls and one small window opening to the south, again no glass. The entry door into the school is a 4 panel wood door. The interior of the school has walls covered with beadboard with the lower third covered by shiplap. The ceiling is also covered with beadboard. There are three window openings on both the east and west walls, some framing, some half covered, a bit of framing and no glass. There are decorative cornices above the window frames inside the school. The floor is tongue and groove hardwood. There are two blackboards across the entire north wall. The pyramid top of a bell tower sits beside the east entry wall. The building is used for storage.

Recorded By Kathy Wilner Date Recorded 1/29/2017  
(First Name & Last Name) (mm/dd/year)

*Instructions to complete a digital version of this form: (1) Download a copy to your hard drive; (2) Open the saved blank copy; (3) Fill out the form; (4) Use the Save As command to rename the form appropriately and save; (5) Print and submit to SHSND.*

**NDCRS ARCHITECTURAL SITE FORM  
PAGE 4—SITE DESCRIPTION**

Field Code Lucy Township School

SITS# 32 BK

**Complete one Page 4 for the entire site.**

2. Owner's Contact Information:

3. Access (to rural areas):

From Powers Lake, east on Highway 50 2 miles to Highway 89, turn left and go north 11 miles to 90th St NW, turn right and go 1/4 mile east to see the school on your right.

4. Site Area (ft<sup>2</sup>): \_\_\_\_\_

5. Description of **SETTING**:

There is a large slough to the south and east, trees to the east and grassland/pasture all directions.

Recorded By Kathy Wilner Date Recorded 1/29/2017  
(First Name & Last Name) (mm/dd/year)

*Instructions to complete a digital version of this form: (1) Download a copy to your hard drive; (2) Open the saved blank copy; (3) Fill out the form; (4) Use the Save As command to rename the form appropriately and save; (5) Print and submit to SHSND.*

**NDCRS ARCHITECTURAL SITE FORM  
PAGE 5—SITE DESCRIPTION**

Field Code Lucy Township School

SITS# 32 BK

**6. Summary of ALL Site Features & Evaluation of Significance:**

**7. References/Comments:**

Kathy Wilner  
366 43rd Ave SE  
Bowdon ND 58418

Recorded By Kathy Wilner Date Recorded 1/29/2017  
(First Name & Last Name) (mm/dd/year)

*Instructions to complete a digital version of this form: (1) Download a copy to your hard drive; (2) Open the saved blank copy; (3) Fill out the form; (4) Use the Save As command to rename the form appropriately and save; (5) Print and submit to SHSND.*



East Side

Lucy Township School

8/21/2016

Kathy Wilner

BK

North Side





South Side

Lucy Township School

8/21/2016

Kathy Wilner

BK

West Side



bing maps

Notes

Lucy Township School

8/21/2016

Kathy Wilner

BK

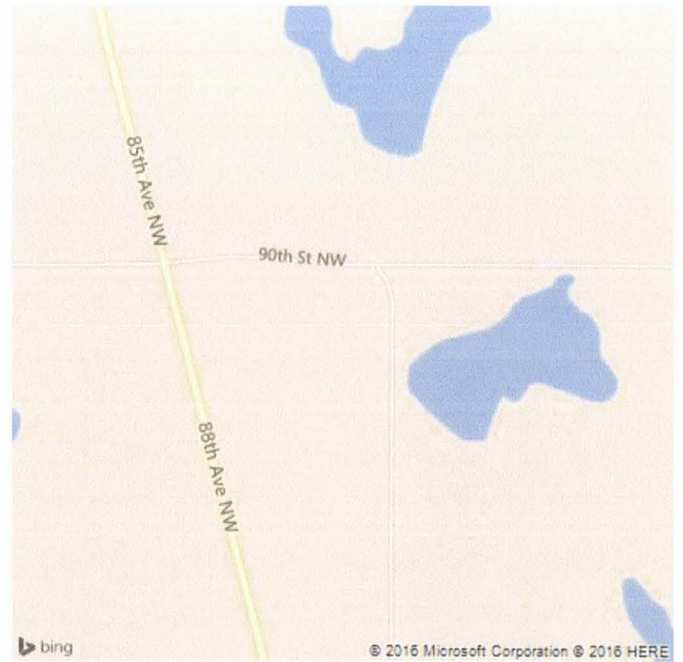

Feature