

# NDCRS ARCHITECTURAL SITE FORM

## PAGE 1

Field Code SX-EH-37

SITS# 32 BL X386

### SITE IDENTIFICATION

Map Quad Moffitt NW 1996 Site Name \_\_\_\_\_

Map Quad \_\_\_\_\_ Site Name \_\_\_\_\_

LTL	___TWP	<u>137</u>	R	<u>77</u>	SEC	<u>34</u>	QQQ	_____	QQ	<u>7</u>	Q	<u>8</u>
LTL	___TWP	<u>137</u>	R	<u>77</u>	SEC	<u>34</u>	QQQ	<u>1</u>	QQ	<u>8</u>	Q	<u>7</u>
LTL	___TWP	<u>137</u>	R	<u>77</u>	SEC	<u>33</u>	QQQ	<u>2</u>	QQ	<u>6</u>	Q	<u>5</u>
LTL	___TWP	<u>137</u>	R	<u>77</u>	SEC	<u>33</u>	QQQ	<u>5</u>	QQ	<u>5</u>	Q	<u>6</u>

NAD 1983, UTM 5175688 **N** ZONE 14N  
 NAD 1983, UTM 852375 **E**

Subsection:
1 = N $\frac{1}{2}$
2 = E $\frac{1}{2}$
3 = S $\frac{1}{2}$
4 = W $\frac{1}{2}$
5 = NE $\frac{1}{4}$
6 = SE $\frac{1}{4}$
7 = SW $\frac{1}{4}$
8 = NW $\frac{1}{4}$

City: \_\_\_\_\_

Street Number: \_\_\_\_\_

Street Name: \_\_\_\_\_

Urban Legal Description: \_\_\_\_\_

### SITE DATA

Total # **Architectural** Features: 8

Fieldwork Date: 09/15/2017

Reconnaissance Survey  Intensive Survey

Project & Principal Investigator:

PNE Wind Turbine Survey; William Harding

Report Title & Author(s):

A Class I and Class III Cultural Resource Inventory of 71 Wind Turbine Locations and Access Roads, Burleigh and Emmons Counties, North Dakota; Jolene Schleicher

Contracting firm or Agency completing the form:

SWCA Environmental Consultants

Additional Information:

Due to project landowner constraints, site lead could only be recorded from public right-of-way. Site lead sketch map is based on aerial photography.

<b>SHSND USE</b>				
Area of Significance <u>2</u>	Ecozone <u>19</u>	Verified Site <u>1</u>	CR Type <u>1</u>	
Area of Significance _____	Ecozone _____			
Area of Significance _____	Ecozone _____			

Recorded By Eileen Heideman Date Recorded 09/15/2017  
 (First Name & Last Name) (mm/dd/year)

## NDCRS ARCHITECTURAL SITE FORM PAGE 2—Feature Data

Field Code SX-EH-37SITS# 32 BL X

**Complete one Page 2 for each architectural feature at the site.**

Architectural Feature # 2

Construction Date \_\_\_\_\_

Feature Type 9Condition 4Feature Date 3Context 13Plan Shape 5Structural System 25Primary Exterior 26Style Other Style

Original Owner's Ethnicity \_\_\_\_\_

Secondary Exterior \_\_\_\_\_

Architect/Builder \_\_\_\_\_

Other Information: Feature 2 is a schoolhouse that has been converted into a garage.Foundation \_\_\_\_\_ Stories 1.0Roof/Cornice Gabled roof sheathed in sheet metalWindow Regularly spaced 4-over-4 double-hung wood sash on the east and west sides of the buildingDating Method(s): Professional judgement

**Feature Preservation Recommendation(s) (Check all that apply):**

 Individual nomination Contributes to a potential district No nomination potential Will not contribute to a district Potential district—feature would be a contributing element if other properties constitute a district Thematic nomination potential Component of a historic site or landscape

Moved (specify all applicable choices)—a) relocation occurred within a historic period; b) recreates original site, orientation, landscape, & spatial relationships; c) compatible in context with neighboring structures; d) relocation has damaged eligibility

Historical associations require further investigation

Recorded By Eileen Heideman Date Recorded 09/15/2017  
(First Name & Last Name) (mm/dd/year)

**NDCRS ARCHITECTURAL SITE FORM**  
**PAGE 3—Feature Data**

Field Code SX-EH-37SITS# 32 BL X**Complete a Page 3 for each feature.****1. Feature Description, Integrity, Eligibility:**

Feature 2 is a schoolhouse that has been converted into a garage. The schoolhouse has a similar lintel on its windows as those on the house and appears to date to the same time period (late nineteenth to early twentieth century). The building is a tall single-story, gable-roofed structure with regularly spaced four-over-four double-hung wood sash lighting the east and west sides of the building. These windows have been boarded over from the exterior, and one has been replaced with a paneled wood pedestrian door. An overhead track garage door has been added to the south side of the building, removing the original entrances and most of the vestibule. The building is clad with clapboard siding and roofed with corrugated aluminum. Paint in the south gable end reveals the former location of a fan-shaped sign or decoration.

Further research on the history of this property is recommended.

SX-EH-37 is a site lead that could not be fully recorded due to lack of permission to access the property. As such, SWCA recommends the site lead remain unevaluated regarding its National Register of Historic Places (NRHP) eligibility pending full recordation.

Recorded By Eileen Heideman Date Recorded 09/15/2017  
 (First Name & Last Name) (mm/dd/year)

**NDCRS ARCHITECTURAL SITE FORM  
PAGE 5—SITE DESCRIPTION**Field Code SX-EH-37SITS# 32 BL X386**6. Summary of ALL Site Features & Evaluation of Significance:**

This site consists of eight features: one late nineteenth/early twentieth century house (Feature 1), one schoolhouse that has been converted into a garage (Feature 2), one mid-twentieth century pole barn (Feature 3), five mid-twentieth century grain bins (Features 4, 6, 7, and 8), and one outhouse (Feature 5). Several corrals are also visible.

Further research on the history of this property is recommended.

SX-EH-37 is a site lead that could not be fully recorded due to lack of permission to access the property. As such, SWCA recommends the site lead remain unevaluated regarding its National Register of Historic Places (NRHP) eligibility pending full recordation.

**7. References/Comments:**

See continuation sheet

Recorded By Eileen Heideman Date Recorded 09/15/2017  
(First Name & Last Name) (mm/dd/year)

## NDCRS SITE FORM CONTINUATION PAGE

Field Code SX-EH-37

SITS# 32BLX

**Complete a *Continuation Page(s)* for information that does not fit in the space available on other sections of a Site Form.**

### HISTORIC BACKGROUND

SWCA conducted research to identify and locate records of any historic landowners, homesteads, trails, roads, stage stops, mines, or other historic entities within the project area that could fall under the Criteria of Eligibility for the NRHP. This research included a review of the 1884 General Land Office (GLO) survey map for T137N, R77W (North Dakota State Water Commission 2017) and a search of online GLO land patent records (BLM 2017).

The 1884 GLO map (North Dakota State Water Commission 2017) depicts no human-made features within Sections 33 and 34.

Land patent records indicate that two land patents were granted for lands containing the site lead, one in 1896 and the other in 1901 (BLM 2017) (Table 1). During the inventory, SWCA located no cultural resources that could be confidently associated with the patentees.

**Table 1. Summary of GLO Historic Land Patent Records for the Project Area**

Patentee Name	Year	Location (T/R/S)*	Patent Type	Accession Number
Northern Pacific Railroad Company	1896	137N/77W/33	Northern Pacific Railroad Grant	NDMTAA 003332
Elvin Hoover	1901	137N/77W/34	Homestead Entry-Original	ND1360_.021

Source: North Dakota State Water Commission (2017)

\* T/R/S = Township/Range/Section

**Recorded By** Eileen Heideman  
(First Name & Last Name)

**Date Recorded** 9/15/2017  
(mm/dd/year)

## NDCRS SITE FORM ATTACHMENTS SECTION

Field Code SX-EH-37

SITS# 32BLX

Complete one *Attachments Section* for the entire site. Include: Topographic map (with quad name and legal description), sketch map, photographs, and any other attachments.



**Figure 3. Feature 1, facing northwest.**



**Figure 4. Feature 2, facing northwest.**

**Recorded By** Eileen Heideman  
(First Name & Last Name)

**Date Recorded** 9/15/2017  
(mm/dd/year)

*Instructions to complete this form:* (1) Download ; (2) Save A Copy; (3) Submit a paper copy of the form to the SHSND and a PDF version of the form and corresponding GIS shapefiles to the FTP site of the SHSND.

# NDCRS SITE FORM ATTACHMENTS SECTION



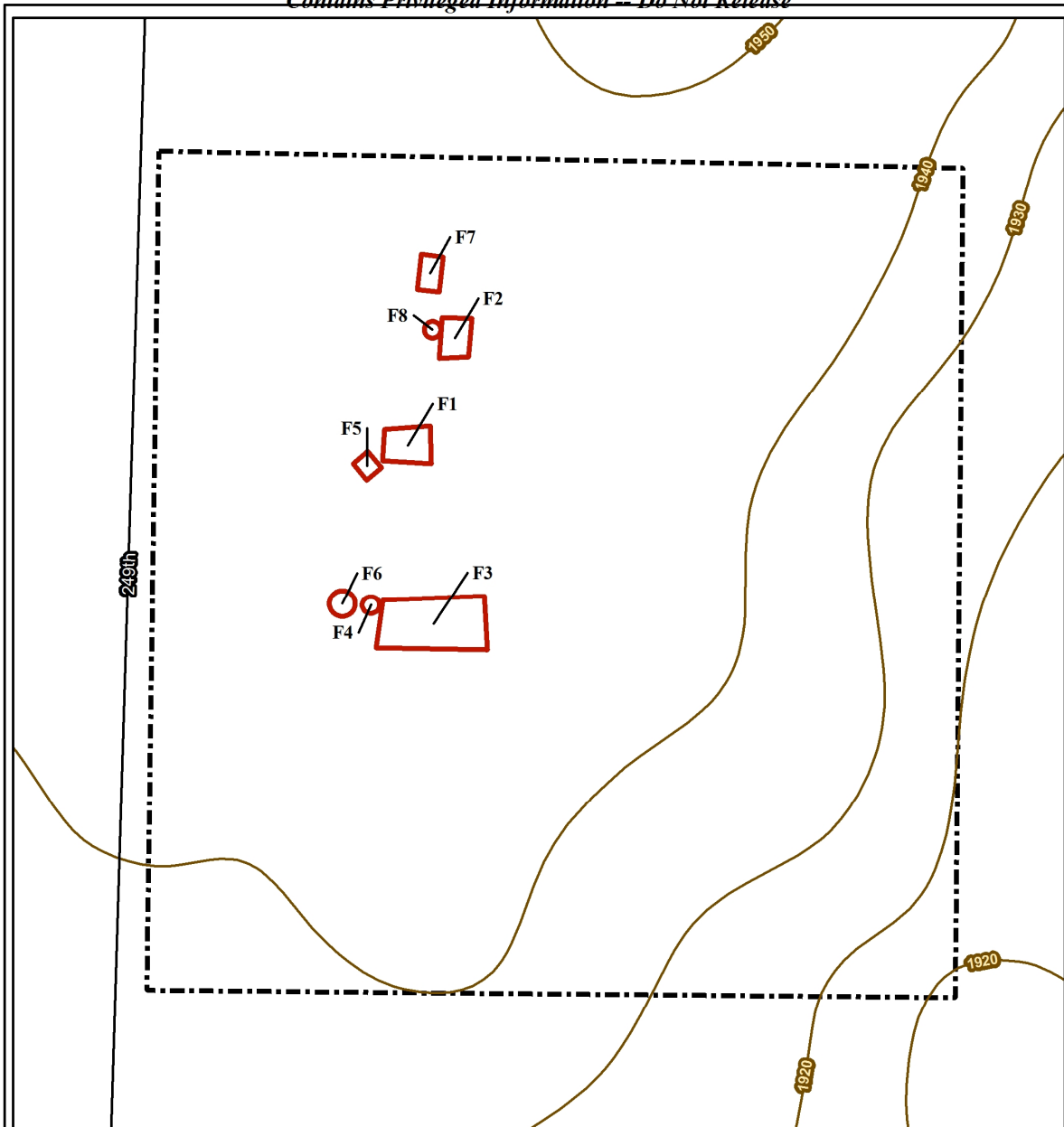

Field Code SX-EH-37

SITS# 32BLX

*Contains Privileged Information -- Do Not Release*



**SX-EH-37**

-  Existing Road
-  Contour Line (feet)
-  Site Boundary
-  Historical Feature

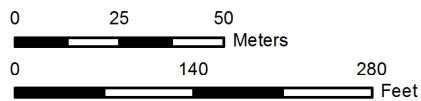

116 North 4th Street  
Suite 200  
Bismarck, ND 58501  
Phone: 701.258.6622  
Fax: 701.258.5957  
www.swca.com



**SX-EH-37 Site Sketch map**

**Recorded By** Eileen Heideman  
(First Name & Last Name)

**Date Recorded** 9/15/2017  
(mm/dd/year)

*Instructions to complete this form: (1) Download ; (2) Save A Copy; (3) Submit a paper copy of the form to the SHSND and a PDF version of the form and corresponding GIS shapefiles to the FTP site of the SHSND.*