

# NDCRS ARCHITECTURAL SITE FORM PAGE 1

SITS# 32 BU 188

### SITE IDENTIFICATION

Field Code Cordeilia Township Hall

Site Name Cordeilia Township School

Map Quad Lords Lake

Site Name Cordeilia Township Hall

Map Quad \_\_\_\_\_

LTL	TWP	<u>162</u>	R	<u>74</u>	SEC	<u>11</u>	QQQ	<u>8</u>	QQ	<u>8</u>	Q	<u>7</u>
LTL	TWP	_____	R	_____	SEC	_____	QQQ	_____	QQ	_____	Q	_____
LTL	TWP	_____	R	_____	SEC	_____	QQQ	_____	QQ	_____	Q	_____
LTL	TWP	_____	R	_____	SEC	_____	QQQ	_____	QQ	_____	Q	_____

UTM \_\_\_\_\_ N ZONE \_\_\_\_\_  
 UTM \_\_\_\_\_ E NAD 1927 \_\_\_\_\_ NAD 1983 \_\_\_\_\_

Subsection:
1 = N½
2 = E½
3 = S½
4 = W½
5 = NE¼
6 = SE¼
7 = SW¼
8 = NW¼

City: \_\_\_\_\_

Street Number: \_\_\_\_\_

Street Name: 22nd Ave NE

Urban Legal Description: \_\_\_\_\_

### SITE DATA

Total # *Architectural* Features: 1

Fieldwork Date: 6/16/2016

Reconnaissance Survey  Intensive Survey

Project Title & Supervisor:  
Country Schoolhouse Project

Report Title & Author(s):

Additional Information: \_\_\_\_\_

<b>SHSND USE</b>	<u>2</u>	Ecozone	<u>20</u>	Verified Site	<u>1</u>	CR Type	<u>2</u>
Area of Significance	_____	Ecozone	_____	Non-Site	_____		
Area of Significance	_____						

Recorded By Kathy Wilner Date Recorded 1/23/2017  
(First Name & Last Name) (mm/dd/year)

*Instructions to complete a digital version of this form:* (1) Download a copy to your hard drive; (2) Open the saved blank copy; (3) Fill out the form; (4) Use the Save As command to rename the form appropriately and save; (5) Print and submit to SHSND.

### NDCRS ARCHITECTURAL SITE FORM PAGE 2—Feature Data

Field Code Cordeilia Township Hall

SITS# 32 BU

**Complete one Page 2 for each architectural feature at the site.**

Architectural Feature # 1

Construction Date \_\_\_\_\_

Feature Type 9

Condition 6

Feature Date 3

Context 7

Plan Shape 5

Structural System 25

Primary Exterior 22

Style Other Style

Original Owner's Ethnicity \_\_\_\_\_

Secondary Exterior \_\_\_\_\_

Architect/Builder \_\_\_\_\_

Other Information:

Foundation Poured concrete Stories 1

Roof/Cornice Gable main body and entry

Window Multipane, double hung

Dating Method(s): estimate

**Feature Preservation Recommendation(s) (Check all that apply):**

Individual nomination

Contributes to a potential district

No nomination potential

Will not contribute to a district

Potential district—feature would be a contributing element if other properties constitute a district

Thematic nomination potential

Component of a historic site or landscape

Moved (specify all applicable choices)—a) relocation occurred within a historic period; b) recreates original site, orientation, landscape, & spatial relationships; c) compatible in context with neighboring structures; d) relocation has damaged eligibility

Historical associations require further investigation

Recorded By Kathy Wilner Date Recorded 1/23/2017  
(First Name & Last Name) (mm/dd/year)

*Instructions to complete a digital version of this form:* (1) Download a copy to your hard drive; (2) Open the saved blank copy; (3) Fill out the form; (4) Use the Save As command to rename the form appropriately and save; (5) Print and submit to SHSND.

**NDCRS ARCHITECTURAL SITE FORM  
PAGE 3—Feature Data**Field Code Cordeilia Township HallSITS# 32 BU**Complete a Page 3 for each feature.****1. Feature Description, Integrity, Eligibility:**

The feature is a one room prairie school on a poured concrete foundation. The building serves as a township meeting hall today. The gable roof of the school, entry, and small porch overhang are covered with asphalt shingles. The roofing is in pretty tough shape. There is a concrete block chimney near the east end at the peak of the roof. The soffits are closed. The building measures 24 feet east to west and 18 feet north to south with the entry measuring 12 feet north to south by 6 feet east to west.

The siding on this school is stucco. There is a small, double hung window on the west wall of the entry and a locked 5 panel wood door giving entry from a concrete step. A bank of 6 multipane, double hung windows on the south side has all glass intact. On the east side of the school are two more multipane, double hung windows. The interior walls and ceiling are wallboard. The floor is wide hardwood. There are chairs and a small table inside the building as well as a furnace near the east wall. Blackboards are either side of the 5 panel wood door that comes in from the entry. Another small blackboard is on the north 1/2 of the the east wall. Light switches, outlets and fixtures suggest electricity.

Recorded By Kathy Wilner Date Recorded 1/23/2017  
(First Name & Last Name) (mm/dd/year)

*Instructions to complete a digital version of this form:* (1) Download a copy to your hard drive; (2) Open the saved blank copy; (3) Fill out the form; (4) Use the Save As command to rename the form appropriately and save; (5) *Print* and submit to SHSND.

**NDCRS ARCHITECTURAL SITE FORM  
PAGE 4—SITE DESCRIPTION**

Field Code Cordeilia Township Hall

SITS# 32 BU

**Complete one Page 4 for the entire site.**

2. Owner's Contact Information:

Cordelia Township

3. Access (to rural areas):

East of Bottineau, on Highway 5, 9 miles to 22nd Ave NE. Turn left and go north 4 1/2 miles to see the school on your right. It is about 3/4 of a mile south of 101st St NE.

4. Site Area (ft<sup>2</sup>): \_\_\_\_\_

5. Description of **SETTING**:

Hilly and heavily wooded, in the Turtle Mountains.

Recorded By Kathy Wilner Date Recorded 1/23/2017  
(First Name & Last Name) (mm/dd/year)

*Instructions to complete a digital version of this form:* (1) Download a copy to your hard drive; (2) Open the saved blank copy; (3) Fill out the form; (4) Use the Save As command to rename the form appropriately and save; (5) *Print* and submit to SHSND.

**NDCRS ARCHITECTURAL SITE FORM  
PAGE 5—SITE DESCRIPTION**

Field Code Cordeilia Township Hall

SITS# 32 BU

**6. Summary of ALL Site Features & Evaluation of Significance:**

**7. References/Comments:**

Kathy Wilner  
366 43rd Ave SE  
Bowdon ND 58418

Recorded By Kathy Wilner Date Recorded 1/23/2017  
(First Name & Last Name) (mm/dd/year)

*Instructions to complete a digital version of this form: (1) Download a copy to your hard drive; (2) Open the saved blank copy; (3) Fill out the form; (4) Use the Save As command to rename the form appropriately and save; (5) Print and submit to SHSND.*



West Side

Cordellia Township Hall

6/16/2016

Kathy Wilner

BU

South Side





East side

Cordellia  
Township Hall

6162016

Kathy Wilner

BU

North Side



bing maps

Notes

Cordellia Town Hall

6/16/2016

Kathy Wilner

BU

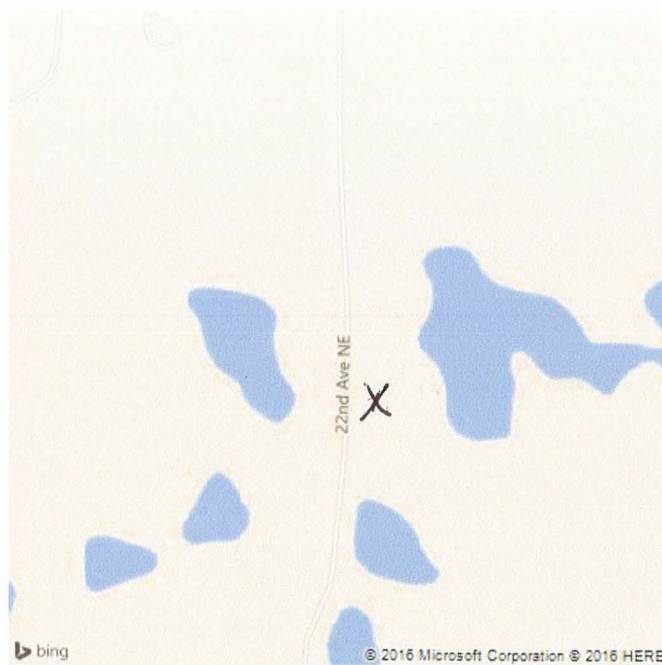

Feature