

NDCRS ARCHITECTURAL FORM

PAGE 1

UPDATE

Field Code Semerada School

SITS# 32DU 1657

Map Quad Manning NW

Site Name Semerada School

Map Quad _____

Site Name _____

LTL T. 142 N., R. 97 W., Sec. 1 QQQ 6 of the QQ 6 of the Q 6

LTL T. N., R. W., Sec. QQQ of the QQ of the Q

LTL T. N., R. W., Sec. QQQ of the QQ of the Q

LTL T. N., R. W., Sec. QQQ of the QQ of the Q

NAD 1983 UTM 5228156 Zone 14N

NAD UTM 203822

City: _____

Street Number: _____

Street Name: 19th St SW

Urban Legal Description: _____

Total Number of Architectural Features: 1

Fieldwork Date: 8/17/2021

Reconnaissance Survey

Intensive Survey

Project & Principal Investigator:

Country School House Project
Kathy Wilner
366 43rd Ave SE
Bowdon ND 58418

Contracting Firm or Agency Completing the Form:

Additional Information:

SHSND USE

Component _____ Study Unit _____ Verified Site _____ CR Type _____

Component _____

Component _____

Recorded By: Kathy Wilner Date Recorded: 10/21/2021

Form instructions: (1) Download; (2) Save A Copy; (3) Submit a paper copy of the form to the SHSND and upload the PDF version of the form and corresponding GIS shapefiles to the ND SHPO-run FTP site.

Subsection	
1	= N½
2	= E½
3	= S½
4	= W½
5	= NE¼
6	= SE¼
7	= SW¼
8	= NW¼

NDCRS ARCHITECTURAL FORM

PAGE 2 – Feature Data

UPDATE

Field Code Semerada School

SITS# 32 DU 1657

Complete one Page 2 for each architectural feature at the site.

Architectural Feature # 1

Construction Date _____

Feature Date 1915-1930

Structural System Wood Frame

Original Owner's Ethnicity _____

Feature Type 9 - School; Church school

Context Education

Primary Exterior Wood, Horizontal Siding

Secondary Exterior _____

Condition Fair

Plan Shape Rectangular

Style Other Style

Architect/Builder _____

Foundation Poured Concrete Stories 1

Roof/Cornice Gable

Window Double hung, glass

Dating Method(s) Previous documentation

Miscellaneous Information _____

Feature Preservation Recommendation(s) (Check all that apply):

Individual nomination

Contributes to a potential district

No nomination potential

Will not contribute to a district

Potential district—feature would be a contributing element if other properties constitute a district

Thematic nomination potential

Component of a historic site or landscape

Moved (specify all applicable choices)—a) relocation occurred within a historic period; b) recreates original site, orientation, landscape, and spatial relationships; c) compatible in context with neighboring structures; d) relocation has damaged eligibility

Historical associations require further investigation

Recorded By: Kathy Wilner Date Recorded: 10/21/2021

NDCRS ARCHITECTURAL FORM**PAGE 3 – Feature Data**

UPDATE

Field Code Semerada SchoolSITS# 32 DU 1657Complete one Page 3 for *each* architectural feature at the site.

1. Feature Description, Integrity, Eligibility:

The feature is a one room prairie school on a poured concrete foundation. The gable roof is mostly covered with wood shakes. Some have blown off. There are sections of the metal capping remaining with finials at both ends. The chimney has been covered with concrete blocks with a chimney pipe out the top. The soffits are closed.

The siding begins with a rake board under the eaves on the peak ends. The rest of the siding is 6 inch wood lap with 4 inch wood corner trim and waterboard at the bottom. There is no entry. A concrete step leads to a 5 panel wood door. Either side of the door are small windows. There are two covered windows on the west wall and four more double hung windows on the south wall with three of those covered and one open. There is some glass in the windows. The windows were boarded up to allow for grain storage. You enter a small coatroom that then leads into the main room of the school. Another small room in the northeast corner is accessed from the main school room. The walls have a variety of coverings, there is some lathe and plaster in the entry with the bottom third covered with laminate wallboard over wainscot. Inside the school room the walls are covered with a mixture of lathe and plaster and wall board. The ceiling is lathe and plaster with light fixtures present. The floor is tongue and groove hardwood. A blackboard runs along the north wall.

2. Owner's Contact Information:

David Semerada
3724 Morning View Dr.
Rapid City SD 57702

Recorded By: Kathy Wilner Date Recorded: 10/21/2021

NDCRS ARCHITECTURAL FORM**PAGE 4 – Site Description**

UPDATE

Field Code Semerada School**SITS# 32** DU 16573. Site Area (ft²):

4. Description of Access and Site Setting:

This school can be reached from Highway 22 north of Dickinson. At 20th St SW drive 2 1/2 miles to follow the curve to the northwest 1 mile, curve again to go west 3 miles on 19th St SW to see the school at the intersection with 114th Ave SW. There is a large cattle ranch south of the school and hay bales surround the building. Farm fields and pasture are other all directions.

5. Summary of ALL Site Features and Evaluation of Significance:

6. References/Comments:

Kathy Wilner
366 43rd Ave SE
Bowdon ND 58418

Recorded By: Kathy Wilner **Date Recorded:** 10/21/2021

Form instructions: (1) Download; (2) Save A Copy; (3) Submit a paper copy of the form to the SHSND and upload the PDF version of the form and corresponding GIS shapefiles to the ND SHPO-run FTP site.



East Side

Semerada School

8/17/2021

Kathy Wilner

DU

South
Side





West Side

Semerada School

8/17/2021

Kathy Wilner

DU

North
Side





Imagery ©2021 Maxar Technologies, USDA Farm Service Agency, Map data ©2021 200 ft

Feature

East of 116th Ave NW

NDCRS ARCHITECTURAL SITE FORM

Page 1

Field Code: UND-DCR11-MW1

SITS#: 32 DU 1657

SITE IDENTIFICATION

Map Quad	<u>Manning NW</u>	Site Name	<u></u>
Map Quad	<u></u>	Site Name	<u></u>
LTL	TWP <u>142</u> RNG <u>97</u> SEC <u>1</u> QQQ <u>6</u> QQ <u>6</u> Q <u>6</u>		
LTL	TWP <u></u> RNG <u></u> SEC <u></u> QQQ <u></u> QQ <u></u> Q <u></u>		
LTL	TWP <u></u> RNG <u></u> SEC <u></u> QQQ <u></u> QQ <u></u> Q <u></u>		
LTL	TWP <u></u> RNG <u></u> SEC <u></u> QQQ <u></u> QQ <u></u> Q <u></u>		
UTM	<u>5,228,156</u> N ZONE <u>14</u>		
	<u>203,822</u> E NAD 1927 <u></u> NAD 1983 <u>X</u>		

Subsection:

1 = N ½

2 = E ½

3 = S ½

4 = W ½

5 = NE ¼

6 = SE ¼

7 = SW ¼

8 = NW ¼

City:

Street Number:

Street Name:

Urban Legal Description:

SITE DATA

Total # Architectural Features: 1

Fieldwork Date: 07/10/2011

Reconnaissance Survey: Intensive Survey: X

Project Title & Supervisor: Dunn County Roads Survey No. 1, 2011. Michael A. Jackson, UND Anthropology Research.

Report Title & Author(s): Dunn County Roads 2011 Class III Cultural Resources Inventory, Dunn County, North Dakota: 20th Street SW, 19th Street SW, and 103rd Avenue SW. by Michael A. Jackson and Megan J. Lonski.

Additional Information:

SHSND USE

Area of Significance	<u>2</u>	Ecozone	<u>23</u>	Verified Site	<u>1</u>	CR Type	<u>2</u>
Area of Significance	<u>3</u>	Ecozone	<u></u>	Non-Site	<u></u>		
Area of Significance	<u></u>	Ecozone	<u></u>				

Recorded By: Megan Lonski & Mike Jackson Date Recorded: 09/13/2011

NDCRS ARCHITECTURAL SITE FORM

Page 2

Field Code: UND-DCR11-MW1

SITS#: 32 DU

FEATURE DATA

Architectural Feature # 1

Construction Date _____ Feature Type 9 Condition 5

Feature Date 4 Context 7 Plan Shape 5

Structural System 25 Primary Exterior 26 Style Other

Original Owner's Ethnicity 0 Secondary Exterior _____ Architect/Builder _____

Other Information: Style is remarkable only for its lack of ornamentation or distinctive stylistic elements.

Foundation Poured concrete Stories 1

Window Most original windows and openings intact

Roof/Cornice Gable

Dating Method(s) Professional estimate

Feature Preservation Recommendations(s) (Check all that apply)

Individual Nomination

Contributes to a potential district

No nomination potential

Will not contribute to a district

Potential District – feature would be a contributing element if other properties constitute a district

Thematic nomination potential

Component of a historic site or landscape

Moved (specify all applicable choices)—a) relocation occurred within a historic period; b) recreates original site, orientation, landscape, & spatial relationships; c) compatible in context with neighboring structures; d) relocation has damaged eligibility

Historical associations require further investigation

Recorded By: Megan Lonski & Mike Jackson Date Recorded: 09/13/2011

NDCRS ARCHITECTURAL SITE FORM

Page 3

Field Code: UND-DCR11-MW1

SITS#: 32 DU

FEATURE DATA

1. Feature Description, Integrity, Eligibility:

Feature 1: Schoolhouse

The feature is a standing schoolhouse in rural Dunn County, ND. The wood frame structure measures 26-ft 6-in east/west by 20-ft 4-in north/south and faces east. The 2-in by 4-in stud walls have been sheathed in 1-in by 4-in horizontal wood siding that has been painted white. This painted surface is heavily weathered and peeling.

East exposure: This is the building front. The east face of the building has a central panel construction wooden door with five recessed panels. The door measures 34-in wide by 80-in high and has the original knob and hardware. The door and door frame are intact and in fair condition. Two identical windows flank this central door. The windows measure 2-ft 4-in wide by 2-ft high. The glass in these windows has been removed and window screen has been installed. The window frames are slightly deteriorated along the bottom sill.

South exposure: The south face of the building has four larger windows with separate frames. These windows measure 5-ft 4-in high by 2-ft 6-in wide and are of undetermined type. Three of the windows have been covered with corrugated metal panels. Some glass panes are missing and the bottom sills of the windows are completely without paint. The frames are in fair condition overall.

West exposure: There are two window openings on the west facing wall. These windows have been boarded over and are of undetermined type. The condition of the windows or frames is unknown.

North exposure: There are no doors or windows in the north face of the building.

Roof: The roof of the building has been covered in wood shingles that are in fair condition. The shingles are largely intact. The chimney located at the peak of the gable roof has been repaired with two modern concrete cinder blocks and a ceramic stack on top of the original courses of red brick.

Foundation: The schoolhouse sits on a poured concrete foundation.

Interior: The school is divided into three rooms. A small entryway, in the southeast corner of the building, opens into the main classroom area. A small office or coat room is located in the northeast corner of the building. The chalkboard and several school desks remain inside the building. Sheets of 4-ft by 8-ft laminate bathroom wallboard have been attached to the base of the walls. One-to-two feet of wheat seed covers the floor of the main room and the office/coat room. It appears the wallboard has been used to reinforce the base of the walls, so that the abandoned school could be made useful as a granary. The original light fixtures are present.

The integrity of the feature is fair. The use of the building as a granary has undoubtedly impacted the structure but the degree of impact cannot easily be assessed. The building feature retains many original features including windows, doors, roof, lights, school desks, and a chalkboard. The building is structurally sound and may contribute important information regarding rural settlement and educational practices in the region.

Recorded By: Megan Lonski & Mike Jackson Date Recorded: 09/13/2011

NDCRS ARCHITECTURAL SITE FORM

Page 4

Field Code: UND-DCR11-MW1

SITS#: 32 DU

SITE DESCRIPTION

2. Owner's Contact Information: Unknown.

3. Access (rural areas): From the southern border of Dunn County, ND, north of Dickinson, ND, travel on Highway 22 for 10.25 miles. Turn left (west) and continue on 20th St. SW for 2.6 miles. Continue on the gravel road for 1.1 miles as it trends north and northwest and turns to 19th St. SW. Drive west on 19th St. SW for 2.9 miles. The schoolhouse is located to the north of the road. A dirt road allows access up to the building. See the attached maps for additional location details.

4. Site Area (ft²): 16,900

5. Site Description: The site consists of a standing rural schoolhouse and an associated concrete foundation. Details regarding the foundation are outlined in the following historical archeological form. The site area lies in the extreme southeast corner of T142/N/R97W/SCT1. This area is currently being used by a local farmer as a hay yard. The area lies in the rolling uplands above a creek drainage, to the east. There were no associated historic artifacts noted within the site area.

6. Summary of All Site Features & Evaluation of Site Significance: The schoolhouse feature is largely original and retains integrity of materials, location, and workmanship. The structure has been impacted by use of the building as a granary. The extent of this damage is unknown. The foundation feature is likely recent and retains good integrity though it likely lacks any historical associations of note. The site is currently unevaluated in terms of NRHP eligibility. A rural schoolhouse in good condition may contribute to our understanding of the early rural settlement of the area. The historical associations of the building should be further investigated to determine any associations with notable events or personalities.

7. References/Comments: The site location is located within the area of potential effect (APE) of a road improvement project along 19th Street SW. It is recommended that site features be avoided by all construction activities.

Recorded By: Megan Lonski & Mike Jackson Date Recorded: 09/13/2011

NDCRS ARCHITECTURAL SITE FORM

Page 5

Field Code: UND-DCR11-MW1

SITS#: 32 DU

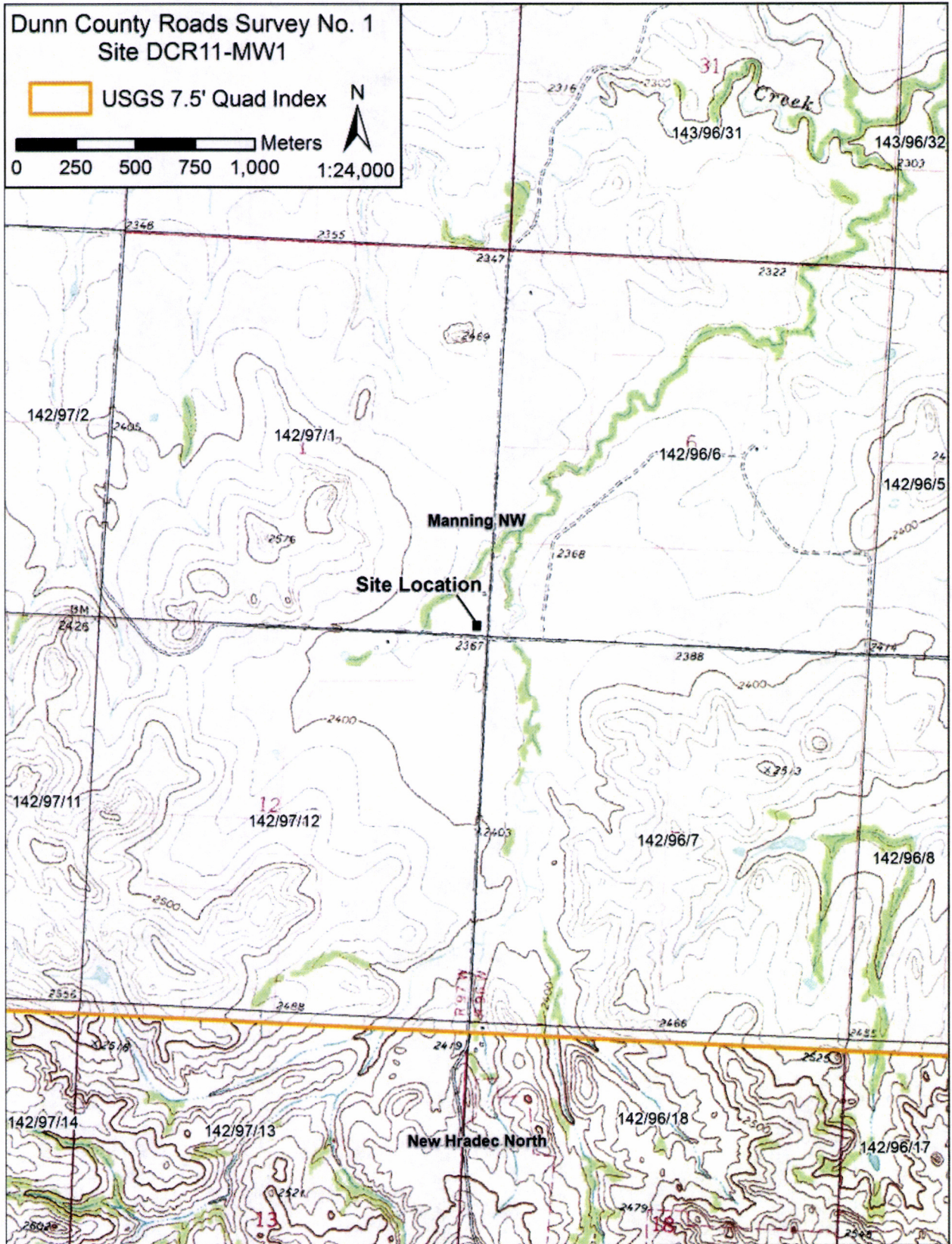

Recorded By: Megan Lonski & Mike Jackson Date Recorded: 09/13/2011

NDCRS ARCHITECTURAL SITE FORM

Field Code: UND-DCR11-MW1

SITS#: 32 DU

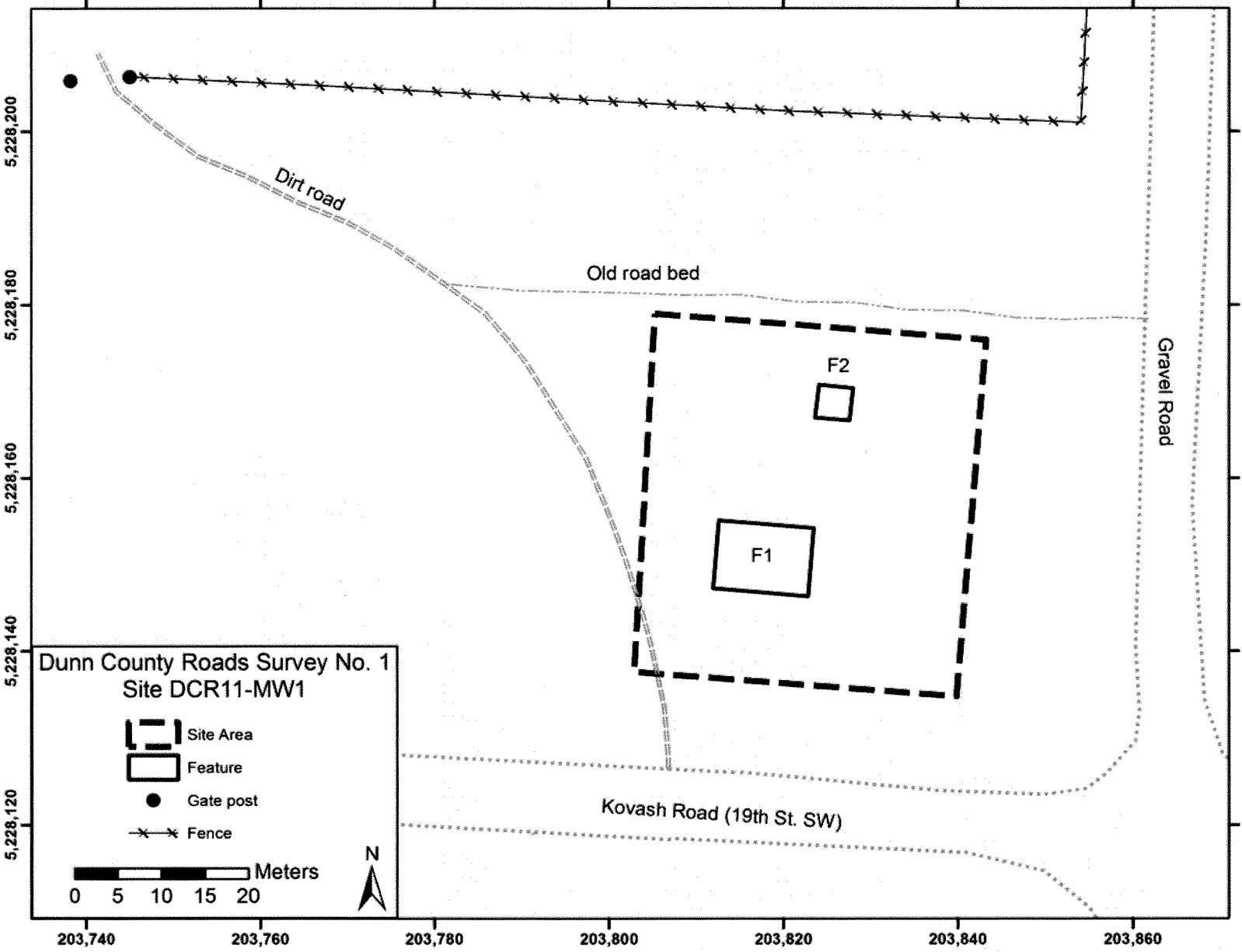

Recorded By:

Megan Lonski & Mike Jackson

Date Recorded:

09/13/2011

NDCRS ARCHITECTURAL SITE FORM
Page 7

Field Code: UND-DCR11-MW1

SITS#: 32 DU



Site overview (View WNW; UW2582-119).



Feature 1 schoolhouse, front-side oblique view (View NW; UW2582-099).

Recorded By: Megan Lonski & Mike Jackson Date Recorded: 09/13/2011

NDCRS ARCHITECTURAL SITE FORM

Page 8

Field Code: UND-DCR11-MW1

SITS#: 32 DU



Feature 1 schoolhouse, rear-side oblique view (View SE; UW2582-104).



Interior of Feature 1 schoolhouse. West and north walls with chalkboard and boarded-up window. (View NW; UW2582-088).

Recorded By: Megan Lonski & Mike Jackson Date Recorded: 09/13/2011