

NDCRS ARCHITECTURAL FORM

PAGE 1

UPDATE

Field Code Tell Township School

SITS# 32EM 942

Map Quad Schell Buttes NW

Site Name Tell Township School

Map Quad \_\_\_\_\_

Site Name \_\_\_\_\_

LTL    T. 135 N., R. 74 W., Sec. 27 QQQ 5 of the QQ 5 of the Q 6

LTL    T.    N., R.    W., Sec.    QQQ    of the QQ    of the Q   

LTL    T.    N., R.    W., Sec.    QQQ    of the QQ    of the Q   

LTL    T.    N., R.    W., Sec.    QQQ    of the QQ    of the Q   

NAD 1983 UTM 5147771 Zone 14N

NAD 1983 UTM 426381

Subsection
1 = N½
2 = E½
3 = S½
4 = W½
5 = NE¼
6 = SE¼
7 = SW¼
8 = NW¼

City: \_\_\_\_\_

Street Number: \_\_\_\_\_

Street Name: 22nd Ave SE

Urban Legal Description: \_\_\_\_\_

Total Number of Architectural Features: 1

Fieldwork Date: 10/7/2021

Reconnaissance Survey

Intensive Survey

Project & Principal Investigator:

Country School House Project  
Kathy Wilner  
366 43rd Ave SE  
Bowdon ND 58418

Contracting Firm or Agency Completing the Form:

Additional Information:

SHSND USE

Component \_\_\_\_\_ Study Unit \_\_\_\_\_ Verified Site \_\_\_\_\_ CR Type \_\_\_\_\_

Component \_\_\_\_\_

Component \_\_\_\_\_

Recorded By: Kathy Wilner Date Recorded: 11/9/2021

Form instructions: (1) Download; (2) Save A Copy; (3) Submit a paper copy of the form to the SHSND and upload the PDF version of the form and corresponding GIS shapefiles to the ND SHPO-run FTP site.

NDCRS ARCHITECTURAL FORM  
PAGE 2 – Feature Data

Field Code Tell Township School

SITS# 32 EM 942

Complete one Page 2 for each architectural feature at the site.

Architectural Feature # 1

Construction Date \_\_\_\_\_

Feature Date 1900-1915

Structural System Wood Frame

Original Owner's Ethnicity \_\_\_\_\_

Feature Type 9 - School; Church school

Context Education

Primary Exterior Wood, Horizontal Siding

Secondary Exterior \_\_\_\_\_

Condition Good

Plan Shape Rectangular

Style Other Style

Architect/Builder \_\_\_\_\_

Foundation Poured Concrete Stories 1

Roof/Cornice Gable

Window Replacements

Dating Method(s) Estimate

Miscellaneous Information \_\_\_\_\_

**Feature Preservation Recommendation(s) (Check all that apply):**

- Individual nomination
- Contributes to a potential district
- No nomination potential
- Will not contribute to a district
- Potential district—feature would be a contributing element if other properties constitute a district
- Thematic nomination potential
- Component of a historic site or landscape
- Moved (specify all applicable choices)—a) relocation occurred within a historic period; b) recreates original site, orientation, landscape, and spatial relationships; c) compatible in context with neighboring structures; d) relocation has damaged eligibility
- Historical associations require further investigation

Recorded By: Kathy Wilner Date Recorded: 11/9/2021

Form instructions: (1) Download; (2) Save A Copy; (3) Submit a paper copy of the form to the SHSND and upload the PDF version of the form and corresponding GIS shapefiles to the ND SHPO-run FTP site.

**NDCRS ARCHITECTURAL FORM  
PAGE 3 – Feature Data****Field Code** Tell Township School**SITS#** 32 **EM** 942**Complete one Page 3 for each architectural feature at the site.****1. Feature Description, Integrity, Eligibility:**

The feature is a one room prairie school on a poured concrete and rock foundation. The gable roof is covered with failing asphalt shingles. A yellow brick chimney sits on the west slope near the south end of the school. The soffits are open. The building measures 30 feet north to south and 16 feet east to west.

The siding begins with a rake board under the eaves at the peak ends of the school. The remainder of the siding is 6 inch wood lap with 6 inch wood corner trim. There are two small, replacement windows on the west side. On the south side there is a shuttered window opening to the right of the entry door. The locked entry door is a sheet of plywood. There is a transom above the door with three small square pieces of glass. No information about the interior.

**2. Owner's Contact Information:**

Edward and Sharon Jutila  
2260 64th At SE  
Kintyre ND 58549

**Recorded By:** Kathy Wilner **Date Recorded:** 11/9/2021

**NDCRS ARCHITECTURAL FORM**  
**PAGE 4 – Site Description****Field Code** Tell Township School**SITS# 32** EM 9423. Site Area (ft<sup>2</sup>):

4. Description of Access and Site Setting:

Access to this school is from Kintyre ND. Go south from Kintyre on 22nd Ave SE 4 and 1/2 miles. At the point where Hwy 34 curves to the west continue south another 1/2 mile. the school is on the west side of the road. There is a farm site to the east and fields all directions.

5. Summary of ALL Site Features and Evaluation of Significance:

6. References/Comments:

Kathy Wilner  
366 43rd Ave SE  
Bowdon ND 58418

**Recorded By:** Kathy Wilner **Date Recorded:** 11/9/2021

Form instructions: (1) Download; (2) Save A Copy; (3) Submit a paper copy of the form to the SHSND and upload the PDF version of the form and corresponding GIS shapefiles to the ND SHPO-run FTP site.



East Side

Tell Township School

10/7/2021

Kathy Wilner

EM

North Side





**West Side**

Tell Township School

10/7/2021

Kathy Wilner

EM

**South Side**



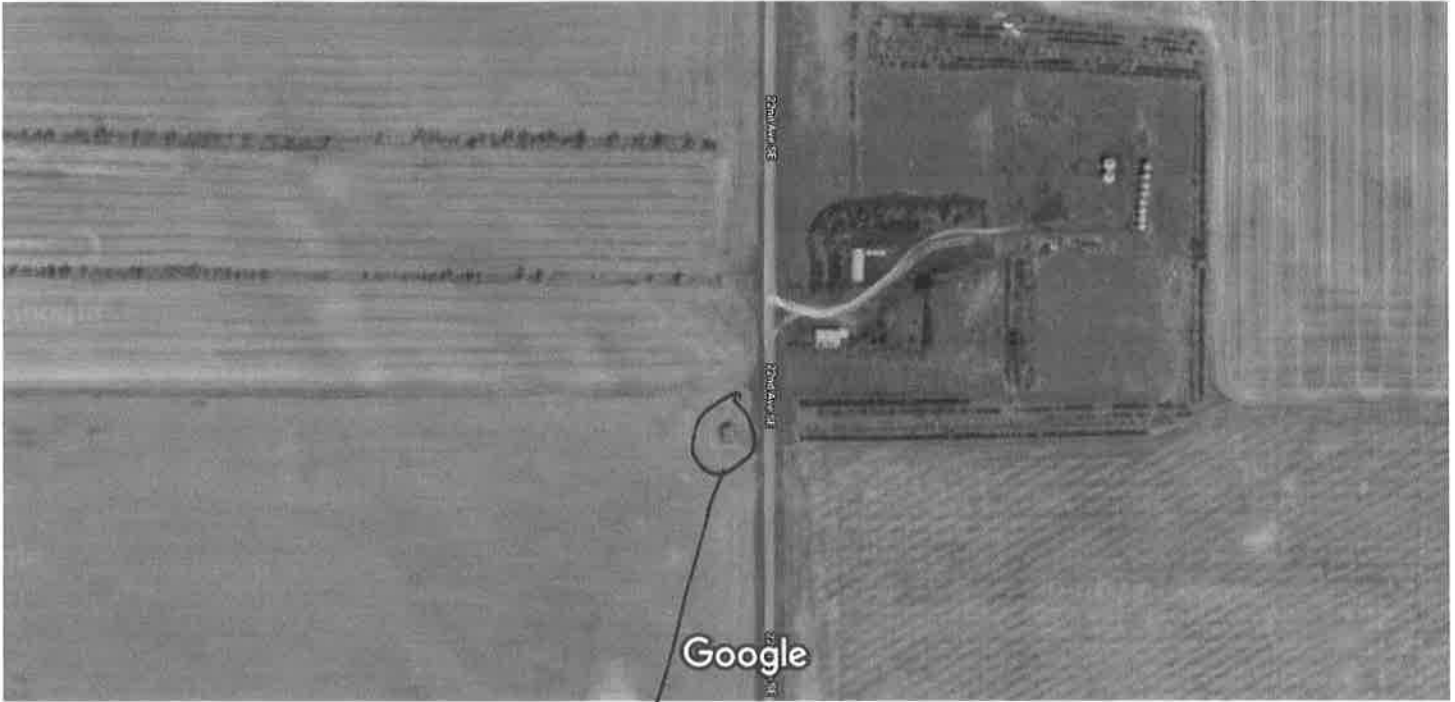

Imagery ©2021 Maxar Technologies, USDA Farm Service Agency, Map data ©2021 200 ft

Feature

SITS # 3.2 EM 94.2  
State County Site Number

Field Code C.R.M. 26.2-24 Site Name \_\_\_\_\_  
Field Code 1.3.5.7.4-27-1 Site Name \_\_\_\_\_

Map Quad Sch. 1.1, Buttes, NW  
Map Quad \_\_\_\_\_

LTL	<input type="checkbox"/>	Twp	<u>13.5</u>	R	<u>7.4</u>	Sec	<u>27</u>	QQQ	<u>5</u>	QQ	<u>5</u>	Q	<u>6</u>
LTL	<input type="checkbox"/>	Twp	_____	R	_____	Sec	_____	QQQ	_____	QQ	_____	Q	_____
LTL	<input type="checkbox"/>	Twp	_____	R	_____	Sec	_____	QQQ	_____	QQ	_____	Q	_____
LTL	<input type="checkbox"/>	Twp	_____	R	_____	Sec	_____	QQQ	_____	QQ	_____	Q	_____
LTL	<input type="checkbox"/>	Twp	_____	R	_____	Sec	_____	QQQ	_____	QQ	_____	Q	_____
LTL	<input type="checkbox"/>	Twp	_____	R	_____	Sec	_____	QQQ	_____	QQ	_____	Q	_____

1. N
2. E
3. S
4. W
5. NE
6. SE
7. SW
8. NW
9. C

SITE DATA

City \_\_\_\_\_  
Street # \_\_\_\_\_ Street # \_\_\_\_\_  
Street Name \_\_\_\_\_ Street Name \_\_\_\_\_  
# of Features 1

FEATURE DATA

1 Feature #      9 Feature Type      6 Condition  
\_\_\_\_\_ Const Date      7 Context      ~~7 Significance~~  
5 Feature Date      3 Plan Shape

PORCH

Original  
 Addition/Altered  
 Removed/None

BUILDING MATERIALS

25 Structure System      ~~3 Main Entrance~~  
26 Primary Exterior Finish  
\_\_\_\_\_ Secondary Exterior Finish

\_\_\_\_\_ Ethnic  
14 Style

\_\_\_\_\_ Builder  
\_\_\_\_\_ Engineer  
\_\_\_\_\_ Designer Architect

120187 Fieldwork Date

Other Information \_\_\_\_\_

\_\_\_\_\_ Soil Association 19 Ecozone 2 Area Signf      \_\_\_\_\_ MS Number  
\_\_\_\_\_ Soil Association \_\_\_\_\_ Ecozone \_\_\_\_\_ Area Signf      \_\_\_\_\_ MS Number  
3 CR Type      1 Verified Site      \_\_\_\_\_ Non-Site      3 E C F      3 T F  
\_\_\_\_\_ State Registry      \_\_\_\_\_ National Register

Coder Schweigert

Date Coded 1/9/89

SITE I.D.  
SITE DATA  
FEATURE DATA  
SHSND USE



NDCRS ARCHITECTURAL SITE FORM  
Page 2

Field Code CRM 262-24

SITS NUMBER \_\_\_\_\_

FEATURE # 1 NAME IN NAME BLOCK \_\_\_\_\_

<u>BASEMENT</u>	<u>FOUNDATION MATERIALS</u>	<u>STORIES</u>	<u>CORNICE</u>	<u>ROOF TYPE</u>	<u>DATING METHOD</u>
<input type="checkbox"/> yes	<input type="checkbox"/> Brick	<input checked="" type="checkbox"/> 1	<input type="checkbox"/> Metal	<input checked="" type="checkbox"/> Gable	<input type="checkbox"/> Plat Map(s)
<input checked="" type="checkbox"/> no	<input type="checkbox"/> Concrete Block	<input type="checkbox"/> 1 1/2	<input type="checkbox"/> Brick	<input type="checkbox"/> Hipped	<input type="checkbox"/> County Atlas
<input type="checkbox"/> unknown	<input type="checkbox"/> Fieldstone	<input type="checkbox"/> 2	<input checked="" type="checkbox"/> None	<input type="checkbox"/> Deck	<input type="checkbox"/> Date Block
<input type="checkbox"/> other	<input type="checkbox"/> Cut Stone	<input type="checkbox"/> 2 1/2	<input type="checkbox"/> Wood	<input type="checkbox"/> Gambrel	<input type="checkbox"/> Sanborn Map(s)
	<input checked="" type="checkbox"/> Poured Concrete	<input type="checkbox"/> 3	<input type="checkbox"/> Other	<input type="checkbox"/> Flat	<input type="checkbox"/> Topo Map(s)
	<input type="checkbox"/> Refaced	<input type="checkbox"/> Other		<input type="checkbox"/> Other	<input checked="" type="checkbox"/> Other
<u>WINDOWS</u>	<input type="checkbox"/> Unknown				<u>Photo Judgment</u>
<input type="checkbox"/> Original	<input type="checkbox"/> Other				
<input checked="" type="checkbox"/> Altered					

FEATURE DESCRIPTION & STATEMENT OF INTEGRITY \_\_\_\_\_

SIGNIFICANCE

SIGNIFICANT

NOT SIGNIFICANT

- |   |   |   |
|---|---|---|
| <input type="checkbox"/> Work of Master                               | <input type="checkbox"/> Visual Landmark                    | <input type="checkbox"/> Too new                      |
| <input type="checkbox"/> High Artistic Values                         | <input type="checkbox"/> Associated with significant event  | <input checked="" type="checkbox"/> Lacking integrity |
| <input type="checkbox"/> Rep. of type, period, method of construction | <input type="checkbox"/> Associated with devel. of locality | <input checked="" type="checkbox"/> Not High Style    |
| <input type="checkbox"/> Other _____                                  | <input type="checkbox"/> Associated with significant person | <input type="checkbox"/> Other _____                  |

JUSTIFICATION OF SIGNIFICANCE \_\_\_\_\_

Recorded by Schweigert

Date 12/01/87

NDCRS ARCHEOLOGICAL AND HISTORICAL SITE FORMS

Field Code 13574-27-1 Photo

SITS Number \_\_\_\_\_

