

NDCRS ARCHITECTURAL FORM

PAGE 1

UPDATE

Field Code Wilson Township School

SITS# 32EM 998

Map Quad Schell buttes NW

Site Name Wilson Township School

Map Quad _____

Site Name _____

LTL T. 134 N., R. 74 W., Sec. 13 QQQ 7 of the QQ 7 of the Q 8

LTL T. N., R. W., Sec. QQQ of the QQ of the Q

LTL T. N., R. W., Sec. QQQ of the QQ of the Q

LTL T. N., R. W., Sec. QQQ of the QQ of the Q

NAD 1983 UTM 5141325 Zone 14N

NAD 1983 UTM 427993

| |
|------------|
| Subsection |
| 1 = N½ |
| 2 = E½ |
| 3 = S½ |
| 4 = W½ |
| 5 = NE¼ |
| 6 = SE¼ |
| 7 = SW¼ |
| 8 = NW¼ |

City: _____

Street Number: _____

Street Name: 23rd Ave SE

Urban Legal Description: _____

Total Number of Architectural Features: 1

Fieldwork Date: 10/7/2021

Reconnaissance Survey

Intensive Survey

Project & Principal Investigator:

Country School House Project
Kathy Wilner
366 43rd Ave SE
Bowdon ND 58418

Contracting Firm or Agency Completing the Form:

Additional Information:

SHSND USE

Component _____ Study Unit _____ Verified Site _____ CR Type _____

Component _____

Component _____

Recorded By: Kathy Wilner Date Recorded: 11/9/2021

Form instructions: (1) Download; (2) Save A Copy; (3) Submit a paper copy of the form to the SHSND and upload the PDF version of the form and corresponding GIS shapefiles to the ND SHPO-run FTP site.

NDCRS ARCHITECTURAL FORM
PAGE 2 – Feature Data

Field Code Wilson Township School

SITS# 32 EM 998

Complete one Page 2 for each architectural feature at the site.

Architectural Feature # 1

Construction Date _____

Feature Date 1900-1915

Structural System Wood Frame

Original Owner's Ethnicity _____

Feature Type 9 - School; Church school

Context Education

Primary Exterior Wood, Horizontal Siding

Secondary Exterior _____

Condition Poor

Plan Shape Rectangular

Style Other Style

Architect/Builder _____

Foundation Poured concrete Stories 1

Roof/Cornice Gable

Window Two double hung without glass, more replacement windows

Dating Method(s) Previous documentation

Miscellaneous Information _____

Feature Preservation Recommendation(s) (Check all that apply):

- Individual nomination
- Contributes to a potential district
- No nomination potential
- Will not contribute to a district
- Potential district—feature would be a contributing element if other properties constitute a district
- Thematic nomination potential
- Component of a historic site or landscape
- Moved (specify all applicable choices)—a) relocation occurred within a historic period; b) recreates original site, orientation, landscape, and spatial relationships; c) compatible in context with neighboring structures; d) relocation has damaged eligibility
- Historical associations require further investigation

Recorded By: Kathy Wilner Date Recorded: 11/9/2021

NDCRS ARCHITECTURAL FORM
PAGE 3 – Feature Data

Field Code Wilson Township School

SITS# 32 **EM** 998

Complete one Page 3 for each architectural feature at the site.

1. Feature Description, Integrity, Eligibility:

This story of this school is told in previous documentation. It is largely unchanged from 2018.

2. Owner's Contact Information:

Justin and Jenna Weigel
6880 23rd Ave SE
Kintyre ND 58549

Recorded By: Kathy Wilner **Date Recorded:** 11/9/2021

NDCRS ARCHITECTURAL FORM
PAGE 4 – Site Description**Field Code** Wilson Township School**SITS# 32** EM 9983. Site Area (ft²):

4. Description of Access and Site Setting:

Access to this school is from Kintyre on 22nd Ave SE. Go south of Kintyre 8 miles to 68th St SE. Turn left and go east 1 miles to 23rd Ave SE. Turn right and go south 1/2 mile to see the school on the east side of the road. Trees to the south of the school hide a farm, there is another farm north and farm fields all directions.

5. Summary of ALL Site Features and Evaluation of Significance:

6. References/Comments:

Kathy Wilner
366 43rd Ave SE
Bowdon ND 58418

Recorded By: Kathy Wilner **Date Recorded:** 11/9/2021

Form instructions: (1) Download; (2) Save A Copy; (3) Submit a paper copy of the form to the SHSND and upload the PDF version of the form and corresponding GIS shapefiles to the ND SHPO-run FTP site.



East Side

Wilson Township School

10/7/2021

Kathy Wilner

EM

North Side





South Side

Wilson Township School

10/7/2021

Kathy Wilner

EM

West Side

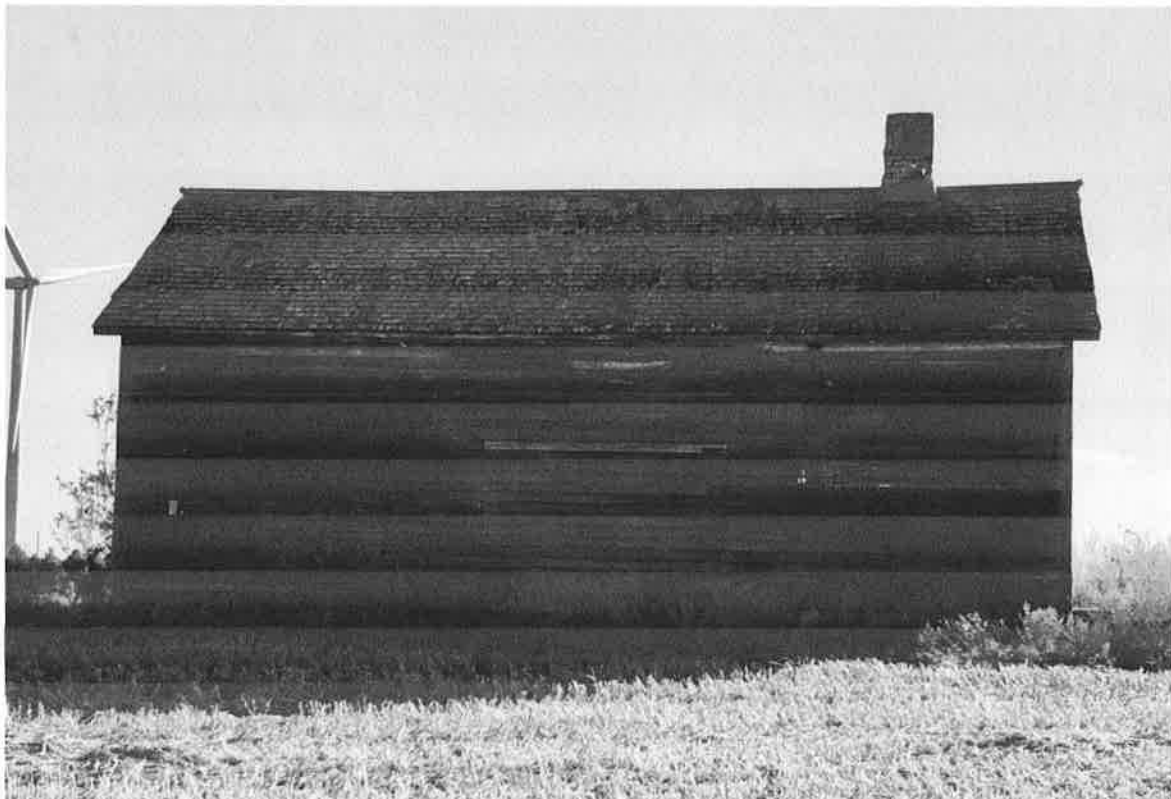

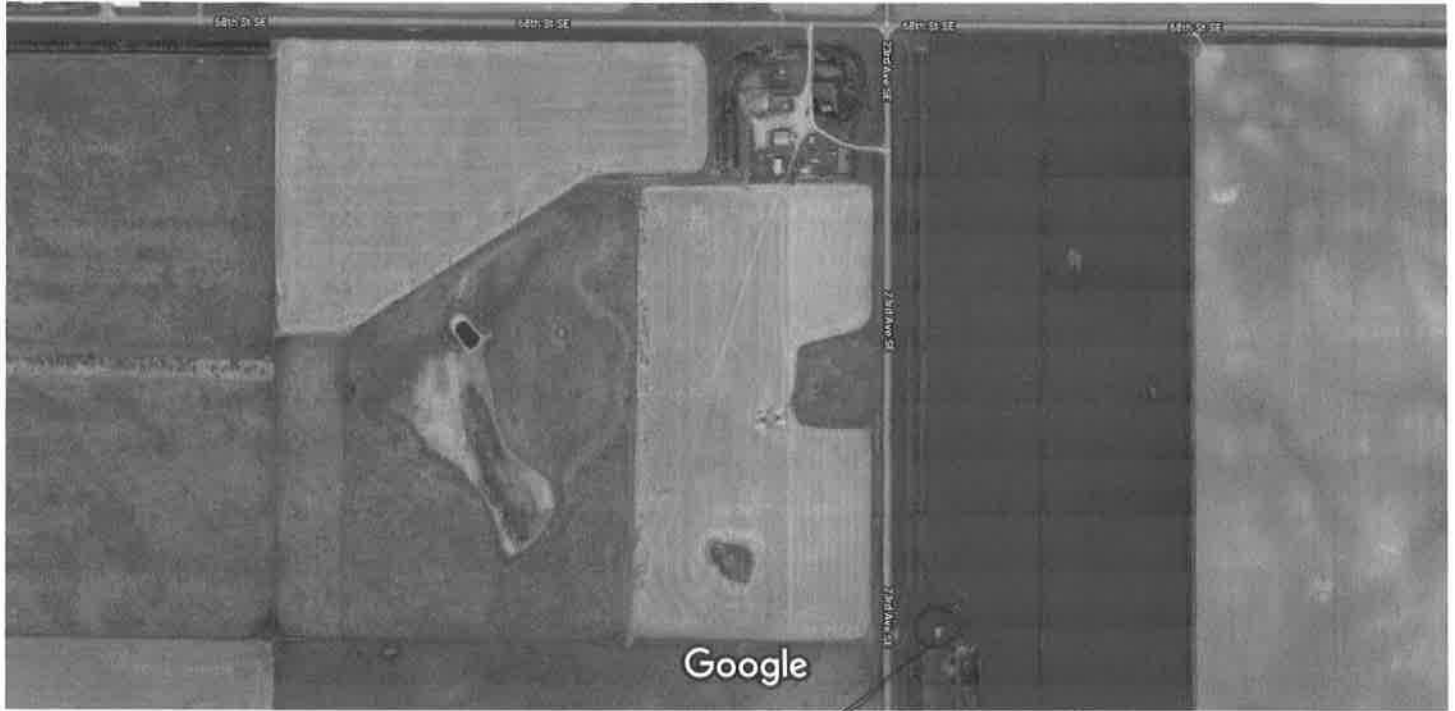

Imagery ©2021 Maxar Technologies, USDA Farm Service Agency, Map data ©2021 500 ft

Feature

NDCRS ARCHITECTURAL SITE FORM

PAGE 1

UPDATE

Field Code EL1-134-ARCH

SITS# 32 EM 998

SITE IDENTIFICATION

Map Quad Schell Buttes NW Site Name _____

Map Quad _____ Site Name _____

| | | | | | | | | | | | | |
|-----|--------|------------|---|-----------|-----|-----------|-----|----------|----|----------|---|----------|
| LTL | ___TWP | <u>134</u> | R | <u>74</u> | SEC | <u>13</u> | QQQ | <u>7</u> | QQ | <u>7</u> | Q | <u>8</u> |
| LTL | ___TWP | _____ | R | _____ | SEC | _____ | QQQ | _____ | QQ | _____ | Q | _____ |
| LTL | ___TWP | _____ | R | _____ | SEC | _____ | QQQ | _____ | QQ | _____ | Q | _____ |
| LTL | ___TWP | _____ | R | _____ | SEC | _____ | QQQ | _____ | QQ | _____ | Q | _____ |

NAD 1983, UTM 5141324 **N** ZONE 14N
 NAD 1983, UTM 427989 **E**

| |
|-------------|
| Subsection: |
| 1 = N½ |
| 2 = E½ |
| 3 = S½ |
| 4 = W½ |
| 5 = NE¼ |
| 6 = SE¼ |
| 7 = SW¼ |
| 8 = NW¼ |

City: _____

Street Number: _____

Street Name: 23rd Ave SE

Urban Legal Description: _____

SITE DATA

Total # **Architectural** Features: 1

Fieldwork Date: 02/02/2018

Reconnaissance Survey Intensive Survey

Project & Principal Investigator:

Emmons-Logan Wind Energy Center; Melinda McCarthy

Report Title & Author(s):

A Class II Architecture Survey - Emmons-Logan Wind Energy Center in Emmons and Logan Counties, North Dakota; Melinda McCarthy, Thomas Eiceman, & Marcia Bender

Contracting firm or Agency completing the form:

AECOM

Additional Information:

SHSND USE

| | | | |
|-------------------------------|-------------------|------------------------|------------------|
| Area of Significance <u>2</u> | Ecozone <u>19</u> | Verified Site <u>1</u> | CR Type <u>2</u> |
| Area of Significance _____ | Ecozone _____ | | |
| Area of Significance _____ | Ecozone _____ | | |

Recorded By Melinda McCarthy Date Recorded 02/02/2018
 (First Name & Last Name) (mm/dd/year)

NDCRS ARCHITECTURAL SITE FORM
PAGE 2—Feature Data

UPDATE

Field Code EL1-134-ARCH

SITS# 32 EM 998

Complete one Page 2 for each architectural feature at the site.

Architectural Feature # 1

Construction Date Feature Type 9 Condition 4
Feature Date 3 Context 30 Plan Shape 5
Structural System 25 Primary Exterior 25 Style Gabled Front: L/T
Original Owner's Ethnicity Secondary Exterior N/A Architect/Builder

Other Information:

Foundation Concrete Stories 1.0

Roof/Cornice Gable

Window Most Original Windows Replaced, Openings Altered

Dating Method(s): Professional Estimate

Feature Preservation Recommendation(s) (Check all that apply):

- Individual nomination
Contributes to a potential district
[checked] No nomination potential
Will not contribute to a district
Potential district—feature would be a contributing element if other properties constitute a district
Thematic nomination potential
Component of a historic site or landscape
Moved (specify all applicable choices)—a) relocation occurred within a historic period; b) recreates original site, orientation, landscape, & spatial relationships; c) compatible in context with neighboring structures; d) relocation has damaged eligibility
Historical associations require further investigation

Recorded By Melinda McCarthy Date Recorded 02/02/2018
(First Name & Last Name) (mm/dd/year)

NDCRS ARCHITECTURAL SITE FORM
PAGE 3—Feature Data**UPDATE**Field Code EL1-134-ARCHSITS# 32 EM 998**Complete a Page 3 for each feature.****1. Feature Description, Integrity, Eligibility:**

Feature (F.)1 is a wood-frame, two-room school building clad in wooden clapboard siding with simple wooden corner boards. The rectangular building features a front-gable roof with closed eaves. The roof is covered in wooden shake (although sections have fallen off) and features a metal cap with decorative ball finials. A blonde brick chimney, in very poor condition, breaks the ridge line near the front of the building. The chimney had been previously covered in cement, a majority of which has fallen off, exposing the brick underneath. The structure rests on a concrete foundation, which is in poor condition. The windows on the building are a mix of original and replacements; all are in poor condition, with several missing sections of their framing, panes, and mullions.

On the front (southern) façade, the centrally-placed wood-framed entrance is flanked by two, 2:2 sash windows. The front door appears to be original and is accessed by a set of tiered concrete steps; both are in poor condition. The door is missing several panels, and the steps have collapsed in the center. The western and northern elevations contain no fenestration, while the eastern elevation contains three sets of horizontal sliding windows. These windows are asymmetrically placed in a group on the northern end of the wall. These windows appear to be replacement windows in altered window openings. The interior of the building retains its lath and plaster walls and wooden flooring. Both are largely intact but in poor condition due to water seepage from the roof. A drop ceiling and chalkboard remain from the building's last period of use.

An exact identification of the building's construction date is difficult due to a lack of records; however, research reveals that the building is present and labeled as "schoolhouse" on a plat map from 1916 (Midland Atlas Co. 1916).

The building is falling into disrepair; its integrity is diminished due to rot, water damage, and the alteration of over half the building's original window openings. The school's diminished integrity and its condition have affected its connection to its historical significance. Further, more intact examples of early school houses can be found within Emmons County. The building is recommended not eligible for the National Register of Historic Places (NRHP). See the Feature Summary for more a more detailed discussion of the school's property ownership and historical significance.

Recorded By Melinda McCarthy Date Recorded 02/02/2018
(First Name & Last Name) (mm/dd/year)

**NDCRS ARCHITECTURAL SITE FORM
PAGE 4—SITE DESCRIPTION****UPDATE**Field Code EL1-134-ARCHSITS# 32 EM 998**Complete one Page 4 for the entire site.**

2. Owner's Contact Information:

Justin and Jenna Weigel

3. Access (to rural areas):

From Linton, ND, head east on Hwy 13 for 17.6 miles (mi) and turn left onto 24th Ave SE. Proceed north 1.5 mi and follow the curve onto 26th Ave SE. Continue north 11 mi and turn left onto 67th St. SE. Drive west 2 mi and turn left on 24th Ave SE. Travel south 2 miles and turn right on 69th St SE. Drive 1 mi and follow the road curve onto 23rd Ave SE. The site is located 0.5 mi down 23rd, on the right.

4. Site Area (ft²): 1,9165. Description of **SETTING**:

The site is set in the gently rolling prairie of the Missouri Coteau Slope. The region is rural, with scattered farmsteads and rolling pasture lands and steep drainages. While many farmsteads have been abandoned, just as many remain active. Corn, sunflower, and soybeans are the predominant agriculture products of the area. Livestock is pastured on the steeper slopes surrounding drainages. Small churches and abandoned one-room school houses dot the countryside.

The closest towns, Napoleon and Kintyre, are 10 mi and 8.9 mi away, to the northeast and northwest, respectively. Napoleon is the county seat. The site sits 0.95 mi from the Logan County border with Emmons County.

The site currently rests in an active agricultural field. No access path into the site remains, and newly planted tree rows are located to the north and south of the site. 23rd Ave SE runs along a north-south line approximately 60 meters west of the site's location.

Recorded By Melinda McCarthy Date Recorded 02/02/2018
(First Name & Last Name) (mm/dd/year)

**NDCRS ARCHITECTURAL SITE FORM
PAGE 5—SITE DESCRIPTION**

UPDATEField Code EL1-134-ARCHSITS# 32 EM 998**6. Summary of ALL Site Features & Evaluation of Significance:**

The site is composed of a single feature, a historic Schoolhouse, set in an active agricultural field.

Few records could be found concerning the site; however, the land was initially owned by the Northern Pacific Railroad Company (BLM 1896). Viktor Pikkola, a Russian immigrant, purchased the land in 1910 (BLM 1910). The school house is noted on a plat map from 1916, indicating the building likely pre-dates that year (Midland Atlas Co. 1916). Pikkola, a farmer, was recorded as living in this Township until the early 1920s, by which time records indicate he had relocated to Oregon (Ancestry 2018). Based on this time frame and the likely construction date range of the school house, it is possible it was the Pikkola family who built or allowed the construction on the land where the school house sits. No further landowner information is available until 1962, by which time Anthony and Rosalid Weigel owned and farmed the land (Midland Atlas Co. 1962). Their descendants Justin and Jenna Weigel currently own the land.

Based on aerial imagery from the late 1950s and early 1960s, at least two of the school house's associated outbuildings have been removed (NDGISHUB 2018). One was removed between the early 1960s and 1995 (NDGISHUB 2018; Google Earth 1995). The second, likely an outhouse based on its size and location, was removed between 2010 and 2013 (Google Earth 2010, 2013).

Based on the diminished integrity of the site's remaining feature, the removal of associated outbuildings, the commonplace nature of the architecture, the lack of association with any person or events of significance shown through background research, and the unlikely ability of the site to provide further information to the archaeological record, the site is recommended as not eligible for the NRHP.

7. References/Comments:

Ancestry.com. (Ancestry)

2018. Ancestry.com. Oregon, Motor Vehicle Registrations, 1911-1946 [database on-line]. Provo, UT, USA: Ancestry.com Operations, Inc., 2015. Accessed Online: April 25, 2018.

See Continuation Page 1

Recorded By Melinda McCarthy Date Recorded 02/02/2018
(First Name & Last Name) (mm/dd/year)

**NDCRS SITE FORM
CONTINUATION PAGE****Field Code** EL1-134-ARCH**SITS#** 32 EM

Complete a *Continuation Page(s)* for information that does not fit in the space available on other sections of a Site Form.

Continuation Page 1**Continued from References/Comments:**

Bureau of Land Management (BLM)

1896 GLO Records Database: Document No. 34, BLM Serial No. NDMTAA 000031, Date 01/11/1896 United States Department of the Interior. Accessed Online: April 5, 2018.

<https://glorerecords.blm.gov/details/patent/default.aspx?accession=NDMTAA%20000031&docClass=SER&sid=bsegwl4q.rg0>

1910 GLO Records Database: Document No. 04407, BLM Serial No.132076, Date 05/23/1910, United States Department of the Interior. Accessed Online: April 25, 2018.

<https://glorerecords.blm.gov/details/patent/default.aspx?accession=132076&docClass=SER&sid=yzli0l5b.lf4>

Google Earth

1995 Historical Imagery: June 11, 1995. Google Earth Pro. Accessed Online: March 11, 2018.

2010 Historical Imagery: Dec. 31, 2010. Google Earth Pro. Accessed Online: April 25,, 2018.

2013 Historical Imagery: July 27, 1995. Google Earth Pro. Accessed Online: April 25, 2018.

Midland Atlas Company (Midland Atlas Co.)

1962 Atlas of Emmons County North Dakota. Midland Atlas Company, LLC. Midland, South Dakota.

2016 Atlas of Emmons County North Dakota. Midland Atlas Company, LLC. Midland, South Dakota.

North Dakota GIS Hub (NDGISHUB)

2018 "Imagery/Aerial_ND_19571962". Accessed Online: March. 2, 2018.

https://ndgishub.nd.gov/arcgis/rest/services/Imagery/AerialImage_ND_19571962/ImageServe**Recorded By** M. McCarthy**Date Recorded****02/02/2018**

(First Name & Last Name)

(mm/dd/year)

Instructions to complete a digital version of this form: (1) Download a copy; (2) Open the saved blank copy; (3) Fill out the form; (4) Use the Save As command to rename the form appropriately, and save; (5) **Print** and submit to SHSND.

Client Name:
NextEra Energy Resources

Project:
Emmons-Logan Wind Energy Center

Project No.:
60552785

Photo No.:
IMG_9976

Date:
Feb. 2, 2018



Site Number:
EL1-134-ARCH

Description:
The front (southern) façade and western elevation of Feature (F.)1, a historic school house. View to the northeast.

Client Name:
NextEra Energy Resources

Project:
Emmons-Logan Wind Energy Center

Project No.:
60552785

Photo No.:
IMG_9943

Date:
Feb. 2, 2018



Site Number:
EL1-134-ARCH

Description:
The eastern and northern elevation of F.1, looking southwest. Note the replacement windows on the eastern elevation.

| | | | |
|---|------------------------------|---|---------------------------------|
| Client Name: NextEra Energy Resources | | Project: Emmons-Logan Wind Energy Center | Project No.: 60552785 |
| Photo No.: IMG_9956 | Date: Feb. 2, 2018 |  | |
| Site Number: EL1-134-ARCH | | | |
| Description: The front façade of the school house, looking north. Note the poor condition of the building's window and doors. | | | |

| | | | |
|---|------------------------------|--|---------------------------------|
| Client Name: NextEra Energy Resources | | Project: Emmons-Logan Wind Energy Center | Project No.: 60552785 |
| Photo No.: IMG_9969 | Date: Feb. 2, 2018 |  | |
| Site Number: EL1-134-ARCH | | | |
| Description: Overview of the school room, which has been partially updated with modern features. View to the west, looking through the eastern elevation's windows. | | | |

Client Name:
NextEra Energy Resources

Project:
Emmons-Logan Wind Energy Center

Project No.:
60552785

Photo No.:
IMG_9970

Date:
Feb. 2, 2018

Site Number:
EL1-134-ARCH

Description:
The interior of the northern wall of the building, which showcases both the original lath and plaster and the extensive water damage present inside the structure. View to the northwest.



Client Name:
NextEra Energy Resources

Project:
Emmons-Logan Wind Energy Center

Project No.:
60552785

Photo No.:
IMG_9971

Date:
Feb. 2, 2018

Site Number:
EL1-134-ARCH

Description:
Overview of the southern wall of the classroom portion of the school house. View to the south.



Client Name:
NextEra Energy Resources

Project:
Emmons-Logan Wind Energy Center

Project No.:
60552785

Photo No.:
IMG_9961

Date:
Feb. 2, 2018

Site Number:
EL1-134-ARCH

Description:
Overview of the interior ceiling in the front entranceway from the doorway. View to the northwest.



SITS # 3.2 FM 998
State County Site Number

Field Code C.R.M. 26.2-2.1 Site Name _____
Field Code 1.3.4.7.4-1.3-1 Site Name _____

Map Quad Schell, Buttes, NW
Map Quad _____

| | | | | | | | | | | | | | |
|-----|--------------------------|-----|-------------|---|------------|-----|-----------|-----|-------------------------------------|----|-------------------------------------|---|----------|
| LTL | <input type="checkbox"/> | Twp | <u>13.4</u> | R | <u>7.4</u> | Sec | <u>13</u> | QQQ | <input checked="" type="checkbox"/> | QQ | <input checked="" type="checkbox"/> | Q | <u>8</u> |
| LTL | <input type="checkbox"/> | Twp | _____ | R | _____ | Sec | _____ | QQQ | <input type="checkbox"/> | QQ | <input type="checkbox"/> | Q | <u>7</u> |
| LTL | <input type="checkbox"/> | Twp | _____ | R | _____ | Sec | _____ | QQQ | <input type="checkbox"/> | QQ | <input type="checkbox"/> | Q | _____ |
| LTL | <input type="checkbox"/> | Twp | _____ | R | _____ | Sec | _____ | QQQ | <input type="checkbox"/> | QQ | <input type="checkbox"/> | Q | _____ |
| LTL | <input type="checkbox"/> | Twp | _____ | R | _____ | Sec | _____ | QQQ | <input type="checkbox"/> | QQ | <input type="checkbox"/> | Q | _____ |
| LTL | <input type="checkbox"/> | Twp | _____ | R | _____ | Sec | _____ | QQQ | <input type="checkbox"/> | QQ | <input type="checkbox"/> | Q | _____ |

1. N $\frac{1}{2}$
2. E $\frac{1}{2}$
3. S $\frac{1}{2}$
4. W $\frac{1}{2}$
5. NE $\frac{1}{4}$
6. SE $\frac{1}{4}$
7. SW $\frac{1}{4}$
8. NW $\frac{1}{4}$
9. C

SITE DATA

City _____
Street # _____ Street # _____
Street Name _____ Street Name _____
of Features 2

FEATURE DATA

| | | |
|--|---------------------------------------|--|
| <input type="checkbox"/> Feature # | <input type="checkbox"/> Feature Type | <input checked="" type="checkbox"/> Condition |
| <u>19.14</u> Const Date | <input type="checkbox"/> Context | <input checked="" type="checkbox"/> Significance |
| <input checked="" type="checkbox"/> Feature Date | | <input checked="" type="checkbox"/> Plan Shape |

PORCH

Original
 Addition/Altered
 Removed/None

BUILDING MATERIALS

Structure System
 Primary Exterior Finish
 Secondary Exterior Finish
 Main Entrance

_____ Ethnic
_____ Style
1.2.0.1.8.7 Fieldwork Date
_____ Builder
_____ Engineer
_____ Designer Architect

Other Information _____

_____ Soil Association 1.9 Ecozone Area Signf _____ MS Number
_____ Soil Association _____ Ecozone _____ Area Signf _____ MS Number
 CR Type Verified Site Non-Site E C F T F
 State Registry National Register

Coder Schweigert Date Coded 1/09/89

SITE I.D.

SITE DATA

FEATURE DATA

SHSND USE

NDCRS ARCHITECTURAL SITE FORM
Page 2

Field Code CRM262-21

SITS NUMBER _____

FEATURE # 1 NAME IN NAME BLOCK _____

| <u>BASEMENT</u> | <u>FOUNDATION MATERIALS</u> | <u>STORIES</u> | <u>CORNICE</u> | <u>ROOF TYPE</u> | <u>DATING METHOD</u> |
|--|---|---------------------------------------|--|---|---|
| <input type="checkbox"/> yes | <input type="checkbox"/> Brick | <input checked="" type="checkbox"/> 1 | <input type="checkbox"/> Metal | <input checked="" type="checkbox"/> Gable | <input type="checkbox"/> Plat Map(s) |
| <input checked="" type="checkbox"/> no | <input type="checkbox"/> Concrete Block | <input type="checkbox"/> 1 1/2 | <input type="checkbox"/> Brick | <input type="checkbox"/> Hipped | <input type="checkbox"/> County Atlas |
| <input type="checkbox"/> unknown | <input type="checkbox"/> Fieldstone | <input type="checkbox"/> 2 | <input checked="" type="checkbox"/> None | <input type="checkbox"/> Deck | <input type="checkbox"/> Date Block |
| <input type="checkbox"/> other | <input type="checkbox"/> Cut Stone | <input type="checkbox"/> 2 1/2 | <input type="checkbox"/> Wood | <input type="checkbox"/> Gambrel | <input type="checkbox"/> Sanborn Map(s) |
| | <input checked="" type="checkbox"/> Poured Concrete | <input type="checkbox"/> 3 | <input type="checkbox"/> Other | <input type="checkbox"/> Flat | <input type="checkbox"/> Topo Map(s) |
| | <input type="checkbox"/> Refaced | <input type="checkbox"/> Other | | <input type="checkbox"/> Other | <input checked="" type="checkbox"/> Other |
| <u>WINDOWS</u> | <input type="checkbox"/> Unknown | | | | <u>Interview</u> |
| <input checked="" type="checkbox"/> Original | <input type="checkbox"/> Other | | | | |
| <input checked="" type="checkbox"/> Altered | | | | | |

FEATURE DESCRIPTION & STATEMENT OF INTEGRITY _____

SIGNIFICANCE

SIGNIFICANT

NOT SIGNIFICANT

- | | | |
|---|---|--|
| <input type="checkbox"/> Work of Master | <input type="checkbox"/> Visual Landmark | <input type="checkbox"/> Too new |
| <input type="checkbox"/> High Artistic Values | <input type="checkbox"/> Associated with significant event | <input type="checkbox"/> Lacking integrity |
| <input type="checkbox"/> Rep. of type, period, method of construction | <input type="checkbox"/> Associated with devel. of locality | <input checked="" type="checkbox"/> Not High Style |
| <input type="checkbox"/> Other _____ | <input type="checkbox"/> Associated with significant person | <input type="checkbox"/> Other _____ |

JUSTIFICATION OF SIGNIFICANCE _____

Recorded by Schweigert

Date 12/01/87

NDCRS ARCHEOLOGICAL AND HISTORICAL SITE FORMS

Field Code 13474-13-1 Photo

SITS Number _____

