

I. SITE I.D.

SITS #

Field Code LT237 State 32 County GE Site Number 61

Site Name _____ LTL Twp R Sec QQQ QQ Q

Map Quad INKSTER LTL_a Twp_a R_a Sec_a QQQ_a QQ_a Q_a

1. N₂
2. E₂
3. S₂
4. W₂
5. NE₂
6. SE₂
7. SW₂
8. NW₂
9. C

II. SITE DESCRIPTION

City _____ 18 3 MAIN ENTRANCE

Street # _____ BUILDING MATERIALS

Street Name _____

- SITE COMPONENTS**
- 46 # of Features
 - 51 Barn
 - 58 Chicken Coop
 - 62 Corral/Enclosure
 - 66 General Storage
 - 70 Grain Storage
 - 74 Privy
 - 78 Well/Windmill
 - 2 Workshop
 - 8 Dwelling: Multiple
 - 11 Dwelling: Sngl/Mobile
 - 15 Dwelling: Sngl/Perm
 - 19 Hotel/Motel
 - 23 Garage/Carriage House
 - 27 Gravestone/Marker
 - 31 Commercial/Office
 - 34 Educational
 - 38 Engineering Struc.
 - 42 Governmental
 - 46 Health Care
 - 50 Industrial/Utility
 - 53 Military
 - 57 Religious
 - 61 Social/Recre/Arts
 - 65 Transportation
 - 69 Warehouse
 - 73 Other

- FEATURE DATA**
- 48 Feature #
 - 53 Const. Date
 - 60 pre-1880
 - 64 1880-1900
 - 68 1900-1915
 - 72 1915-1930
 - 76 1930-1945
 - 80 post-1945

- CONDITION**
- 13 Excellent
 - 17 Good
 - 21 Fair
 - 25 Poor
 - 29 Destroyed

- SIGNIFICANCE**
- 36 Eligible
 - 40 Not Eligible
 - 44 Contributing
 - 48 Non-contrib.

- PLAN SHAPE**
- 55 Circular
 - 59 Irregular
 - 63 L-Shaped
 - 67 Polygonal
 - 71 Rectangular
 - 75 Square
 - 78 T-Shaped
 - 3 U-Shaped
 - 7 Other

- 24 Unknown
- 43 Asbestos Siding/Shingle
- 44 Asphalt Siding/Shingle
- 45 Brick
- 50 Clay Tile
- 57 Composition Board
- 61 Concrete Block
- 65 Concrete, Poured/Cast
- 69 Earth/Clay
- 73 Earthen Brick
- 77 Glass, Block
- 1 Glass, Pigmented
- 4 Log
- 7 Metal, Decorative
- 10 Metal, Frame
- 14 Metal, Horiz. Siding
- 18 Metal, Sheet
- 22 Perma-Stone
- 26 Plastic, Vinyl
- 30 Pole
- 33 Stone, Cut
- 37 Stone, Uncut
- 41 Stucco/Plaster
- 45 Tarpaper
- 49 Thatch
- 52 Wood, Frame
- 56 Wood, Horiz. Siding
- 60 Wood, Shingle/Shake
- 64 Wood, Vert. Siding
- 68 Other

- 1= struct system
- 2= Primary exterior finish
- 3= Both 1 & 2
- 4= Second exterior finish

Fieldwork Date 07/08/85 16 Ethnic 18 Builder

Other Info. DIATIEI IISI IAPIRIOXILIMATIEIDI 19 Style 21 Engineer

46 Designer/Architect

O=Unknown
1=Known

OFFICE USE ONLY

OFFICE USE ONLY

Soil Association _____ Ecozone _____ Area Signf _____ CR Type _____ Verified Site _____ Non-Site _____

State Registry _____ National Register _____ E C F T F _____ MS Number _____

_____ _____ _____ _____ _____ _____ _____ _____

Code

Date Coded

I. SITE I.D.

Field Code	SITS #			State	County	Site Number
<u>L.T.237</u>	<u>3</u>	<u>2</u>	<u>GF</u>	<u>6</u>	<u>1</u>	
<u>1</u>	<u>10</u>	<u>11</u>	<u>13</u>	<u>15</u>	<u>18</u>	
Site Name	LTL	Twp	R	Sec	QQQ	QQ Q
<u>19</u>	<u>39</u>	<u>40</u>	<u>47</u>	<u>48</u>	<u>49</u>	<u>50</u>
Map Quad	LTL _a	Twp _a	R _a	Sec _a	QQQ _a	QQ _a Q _a
<u>51</u>	<u>69</u>	<u>70</u>	<u>77</u>	<u>78</u>	<u>79</u>	<u>80</u>

1. N½
2. E½
3. S½
4. W½
5. NE¼
6. SE¼
7. SW¼
8. NW¼
9. C

II. SITE DESCRIPTION

Theme 1	Site Type	Cultural Material	Site Area
<u>1</u>	<u>3</u> CM Scatter	<u>4</u> Bone (worked)	<u>5</u> <u>7200</u> <u>12</u> m ²
<u>2</u>	<u>13</u> Chimney	<u>14</u> Ceramics (Euro Am)	Cultural Depth
Theme 2	<u>15</u> Depression	<u>16</u> Charcoal	<u>21</u> <u>23</u>
<u>17</u>	<u>19</u> Dump	<u>20</u> Cloth	Depth Indicator
<u>18</u>	<u>24</u> Earthworks	<u>25</u> Faunal Remains	<u>30</u> <u>0</u>
	<u>26</u> Fortification	<u>27</u> Fire Cracked Rock	Occupation Date
	<u>28</u> Foundation	<u>29</u> Floral Remains	Begin End
	<u>31</u> Grave	<u>32</u> Glass	<u>39</u> <u>1900</u> <u>42</u> <u>43</u> <u>46</u>
	<u>33</u> Hearth	<u>34</u> Hide, Hair, Fur	Basis for Dating
	<u>35</u> Machinery	<u>36</u> Human Remains	<u>53</u> <u>03</u> <u>54</u>
	<u>37</u> Quarry/Mine	<u>38</u> Masonry	CM Density Isolated Find
	<u>47</u> Rock Art	<u>48</u> Metal	<u>59</u> <u>0</u> <u>60</u>
	<u>49</u> Trail	<u>50</u> Plastic	
	<u>51</u> Wreck (ship)	<u>52</u> Rubber	
	<u>55</u> Other	<u>56</u> Shell (worked)	
		<u>57</u> Wood (worked)	
		<u>58</u> Other	

III. ENVIRONMENT

Landform 1	Landform 2	Slope/Exposure	View, degree	View, distance
<u>1</u>	<u>07</u>	<u>10</u>	<u>4</u>	<u>2</u>
<u>61</u>	<u>62</u> <u>63</u>	<u>64</u> <u>65</u>	<u>66</u>	<u>67</u>
Elevation	Drainage System			Dist Perm Water
<u>343</u> m.	<u>FOREST RIVER</u>			<u>1000</u> m.
<u>68</u>	<u>1</u>	<u>21</u>	<u>22</u>	<u>26</u>
Perm Water Type	Dist Seas Water	Seas Water Type	Ecosystem	
<u>3</u>	<u>28</u> <u>32</u>	<u>33</u>	<u>34</u>	<u>37</u>

IV. C.R.M.

Ownership	Site Condition	Collection	Test	Excavation
<u>3</u>	<u>5</u>	<u>3</u>	<u>0</u>	<u>0</u>
<u>38</u>	<u>39</u>	<u>40</u>	<u>41</u>	<u>42</u>
Fieldwork Date	Management Recommendation			
<u>07.08.85</u>	<u>2</u>			
<u>43</u>	<u>48</u>			
Additional Information				
<u>1</u>				

OFFICE USE ONLY

OFFICE USE ONLY					
Soil Association	Ecozone	Area Signf	CR Type	Verified Site	Non-Site
<u>41</u> <u>43</u>	<u>44</u> <u>45</u>	<u>46</u>	<u>47</u>	<u>48</u>	<u>49</u>
State Registry	National Register	E C F	T F	MS Number	
<u>50</u>	<u>51</u>	<u>52</u>	<u>53</u>	<u>54</u>	<u>60</u>

Coder _____ Date Coded _____

ACCESS Travel 3 miles west of Inkster on Grand Forks County 1. The township hall and the cultural material scatter are located on the NE corner of the intersection. DESCRIPTION OF SITE This site consists of the Inkster township hall and a historic cultural material scatter.

SIG. FEAT. 1, INKSTER TOWNSHIP TOWNHALL

NON-SIG. FEAT. none

OWNER'S NAME, ADDRESS, AND PHONE NUMBER Forest River Community of the Hutterian Brethern, Fordville, North Dakota.

FEATURE # 1 NAME IN NAME BLOCK

BASEMENT	FOUNDATION MATERIALS	STORIES	CORNICE	ROOF TYPE	DATING METHOD
<input type="checkbox"/> yes	<input type="checkbox"/> Brick	<input checked="" type="checkbox"/> 1	<input checked="" type="checkbox"/> Metal	<input checked="" type="checkbox"/> Gable	<input type="checkbox"/> Plat Map(s)
<input type="checkbox"/> no	<input type="checkbox"/> Concrete Block	<input type="checkbox"/> 1 1/2	<input type="checkbox"/> Brick	<input type="checkbox"/> Hipped	<input type="checkbox"/> County Atlas
<input checked="" type="checkbox"/> unknown	<input type="checkbox"/> Fieldstone	<input type="checkbox"/> 2	<input type="checkbox"/> None	<input type="checkbox"/> Deck	<input type="checkbox"/> Date Block
<input type="checkbox"/> other	<input type="checkbox"/> Cut Stone	<input type="checkbox"/> 2 1/2	<input type="checkbox"/> Wood	<input type="checkbox"/> Gambrel	<input type="checkbox"/> Sanborn Map(s)
	<input checked="" type="checkbox"/> Poured Concrete	<input type="checkbox"/> 3	<input type="checkbox"/> Other	<input type="checkbox"/> Flat	<input type="checkbox"/> Topo Map(s)
	<input type="checkbox"/> Refaced	<input type="checkbox"/> Other		<input type="checkbox"/> Other	<input type="checkbox"/> Other
	<input type="checkbox"/> Unknown				
	<input type="checkbox"/> Other				
WINDOWS					
<input type="checkbox"/> Original					
<input checked="" type="checkbox"/> Altered					

ARCHITECTURAL SIGNIFICANCE

- Work of Master
- High Artistic Values
- Rep. of type, period, method of construction
- Visual Landmark
- Too new to be elig.
- Lacking integrity
- Not High Style

HISTORICAL SIGNIFICANCE

- Associated with significant person
- Associated with significant event
- Associated with development of locality

FEATURE DESCRIPTION This feature is noted on the USGS topographic map as "townhall". It is probably the meeting place for the township of Inkster. Adjacent to this building (in what is probably the parking lot, in the cultivated field adjacent to the bldg) is a historic trash scatter that appears to represent a household dump. It is summarized on the accompanying archaeological-historical site form.

OTHER HISTORICAL INFORMATION Many of these townhalls were once rural schools. This possibility and the possibility that this is not the original location of this building, should be researched.

COMMENTS/REFERENCES

1. Access: From Inkster, North Dakota, travel 3 miles west on Grand Forks County Road #1. The township hall and cultural material scatter are located in the northeast corner of this intersection.

2. Description of Site: This site consists of a dense scatter of cultural material that appears to represent a household dump. It is located adjacent to the Inkster township hall in what appears to be the parking lot. The site apparently extends into the cultivated field to the east and north of the township hall, but the visibility was poor at the time of our survey and did not allow us to delimit the boundaries of the site accurately. An architectural form has also been filled out on the townhall portion of the this site.

3. Description of Cultural Materials: Cultural materials included china, glass, leather, metal, crockery, limestone foundation slabs and brick. Some of the glass and other materials appear to have been burned.

Items: See map and map legend.

Collected: Artifactual material thought to be temporally diagnostic.

4. Artifact Repository Collected materials will be returned to the land owners

5. Description of Subsurface Testing none on this project.

6. Current Use of Site: Inkster Township hall and a cultivated field.

7. Owner's Name/Address: Forest River Community of the Hutterian Brethern, Fordville, North Dakota.

8. Vegetation: Cultivated field, some grasses and forbs in front of township hall and in road ditch.

9. Cover (% of visible ground): Varied (see site description).

10. Man-hours spent on site: 3

11. Project Title/P.I. 1985 Forest River Archaeological Survey
Thomas K. Larson

12. Report Title/Author 1985 Forest River Archaeological Survey
Larson et al.

13. Other Published References: none

14. Description of Collections Observed: none

15. Owner-Address of Collections Observed: N/A

Field Number: LT237

SITS Number

16. Statement of Integrity: The dense scatter of artifactual material may indicate the presence of a subsurface deposit of household items. These may be the result of an earlier use of the townhall or an earlier building on the site. The integrity of the site cannot be determined without testing and an archival search.

17. Statement of Significance: Testing within the concentration and a title and archival research should be completed before a statement of significance is made.

18. Comments/References:

Recorded by: Dori Penny, Larson-Tibesar Associates Date: 07/08/85

Gravel Road

Gravel #1

1125

Site boundary

pass

dead end road

Town Hall

GRAND FORKS COUNTY #1

30 METERS

LT237

N

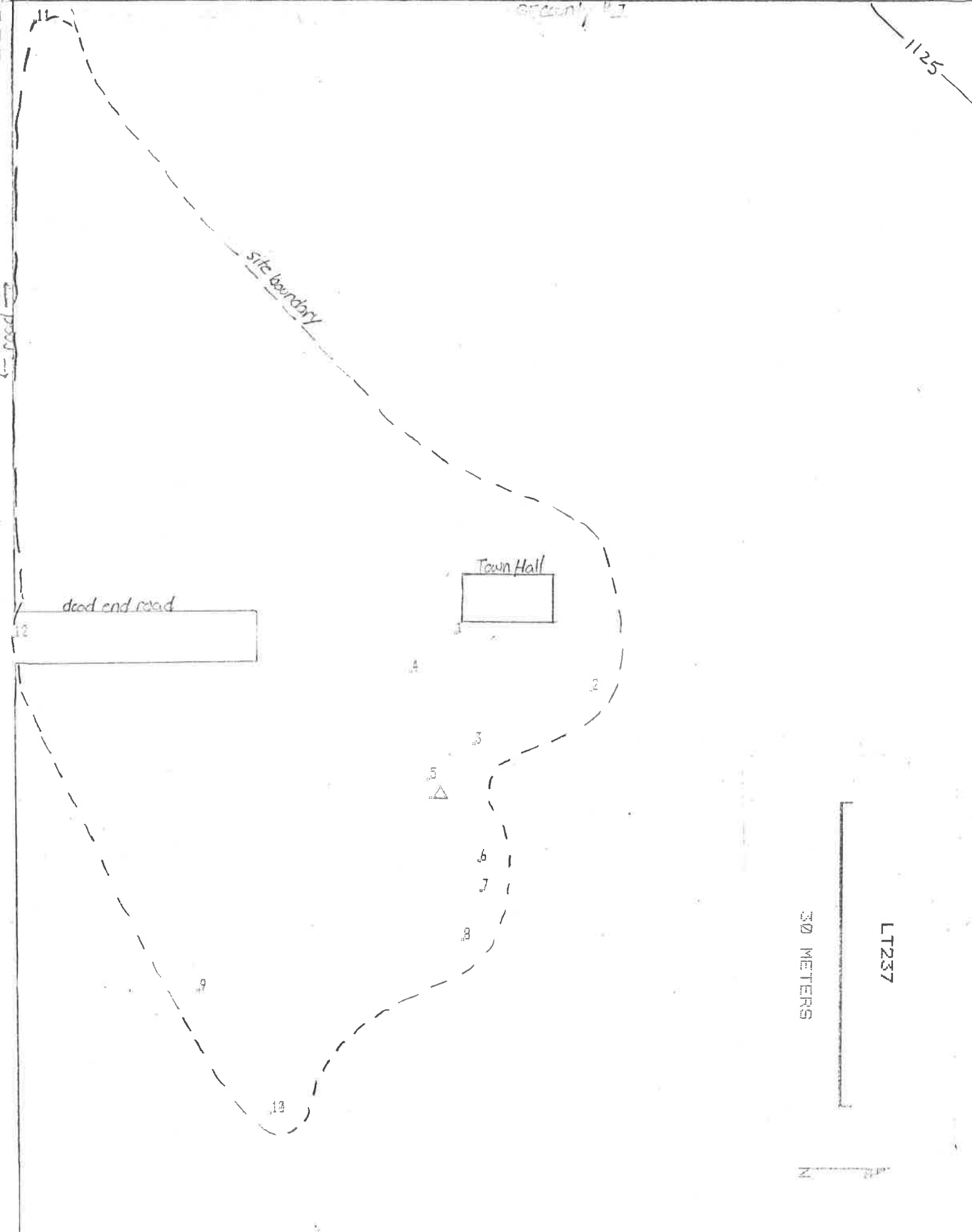

MAP LEGEND
SITE LT237

MAP #	DESCRIPTION	COLLECTED ?
1	1 TOWNHALL/SE CORNER/SOUTH ENTRANCE/ 5 EAST	
2	1 PURPLE GLASS	
3	1 CLEAR GLASS	X
4	1 BOTTLE BASE/CLEAR	X
5	1 PRESSED GLASS	
6	1 CLEAR BOTTLE BASE	
6	1 BROWN BOTTLE BASE	
6	1 CANNING JAR	
7	1 PURPLE GLASS	
8	1 CLEAR BOTTLE BASE	X
9	1 BONE	
10	1 BRICK	
11	1 ROAD	
12	1 ROAD	



LT237, Feature 1, view to the northwest (Roll 7, Frame 19)



LT237, Feature 1, view to the southeast (Roll 7, Frame 20)