

NDCRS ARCHITECTURAL SITE FORM

PAGE 1

Field Code Oakville Township School

SITS# 32 GF 3810

SITE IDENTIFICATION

Map Quad Emerado Site Name Oakville Township School

Map Quad _____ Site Name _____

LTL	___	TWP	<u>152</u>	R	<u>52</u>	SEC	<u>36</u>	QQQ	<u>7</u>	QQ	<u>X 7</u>	Q	<u>X 7</u>
LTL	___	TWP	_____	R	_____	SEC	_____	QQQ	_____	QQ	_____	Q	_____
LTL	___	TWP	_____	R	_____	SEC	_____	QQQ	_____	QQ	_____	Q	_____
LTL	___	TWP	_____	R	_____	SEC	_____	QQQ	_____	QQ	_____	Q	_____

NAD 1983, UTM -5309946-- N ZONE 14N
 NAD 1983, UTM -630009-- E

Subsection:
 1 = N½
 2 = E½
 3 = S½
 4 = W½
 5 = NE¼
 6 = SE¼
 7 = SW¼
 8 = NW¼

City: Emerado
 Street Number: 1804
 Street Name: 20th St NE
 Urban Legal Description: _____

SITE DATA

Total # **Architectural** Features: 1

Fieldwork Date: 7/18/2018

Reconnaissance Survey Intensive Survey _____

Project & Principal Investigator:
Country Schoolhouse Project

Report Title & Author(s):

Contracting firm or Agency completing the form:

Additional Information:

SHSND USE
 Area of Significance 2 Ecozone 16 Verified Site 1 CR Type 2
 Area of Significance _____ Ecozone _____
 Area of Significance _____ Ecozone _____

Recorded By Kathy Wilner Date Recorded 1/20/2019
 (First Name & Last Name) (mm/dd/year)

Instructions to complete a digital version of this form: (1) Download a copy; (2) Open the saved blank copy; (3) Fill out the form; (4) Use the Save As command to rename the form appropriately, and save; (5) **Print** and submit to SHSND.

NDCRS ARCHITECTURAL SITE FORM
PAGE 2—Feature Data

Field Code

SITS# 32

Complete one Page 2 for each architectural feature at the site.

Architectural Feature #

Construction Date _____

Feature Type 9

Condition

Feature Date

Context 7

Plan Shape

Structural System

Primary Exterior

Style

Original Owner's Ethnicity _____

Secondary Exterior

Architect/Builder _____

Other Information: _____

Foundation

Stories

Roof/Cornice

Window

Dating Method(s)

Feature Preservation Recommendation(s) (Check all that apply):

Individual nomination

Contributes to a potential district

No nomination potential

Will not contribute to a district

Potential district—feature would be a contributing element if other properties constitute a district

Thematic nomination potential

Component of a historic site or landscape

Moved (specify all applicable choices)—a) relocation occurred within a historic period; b) recreates original site, orientation, landscape, & spatial relationships; c) compatible in context with neighboring structures; d) relocation has damaged eligibility

Historical associations require further investigation

Recorded By
(First Name & Last Name)

Date Recorded
(mm/dd/year)

NDCRS ARCHITECTURAL SITE FORM**PAGE 3—Feature Data**Field Code SITS# 32 **Complete a Page 3 for each feature.****1. Feature Description, Integrity, Eligibility:**

The feature is a large, one room school on a poured concrete basement. The building is two stories tall, the roof was raised to accomodate the second story. The hip roof of the main building, the west addition and roofs of both entries are covered with asphalt shingles. Both the north and south slopes of the roof have large dormers and the east slope has a smaller dormer. A red brick chimney is located at the top of the east dormer. The soffits are open. There are eaves troughs on all sides of the school.

The siding on this building is 12 inch masonite. There are several windows, all newer double hung windows with storm windows. Two windows are at either end of the upper north and south dormers, one small window in the south dormer, three separate windows on the north wall of the lower floor, two sets of two windows on the south wall, either side of the entry and one window on the east wall to the right of that entry. Both entries have storm doors over 3 panel wood, with upper window, doors. There are concrete steps leading up to both of the entries. Electricity is present. I did not learn anything about the interior of this building.

Recorded By
(First Name & Last Name)Date Recorded
(mm/dd/year)

Instructions to complete a digital version of this form: (1) Download a copy; (2) Open the saved blank copy; (3) Fill out the form; (4) Use the Save As command to rename the form appropriately, and save; (5) **Print** and submit to SHSND.

**NDCRS ARCHITECTURAL SITE FORM
PAGE 4—SITE DESCRIPTION**

Field Code

SITS# 32

Complete one Page 4 for the entire site.

2. Owner's Contact Information:
GL Saddlery & Tack
1804 20th St NE
Emerado ND 58228

3. Access (to rural areas):
This school is located east of Grand Forks and north of Highway 2 at the intersection of 20th St NE. It is on the right side of 20th St NE.

4. Site Area (ft²): _____

5. Description of **SETTING**:
There is a farm site directly west, a new house to the east, yet another farm site south and farm fields all directions around the properties.

Recorded By
(First Name & Last Name)

Date Recorded
(mm/dd/year)

**NDCRS ARCHITECTURAL SITE FORM
PAGE 5—SITE DESCRIPTION**

Field Code

SITS# 32

6. Summary of ALL Site Features & Evaluation of Significance:

7. References/Comments:

Kathy Wilner
366 43rd Ave SE
Bowdon ND 58418

Recorded By
(First Name & Last Name)

Date Recorded
(mm/dd/year)



North Side

Oakville Township School

7/18/2018

Kathy Wilner

GF

West Side





South Side

Oakville Township School

7/18/2018

Kathy Wilner

GF



East Side

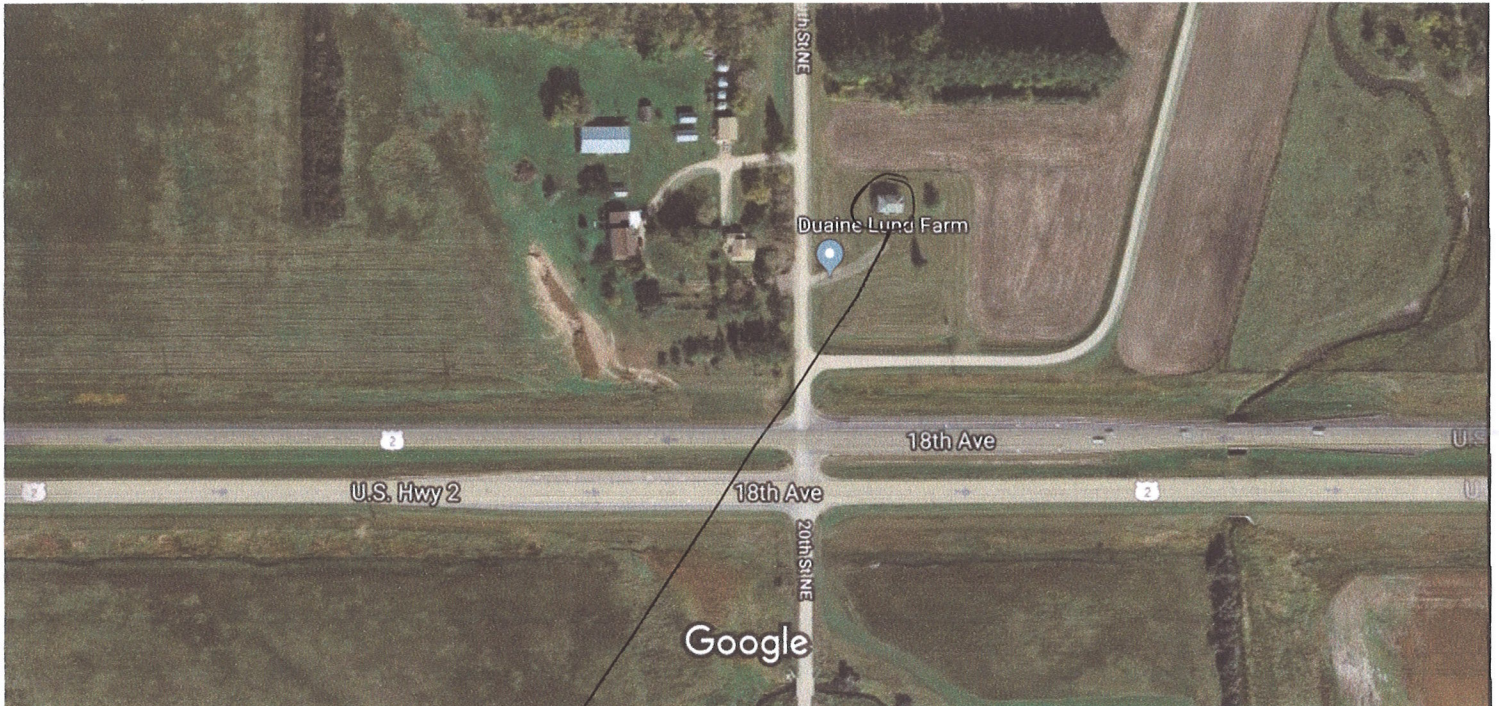

Imagery ©2019 Google, Map data ©2019 Google 200 ft

Feature