

### NDCRS ARCHITECTURAL SITE FORM

PAGE 1

Field Code Retzlaff School

SITS# 32 GG 196

**SITE IDENTIFICATION**

Map Quad Coopers-town West Site Name \_\_\_\_\_

Map Quad \_\_\_\_\_ Site Name \_\_\_\_\_

LTL	TWP	146	R	59	SEC	14	QQQ	7	QQ	8	Q	7
LTL	TWP	_____	R	_____	SEC	_____	QQQ	_____	QQ	_____	Q	_____
LTL	TWP	_____	R	_____	SEC	_____	QQQ	_____	QQ	_____	Q	_____
LTL	TWP	_____	R	_____	SEC	_____	QQQ	_____	QQ	_____	Q	_____

NAD 1983, UTM 5256880 **N** ZONE 14N  
 NAD 1983, UTM 563669 **E**

Subsection:
1 = N½
2 = E½
3 = S½
4 = W½
5 = NE¼
6 = SE¼
7 = SW¼
8 = NW¼

City: \_\_\_\_\_

Street Number: \_\_\_\_\_

Street Name: 112th Ave NE

Urban Legal Description: \_\_\_\_\_

**SITE DATA**

Total # **Architectural** Features: 1

Fieldwork Date: 10/30/2015

Reconnaissance Survey  Intensive Survey

Project & Principal Investigator:

Country Schoolhouse Project

Report Title & Author(s):

Contracting firm or Agency completing the form:

Additional Information:

**SHSND USE**

Area of Significance 2 Ecozone 18 Verified Site \_\_\_\_\_ CR Type 2

Area of Significance \_\_\_\_\_ Ecozone \_\_\_\_\_

Area of Significance \_\_\_\_\_ Ecozone \_\_\_\_\_

Recorded By Kathy Wilner Date Recorded 02/10/2016  
 (First Name & Last Name) (mm/dd/year)

### NDCRS ARCHITECTURAL SITE FORM PAGE 2—Feature Data

Field Code Retzlaff School

SITS# 32 GG

Complete one Page 2 for each architectural feature at the site.

Architectural Feature # 1

Construction Date \_\_\_\_\_

Feature Type 9

Condition 6

Feature Date 3

Context 7

Plan Shape 5

Structural System 25

Primary Exterior 26

Style Other Style

Original Owner's Ethnicity \_\_\_\_\_

Secondary Exterior \_\_\_\_\_

Architect/Builder \_\_\_\_\_

Other Information:

Foundation Concrete Block Stories 1

Roof/Cornice Hip

Window Double Hung, little glass

Dating Method(s): estimate

**Feature Preservation Recommendation(s) (Check all that apply):**

- Individual nomination
- Contributes to a potential district
- No nomination potential
- Will not contribute to a district
- Potential district—feature would be a contributing element if other properties constitute a district
- Thematic nomination potential
- Component of a historic site or landscape
- Moved (specify all applicable choices)—a) relocation occurred within a historic period; b) recreates original site, orientation, landscape, & spatial relationships; c) compatible in context with neighboring structures; d) relocation has damaged eligibility
- Historical associations require further investigation

Recorded By Kathy Wilner Date Recorded 2/10/2016  
(First Name & Last Name) (mm/dd/year)

Instructions to complete a digital version of this form: (1) Download a copy to your hard drive; (2) Open the saved blank copy; (3) Fill out the form; (4) Use the Save As command to rename the form appropriately and save; (5) Print and submit to SHSND.

**NDCRS ARCHITECTURAL SITE FORM  
PAGE 3—Feature Data**Field Code Retzlaff SchoolSITS# 32 GG**Complete a Page 3 for each feature.****1. Feature Description, Integrity, Eligibility:**

The feature is a one room prairie school on a concrete block foundation. The main body of the building measures 27 1/2 feet east to west and 23 feet north to south with an entry that measures 8 feet by 8 feet and a small shed addition on the south side measuring 14 feet by 7 feet. The roof on this building is covered with wood shakes and the hips have metal cap pieces. The shed attachment has a modified hip roof that ties into the main structure. A tall, concrete chimney is on the south slope of the hip roof, held in place by metal guide wires. The entry had a tall roof with a flat top, perhaps a cupola at some point. All the soffits are closed with beadboard. The fascia boards on the entry are starting to fall off. There is a wide header under the eaves of the roof on all sides as well as the shed attachment. The siding is 6 inch lap with 4 inch corner trim. A set of concrete steps with platform give entry into the school. There is a broken, 5 panel wood door at the entry to the main body of the school, the outer door is missing. Windows were double hung, little glass remains. There is a bank of 5 windows on the east wall and two more on the north wall with plywood and/or particle board covering most. Three more windows in the shed addition as well as one in the entry are also covered. The wall covering is either paneling or wallboard with wainscoting. The ceiling is covered with wallboard and some ceiling tiles, much of it is missing. There are blackboards on the north wall between windows as well as the entire west wall. The floors are hardwood. Electricity was present when it was used as a gathering place for the Rifle Club.

Recorded By Kathy Wilner Date Recorded 2/10/2016  
(First Name & Last Name) (mm/dd/year)

*Instructions to complete a digital version of this form: (1) Download a copy to your hard drive; (2) Open the saved blank copy; (3) Fill out the form; (4) Use the Save As command to rename the form appropriately and save; (5) Print and submit to SHSND.*

**NDCRS ARCHITECTURAL SITE FORM  
PAGE 4—SITE DESCRIPTION**Field Code Retzlaff SchoolSITS# 32 GG**Complete one Page 4 for the entire site.****2. Owner's Contact Information:**

Coopertown Rifle Club  
Richard Reiten  
PO Box 626  
Cooperstown ND 58425

**3. Access (to rural areas):**

From Cooperstown drive west on Highway 200 to 109th Ave NE. Turn right and drive north about 1 1/2 miles to see the school on the right.

**4. Site Area (ft<sup>2</sup>):** \_\_\_\_\_**5. Description of *SETTING*:**

The area where this school sits is wide open with fields all directions with a shooting range located to the east..

**Recorded By** Kathy Wilner **Date Recorded** 2/10/2016  
(First Name & Last Name) (mm/dd/year)

*Instructions to complete a digital version of this form: (1) Download a copy to your hard drive; (2) Open the saved blank copy; (3) Fill out the form; (4) Use the Save As command to rename the form appropriately and save; (5) Print and submit to SHSND.*

**NDCRS ARCHITECTURAL SITE FORM  
PAGE 5—SITE DESCRIPTION**

Field Code Retzlaff School

SITS# 32 GG

**6. Summary of ALL Site Features & Evaluation of Significance:**

**7. References/Comments:**

Kathy Wilner  
366 43rd Ave SE  
Bowdon ND 58418

Recorded By Kathy Wilner Date Recorded 2/10/2016  
(First Name & Last Name) (mm/dd/year)

*Instructions to complete a digital version of this form: (1) Download a copy to your hard drive; (2) Open the saved blank copy; (3) Fill out the form; (4) Use the Save As command to rename the form appropriately and save; (5) Print and submit to SHSND.*



South Side

Retzlaff School

10/30/2015

Kathy Wilner

GG

West Side





East Side

Retzlaff School

10/30/2015

Kathy Wilner

GG

North Side



T-146-N TYROL TWP. COOPERSTOWN TYROL TWP. R-59-W

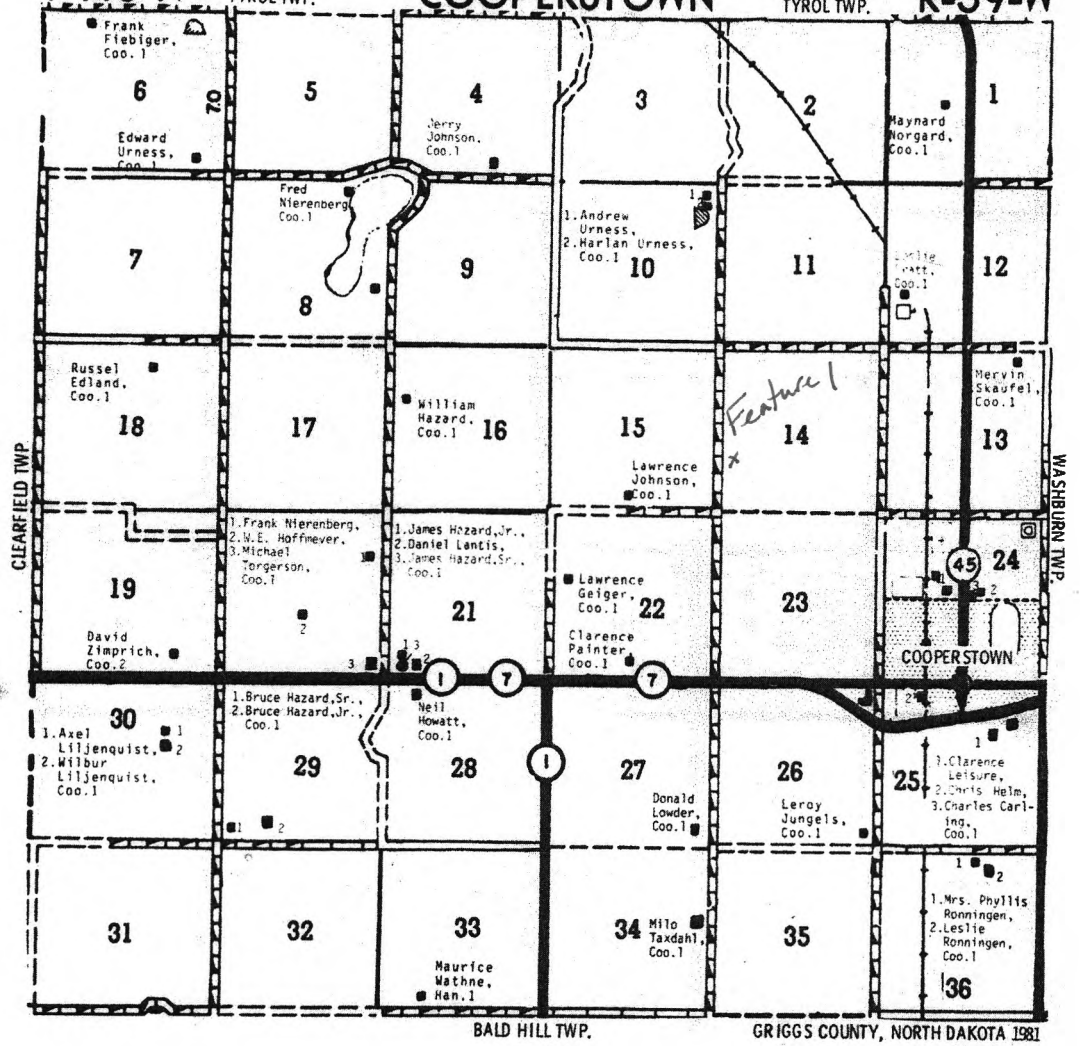

Retzlaff School 10/30/15 Kathy Wilner GG