

NDCRS ARCHITECTURAL SITE FORM PAGE 1

UPDATE

SITS# 32 GT 325

SITE IDENTIFICATION

Field Code Leipzig School

Site Name Leipzig School

Map Quad New Leipzig North
Map Quad 9

Site Name _____

LTL	TWP	<u>135</u>	R	<u>89</u>	SEC	<u>20</u>	QQQ	<u>7</u>	QQ	<u>6</u>	Q	<u>6</u>
LTL	TWP	_____	R	_____	SEC	_____	QQQ	_____	QQ	_____	Q	_____
LTL	TWP	_____	R	_____	SEC	_____	QQQ	_____	QQ	_____	Q	_____
LTL	TWP	_____	R	_____	SEC	_____	QQQ	_____	QQ	_____	Q	_____

UTM _____ N ZONE _____
 UTM _____ E NAD 1927 _____ NAD 1983 _____

Subsection:
 1 = N½
 2 = E½
 3 = S½
 4 = W½
 5 = NE¼
 6 = SE¼
 7 = SW¼
 8 = NW¼

City: Elgin ND

Street Number: _____

Street Name: 64th St SW

Urban Legal Description: _____

SITE DATA

Total # **Architectural** Features: 1

Fieldwork Date: 8/26/2012

Reconnaissance Survey Intensive Survey

Project Title & Supervisor:
Country Schoolhouse Project

Report Title & Author(s): _____

Additional Information: _____

SHSND USE

Area of Significance 2 Ecozone 23 Verified Site _____ CR Type 2
 Area of Significance _____ Ecozone _____ Non-Site _____
 Area of Significance _____

Recorded By Kathy Wilner Date Recorded 9/6/2012
 (First Name & Last Name) (mm/dd/year)

Instructions to complete a digital version of this form: (1) Download a copy to your hard drive; (2) Open the saved blank copy; (3) Fill out the form; (4) Use the Save As command to rename the form appropriately and save; (5) Print and submit to SHSND.

NN CODE LETTER

LEIPZIG

TOWNSHIP 135 N

RANGE 89W

T135N

R89W

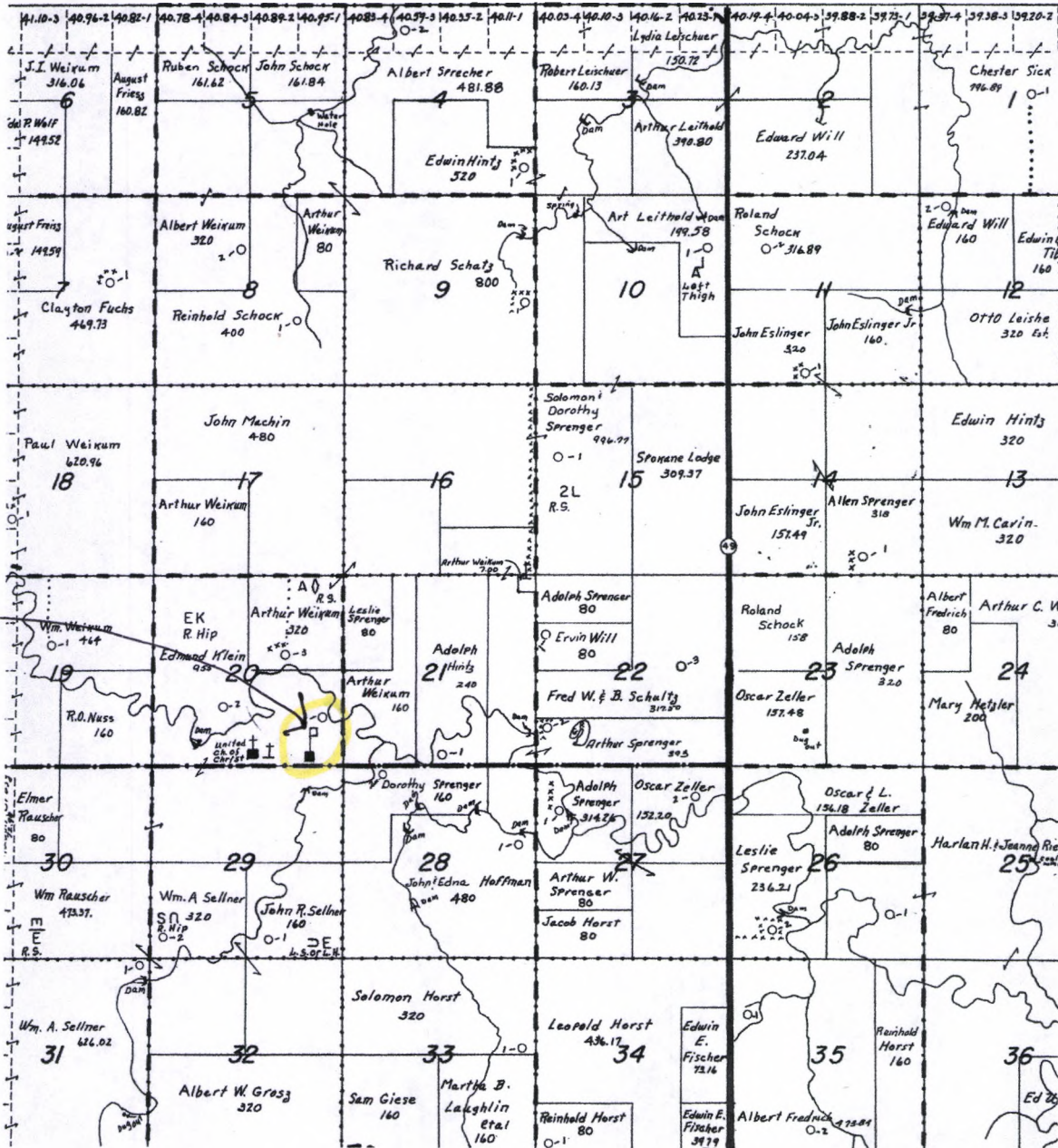

Feature

Leipzig School

8/26/2012 Kathy Wilner GT

NDCRS ARCHITECTURAL SITE FORM

PAGE 1

SITS# 32 GT 325

SITE IDENTIFICATION

Field Code Leipzig School

Site Name Leipzig School

Map Quad New Leipzig North

Site Name _____

LTL	TWP	<u>135</u>	R	<u>89</u>	SEC	<u>20</u>	QQQ	<u>7</u>	QQ	<u>7</u>	Q	<u>6</u>
LTL	TWP	_____	R	_____	SEC	_____	QQQ	_____	QQ	_____	Q	_____
LTL	TWP	_____	R	_____	SEC	_____	QQQ	_____	QQ	_____	Q	_____
LTL	TWP	_____	R	_____	SEC	_____	QQQ	_____	QQ	_____	Q	_____

UTM _____ N ZONE _____
 UTM _____ E NAD 1927 _____ NAD 1983 _____

Subsection:
 1 = N½
 2 = E½
 3 = S½
 4 = W½
 5 = NE¼
 6 = SE¼
 7 = SW¼
 8 = NW¼

City: Elgin ND

Street Number: _____

Street Name: 64th St SW

Urban Legal Description: _____

SITE DATA

Total # **Architectural** Features: 1

Fieldwork Date: 8/26/2012

Reconnaissance Survey Intensive Survey _____

Project Title & Supervisor:
Country Schoolhouse Project

Report Title & Author(s): _____

Additional Information: _____

SHSND USE
 Area of Significance 2 Ecozone 23 Verified Site _____ CR Type 2
 Area of Significance _____ Ecozone _____ Non-Site _____
 Area of Significance _____

Recorded By Kathy Wilner Date Recorded 9/6/2012
 (First Name & Last Name) (mm/dd/year)

Instructions to complete a digital version of this form: (1) Download a copy to your hard drive; (2) Open the saved blank copy; (3) Fill out the form; (4) Use the Save As command to rename the form appropriately and save; (5) Print and submit to SHSND.

**NDCRS ARCHITECTURAL SITE FORM
PAGE 2—Feature Data**

Field Code Leipzig School

SITS# 32 GT

Complete one Page 2 for each architectural feature at the site.

Architectural Feature # 1

Construction Date _____

Feature Type 9

Condition 7

Feature Date 5

Context 7

Plan Shape 5

Structural System 25

Primary Exterior 26

Style Other Style

Original Owner's Ethnicity _____

Secondary Exterior 16

Architect/Builder _____

Other Information:

Foundation poured concrete Stories 1

Roof/Cornice Gable on the main part of the school, shed on the back addition

Window double hung with one small, fixed pane window.

Dating Method(s): professional estimate of NY

Feature Preservation Recommendation(s) (Check all that apply):

Individual nomination

Contributes to a potential district

No nomination potential

Will not contribute to a district

Potential district—feature would be a contributing element if other properties constitute a district

Thematic nomination potential

Component of a historic site or landscape

Moved (specify all applicable choices)—a) relocation occurred within a historic period; b) recreates original site, orientation, landscape, & spatial relationships; c) compatible in context with neighboring structures; d) relocation has damaged eligibility

Historical associations require further investigation

Recorded By Kathy Wilner Date Recorded 9/6/2012
(First Name & Last Name) (mm/dd/year)

Instructions to complete a digital version of this form: (1) Download a copy to your hard drive; (2) Open the saved blank copy; (3) Fill out the form; (4) Use the Save As command to rename the form appropriately and save; (5) Print and submit to SHSND.

NDCRS ARCHITECTURAL SITE FORM
PAGE 3—Feature DataField Code Leipzig SchoolSITS# 32 GT**Complete a Page 3 for each feature.****1. Feature Description, Integrity, Eligibility:**

This is an example of a well kept one-room prairie school. The building has metal roofing with newer, concrete block chimney at the north end of the school. There is also a vent near the peak of the roof on the south side. The building is being used for 4-H meetings as well as township meetings. The school is large at 32 feet three inches north to south with the shed adding another 12 feet. The width of the school is 24 feet with the shed measuring 14 feet east to west. The building has 6 inch lap siding with 4 inch trim boards at the corners. There is an 8 inch trim board under the roof line. The east side has one small fixed pane window in the entry and 7 double hung windows in the main body of the school. Also on the east side is a door giving access into the rear addition. There is a wood porch/step with a ramp for access to the school. The door to the school itself is a hollow core, more modern door. Electricity is present with wires leading to the school and the meter on the east side.

The walls and ceiling in the entry and school are all beadboard planking. There are ceiling lights inside, in the main part of the school the lights are on long chains and I suspect they once had globes. As you enter the main body of the school there is space around to the left where coat hooks are along the west wall of the entry and the south wall of the large room. The floor is tongue and groove. There is a furnace at the north end of the large room and the furnace is propane today. There are blackboards along the north wall, either side of the furnace. In the addition there is an old oil burning stove and I am thinking that was the fuel of choice years ago. The addition at the rear of the school is bare board studs and siding, no effort was made to insulate this area. Some of the old school desks remain in the school.

Recorded By Kathy Wilner Date Recorded 9/6/2012
(First Name & Last Name) (mm/dd/year)

Instructions to complete a digital version of this form: (1) Download a copy to your hard drive; (2) Open the saved blank copy; (3) Fill out the form; (4) Use the Save As command to rename the form appropriately and save; (5) Print and submit to SHSND.

**NDCRS ARCHITECTURAL SITE FORM
PAGE 4—SITE DESCRIPTION**

Field Code Leipzig School

SITS# 32 GT

Complete one Page 4 for the entire site.

2. Owner's Contact Information:

More than likely the Leipzig Township

3. Access (to rural areas):

North of Elgin on Highway 49 (from Highway 21/49 junction) 6 miles. Turn left and go west about 2.2 miles the school will be on your right.

4. Site Area (ft²): _____

5. Description of **SETTING**:

There is a large farm to the northeast of the school with pasture or cropland all other sides. It is slightly rolling with a small stream running near to the northeast.

Recorded By Kathy Wilner Date Recorded 9/6/2012
(First Name & Last Name) (mm/dd/year)

Instructions to complete a digital version of this form: (1) Download a copy to your hard drive; (2) Open the saved blank copy; (3) Fill out the form; (4) Use the Save As command to rename the form appropriately and save; (5) Print and submit to SHSND.

**NDCRS ARCHITECTURAL SITE FORM
PAGE 5—SITE DESCRIPTION**

Field Code Leipzig School

SITS# 32 GT

6. Summary of ALL Site Features & Evaluation of Significance:

7. References/Comments:

Kathy Wilner
366 43rd Ave SE
Bowdon ND 58418

Recorded By Kathy Wilner Date Recorded 9/6/2012
(First Name & Last Name) (mm/dd/year)

Instructions to complete a digital version of this form: (1) Download a copy to your hard drive; (2) Open the saved blank copy; (3) Fill out the form; (4) Use the Save As command to rename the form appropriately and save; (5) Print and submit to SHSND.



Leipzig School

South Side

8/26/2012

Kathy Wilner

GT

Leipzig School

East Side

8/26/2012

Kathy Wilner

GT





Leipzig School West Side 8/26/2012 Kathy Wilner GT

Leipzig School North Side 8/26/2012 Kathy Wilner GT





Address Elgin, ND 58533

Get Google Maps on your phone
Text the word "GMAPS" to 466453



Feature

Leipzig School

8/26/12

Kathy Winer

ST