

NDCRS ARCHITECTURAL SITE FORM PAGE 1

SITS# 32 GV

334

SITE IDENTIFICATION

Field Code Trotters School

Site Name Trotters School

Map Quad Trotters
Map Quad _____

Site Name _____

LTL	TWP	<u>144</u>	R	<u>104</u>	SEC	<u>17</u>	QQQ	<u>8</u>	QQ	<u>8</u>	Q	<u>8</u>
LTL	TWP	_____	R	_____	SEC	_____	QQQ	_____	QQ	_____	Q	_____
LTL	TWP	_____	R	_____	SEC	_____	QQQ	_____	QQ	_____	Q	_____
LTL	TWP	_____	R	_____	SEC	_____	QQQ	_____	QQ	_____	Q	_____

UTM 5238790 N ZONE 13N
 UTM 583347 E NAD 1927 NAD 1983

Subsection:
1 = N $\frac{1}{2}$
2 = E $\frac{1}{2}$
3 = S $\frac{1}{2}$
4 = W $\frac{1}{2}$
5 = NE $\frac{1}{4}$
6 = SE $\frac{1}{4}$
7 = SW $\frac{1}{4}$
8 = NW $\frac{1}{4}$

City: _____

Street Number: _____

Street Name: Pearl Road

Urban Legal Description: _____

SITE DATA

Total # *Architectural* Features: 1

Fieldwork Date: 6/22/2016

Reconnaissance Survey Intensive Survey

Project Title & Supervisor:
Country Schoolhouse Project

Report Title & Author(s):

Additional Information: _____

SHSND USE

Area of Significance <u>2</u>	Ecozone <u>22</u>	Verified Site <u>1</u>	CR Type <u>2</u>
Area of Significance _____	Ecozone _____	Non-Site _____	
Area of Significance _____			

Recorded By Kathy Wilner Date Recorded 1/25/2017
 (First Name & Last Name) (mm/dd/year)

Instructions to complete a digital version of this form: (1) Download a copy to your hard drive; (2) Open the saved blank copy; (3) Fill out the form; (4) Use the Save As command to rename the form appropriately and save; (5) Print and submit to SHSND.

**NDCRS ARCHITECTURAL SITE FORM
PAGE 2—Feature Data**

Field Code Trotters School

SITS# 32 GV

Complete one Page 2 for each architectural feature at the site.

Architectural Feature # 1

Construction Date 1914

Feature Type 9

Condition 6

Feature Date 3

Context 7

Plan Shape 5

Structural System 25

Primary Exterior 5

Style Other Style

Original Owner's Ethnicity _____

Secondary Exterior _____

Architect/Builder _____

Other Information:

Foundation Concrete Stories 1

Roof/Cornice Gable

Window Double hung, replacement

Dating Method(s): School History

Feature Preservation Recommendation(s) (Check all that apply):

- Individual nomination
- Contributes to a potential district
- No nomination potential
- Will not contribute to a district
- Potential district—feature would be a contributing element if other properties constitute a district
- Thematic nomination potential
- Component of a historic site or landscape
- Moved (specify all applicable choices)—a) relocation occurred within a historic period; b) recreates original site, orientation, landscape, & spatial relationships; c) compatible in context with neighboring structures; d) relocation has damaged eligibility
- Historical associations require further investigation

Recorded By Kathy Wilner Date Recorded 1/25/2017
(First Name & Last Name) (mm/dd/year)

Instructions to complete a digital version of this form: (1) Download a copy to your hard drive; (2) Open the saved blank copy; (3) Fill out the form; (4) Use the Save As command to rename the form appropriately and save; (5) Print and submit to SHSND.

NDCRS ARCHITECTURAL SITE FORM
PAGE 3—Feature DataField Code Trotters SchoolSITS# 32 GV**Complete a Page 3 for each feature.****1. Feature Description, Integrity, Eligibility:**

The feature is a one room prairie school that has been converted for use as a house, it is sitting on a concrete foundation with a concrete step at the porch. The gable roof of the building is covered with wood shakes with metal capping and finials. There is a red brick chimney at the peak of the roof at the west end of the building. The soffits are closed. The building measures 26 feet east to west by 20 feet north to south.

the siding on the building is 10 inch composit lap siding. There are three double hung, replacment windows on the north side, two on the south side and one on the east end. Another window is located to the right of the door which is also a combination door with a solid core locked door. A porch cuts into the school proper at the southeast corner and measures 12 feet by 4 feet deep. The walls and ceiling are wallboard and the floor is tongue and groove hardwood. The entry floor is covered with tile. There is no wainscot or blackboard. Light fixtures suggest electricity. There is a fule tank located at the west end of the school.

The school was built in 1914. In the late 30's the Trotter School was moved to be available to more families. Ifclosed in 1967.

Recorded By Kathy Wilner Date Recorded 1/25/2017
(First Name & Last Name) (mm/dd/year)

Instructions to complete a digital version of this form: (1) Download a copy to your hard drive; (2) Open the saved blank copy; (3) Fill out the form; (4) Use the Save As command to rename the form appropriately and save; (5) *Print and submit to SHSND.*

**NDCRS ARCHITECTURAL SITE FORM
PAGE 4—SITE DESCRIPTION**Field Code Trotters SchoolSITS# 32 GV**Complete one Page 4 for the entire site.****2. Owner's Contact Information:**

George Nellerhoe
891 Pearl Rd
Trotters ND 58657

3. Access (to rural areas):

Two miles south of Trotters, an unincorporated village, on Highway 16 to Black Tail Rd, turn left and go east 1 mile to see the school on the right had side.

4. Site Area (ft²): _____**5. Description of *SETTING*:**

Prairie, pasture and it is all very hilly. There is a ranch at the corner of Highway 16 and Blacktail road.

Recorded By Kathy Wilner Date Recorded 1/25/2017
(First Name & Last Name) (mm/dd/year)

Instructions to complete a digital version of this form: (1) Download a copy to your hard drive; (2) Open the saved blank copy; (3) Fill out the form; (4) Use the Save As command to rename the form appropriately and save; (5) *Print* and submit to SHSND.

**NDCRS ARCHITECTURAL SITE FORM
PAGE 5—SITE DESCRIPTION**

Field Code Trotters School

SITS# 32_GV

6. Summary of ALL Site Features & Evaluation of Significance:

7. References/Comments:

Kathy Wilner
366 43rd Ave SE
Bowdon ND 58418

Recorded By Kathy Wilner Date Recorded 1/25/2017
(First Name & Last Name) (mm/dd/year)

Instructions to complete a digital version of this form: (1) Download a copy to your hard drive; (2) Open the saved blank copy; (3) Fill out the form; (4) Use the Save As command to rename the form appropriately and save; (5) Print and submit to SHSND.



East Side

Trotters School

6/22/2016

Kathy Wilner

GV

South
Side





West Side

Trotters
School

6/22/2016

Kathy Wilner

GV

North Side



bing maps

Notes

Trotters School

6/22/2016

Kathy Wilner

GV

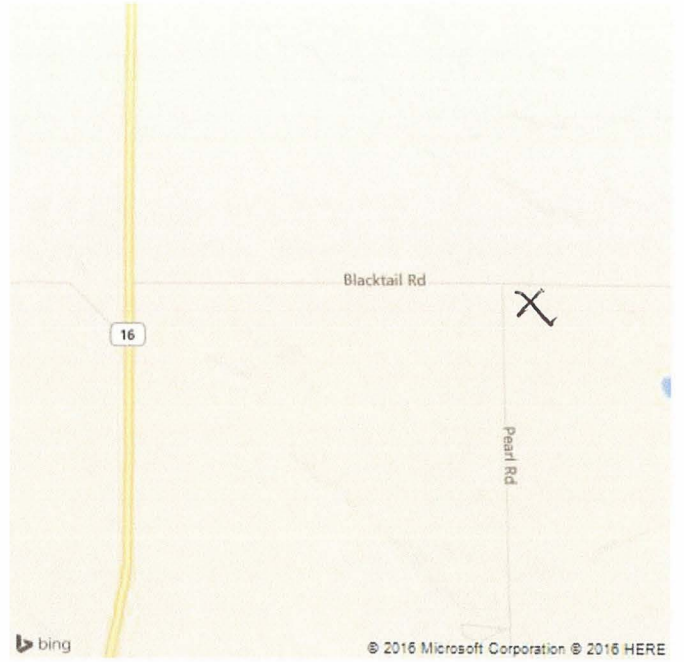

Feature