

NDCRS ARCHITECTURAL SITE FORM PAGE 1

SITS# 32 GV 348

SITE IDENTIFICATION

Field Code Carew Harding School

Site Name Carew Harding School
Site Name _____

Map Quad Alpha
Map Quad _____

LTL	TWP	<u>137</u>	R	<u>104</u>	SEC	<u>20</u>	QQQ	<u>5</u>	QQ	<u>8</u>	Q	<u>5</u>
LTL	TWP	_____	R	_____	SEC	_____	QQQ	_____	QQ	_____	Q	_____
LTL	TWP	_____	R	_____	SEC	_____	QQQ	_____	QQ	_____	Q	_____
LTL	TWP	_____	R	_____	SEC	_____	QQQ	_____	QQ	_____	Q	_____

UTM 5169411 N ZONE 13N
 UTM 589839 E NAD 1927 NAD 1983

Subsection:
1 = N $\frac{1}{2}$
2 = E $\frac{1}{2}$
3 = S $\frac{1}{2}$
4 = W $\frac{1}{2}$
5 = NE $\frac{1}{4}$
6 = SE $\frac{1}{4}$
7 = SW $\frac{1}{4}$
8 = NW $\frac{1}{4}$

City: _____
 Street Number: _____
 Street Name: 51st St SW
 Urban Legal Description: _____

SITE DATA

Total # *Architectural* Features: 1

Fieldwork Date: 6/22/2016

Reconnaissance Survey Intensive Survey

Project Title & Supervisor:
Country Schoolhouse Project

Report Title & Author(s): _____

Additional Information: _____

SHSND USE	<u>2</u>	Ecozone	<u>22</u>	Verified Site	<u>1</u>	CR Type	<u>2</u>
Area of Significance	_____	Ecozone	_____	Non-Site	_____		
Area of Significance	_____						

Recorded By Kathy Wilner Date Recorded 1/27/2017
 (First Name & Last Name) (mm/dd/year)

Instructions to complete a digital version of this form: (1) Download a copy to your hard drive; (2) Open the saved blank copy; (3) Fill out the form; (4) Use the Save As command to rename the form appropriately and save; (5) Print and submit to SHSND.

NDCRS ARCHITECTURAL SITE FORM
PAGE 2—Feature Data

Field Code Carew Harding School

SITS# 32 GV

Complete one Page 2 for each architectural feature at the site.

Architectural Feature # 1

Construction Date 1915

Feature Type 9

Condition 6

Feature Date 3

Context 7

Plan Shape 5

Structural System 25

Primary Exterior 26

Style Other Style

Original Owner's Ethnicity

Secondary Exterior

Architect/Builder

Other Information:

Foundation Concrete Stories 1

Roof/Cornice Gable

Window Shuttered

Dating Method(s): School history

Feature Preservation Recommendation(s) (Check all that apply):

- Individual nomination
Contributes to a potential district
No nomination potential
Will not contribute to a district
Potential district—feature would be a contributing element if other properties constitute a district
Thematic nomination potential
Component of a historic site or landscape
Moved (specify all applicable choices)—a) relocation occurred within a historic period; b) recreates original site, orientation, landscape, & spatial relationships; c) compatible in context with neighboring structures; d) relocation has damaged eligibility
Historical associations require further investigation

Recorded By Kathy Wilner Date Recorded 1/27/2017
(First Name & Last Name) (mm/dd/year)

Instructions to complete a digital version of this form: (1) Download a copy to your hard drive; (2) Open the saved blank copy; (3) Fill out the form; (4) Use the Save As command to rename the form appropriately and save; (5) Print and submit to SHSND.

**NDCRS ARCHITECTURAL SITE FORM
PAGE 3—Feature Data**Field Code Carew Harding SchoolSITS# 32 GV**Complete a Page 3 for each feature.****1. Feature Description, Integrity, Eligibility:**

The feature is a one room prairie school on a concrete foundation. The building was moved to the current location to be used for storage. The gable roof is covered with asphalt shingles on the south side and corrugated tin on the north side. The chimney is gone. The building measures 24 feet north to south and 20 feet east to west.

There is a wide trim board at the top of the wall under the soffits on the peak ends. The remainder of the siding is 6 inch wood lap with 6 inch wood corner trim. There are two shuttered windows on the south side, two shuttered windows either side of a 5 panel locked door on the east side, another 5 panel entry door is at the north side of the west wall. On the north wall there is a shuttered window to the left of an overhead door, installed to give access for storage. Some of the double hung, two over two, windows have glass and are seen on the inside of the building. The ceiling and walls are covered with beadboard and there is vertical beadboard wainscot. The floor is tongue and groove hardwood. Light fixtures on the ceiling suggest electricity was present at some point.

This school was built in 1915 and operated until 1943.

Recorded By Kathy Wilner Date Recorded 1/27/2017
(First Name & Last Name) (mm/dd/year)

Instructions to complete a digital version of this form: (1) Download a copy to your hard drive; (2) Open the saved blank copy; (3) Fill out the form; (4) Use the Save As command to rename the form appropriately and save; (5) *Print* and submit to SHSND.

**NDCRS ARCHITECTURAL SITE FORM
PAGE 4—SITE DESCRIPTION**Field Code Carew Harding SchoolSITS# 32 GV**Complete one Page 4 for the entire site.****2. Owner's Contact Information:**

Ted Nunbert Family Trust
1306 N 26th St
Bismarck ND 58501

3. Access (to rural areas):

South of Golva on Highway 16 5 miles to 52nd St SW, turn left and drive east 8 miles to 160th Ave SW, turn left and drive north 1 mile to 51st St SW and turn left again and drive 1/4 mile west to see the farm on the south side of the road.

4. Site Area (ft²): _____**5. Description of *SETTING*:**

The building is on an abandoned farm with buildings to the north, trees to the east, farm fields to the north and pasture other directions.

Recorded By Kathy Wilner Date Recorded 1/27/2017
(First Name & Last Name) (mm/dd/year)

Instructions to complete a digital version of this form: (1) Download a copy to your hard drive; (2) Open the saved blank copy; (3) Fill out the form; (4) Use the Save As command to rename the form appropriately and save; (5) *Print* and submit to SHSND.

**NDCRS ARCHITECTURAL SITE FORM
PAGE 5—SITE DESCRIPTION**

Field Code Carew Harding School

SITS# 32 GV

6. Summary of ALL Site Features & Evaluation of Significance:

7. References/Comments:

Kathy Wilner
366 43rd Ave SE
Bowdon ND 58418

Recorded By Kathy Wilner Date Recorded 1/27/2017
(First Name & Last Name) (mm/dd/year)

Instructions to complete a digital version of this form: (1) Download a copy to your hard drive; (2) Open the saved blank copy; (3) Fill out the form; (4) Use the Save As command to rename the form appropriately and save; (5) Print and submit to SHSND.



North Side

Carew Harding School

6/22/2016

Kathy Wilner

GV

West Side





East Side

Carew Harding School

6/22/2016

Kathy Wilner

GV

South Side





Notes

Carew/Harding School

6/22/2016

Kathy Wilner

GV

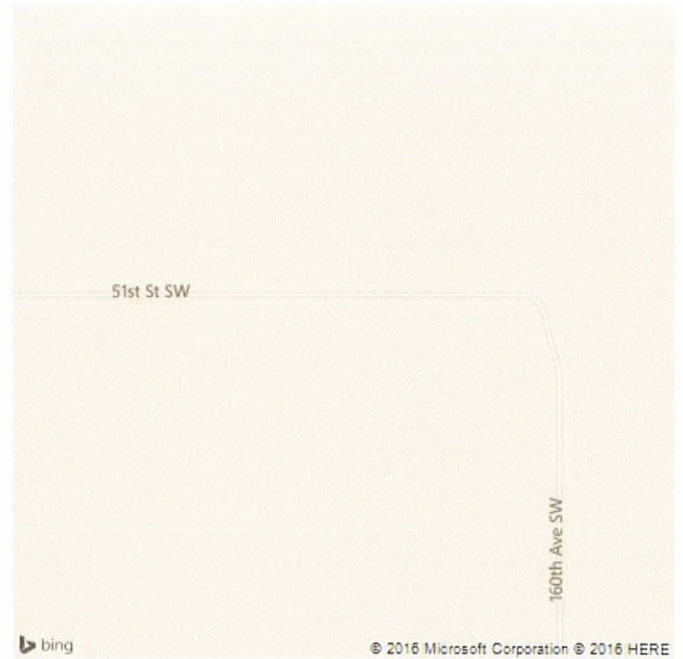

Feature