

NDCRS ARCHITECTURAL SITE FORM PAGE 1

SITS# 32 LM 272

SITE IDENTIFICATION

Field Code Pamona View #2 Site Name Pamona View #2

Map Quad Grand Rapids
Map Quad _____
Site Name _____

LTL	TWP	<u>134</u>	R	<u>61</u>	SEC	<u>5</u>	QQQ	<u>8</u>	QQ	<u>5</u>	Q	<u>5</u>
LTL	TWP	_____	R	_____	SEC	_____	QQQ	_____	QQ	_____	Q	_____
LTL	TWP	_____	R	_____	SEC	_____	QQQ	_____	QQ	_____	Q	_____
LTL	TWP	_____	R	_____	SEC	_____	QQQ	_____	QQ	_____	Q	_____

UTM _____ N ZONE _____
UTM _____ E NAD 1927 _____ NAD 1983 _____

Subsection:
1 = N $\frac{1}{2}$
2 = E $\frac{1}{2}$
3 = S $\frac{1}{2}$
4 = W $\frac{1}{2}$
5 = NE $\frac{1}{4}$
6 = SE $\frac{1}{4}$
7 = SW $\frac{1}{4}$
8 = NW $\frac{1}{4}$

City: Grand Rapids
Street Number: 9789
Street Name: 66th St SE
Urban Legal Description: _____

SITE DATA

Total # **Architectural** Features: 1

Fieldwork Date: 11/4/2014

Reconnaissance Survey Intensive Survey

Project Title & Supervisor:
Country Schoolhouse Project

Report Title & Author(s):

Additional Information: _____

SHSND USE

Area of Significance <u>2</u>	Ecozone <u>18</u>	Verified Site <u>1</u>	CR Type <u>2</u>
Area of Significance _____	Ecozone _____	Non-Site _____	
Area of Significance _____			

Recorded By Kathy Wilner Date Recorded 2/25/2015
(First Name & Last Name) (mm/dd/year)

Instructions to complete a digital version of this form: (1) Download a copy to your hard drive; (2) Open the saved blank copy; (3) Fill out the form; (4) Use the Save As command to rename the form appropriately and save; (5) Print and submit to SHSND.

**NDCRS ARCHITECTURAL SITE FORM
PAGE 2—Feature Data**

Field Code Pamona View #2

SITS# 32 LM

Complete one Page 2 for each architectural feature at the site.

Architectural Feature # 1

Construction Date 1912

Feature Type 9

Condition 7

Feature Date 3

Context 7

Plan Shape 5

Structural System 25

Primary Exterior 18

Style Other Style

Original Owner's Ethnicity _____

Secondary Exterior _____

Architect/Builder _____

Other Information:

Foundation Concrete pillars Stories 1

Roof/Cornice Hip with gable on the entry, bellcast

Window Double hung

Dating Method(s): museum records

Feature Preservation Recommendation(s) (Check all that apply):

- Individual nomination
- Contributes to a potential district
- No nomination potential
- Will not contribute to a district
- Potential district—feature would be a contributing element if other properties constitute a district
- Thematic nomination potential
- Component of a historic site or landscape
- Moved (specify all applicable choices)—a) relocation occurred within a historic period; b) recreates original site, orientation, landscape, & spatial relationships; c) compatible in context with neighboring structures; d) relocation has damaged eligibility
- Historical associations require further investigation

Recorded By Kathy Wilner
(First Name & Last Name)

Date Recorded 2/25/2015
(mm/dd/year)

Instructions to complete a digital version of this form: (1) Download a copy to your hard drive; (2) Open the saved blank copy; (3) Fill out the form; (4) Use the Save As command to rename the form appropriately and save; (5) Print and submit to SHSND.

**NDCRS ARCHITECTURAL SITE FORM
PAGE 3—Feature Data**Field Code Pamona View #2SITS# 32 LM**Complete a Page 3 for each feature.****1. Feature Description, Integrity, Eligibility:**

The feature is a wood framed one room prairie school on concrete pillars. The school was moved to this location prior to 1982. It is a beautifully restored and cared for building. The school was built in 1912. The roof, hip on the main body and gable on the entry, is covered with asphalt shingles and there is a beautiful bell tower above the entry with a bell inside. The flagpole is at the tip of the cupola roof. There is not a chimney. The soffits are closed with original beadboard. The school measures 36 feet north to south and 24 feet east to west with the entry measuring 8 feet east to west by 10 feet north to south.

There is a wide header running under the eaves on all four sides of the main body of the school and also a header under the eaves of the entry. The siding is vinyl siding, put on after all the rotting wood lap siding was removed. Corners are 4 inch vinyl trim. The entry door is glass and 2 panel wood with a half moon transom window above it. There are two smaller windows in the entry, one north and the other south. A double hung window faces south from the coatroom. One small, fixed pane window can be seen high on the south end of the west wall. Two large double hung windows face north and 5 more face east out of the main school room. Most of the old glass of the large windows was replaced and windows were rebuilt to the old dimensions. The entry is a small room leading into a coat room that spans the entire south side of the school. They used to have two bathrooms in this part of the building, removed to have open space for display of school artifacts. The flooring in the building narrow hardwood beautifully finished. The walls and ceiling in the school are sheet rock with original wainscoting. The ceiling is high and there is a trim board running around all the walls about 2 feet down. Blackboards are on the west wall and the south wall of the main body of the school. Heat was coal. There are light fixtures and wiring giving evidence of electricity.

The school is furnished and really lovely.

Recorded By Kathy Wilner Date Recorded 2/25/2015
(First Name & Last Name) (mm/dd/year)

Instructions to complete a digital version of this form: (1) Download a copy to your hard drive; (2) Open the saved blank copy; (3) Fill out the form; (4) Use the Save As command to rename the form appropriately and save; (5) Print and submit to SHSND.

**NDCRS ARCHITECTURAL SITE FORM
PAGE 4—SITE DESCRIPTION**Field Code Pamona View #2SITS# 32 LM**Complete one Page 4 for the entire site.**

2. Owner's Contact Information:

LaMoure County

3. Access (to rural areas):

From Grand Rapids drive north on 98th Ave SE about 1 mile and follow signs to LaMoure County Memorial Park. You will turn onto 66th St SE to reach the park and museum.

4. Site Area (ft²): _____5. Description of **SETTING**:

The school is located in a memorial park area with a large museum building to the south, another to the south east and the James River to the north. There are trees scattered around and to the north and northeast there is a campground.

Recorded By Kathy Wilner Date Recorded 2/25/2015
(First Name & Last Name) (mm/dd/year)

Instructions to complete a digital version of this form: (1) Download a copy to your hard drive; (2) Open the saved blank copy; (3) Fill out the form; (4) Use the Save As command to rename the form appropriately and save; (5) *Print* and submit to SHSND.

**NDCRS ARCHITECTURAL SITE FORM
PAGE 5—SITE DESCRIPTION**

Field Code Pamona View #2

SITS# 32 LM

6. Summary of ALL Site Features & Evaluation of Significance:

7. References/Comments:

Kathy Wilner
366 43rd Ave SE
Bowdon ND 58418

Recorded By Kathy Wilner Date Recorded 2/25/2015
(First Name & Last Name) (mm/dd/year)

Instructions to complete a digital version of this form: (1) Download a copy to your hard drive; (2) Open the saved blank copy; (3) Fill out the form; (4) Use the Save As command to rename the form appropriately and save; (5) Print and submit to SHSND.



East Side

Pamona View #2

11/4/2014

Kathy Wilner

LM

North Side





South Side

Pamona View #2

11/4/2014

Kathy Wilner

LM

West Side



GRANDVIEW DIRECTORY

T-135-N

CODE: AK

R-61-W

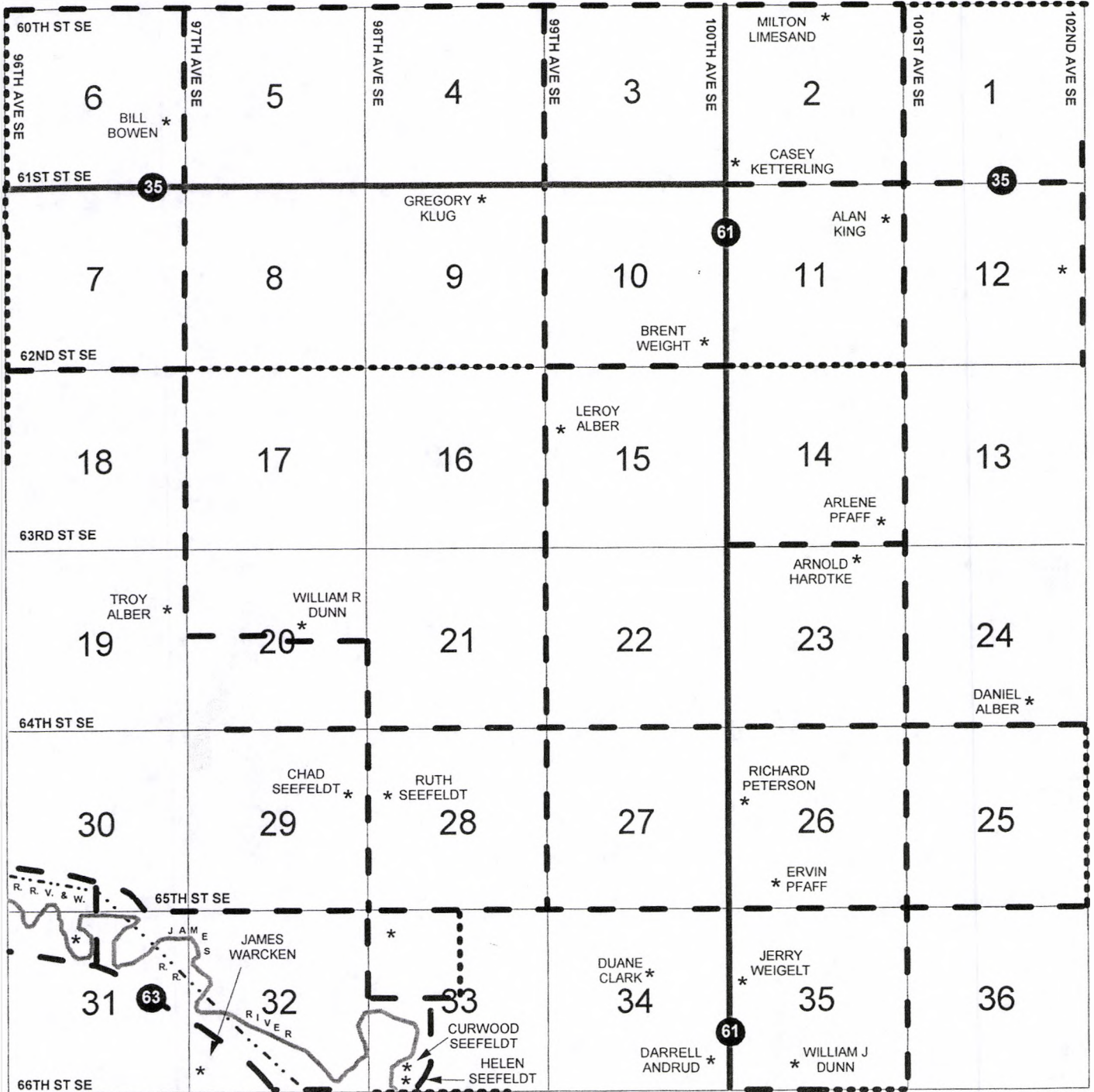

Pamona View #2 11-4-2014

Kathy Wilner

LM

	R66W	R65W	R64W	R63W	R62W	R61W	R60W	R59W
T136N	AG	AP	AN	AA	BB	BC	AV	AO
T135N	AW	AD	AH	AZ	AY	AK	AF	AC
T134N	BD	AX	AQ	BE	AM	AJ	AT	AL
T133N	AR	AU	AI	BF	AB	AE	BA	AS