

# NDCRS ARCHITECTURAL SITE FORM PAGE 1

SITS# 32 LM 281

### SITE IDENTIFICATION

Field Code Norden Township School Site Name \_\_\_\_\_

Map Quad Kulm Site Name \_\_\_\_\_

Map Quad \_\_\_\_\_

LTL	TWP	<u>133</u>	R	<u>66</u>	SEC	<u>9</u>	QQQ	<u>7</u>	QQ	<u>7</u>	Q	<u>7</u>
LTL	TWP	_____	R	_____	SEC	_____	QQQ	_____	QQ	_____	Q	_____
LTL	TWP	_____	R	_____	SEC	_____	QQQ	_____	QQ	_____	Q	_____
LTL	TWP	_____	R	_____	SEC	_____	QQQ	_____	QQ	_____	Q	_____

UTM \_\_\_\_\_ N ZONE \_\_\_\_\_  
 UTM \_\_\_\_\_ E NAD 1927 \_\_\_\_\_ NAD 1983 \_\_\_\_\_

Subsection:
1 = N $\frac{1}{2}$
2 = E $\frac{1}{2}$
3 = S $\frac{1}{2}$
4 = W $\frac{1}{2}$
5 = NE $\frac{1}{4}$
6 = SE $\frac{1}{4}$
7 = SW $\frac{1}{4}$
8 = NW $\frac{1}{4}$

City: Kulm

Street Number: \_\_\_\_\_

Street Name: 66th Ave SE

Urban Legal Description: \_\_\_\_\_

### SITE DATA

Total # **Architectural** Features: 1

Fieldwork Date: 5/5/2016

Reconnaissance Survey  Intensive Survey

Project Title & Supervisor:  
Country Schoolhouse Project

Report Title & Author(s):

Additional Information: \_\_\_\_\_

<b>SHSND USE</b>	<u>2</u>	Ecozone	<u>18</u>	Verified Site	<u>1</u>	CR Type	<u>2</u>
Area of Significance	_____	Ecozone	_____	Non-Site	_____		
Area of Significance	_____						

Recorded By Kathy Wilner Date Recorded 1/10/2017  
(First Name & Last Name) (mm/dd/year)

*Instructions to complete a digital version of this form:* (1) Download a copy to your hard drive; (2) Open the saved blank copy; (3) Fill out the form; (4) Use the Save As command to rename the form appropriately and save; (5) *Print* and submit to SHSND.

**NDCRS ARCHITECTURAL SITE FORM**  
**PAGE 2—Feature Data**

Field Code Norden Township SchoolSITS# 32 LM

**Complete one Page 2 for each architectural feature at the site.**

Architectural Feature # 1

Construction Date \_\_\_\_\_

Feature Type 9Condition 4Feature Date 2Context 7Plan Shape 5Structural System 25Primary Exterior 22Style Other Style

Original Owner's Ethnicity \_\_\_\_\_

Secondary Exterior \_\_\_\_\_

Architect/Builder \_\_\_\_\_

Other Information:

Foundation Poured concrete Stories 1Roof/Cornice Gable, with a shed roof on the entryWindow Double hung, some glass and framing remainDating Method(s): Historical estimate

**Feature Preservation Recommendation(s) (Check all that apply):**

 Individual nomination Contributes to a potential district No nomination potential Will not contribute to a district Potential district—feature would be a contributing element if other properties constitute a district Thematic nomination potential Component of a historic site or landscape

Moved (specify all applicable choices)—a) relocation occurred within a historic period; b) recreates original site, orientation, landscape, & spatial relationships; c) compatible in context with neighboring structures; d) relocation has damaged eligibility

 Historical associations require further investigation

Recorded By Kathy Wilner Date Recorded 1/10/2017  
 (First Name & Last Name) (mm/dd/year)

*Instructions to complete a digital version of this form:* (1) Download a copy to your hard drive; (2) Open the saved blank copy; (3) Fill out the form; (4) Use the Save As command to rename the form appropriately and save; (5) *Print* and submit to SHSND.

**NDCRS ARCHITECTURAL SITE FORM  
PAGE 3—Feature Data**Field Code Norden Township SchoolSITS# 32 LM**Complete a Page 3 for each feature.****1. Feature Description, Integrity, Eligibility:**

The feature is a one room prairie school sitting on a poured concrete foundation. The gable roof is partially covered with asphalt shingles over wood planking. Metal capping with finials can be see at the peak of this roof that is sagging in the middle. There is a red brick chimney at the south end on the west slope and the chimney is partially covered with stucco or concrete. The soffits are closed. Some of the top bricks are missing. The entry roof is partially covered with asphalt shingles. The building measures 25 1/2 feet north to southe and 22 1/2 feet east to west with the entry being 8 feet by 10 feet.

The siding on the building is stucco over wood. Some of the stucco is falling away at the bottom of the school showing the original siding. Inside the entry there is the original 6 inch wood lap siding and it is not covered with stucco. The entry door is missing and there is a 5 panel wood door giving access to the main body of the school. The entry as well as the main body of the school are full of junk so didn't go into this one.

There is a window on the east wall of the entry, framing but no glass. There was also a bank of 5 windows on the east side, the windows were 6 paned double hung, today there is some glass and a lot of farming remaining. Remnants of window shades hang from the top of the window frames. The walls are covered with composite wallboard, the ceiling is gone. Could not see the floor. There was electricity present as noted by electric wires on the north side. A blackboard remained on the north wall.

Recorded By Kathy Wilner Date Recorded 1/10/2017  
(First Name & Last Name) (mm/dd/year)

*Instructions to complete a digital version of this form:* (1) Download a copy to your hard drive; (2) Open the saved blank copy; (3) Fill out the form; (4) Use the Save As command to rename the form appropriately and save; (5) *Print* and submit to SHSND.

**NDCRS ARCHITECTURAL SITE FORM  
PAGE 4—SITE DESCRIPTION**

Field Code Norden Township School

SITS# 32 LM

**Complete one Page 4 for the entire site.**

2. Owner's Contact Information:

Flegel Partnership LLP  
215 10th St SE  
Benson MN 56215

3. Access (to rural areas):

From Kulm, drive north a mile and 12 to 75th St SE, turn left (west) and drive two miles to 66th Ave SE and turn right to go north a little more than 1 mile. The school will be on the right.

4. Site Area (ft<sup>2</sup>): \_\_\_\_\_

5. Description of **SETTING**:

This school is located in a pasture with a slough to the northeast, pasture east and southeast with farm fields all other directions.

Recorded By Kathy Wilner Date Recorded 1/10/2017  
(First Name & Last Name) (mm/dd/year)

*Instructions to complete a digital version of this form: (1) Download a copy to your hard drive; (2) Open the saved blank copy; (3) Fill out the form; (4) Use the Save As command to rename the form appropriately and save; (5) Print and submit to SHSND.*

**NDCRS ARCHITECTURAL SITE FORM  
PAGE 5—SITE DESCRIPTION**

Field Code Norden Township School

SITS# 32 LM

**6. Summary of ALL Site Features & Evaluation of Significance:**

7. References/Comments:

Kathy Wilner  
366 43rd Ave SE  
Bowdon ND 58418

Recorded By Kathy Wilner Date Recorded 1/10/2017  
(First Name & Last Name) (mm/dd/year)

*Instructions to complete a digital version of this form: (1) Download a copy to your hard drive; (2) Open the saved blank copy; (3) Fill out the form; (4) Use the Save As command to rename the form appropriately and save; (5) Print and submit to SHSND.*



East Side

Norden Township School

5/5/2016

Kathy Wilner

LM

North Side





South Side

Norden Township School

5/5/2016

Kathy Wilner

LM

West Side



bing maps

Notes

Norden Township School

5/5/2016

Kathy Wilner

LM

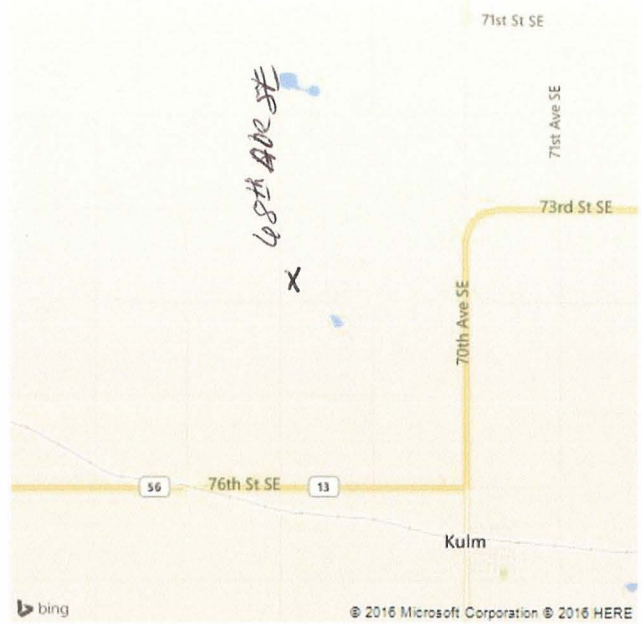

Feature