

# NDCRS ARCHITECTURAL SITE FORM PAGE 1

**UPDATE**

SITS# 32 MH x 297

### SITE IDENTIFICATION

Field Code Olivia Township School Site Name \_\_\_\_\_  
Site Name \_\_\_\_\_

Map Quad \_\_\_\_\_  
Map Quad \_\_\_\_\_

LTL	TWP	<u>151</u>	R	<u>79</u>	SEC	<u>28</u>	QQQ	<u>8</u>	QQ	<u>7</u>	Q	<u>7</u>
LTL	TWP	_____	R	_____	SEC	_____	QQQ	_____	QQ	_____	Q	_____
LTL	TWP	_____	R	_____	SEC	_____	QQQ	_____	QQ	_____	Q	_____
LTL	TWP	_____	R	_____	SEC	_____	QQQ	_____	QQ	_____	Q	_____

UTM \_\_\_\_\_ N ZONE \_\_\_\_\_  
UTM \_\_\_\_\_ E NAD 1927 \_\_\_\_\_ NAD 1983 \_\_\_\_\_

City: \_\_\_\_\_

Street Number: \_\_\_\_\_

Street Name: 10th Ave N

Urban Legal Description: \_\_\_\_\_

Subsection:
1 = N $\frac{1}{2}$
2 = E $\frac{1}{2}$
3 = S $\frac{1}{2}$
4 = W $\frac{1}{2}$
5 = NE $\frac{1}{4}$
6 = SE $\frac{1}{4}$
7 = SW $\frac{1}{4}$
8 = NW $\frac{1}{4}$

### SITE DATA

Total # **Architectural** Features: 1

Fieldwork Date: 6/20/2016

Reconnaissance Survey  Intensive Survey

Project Title & Supervisor:  
Country Schoolhouse Project

Report Title & Author(s):

Additional Information: \_\_\_\_\_

### SHSND USE

Area of Significance _____	Ecozone _____	Verified Site _____	CR Type _____
Area of Significance _____	Ecozone _____	Non-Site _____	
Area of Significance _____			

Recorded By Kathy Wilner Date Recorded 1/18/2017  
(First Name & Last Name) (mm/dd/year)

*Instructions to complete a digital version of this form: (1) Download a copy to your hard drive; (2) Open the saved blank copy; (3) Fill out the form; (4) Use the Save As command to rename the form appropriately and save; (5) Print and submit to SHSND.*

NDCRS ARCHITECTURAL SITE FORM
PAGE 2—Feature Data

UPDATE

Field Code Olivia Township School

SITS# 32 MH X 297

Complete one Page 2 for each architectural feature at the site.

Architectural Feature # 1

Construction Date Feature Type 9 Condition 5
Feature Date Context 7 Plan Shape 5
Structural System 25 Primary Exterior 26 Style Other Style
Original Owner's Ethnicity Secondary Exterior Architect/Builder

Other Information:

Foundation Poured concrete Stories 1

Roof/Cornice Gable

Window Double hung, most covered with some framing and little glass

Dating Method(s):

Feature Preservation Recommendation(s) (Check all that apply):

- Individual nomination
Contributes to a potential district
No nomination potential
Will not contribute to a district
Potential district—feature would be a contributing element if other properties constitute a district
Thematic nomination potential
Component of a historic site or landscape
Moved (specify all applicable choices)—a) relocation occurred within a historic period; b) recreates original site, orientation, landscape, & spatial relationships; c) compatible in context with neighboring structures; d) relocation has damaged eligibility
Historical associations require further investigation

Recorded By Kathy Wilner Date Recorded 1/18/2017
(First Name & Last Name) (mm/dd/year)

Instructions to complete a digital version of this form: (1) Download a copy to your hard drive; (2) Open the saved blank copy; (3) Fill out the form; (4) Use the Save As command to rename the form appropriately and save; (5) Print and submit to SHSND.

**NDCRS ARCHITECTURAL SITE FORM  
PAGE 5—SITE DESCRIPTION**

**UPDATE**

Field Code Olivia Township School

SITS# 32 MH X 297

**6. Summary of ALL Site Features & Evaluation of Significance:**

7. References/Comments:

Kathy Wilner  
366 43rd Ave SE  
Bowdon ND 58418

Recorded By Kathy Wilner Date Recorded 1/18/2017  
(First Name & Last Name) (mm/dd/year)

*Instructions to complete a digital version of this form: (1) Download a copy to your hard drive; (2) Open the saved blank copy; (3) Fill out the form; (4) Use the Save As command to rename the form appropriately and save; (5) Print and submit to SHSND.*





East Side

Olivia Township School

6/20/2016

Kathy Wilner

MH

North  
Side







North Side

Olivia Township School

6/20/2016

Kathy Wilner

MH

West Side







Notes

Olivia Township School

6/20/2016

Kathy Wilner

MH

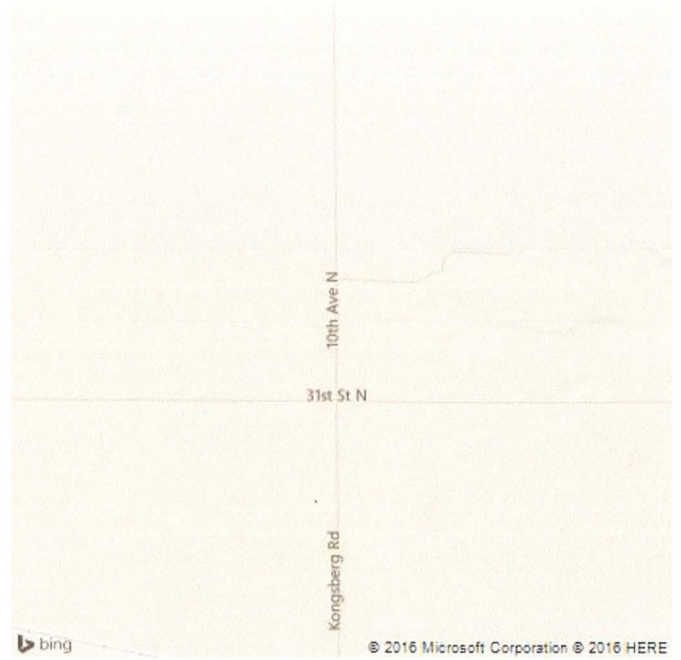

Feature