

NDCRS ARCHITECTURAL FORM

PAGE 1

UPDATE

Field Code _____

SITS# 32 ML 786 _____

Map Quad _____

Site Name _____

Map Quad _____

Site Name _____

LTL ___ T. ___ N., R. ___ W., Sec. ___ QQQ ___ of the QQ ___ of the Q ___

LTL ___ T. ___ N., R. ___ W., Sec. ___ QQQ ___ of the QQ ___ of the Q ___

LTL ___ T. ___ N., R. ___ W., Sec. ___ QQQ ___ of the QQ ___ of the Q ___

LTL ___ T. ___ N., R. ___ W., Sec. ___ QQQ ___ of the QQ ___ of the Q ___

NAD _____ UTM _____ Zone _____

NAD _____ UTM _____

City: _____

Subsection
1 = N½
2 = E½
3 = S½
4 = W½
5 = NE¼
6 = SE¼
7 = SW¼
8 = NW¼

Street Number: _____

Street Name: _____

Urban Legal Description: _____

Total Number of Architectural Features: _____

Fieldwork Date: _____

Reconnaissance Survey _____

Intensive Survey _____

Project & Principal Investigator:

Contracting Firm or Agency Completing the Form:

SHSND

Additional Information:

based on map checks by Kathy Wilner and aerial imagery

SHSND USE
 Component _____ Study Unit _____ Verified Site _____ CR Type _____
 Component _____
 Component _____

Recorded By: Lorna Meidinger Date Recorded: 02/02/2022

Form instructions: (1) Download; (2) Save A Copy; (3) Submit a paper copy of the form to the SHSND and upload the PDF version of the form and corresponding GIS shapefiles to the ND SHPO-run FTP site.

NDCRS ARCHITECTURAL FORM

PAGE 2 – Feature Data

UPDATE

Field Code _____

SITS# 32 ML 786 _____

Complete one Page 2 for each architectural feature at the site.

Architectural Feature # 1

Construction Date _____

Feature Date _____

Structural System _____

Original Owner's Ethnicity _____

Feature Type _____

Context _____

Primary Exterior _____

Secondary Exterior _____

Condition Destroyed

Plan Shape _____

Style _____

Architect/Builder _____

Foundation _____ Stories _____

Roof/Cornice _____

Window _____

Dating Method(s) _____

Miscellaneous Information _____

Feature Preservation Recommendation(s) (Check all that apply):

Individual nomination

Contributes to a potential district

No nomination potential

Will not contribute to a district

Potential district—feature would be a contributing element if other properties constitute a district

Thematic nomination potential

Component of a historic site or landscape

Moved (specify all applicable choices)—a) relocation occurred within a historic period; b) recreates original site, orientation, landscape, and spatial relationships; c) compatible in context with neighboring structures; d) relocation has damaged eligibility

Historical associations require further investigation

Recorded By: Lorna Meidinger **Date Recorded:** 02/02/2022

NDCRS ARCHITECTURAL FORM

PAGE 3 – *Feature Data*

UPDATE

Field Code _____

SITS# 32 ML 786 _____

Complete one Page 3 for *each* architectural feature at the site.

1. Feature Description, Integrity, Eligibility:

Based on aerial imagery available online from the ND Historical Map & Aerial Photography Dissemination Service, and Google Streetview, the school was removed for sure by Aug 2021.

2. Owner's Contact Information:

Recorded By: _____ **Lorna Meidinger** _____ **Date Recorded:** _____ **02/02/2022** _____

NDCRS ARCHITECTURAL FORM

PAGE 4 – *Site Description*

UPDATE

Field Code _____

SITS# 32 ML 786 _____

3. Site Area (ft²):

4. Description of Access and Site Setting:

5. Summary of ALL Site Features and Evaluation of Significance:

6. References/Comments:

<http://aerial.swc.nd.gov/>

Recorded By: Lorna Meidinger **Date Recorded:** 02/02/2022

Form instructions: (1) Download; (2) Save A Copy; (3) Submit a paper copy of the form to the SHSND and upload the PDF version of the form and corresponding GIS shapefiles to the ND SHPO-run FTP site.

NDCRS SITE FORM
ARCHITECTURAL SITES

Page 1

SITS # 32 ML 786

Field Code 9.2.10.1.4a-1 Site Name _____
Field Code LTA Site Name _____

Map Quad COAL HARBOR NW
Map Quad _____

LTL	<input type="checkbox"/>	Twp	<u>148</u>	R	<u>83</u>	Sec	<u>10</u>	QQQ	<u>6</u>	QQ	<u>5</u>	Q	<u>5</u>
LTL	<input type="checkbox"/>	Twp	_____	R	_____	Sec	_____	QQQ	<input type="checkbox"/>	QQ	<input type="checkbox"/>	Q	<input type="checkbox"/>
LTL	<input type="checkbox"/>	Twp	_____	R	_____	Sec	_____	QQQ	<input type="checkbox"/>	QQ	<input type="checkbox"/>	Q	<input type="checkbox"/>
LTL	<input type="checkbox"/>	Twp	_____	R	_____	Sec	_____	QQQ	<input type="checkbox"/>	QQ	<input type="checkbox"/>	Q	<input type="checkbox"/>
LTL	<input type="checkbox"/>	Twp	_____	R	_____	Sec	_____	QQQ	<input type="checkbox"/>	QQ	<input type="checkbox"/>	Q	<input type="checkbox"/>
LTL	<input type="checkbox"/>	Twp	_____	R	_____	Sec	_____	QQQ	<input type="checkbox"/>	QQ	<input type="checkbox"/>	Q	<input type="checkbox"/>

1. N $\frac{1}{2}$
2. E $\frac{1}{2}$
3. S $\frac{1}{2}$
4. W $\frac{1}{2}$
5. NE $\frac{1}{4}$
6. SE $\frac{1}{4}$
7. SW $\frac{1}{4}$
8. NW $\frac{1}{4}$
9. C

City _____

Street # _____ Street # _____

Street Name _____ Street Name _____

of Features 1

<u>1</u> Feature #	<u>9</u> Feature Type	<u>6</u> Condition
_____ Construction Date	<u>7</u> Context *	
<u>3</u> Feature Date		<u>5</u> Plan Shape *
<u>25</u> Structural System **	<u>26</u> Primary Exterior *	_____ Secondary Exterior
<u>0</u> Ethnic	_____ Style *	
<u>1.0.2019.2</u> Fieldwork Date		_____ Architect/Builder
		_____ Other Information

<u>33.1</u> Soil Association	<u>2.1</u> Ecozone	<u>2</u> Area Signf	_____ MS Number
<u>36.0</u> Soil Association	_____ Ecozone	_____ Area Signf	_____ MS Number
<u>2</u> CR Type	<input checked="" type="checkbox"/> Verified Site	<input type="checkbox"/> Non-Site	<u>2</u> ECF <u>2</u> T F
<input type="checkbox"/> State Registry	<input type="checkbox"/> National Register		

Coder D. M. Penny

Date Coded 2-5-93

Reconnaissance Survey _____

Intensive Survey x

Manuscript/Report Title: see page 3

Author(s): Larson et al.

SITE DATA

FEATURE DATA

SHSND USE

NDCRS ARCHITECTURAL SITE FORM
page 1A

Field Code 921014a-1

Feature Number 1

SITS # 32ML

DESCRIPTIVE SECTION

FOUNDATION

STORIES

ROOF TYPE/CORNICE

CONCRETE

1

HIP / WOOD SHINGLE / WOOD

WINDOW CONDITION

DATING METHOD

MOST ORIGINAL WINDOWS AND OPENINGS INTACT ESTIMATE

PRESERVATION RECOMMENDATION (check all that apply):

- 1) Individual Nomination
 - 2) Contributes to a potential district
 - 3) No nomination potential
 - 4) Will not contribute to district
 - 5) Potential district not known at this time: feature would be a contributing element if neighboring properties constitute a district
 - 6) Thematic nomination potential
 - 7) Component of historic site/landscape
- *****
- 8) Feature has an important physical, spatial, functional, historic or architectural relationship to the site/complex/farmstead
 - 9) Moved: A) relocation occurred within historic period. B) recreates original site, orientation, landscape and spatial relationships. C) compatible in context with neighboring structures. D) relocation has damaged eligibility.
 - 10) Request comparative study of neighboring properties
 - 11) Historical associations require further investigation

DESCRIPTION/INTEGRITY/ELIGIBILITY A townhall was recorded at this location. The building is on the northeast side of a low hill in what was once rolling upland grassland. The areas surrounding the building are all in cultivation.

The townhall is a rectangular plan, wood frame building clad with horizontal board siding measuring 35 feet east to west by 20 feet north to south. It has a concrete foundation and basement. A large portion of the north basement wall has collapsed inward. The building has a hip roof with wood shingles.

On the Garrison Northeast Quadrangle, this building is labeled "townhall." The building was probably once a one room schoolhouse; blackboards are still in place on the west wall of the interior. This locality is not mentioned in Tweton's (1978) historic documents search for the Regional Environmental Assessment Program.

Records on file at the McLean County Register of Deeds indicate that David Seidler received a patent to the land on April 18, 1910. He sold the land to Christian Wacker on September 9, 1912. The Wacker family sold the property to K.I. Knapp on April 18, 1923. K.I. and Stella Knapp kept the land until January 3, 1929, when they sold it to Theo. Dubbs. On October 2, 1940, McLean County obtained the land. The current owner, Arthur Eslinger, purchased the land on January 26, 1944.

While the building is in good condition, it does not have any architectural attributes which would set it apart from other townhalls of this same general style and age. However, archival research to establish the township hall's history would need to be conducted prior to determining the site's eligibility for nomination to the National Register of Historic Places. This site will be avoided by moving the proposed right of way to the east.

Urban Legal Description n/a

SEE CONTINUATION SHEET

ARCHITECTURAL SITE FORM

Page 3

Field Code 921014a

SITS No. _____

OWNER'S NAME, ADDRESS, PHONE # Arthur and Clarise Eslinger, RR 1, Box 33, Coleharbor, North Dakota 58531

PROJECT TITLE Cultural Resource Inventory for the Garrison Rural Water System, McLean County, North Dakota

REPORT TITLE Cultural Resource Inventory for the Garrison Rural Water System, McLean County, North Dakota

SITE AREA (in square feet) 700 square feet

ACCESS From the intersection of U.S. 83 and N.D. 37, travel east on the blacktop road three miles. The road curves north at this point. Travel north .75 mile. The site is on the west side of the road just south of the fork in the road.

DESCRIPTION The townhall is a rectangular plan, wood frame building clad with horizontal board siding. The building is on the northeast side of a low hill and is surrounded by cultivated fields.

SUMMARY OF SITE FEATURES AND EVALUATION OF SIGNIFICANCE The townhall is the only feature recorded at this location. While the building is in good condition, it does not have any architectural attributes which would set it apart from other townhalls of this same general style and age. However, archival research to establish the township hall's history would need to be conducted prior to determining the site's eligibility for nomination to the National Register of Historic Places. This site will be avoided by moving the proposed right of way to the east.

REFERENCE CITED

Tweton, D. Jerome

1978 *Known Historic Site Survey of 32 Eastern North Dakota Counties.* Appendix to REAP Cultural Resource Inventory. Submitted to the North Dakota Legislative Council, Bismarck.

Include a north arrow, site boundaries, road or street names, locations of artifacts, features, buildings, structures, objects, and depressions with each item individually numbered and keyed to the Map Key, and road or street name(s).

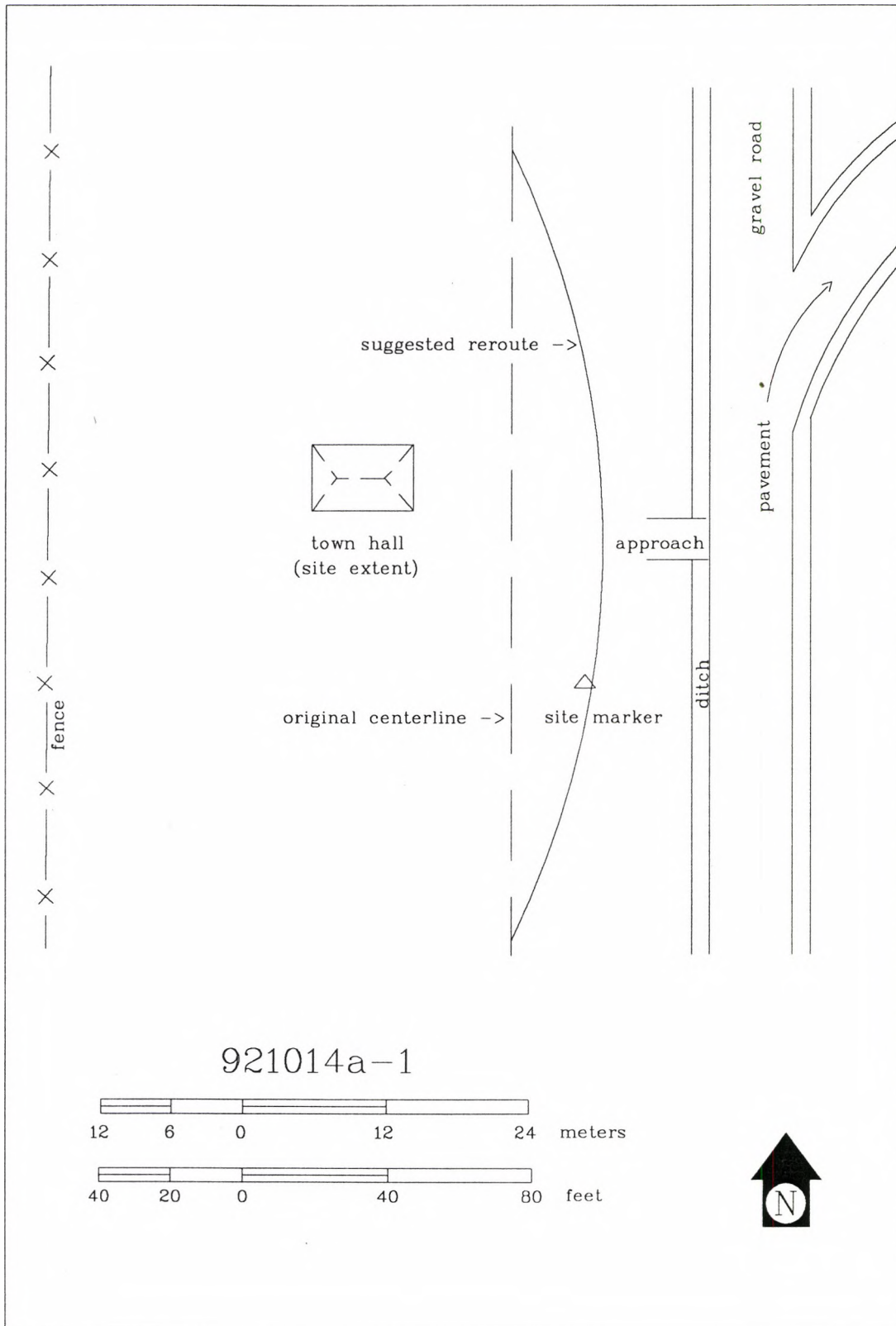

Photocopy the portion of the 7.5' U.S.G.S. topographic quadrangle that shows the location of the site and surrounding area. Mark the boundaries of the site on the photocopy. Photocopy of the portion of the topographic quadrangle must be actual size, reductions or enlargements are unacceptable.

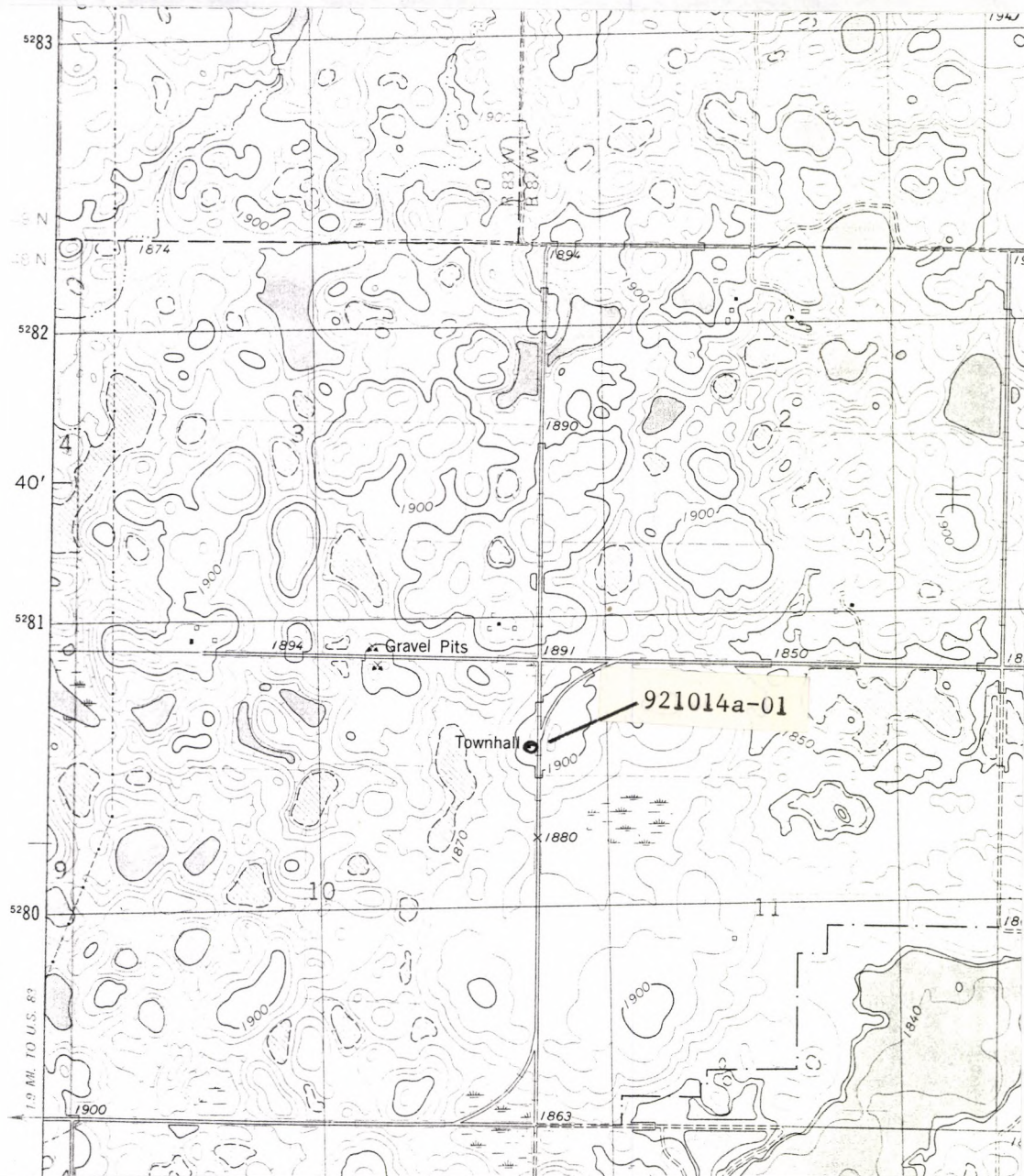

NDCRS SITE FORM

Photograph

Field # 921014a-1

Site # 32ML

Photo I.D. Code 921014a, Roll 1, Frame 4

Storage Location Larson-Tibesar Associates, Laramie, WY

Include direction facing, feature number, and photo caption for each submitted photograph.



Site photo, view to the northwest

NDCRS SITE FORM

Photograph

Field # 921014a-1

Site # 32ML

Photo I.D. Code 921014a, Roll 1, Frames 2 and 3

Storage Location Larson-Tibesar Associates, Laramie, WY

Include direction facing, feature number, and photo caption for each submitted photograph.



Feature 1, view to the southwest



Feature 1, view to the northeast