

NDCRS ARCHITECTURAL SITE FORM
PAGE 1 UPDATE

Field Code _____ SITS# 32 ML 856

SITE IDENTIFICATION

Map Quad _____ Site Name _____
Map Quad _____ Site Name _____

LTL ___ TWP _____ R _____ SEC _____ QQQ _____ QQ _____ Q _____
LTL ___ TWP _____ R _____ SEC _____ QQQ _____ QQ _____ Q _____
LTL ___ TWP _____ R _____ SEC _____ QQQ _____ QQ _____ Q _____
LTL ___ TWP _____ R _____ SEC _____ QQQ _____ QQ _____ Q _____

UTM _____ N ZONE _____
UTM _____ E NAD 1927 ___ NAD 1983 ___

City: _____
Street Number: _____
Street Name: _____
Urban Legal Description: _____

Subsection:
1 = N 1/2
2 = E 1/2
3 = S 1/2
4 = W 1/2
5 = NE 1/4
6 = SE 1/4
7 = SW 1/4
8 = NW 1/4

SITE DATA

Total # Architectural Features: _____

Fieldwork Date: _____

Reconnaissance Survey ___ Intensive Survey ___

Project Title & Supervisor: _____

Report Title & Author(s): _____

Additional Information: based on 2009 aerials, entire site demolished, now cultivated field

SHSND USE

Area of Significance _____ Ecozone _____ Verified Site _____ CR Type _____
Area of Significance _____ Ecozone _____ Non-Site _____
Area of Significance _____ Ecozone _____

Recorded By Lorna Meidinger Date Recorded 9/10/2010
(First Name & Last Name) (mm/dd/year)

Instructions to complete a digital version of this form: (1) Download a copy to your hard drive; (2) Open the saved blank copy; (3) Fill out the form; (4) Use the Save As command to rename the form appropriately and save; (5) Print and submit to SHSND.

NDCRS SITE FORM
ARCHITECTURAL SITES
Page 1

SITS # 32 ML 856

Field Code ES 4 Site Name _____
Field Code _____ Site Name _____

Map Quad W.A.S.H.B.U.R.N. S.W. N. D.A.K.
Map Quad _____

- 1. N $\frac{1}{2}$
- 2. E $\frac{1}{2}$
- 3. S $\frac{1}{2}$
- 4. W $\frac{1}{2}$
- 5. NE $\frac{1}{4}$
- 6. SE $\frac{1}{4}$
- 7. SW $\frac{1}{4}$
- 8. NW $\frac{1}{4}$
- 9. C

LTL Twp 14.5 R 8.3 Sec 29 QQQ 6 QQ 7 Q 6
 LTL Twp _____ R _____ Sec _____ QQQ _____ QQ _____ Q _____
 LTL Twp _____ R _____ Sec _____ QQQ _____ QQ _____ Q _____
 LTL Twp _____ R _____ Sec _____ QQQ _____ QQ _____ Q _____
 LTL Twp _____ R _____ Sec _____ QQQ _____ QQ _____ Q _____
 LTL Twp _____ R _____ Sec _____ QQQ _____ QQ _____ Q _____

SITE DATA

City _____

Street # _____ Street # _____

Street Name _____ Street Name _____

of Features 9

FEATURE DATA

Feature # _____ Feature Type 4.0 Condition 6
 Construction Date _____ Context * 1.3
 Feature Date _____ Plan Shape * 5
 Structural System ** 1.2 Primary Exterior * 1.5 Secondary Exterior _____
 Ethnic 2.5 Style * _____
 Fieldwork Date 1.0.13.01.93 Architect/Builder _____
 _____ Other Information _____

SHSND USE

Soil Association 33.1 Ecozone 1.9 Area Signf 2 _____ MS Number _____
 Soil Association _____ Ecozone _____ Area Signf _____ MS Number _____
 CR Type 2 Verified Site Non-Site _____ E C F 3 T F 3
 State Registry 4 National Register 4

Coder 21 Brownell

Date Coded 12/93

Reconnaissance Survey _____

Intensive Survey _____

Manuscript/Report Title: _____

Author(s): _____

NDCRS ARCHITECTURAL SITE FORM

page 2

Field Code: ES-4

SITS # : 32ML

8 Feature #	9 Feature Type	6 Condition
Construction Date	7 Context	
3 Feature Date		5 Plan Shape
25 Structural System	26 Primary Exterior Style	Secondary Exterior
Ethnic		Architect/Builder
10 30 93 Fieldwork Date		Other Information

FOUNDATION TYPE
concrete

STORIES
1

ROOF TYPE/CORNICE
gable

WINDOW CONDITION
intact

DATING METHOD (S)
owner

PRESERVATION RECOMMENDATION (check all that apply):

- 1) Individual Nomination
- 2) Contributes to a potential district
- 3) No Nomination potential
- 4) Will not contribute to district
- 5) Potential district not known at this time: feature would be a contributing element if neighboring properties constitute a district
- 6) Thematic nomination potential
- 7) Component of historic site/landscape
- *****
- 8) Feature has an important physical, spatial, functional, historic or architectural relationship to the site/complex/farmstead
- 9) Moved:
 - A) relocation occurred within historic period.
 - B) recreates original site, orientation, landscape and spatial relationships.
 - C) compatible in context with neighboring structures.
 - D) relocation has damaged eligibility.
- 10) Request comparative study of neighboring properties
- 11) Historical associations require further investigations

DESCRIPTION/ INTEGRITY/ ELIGIBILITY:

Feature 8 is a wood frame, rectangular school house placed on a low concrete foundation that adjusts to ground level, being highest under the north end wall. The schoolhouse is clad with weatherboard framed by cornerboards and has a gable roof covered with asphalt shingles and a metal ridgecap with end balls. The eaves are enclosed with molded cornice and wide flush boards. The east and west walls are symmetrical with three 2/2 double-hung windows. The south wall contains a centered four panel wood door and is approached by a concrete block stoop. A block chimney protrudes from the ridge near the north wall. According to Jerome Simfenderfer, this school house originally stood 1/2 mile to the west and was moved in by his father-in-law after 1945. The 1914 Ogle Atlas for T146N R83W shows a school house in the SW1/4 of Section 23 (Je Simfenderfer 1993; Ogle 1914b).

The schoolhouse has lost integrity of location, setting, feeling and association due to its removal from its original location. It has retained its historic fabric. The building is not considered eligible under the established NR Criteria (A, B, C and D).

NDCRS ARCHITECTURAL SITE FORM

Page 3

Field Code : ES-4

SITS # : 32ML

OWNER'S NAME, ADDRESS, PHONE#:

Jerome and Judy Simfenderfer, Underwood, ND

PROJECT TITLE: FAL 2

REPORT TITLE:

A Cultural Resource Inventory of the Falkirk Mine Riverdale Extension, McLean County, North Dakota

SITE AREA: approximately 87120 sq. feet (in square feet)

ACCESS:

From Highway 200, turn west at the Falkirk Mine entrance road. Continue on this road after it turns to gravel and passes the mine offices. At the intersection with a north/south gravel road, turn south on a gravel section line road and drive 1 mile. Turn west and drive one mile and then turn south and continue to drive south for 2 miles. Turn west and drive a little more than 1/4 mile to the farm access road to the north.

DESCRIPTION:

This occupied farmstead contains nine buildings, including a partially log house, a garage, granary/shed, granary, pump house, outhouse, chicken coop and a school house. It is approached from the south up a slight rise. It is bound to the north, east and west by cultivated fields and has a windrow north of the schoolhouse.

Historical Information:

In 1890, John Engberg received his homestead patent for the SE1/4 of Section 24, T145N R83W. Engberg held the land until 1903 when he sold it to Henry Grochow. In 1915, Claus Henrichs obtained the title for the SE1/4 from Grochow. Henrichs died in 1931 and his widow transferred this property and other lands to her son, Herman Henrichs. Heinrich held the land until 1943 when he sold it to Hjalmar Swanson. Hjalmar died in 1977 and in 1982, his widow transferred the land to their daughter and son-in-law, Judy and Jerome Simfenderfer (BLM n.d.b; Abstract n.d.b;

According to the local history, the Henrichs were Germans who first settled in Iowa and came to McLean County in 1906. In 1907, Henrichs had a crop agreement with Grochow for this SE1/4 and apparently lived on the property until he obtained title in 1915. The 1911 Van Valkenburgh Atlas shows a building west of this site location but the land owned by Grochow. The 1914 Ogle Atlas for McLean County show a building in the same general location as this farmstead with the SE1/4 owned by C. H. Henrichs. (MCHC 1978; Abstract n.d.b.; Van Valkenburgh 1911; Ogle 1914).

References:

Abstract of Title

n.d.b SE1/4 Section 24 T145N R83W. On file at North American Coal Company, Bismarck, N.D.

Bureau of Land Management

n.d.b Land Patent Records T145N R83W. On file at Records Room, Bureau of Land Management, Billings, Mt.

X SEE CONTINUATION SHEET

NORTH DAKOTA CULTURAL RESOURCES SURVEY Page 3
Continuation Form

Field Code: ES-4

Site No: 32ML

McLean County Historical Committee (MCHC)
1978 *McLean County Heritage McLean County, North Dakota*. McLean County Historical Society, Washburn, ND.
Ogle, George A. Comp and Pub.
1914 *Standard Atlas of McLean County*. George A. Ogle Company, Chicago, IL.
Simfenderfer, Jerome
1993 Personal Communication. Underwood, N.D.
Simfenderfer, Judy
1993 Personal Communication. Underwood, N.D.
Valkenburgh, Van
1911 *Van Valkenburgh's Practical Atlas of McLean County*. Van Valkenburgh Map and Litho Company, Rockford, IL.

SUMMARY OF SITE FEATURES AND EVALUATION OF SIGNIFICANCE:

House- 1
Garage- 2
Granary/ shed- 3
granary- 4
well house- 5
outhouse- 6
chicken house 7
school house - 8
grain bin- 9

Statement of Integrity:

This site retains integrity of location, setting and historic association. The house has undergone extensive alterations and the original barn was destroyed by a tornado. The remaining buildings have all been moved in since the 1960s.

Statement of Significance:

This occupied farmstead is not considered significant under any of the NR Criteria. The site has a historic association with land settlement in this region of McLean County in the late nineteenth and early twentieth century. However, the site does not reflect this association due to its lack of physical integrity. The house of partial log has been extensively remodeled and altered and the early barn was destroyed by a tornado. All of the other buildings at the site have been built or moved on since 1943. The site represents today this post 1940s development. The site has no known association with any known person or persons significant to local, regional, state or national history (Criterion B). The site has no architectural significance (Criterion C) and is not expected to yield important information to local history (Criterion D).

The log walls of the house (F1) illustrate a unique construction technology and the house therefore is considered individually eligible under Criterion C. The use of vertical logs rather than horizontal is a variation on typical log construction methods commonly utilized by early settlers on the northern plains in the late nineteenth century. This construction technology precludes any alterations suffered by the building.

NDCRS SITE FORM

Field # : ES-4

SITE#: 32ML

TOPOGRAPHIC MAP:

Washburn SW, N. Dak
1967 Photorevised 1980 7.5 min.

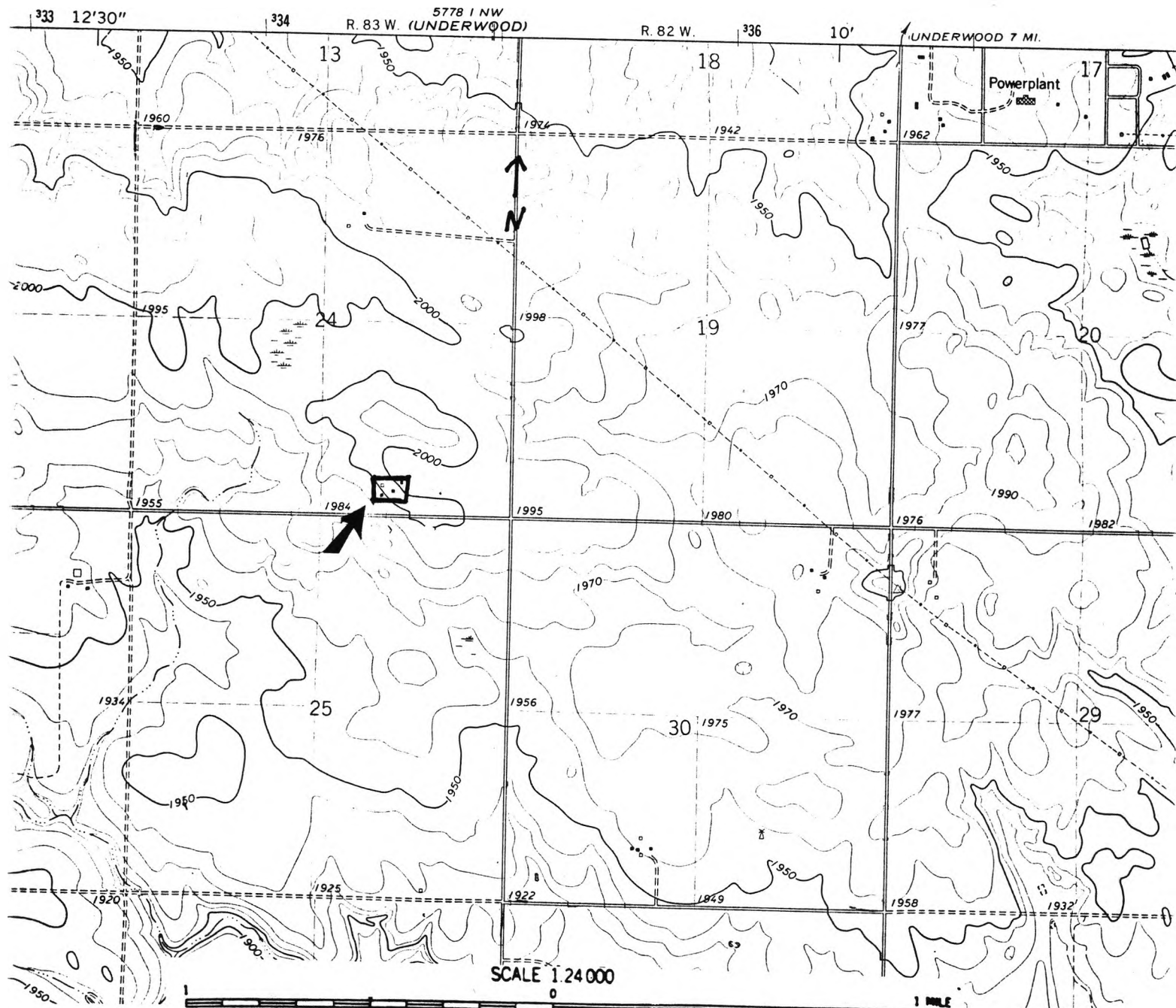

SCALE 1:24 000
1 MILE
1000 0 1000 2000 3000 4000 5000 6000 7000 FEET
1 0 1 KILOMETER
CONTOUR INTERVAL 20 FEET
NATIONAL GEODETIC VERTICAL DATUM OF 1929

NDCRS SITE FORM

Field # : ES-4
SKETCH MAP

SITE# : 32ML

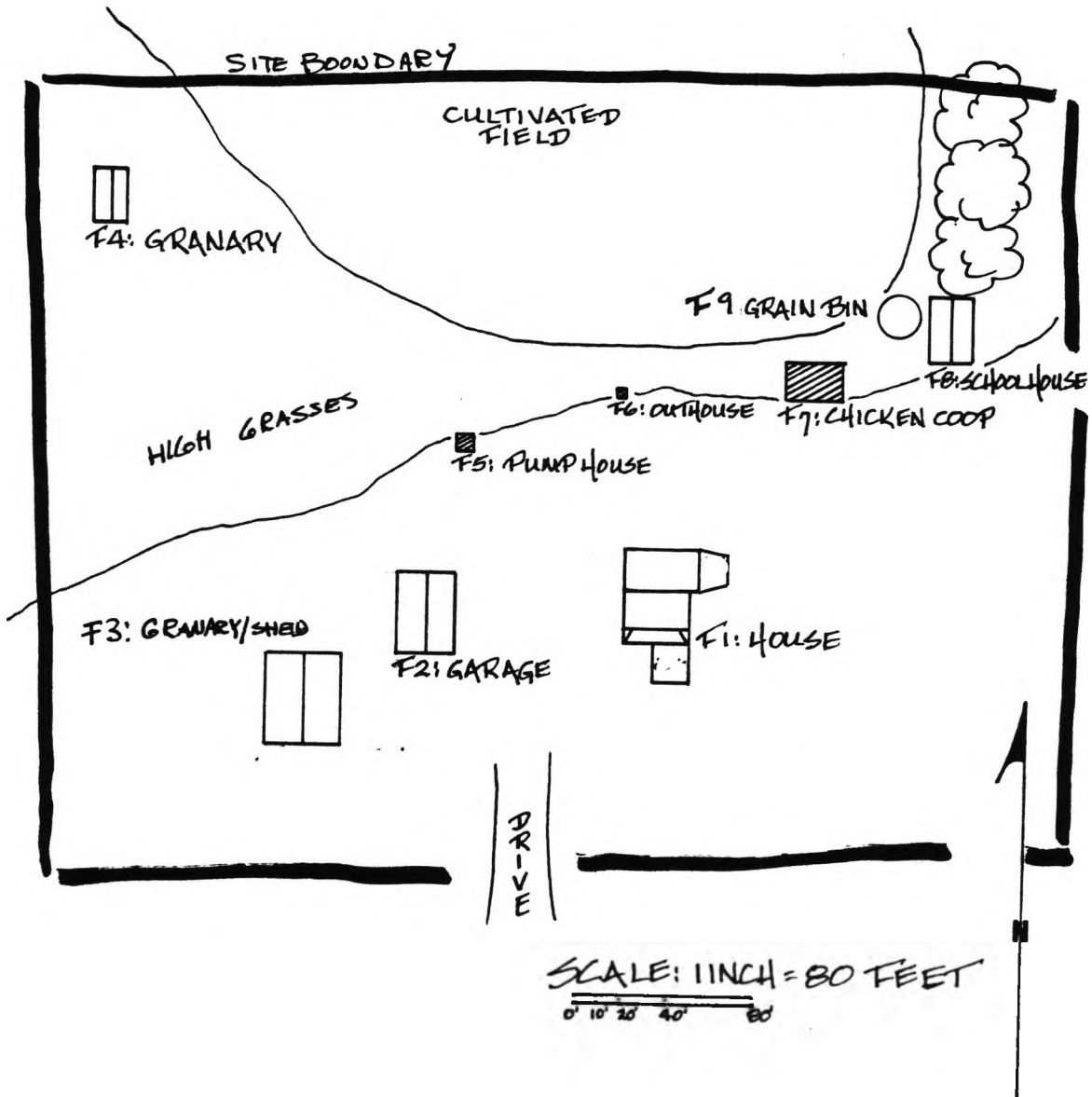

NDCRS SITE FORM

**Field #: ES-4
PHOTOGRAPH**

SITE #: 32ML



FEATURE 7: Chicken coop, south and east elevations, view to northwest



FEATURE 8: School House, south and east elevations, view to northwest