

UPDATE

NDCRS SITE FORM
ARCHITECTURAL SITES
page 1

SITS # 32 M.N. 6,4,4

Field Code B,2,W,U,S,2,S,0,4,6 Site Name _____
Field Code _____ Site Name _____

Map Quad R,0,S,S _____ 1. N½
Map Quad _____ 2. E½
3. S½

LTL	<input type="checkbox"/>	Twp	<u>1,5,6</u>	R	<u>9,2</u>	Sec	<u>2,0</u>	QQQ	<u>3</u>	QQ	<u>7</u>	QQ	<u>7</u>	4. W½
LTL	<input type="checkbox"/>	Twp	_____	R	_____	Sec	_____	QQQ	_____	QQ	_____	QQ	_____	5. NE¼
LTL	<input type="checkbox"/>	Twp	_____	R	_____	Sec	_____	QQQ	_____	QQ	_____	QQ	_____	6. SE¼
LTL	<input type="checkbox"/>	Twp	_____	R	_____	Sec	_____	QQQ	_____	QQ	_____	QQ	_____	7. SW¼
LTL	<input type="checkbox"/>	Twp	_____	R	_____	Sec	_____	QQQ	_____	QQ	_____	QQ	_____	8. NW¼
LTL	<input type="checkbox"/>	Twp	_____	R	_____	Sec	_____	QQQ	_____	QQ	_____	QQ	_____	9. C

City R,0,S,S _____

Street # 1,1,0 _____ Street # _____

Street Name _____ Street Name _____
C,E,N,T,R,A,L, A,V,E _____

of Features 1

<u>1</u> Feature #	<u>9</u> Feature Type	<u>6</u> Condition
_____ Construction Date	<u>7</u> Context *	<u>3</u> Plan Shape *
<u>3</u> Feature Date	<u>2,6</u> Primary Exterior *	_____ Secondary Exterior
<u>2,5</u> Structural System **	<u>2,9</u> Style	_____ Architect/Builder
<u>1,0</u> Ethnic	_____ Other Information	
<u>10,7,12,8,10,0</u> Fieldwork Date		

_____ Soil Association	<u>2,1</u> Ecozone	<u>2</u> Area Signf	_____ MS Number
_____ Soil Association	_____ Ecozone	_____ Area Signf	_____ MS Number
<u>2</u> CR Type	<u>1</u> Verified Site	<u>1</u> Non-Site	<u>2</u> E C F <u>3</u> T F
<u>1</u> State Registry	<u>1</u> National Register		

Coder B. Mitchell Date Coded 01/31/2001

Reconnaissance Survey _____ Intensive Survey X

Manuscript/Report Title: US Hwy 2 Cultural Resource Inventory in Ward, Mountrail, & Williams Counties

Author(s): Bradley E. Perkl and Barbara A. Mitchell, et al.

NDCRS SITE FORM
 ARCHITECTURAL SITES
 page 1

SITS # 32 M.N. 644

Field Code B.R.W.U.S.2.S.O.46 Site Name SCHOOL
 Field Code _____ Site Name HOUSE

Map Quad ROSS
 Map Quad _____

1. N½
2. E½
3. S½
4. W½
5. NE¼
6. SE¼
7. SW¼
8. NW¼
9. C

LTL Twp 156 R 92 Sec 20 QQQ 3 QQ 7 QQ 7
 LTL Twp _____ R _____ Sec _____ QQQ _____ QQ _____ QQ _____
 LTL Twp _____ R _____ Sec _____ QQQ _____ QQ _____ QQ _____
 LTL Twp _____ R _____ Sec _____ QQQ _____ QQ _____ QQ _____
 LTL Twp _____ R _____ Sec _____ QQQ _____ QQ _____ QQ _____
 LTL Twp _____ R _____ Sec _____ QQQ _____ QQ _____ QQ _____

City ROSS

Street # _____

Street # _____

Street Name _____

Street Name _____

of Features 1

<u>1</u> Feature #	<u>9</u> Feature Type	<u>6</u> Condition
_____ Construction Date	<u>7</u> Context *	
<u>3</u> Feature Date		<u>3</u> Plan Shape *
<u>25</u> Structural System **	<u>26</u> Primary Exterior *	_____ Secondary Exterior
<u>0</u> Ethnic	<u>29</u> Style	
<u>0728100</u> Fieldwork Date		_____ Architect/Builder
		_____ Other Information

_____ Soil Association	<u>21</u> Ecozone	<u>2</u> Area Signf	_____ MS Number
_____ Soil Association	_____ Ecozone	_____ Area Signf	_____ MS Number
<u>2</u> CR Type	<u>1</u> Verified Site	_____ Non-Site	<u>2</u> E C F <u>2</u> T F
_____ State Registry		_____ National Register	

Coder B. Mitchell

Date Coded 01/31/2001

Reconnaissance Survey _____

Intensive Survey X

Manuscript/Report Title: US Hwy 2 Cultural Resource Inventory in Ward, Mountrail, & Williams Counties

Author(s): Bradley E. Perkl and Barbara A. Mitchell, et al.

NDCRS ARCHITECTURAL SITE FORM
page 1A

Field Code BRW US2 S046

Feature Number 1

SITS # 32MN

DESCRIPTIVE SECTION

FOUNDATION

STORIES

ROOF TYPE/CORNICE

Poured concrete

1

Hipped w/ bellcast; wood shingles

WINDOW CONDITION

DATING METHOD

Most original windows replaced/openings intact

Professional estimate

PRESERVATION RECOMMENDATION (check all that apply):

- 1) Individual Nomination 2) Contributes to a potential district
- 3) No nomination potential 4) Will not contribute to a district
- 5) Potential district not known at this time: feature would be a contributing element if neighboring properties constitute a district
- 6) Thematic nomination potential 7) Component of historic site/landscape
- *****
- 8) Feature has an important physical, spatial, functional, historic or architectural relationship to the site/complex/farmstead
- 9) Moved: A) relocation occurred within historic period. B) recreates original site, orientation, landscape and spatial relationships. C) compatible in context with neighboring structures. D) relocation has damaged eligibility.
- 10) Request comparative study of neighboring properties
- 11) Historical associations require further investigation

DESCRIPTION/INTEGRITY/ELIGIBILITY

Feature #1 is an old schoolhouse that has been converted into a single-family dwelling. The building may date to the early 1900s. Although it is obvious that the building was moved onto the property, the date of the move was not found. The building is essentially rectangular in plan with a small wing off the north facade that forms an "L". There is also an enclosed, gable-roofed porch on the front (west) facade and a small gable-roofed entry vestibule on the east facade, with a wood deck. Although none of the additions are original to the structure, the wing is at least 50 years old and the entry vestibule and a portion of the porch may be as well. The wood-frame structure is on a poured concrete foundation and is clad with horizontal wood siding with corner boards. The hipped roof has a bellcast and a single, hipped-roof dormer on the west side. The roof is clad with wood shingles. The windows are primarily wood-framed, one-over-one double-hung. They are not original to the structure.

The building appears to be an elaboration of the typical one-room gable-roofed country schoolhouse and retains substantial integrity. Although the structure has been moved, its historical associations should be fully researched and its eligibility for individual listing on the National Register of Historic Places under Criteria A and/or C should be evaluated.

Urban Legal Description Lots 13-14, Block 6; Original Townsite

SEE CONTINUATION SHEET

NDCRS ARCHITECTURAL SITE FORM

page 3

Field Code BRW US2 S046

SITS # 32MN

OWNER'S NAME, ADDRESS, PHONE # _____

PROJECT TITLE US Hwy 2 Cultural Resources Inventory for FHWA and North Dakota Dept. of Transportation (subcontracted through Houston Engineering); B. E. Perkl and B. A. Mitchell, Co-Principal Investigators

REPORT TITLE US Hwy 2 Cultural Resources Inventory in Ward, Mountrail, & Williams Counties, North Dakota. Authored by B. E. Perkl & B. A. Mitchell, et al. URS/BRW Report No. 01-01, URS/BRW, Inc., Minneapolis, Minnesota.

SITE AREA 16,935 (in square feet)

ACCESS The property is located in Ross at the intersection of 2nd St. West and old US Hwy 2 on the north-east corner.

DESCRIPTION _____

SUMMARY OF SITE FEATURES AND EVALUATION OF SIGNIFICANCE Schoolhouse - 1.

The first school district in Mountrail County was formed on October 5, 1896 in the White Earth Valley. By 1925, there were over 145 schools in the county, 53 districts, and 190 teachers. The first one-room schoolhouse in the town of Ross was built in 1902. According to local history, it was located on Block 7, Lot 8, which would place it directly across the street from the extant structure. Feature #1 was not originally located on its current site, according to the real estate agent that was trying to sell the empty structure. Attempts to obtain additional information on the structure were fruitless. Additional historical research could verify or rule out the extant structure as the first schoolhouse in Ross.

The extant building appears to be an elaboration of the typical one-room gable-roofed country schoolhouse and retains substantial integrity. Although the structure has been moved, its historical associations should be fully researched and its eligibility for individual listing on the National Register of Historic Places under Criteria A and/or C should be evaluated.

References:

Mountrail County Historical Society

1979 *Tales of Mighty Mountrail*. Taylor Publishing Company, Dallas, Texas.

1986 *Tales of Mighty Mountrail (Volume II): a History of Mountrail County, North Dakota*. Mountrail County Historical Society, Stanley, North Dakota.

Key
1. Old Schoolhouse

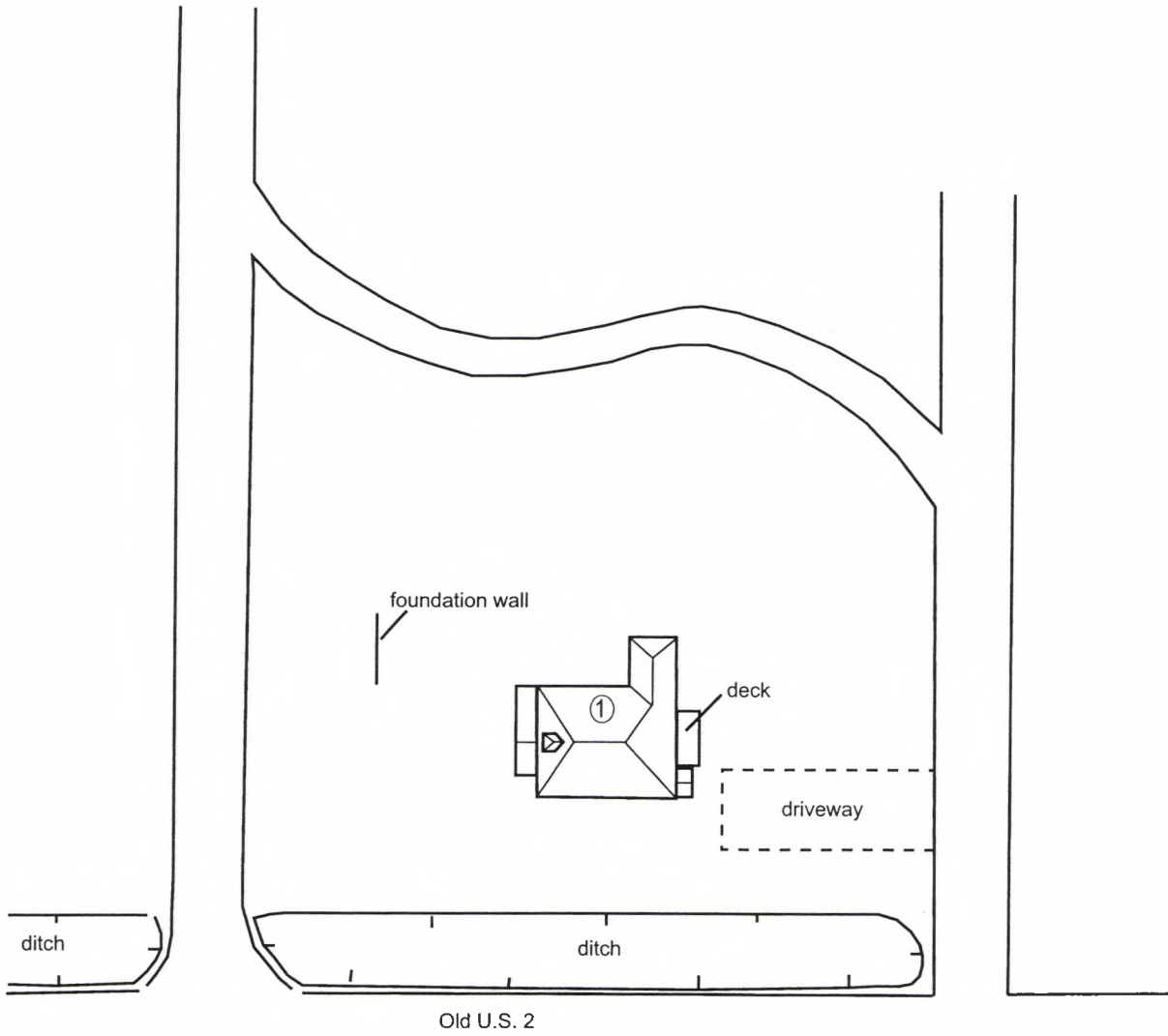

Photocopy the portion of the 7.5' U.S.G.S. topographic quadrangle that shows the location of the site and surrounding area. Mark the boundaries of the site on the photocopy. Photocopy the portion of the topographic quadrangle must be actual size; reductions or enlargements are unacceptable.

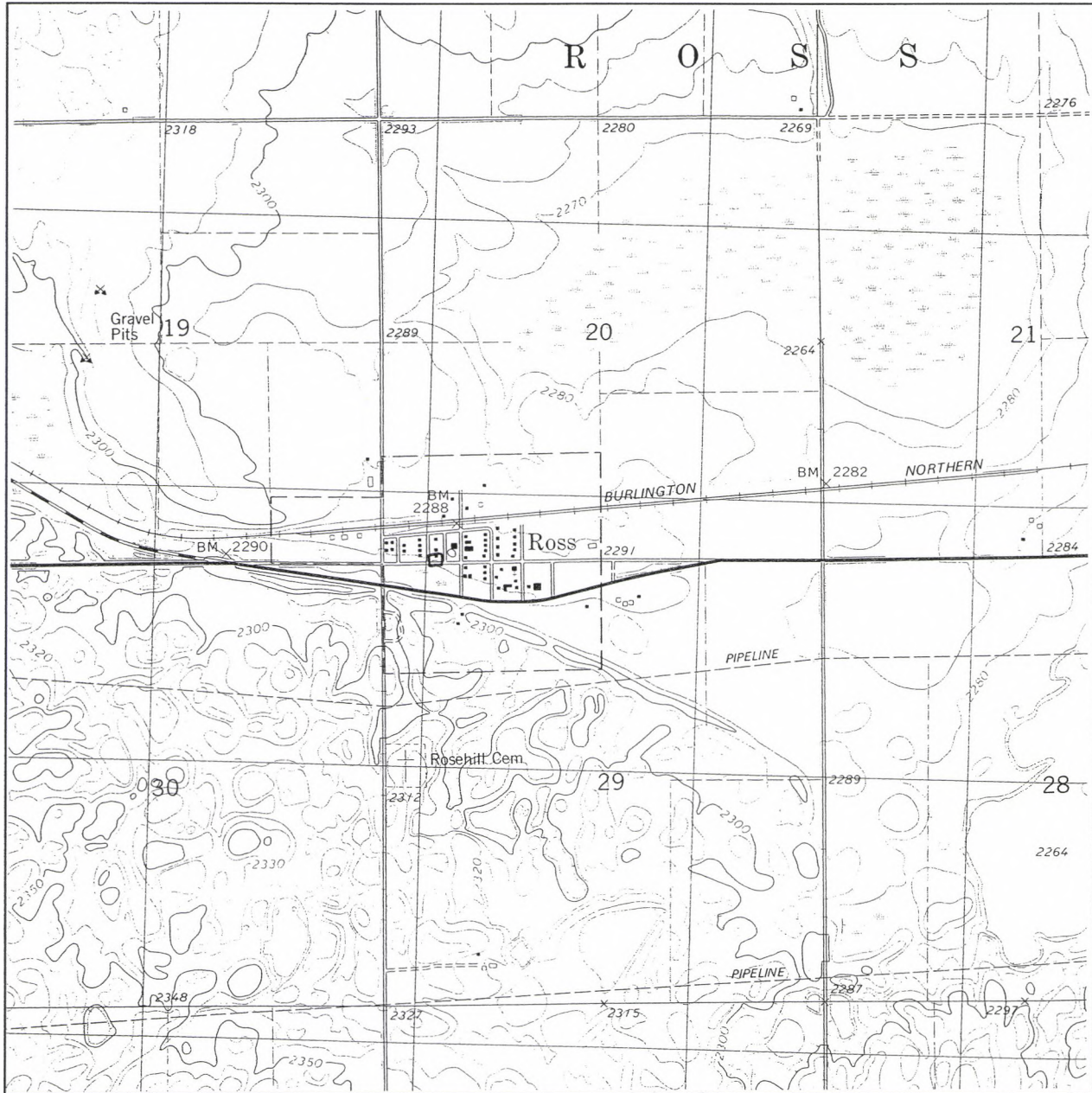

ROSS, N. DAK (1981)
T156N, R92W, Section 20

Photo I.D. Code BRW US2 Roll 9, Frame 20 (B&W); BRW US2 Roll 9, Frame 21 (B&W)

Storage Location State Historical Society of North Dakota: State Historic Preservation Office

Include direction facing, feature number, and photo caption for each submitted photograph.

Old Schoolhouse, facing SE



Old Schoolhouse, facing NE



Photo I.D. Code BRW US2 Roll 9, Frame 19 (B&W)

Storage Location State Historical Society of North Dakota: State Historic Preservation Office

Include direction facing, feature number, and photo caption for each submitted photograph.

Old Schoolhouse, facing NW

