

NDCRS ARCHITECTURAL SITE FORM PAGE 1

SITS# 32 MN 1383

SITE IDENTIFICATION

Field Code Crowfoot Township School Site Name _____

Map Quad Coulee Site Name _____

Map Quad _____

LTL	TWP	<u>158</u>	R	<u>89</u>	SEC	<u>12</u>	QQQ	<u>7</u>	QQ	<u>7</u>	Q	<u>7</u>
LTL	TWP	_____	R	_____	SEC	_____	QQQ	_____	QQ	_____	Q	_____
LTL	TWP	_____	R	_____	SEC	_____	QQQ	_____	QQ	_____	Q	_____
LTL	TWP	_____	R	_____	SEC	_____	QQQ	_____	QQ	_____	Q	_____

UTM _____ N ZONE _____
UTM _____ E NAD 1927 _____ NAD 1983 _____

Subsection:
1 = N½
2 = E½
3 = S½
4 = W½
5 = NE¼
6 = SE¼
7 = SW¼
8 = NW¼

City: _____

Street Number: _____

Street Name: 67th Ave NW

Urban Legal Description: _____

SITE DATA

Total # *Architectural* Features: 1

Fieldwork Date: 7/14/2017

Reconnaissance Survey Intensive Survey

Project Title & Supervisor:
Country Schoolhouse Project

Report Title & Author(s): _____

Additional Information: _____

SHSND USE

Area of Significance <u>2</u>	Ecozone <u>21</u>	Verified Site <u>1</u>	CR Type <u>2</u>
Area of Significance _____	Ecozone _____	Non-Site _____	
Area of Significance _____			

Recorded By Kathy Wilner Date Recorded 1/31/2017
(First Name & Last Name) (mm/dd/year)

Instructions to complete a digital version of this form: (1) Download a copy to your hard drive; (2) Open the saved blank copy; (3) Fill out the form; (4) Use the Save As command to rename the form appropriately and save; (5) Print and submit to SHSND.

NDCRS ARCHITECTURAL SITE FORM
PAGE 2—Feature Data

Field Code Crowfoot Township SchoolSITS# 32 MN

Complete one Page 2 for each architectural feature at the site.

Architectural Feature # 1

Construction Date _____

Feature Type 9Condition 5Feature Date 3Context 7Plan Shape 5Structural System 25Primary Exterior 26Style Other Style

Original Owner's Ethnicity _____

Secondary Exterior _____

Architect/Builder _____

Other Information:

Foundation Concrete Stories 1Roof/Cornice GableWindow Double hung, some framing, little glassDating Method(s): Estimate

Feature Preservation Recommendation(s) (Check all that apply):

 Individual nomination Contributes to a potential district No nomination potential Will not contribute to a district Potential district—feature would be a contributing element if other properties constitute a district Thematic nomination potential Component of a historic site or landscape

Moved (specify all applicable choices)—a) relocation occurred within a historic period; b) recreates original site, orientation, landscape, & spatial relationships; c) compatible in context with neighboring structures; d) relocation has damaged eligibility

 Historical associations require further investigation

Recorded By Kathy Wilner Date Recorded 1/31/2017
(First Name & Last Name) (mm/dd/year)

Instructions to complete a digital version of this form: (1) Download a copy to your hard drive; (2) Open the saved blank copy; (3) Fill out the form; (4) Use the Save As command to rename the form appropriately and save; (5) *Print* and submit to SHSND.

**NDCRS ARCHITECTURAL SITE FORM
PAGE 3—Feature Data**Field Code Crowfoot Township SchoolSITS# 32 MN**Complete a Page 3 for each feature.****1. Feature Description, Integrity, Eligibility:**

The feature is a one room prairie school on a concrete foundation. The gable roof of the main body of the school and the shed entry are covered with wood shakes with metal capping and finials. The addition at the east end of the school has asphalt shingles on the gable roof. There is a bell tower at peak of the west end of the roof. The tower base is ship lap with four corner posts holding up the pyramidal roof of the tower. This roof is covered with wood shakes with metal capping corners. At the peak of the bell tower is a flagpole. The soffits are closed. There is a red brick chimney at the peak at the east end. The building measures 34 feet east to west with the east addition another 12 feet east to west and 16 feet north to south. The west entry measures 4 feet by 6 feet.

There is a wide trim wall board under the soffits at the peak ends of the school. The remainder of the siding is 6 inch wood lap with 6 inch wood corner trim. A concrete step leads to the 5 panel wood entry door. Another 5 panel door leads into the coat room. There is one small covered window space on the north wall of the coatroom and a covered, double hung window on the south side. The school has 3 double hung, two over two, windows on the north side and 3 more on the south side with framing and some glass. The east most window on the north side is covered. There is a 2 panel wood door that leads into the addition. The addition has an opening on the east wall that is boarded up. The walls and ceiling are covered with wallboard and the ceiling curves toward the walls (cove ceiling) on the north and south walls. There is wainscot on all the walls. There is tongue and groove flooring. One blackboard between the middle and east window on the north wall. Light fixtures suggest electricity. There is an oil burning furnace at the east end of the school room. A single outhouse sits to the east of the building.

Recorded By Kathy Wilner Date Recorded 1/31/2017
(First Name & Last Name) (mm/dd/year)

Instructions to complete a digital version of this form: (1) Download a copy to your hard drive; (2) Open the saved blank copy; (3) Fill out the form; (4) Use the Save As command to rename the form appropriately and save; (5) Print and submit to SHSND.

**NDCRS ARCHITECTURAL SITE FORM
PAGE 4—SITE DESCRIPTION**

Field Code Crowfoot Township School

SITS# 32 MN

Complete one Page 4 for the entire site.

2. Owner's Contact Information:

Crowfoot Township
%Howard Gustafson
7631 66th Ave NW
Donnybrook ND 58734

3. Access (to rural areas):

From Coulee, go south on 62nd Ave NW 4 miles and turn right on 74th St NW and drive 5 miles west to 67th Ave NW, turn right again and go north 2 miles. Access from the north on 67th Ave NW is impassable and there is only a tired township road coming from 68th Ave NW.

4. Site Area (ft²): _____

5. Description of *SETTING*:

There is a large sough to the west and another south, a farm to the north and farm fields east.

Recorded By Kathy Wilner **Date Recorded** 1/31/2017
(First Name & Last Name) (mm/dd/year)

Instructions to complete a digital version of this form: (1) Download a copy to your hard drive; (2) Open the saved blank copy; (3) Fill out the form; (4) Use the Save As command to rename the form appropriately and save; (5) Print and submit to SHSND.

**NDCRS ARCHITECTURAL SITE FORM
PAGE 5—SITE DESCRIPTION**

Field Code Crowfoot Township School

SITS# 32 MN

6. Summary of ALL Site Features & Evaluation of Significance:

7. References/Comments:

Kathy Wilner
366 43rd Ave SE
Bowdon ND 58418

Recorded By Kathy Wilner Date Recorded 1/31/2017
(First Name & Last Name) (mm/dd/year)

Instructions to complete a digital version of this form: (1) Download a copy to your hard drive; (2) Open the saved blank copy; (3) Fill out the form; (4) Use the Save As command to rename the form appropriately and save; (5) Print and submit to SHSND.



West Side

Crowfoot
Township
School

7/14/2016

Kathy Wilner

MN

North Side





South Side

Crowfoot Township School

7/14/2016

Kathy Wilner

MN

East Side



bing maps

Notes

Crow Foot Township School

7/14/2016

Kathy Wilner

BK

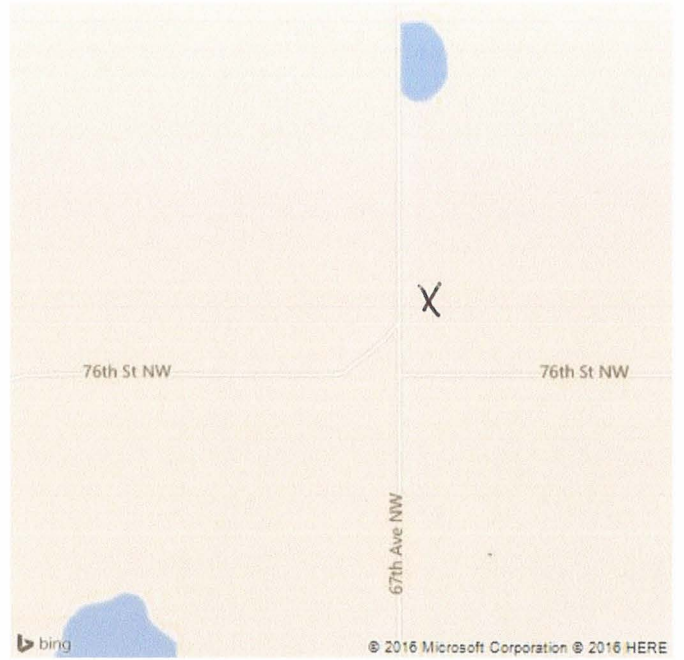

Feature