

NDCRS ARCHITECTURAL SITE FORM

PAGE 1

SITS# 32 MO 1412

SITE IDENTIFICATION

Field Code Bleth School

Site Name Bleth School

Map Quad Glen Ullin

Site Name _____

Map Quad _____

LTL	TWP	<u>138</u>	R	<u>89</u>	SEC	<u>13</u>	QQQ	<u>8</u>	QQ	<u>8</u>	Q	<u>7</u>
LTL	TWP	_____	R	_____	SEC	_____	QQQ	_____	QQ	_____	Q	_____
LTL	TWP	_____	R	_____	SEC	_____	QQQ	_____	QQ	_____	Q	_____
LTL	TWP	_____	R	_____	SEC	_____	QQQ	_____	QQ	_____	Q	_____

UTM _____ N ZONE _____
 UTM _____ E NAD 1927 _____ NAD 1983 _____

Subsection:
 1 = N½
 2 = E½
 3 = S½
 4 = W½
 5 = NE¼
 6 = SE¼
 7 = SW¼
 8 = NW¼

City: Glen Ullin ND

Street Number: Approx 4450

Street Name: Highway 49 SW

Urban Legal Description: _____

SITE DATA

Total # **Architectural** Features: 1

Fieldwork Date: 10/31/2012

Reconnaissance Survey Intensive Survey

Project Title & Supervisor:
Country Schoolhouse Project

Report Title & Author(s): _____

Additional Information: _____

SHSND USE

Area of Significance 2 Ecozone 23 Verified Site _____ CR Type 2
 Area of Significance _____ Ecozone _____ Non-Site _____
 Area of Significance _____

Recorded By Kathy Wilner Date Recorded 11/17/2012
 (First Name & Last Name) (mm/dd/year)

Instructions to complete a digital version of this form: (1) Download a copy to your hard drive; (2) Open the saved blank copy; (3) Fill out the form; (4) Use the Save As command to rename the form appropriately and save; (5) Print and submit to SHSND.

**NDCRS ARCHITECTURAL SITE FORM
PAGE 2—Feature Data**

Field Code Bleth School

SITS# 32 MO

Complete one Page 2 for each architectural feature at the site.

Architectural Feature # 1

Construction Date _____	Feature Type <u>9</u>	Condition <u>6</u>
Feature Date <u>3</u>	Context <u>7</u>	Plan Shape <u>5</u>
Structural System <u>25</u>	Primary Exterior <u>26</u>	Style <u>Other Style</u>
Original Owner's Ethnicity _____	Secondary Exterior _____	Architect/Builder _____

Other Information:

Foundation Crumbling concrete Stories 1

Roof/Cornice Hip

Window Double hung

Dating Method(s): professional estimate by

Feature Preservation Recommendation(s) (Check all that apply):

- Individual nomination
- Contributes to a potential district
- No nomination potential
- Will not contribute to a district
- Potential district—feature would be a contributing element if other properties constitute a district
- Thematic nomination potential
- Component of a historic site or landscape
- Moved (specify all applicable choices)—a) relocation occurred within a historic period; b) recreates original site, orientation, landscape, & spatial relationships; c) compatible in context with neighboring structures; d) relocation has damaged eligibility
- Historical associations require further investigation

Recorded By Kathy Wilner Date Recorded 11/17/2012
(First Name & Last Name) (mm/dd/year)

Instructions to complete a digital version of this form: (1) Download a copy to your hard drive; (2) Open the saved blank copy; (3) Fill out the form; (4) Use the Save As command to rename the form appropriately and save; (5) Print and submit to SHSND.

**NDCRS ARCHITECTURAL SITE FORM
PAGE 3—Feature Data**Field Code Bleth SchoolSITS# 32 MO**Complete a Page 3 for each feature.****1. Feature Description, Integrity, Eligibility:**

The feature is a one room prairie school sitting in prairie grass. The building has a hip roof with many of the shakes still attached. The roof is finished with overlapping metal ridge cap. Just under the eaves on all four sides there is an 8 inch wide trim board. School has 6 inch lap siding with 6 inch corner trim boards. Holes were drilled in the wall on the east side for blowing insulation into the wall spaces. There is a broken concrete at the entry and the door stands open. Above that entry door is a boarded up space where a transom window used to be. To either side of the door there are double hung windows. Stepping into the building there is a small room to the left with a small, hinged door on the east wall where deliver of fuel was made. The floor is tongue and groove hardwood and the walls are lathe and plaster. The ceiling was covered with ceiling tiles over lathe and plaster, much of it falling down, and light fixtures remain in the school. Blackboards were on 1/2 of the west wall and covered most of the north wall. Four windows are all covered with particle board on the inside of the school. The outside view of the windows shows most of the framing and some glass still intact. There is a trim board that runs around the school room about 1 foot from the ceiling. Wainscoting on most of the walls.

Recorded By Kathy Wilner Date Recorded 11/17/2012
(First Name & Last Name) (mm/dd/year)

Instructions to complete a digital version of this form: (1) Download a copy to your hard drive; (2) Open the saved blank copy; (3) Fill out the form; (4) Use the Save As command to rename the form appropriately and save; (5) Print and submit to SHSND.

**NDCRS ARCHITECTURAL SITE FORM
PAGE 4—SITE DESCRIPTION**Field Code Bleth SchoolSITS# 32 MO**Complete one Page 4 for the entire site.**

2. Owner's Contact Information:

DAvid Bleth
25816 S Ashwood
Sun Lakes AZ 85248

3. Access (to rural areas):

The school is just south of mile marker 65 on Highway 49 or .8 miles south of 44th St. SW. It is on the east side of the road.

4. Site Area (ft²): _____5. Description of **SETTING**:

There is an abandoned farm site just to the northeast of the school, corn field to the south, rolling country with buttes.

Recorded By Kathy Wilner Date Recorded 11/17/2012
(First Name & Last Name) (mm/dd/year)

Instructions to complete a digital version of this form: (1) Download a copy to your hard drive; (2) Open the saved blank copy; (3) Fill out the form; (4) Use the Save As command to rename the form appropriately and save; (5) Print and submit to SHSND.

**NDCRS ARCHITECTURAL SITE FORM
PAGE 5—SITE DESCRIPTION**

Field Code Bleth School

SITS# 32 MO

6. Summary of ALL Site Features & Evaluation of Significance:

7. References/Comments:

Kathy Wilner
366 43rd Ave SE
Bowdon ND 58418

Recorded By Kathy Wilner Date Recorded 11/17/2012
(First Name & Last Name) (mm/dd/year)

Instructions to complete a digital version of this form: (1) Download a copy to your hard drive; (2) Open the saved blank copy; (3) Fill out the form; (4) Use the Save As command to rename the form appropriately and save; (5) *Print* and submit to SHSND.



South Side

Bleth School

10/31/2012

Kathy Wilner

MO

West Side





East Side

Bleth School

10/31/2012

Kathy Wilner

MO

North Side



TWP 138N - R89W DIRECTORY

T-138-N

CODE: BD

R-89-W

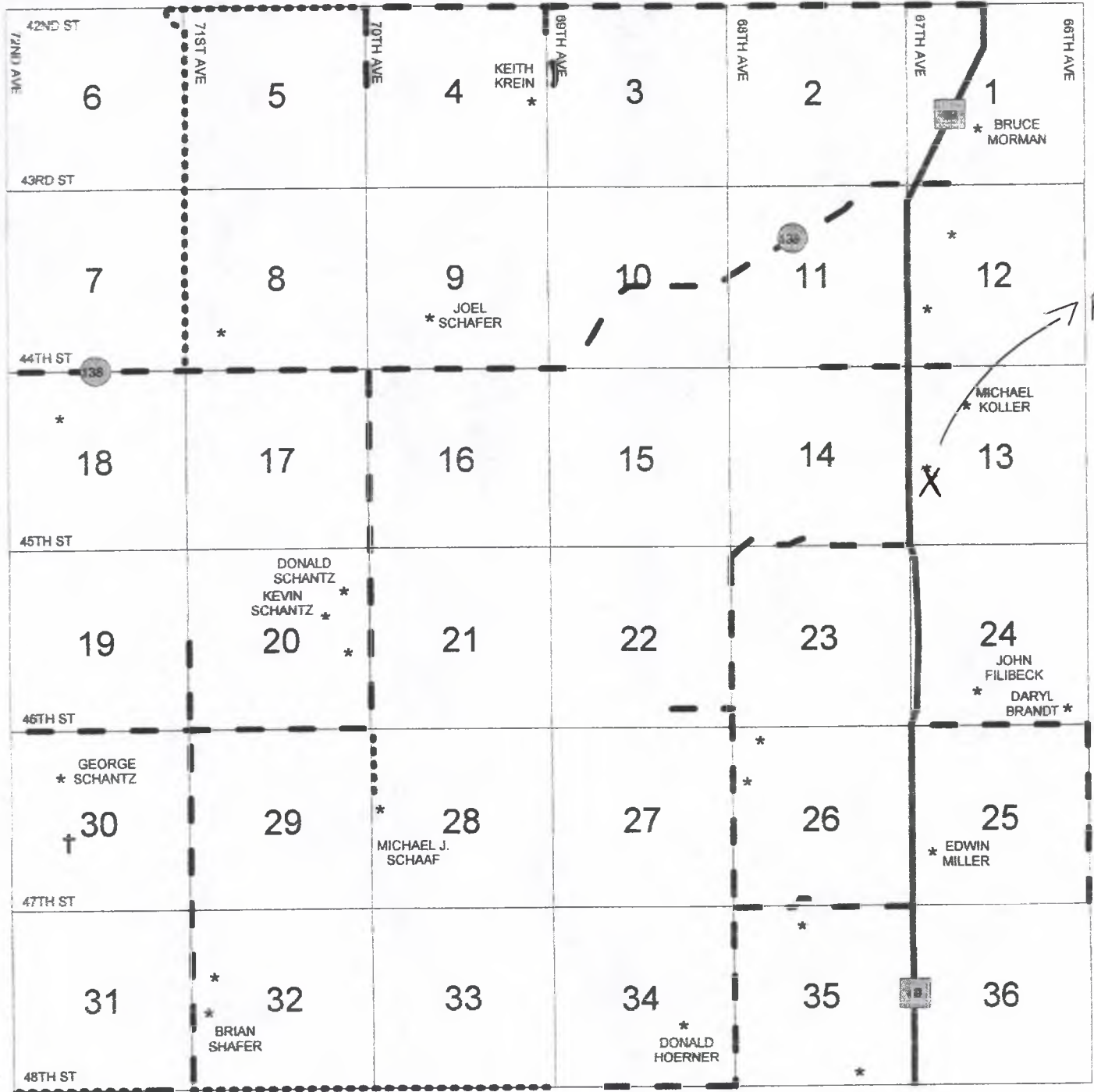

Bleth School

10/31/2012

Kathy Wilner

mo

BY	BZ	CA	CB	CC	CD	CE	CF	CG	CH
BN	BO	BP	BQ	BR	BS	BT	BU	BV	BW
BC	BD	BE	BF	BG	BH	BI	BJ	BK	BL
	AT	AU	AV	AW	AX	AY	AZ	BA	BB
		AN	AO	AP	AQ	AR	AS		
		AH	AI	AJ	AK	AL	AM		
		AB	AC	AD	AE	AF	AG		
								AA	