

# NDCRS ARCHITECTURAL SITE FORM

## PAGE 1

SITS# 32 MO 1497

### SITE IDENTIFICATION

Field Code Fairview School #4

Site Name Fairview School #4

Site Name Windhorst School

Map Quad New Salem

Map Quad \_\_\_\_\_

LTL	TWP	<u>139</u>	R	<u>85</u>	SEC	<u>16</u>	QQQ	<u>5</u>	QQ	<u>6</u>	Q	<u>7</u>
LTL	TWP	_____	R	_____	SEC	_____	QQQ	_____	QQ	_____	Q	_____
LTL	TWP	_____	R	_____	SEC	_____	QQQ	_____	QQ	_____	Q	_____
LTL	TWP	_____	R	_____	SEC	_____	QQQ	_____	QQ	_____	Q	_____

UTM \_\_\_\_\_ 5191430 \_\_\_\_\_ N

ZONE 14N

UTM \_\_\_\_\_ 315626 \_\_\_\_\_ E

NAD 1927 \_\_\_\_\_ NAD 1983 \_\_\_\_\_

**Subsection:**

- 1 = N½
- 2 = E½
- 3 = S½
- 4 = W½
- 5 = NE¼
- 6 = SE¼
- 7 = SW¼
- 8 = NW¼

City: New Salem ND

Street Number: \_\_\_\_\_

Street Name: Morton County Road 31

Urban Legal Description: \_\_\_\_\_

### SITE DATA

Total # *Architectural* Features: 1

Fieldwork Date: 6/6/2016

Reconnaissance Survey

Intensive Survey \_\_\_\_\_

Project Title & Supervisor:

Country Schoolhouse Project

Report Title & Author(s):

Additional Information: \_\_\_\_\_

### SHSND USE

Area of Significance 2

Ecozone 23

Verified Site 1

CR Type 2

Area of Significance \_\_\_\_\_

Ecozone \_\_\_\_\_

Non-Site \_\_\_\_\_

Area of Significance \_\_\_\_\_

Recorded By Kathy Wilner  
(First Name & Last Name)

Date Recorded 10/29/2016  
(mm/dd/year)

*Instructions to complete a digital version of this form:* (1) Download a copy to your hard drive; (2) Open the saved blank copy; (3) Fill out the form; (4) Use the Save As command to rename the form appropriately and save; (5) Print and submit to SHSND.

**NDCRS ARCHITECTURAL SITE FORM  
PAGE 2—Feature Data**

Field Code Fairview School #4SITS# 32 MO**Complete one Page 2 for each architectural feature at the site.****Architectural Feature #** 1Construction Date 1921Feature Type 9Condition 7Feature Date 4Context 7Plan Shape 5Structural System 25Primary Exterior 26Style Other Style

Original Owner's Ethnicity \_\_\_\_\_

Secondary Exterior \_\_\_\_\_

Architect/Builder \_\_\_\_\_

Other Information:

Foundation Poured concrete Stories 1Roof/Cornice hip roof with gable roof on the entryWindow double hung, 2 pane windowsDating Method(s): History at the school**Feature Preservation Recommendation(s) (Check all that apply):** Individual nomination Contributes to a potential district No nomination potential Will not contribute to a district Potential district—feature would be a contributing element if other properties constitute a district Thematic nomination potential Component of a historic site or landscape

Moved (specify all applicable choices)—a) relocation occurred within a historic period; b) recreates original site, orientation, landscape, & spatial relationships; c) compatible in context with neighboring structures; d) relocation has damaged eligibility

 Historical associations require further investigation

Recorded By Kathy Wilner Date Recorded 10/29/2016  
(First Name & Last Name) (mm/dd/year)

*Instructions to complete a digital version of this form: (1) Download a copy to your hard drive; (2) Open the saved blank copy; (3) Fill out the form; (4) Use the Save As command to rename the form appropriately and save; (5) Print and submit to SHSND.*

**NDCRS ARCHITECTURAL SITE FORM**  
**PAGE 3—Feature Data**

Field Code Fairview School #4SITS# 32 MO**Complete a Page 3 for each feature.****1. Feature Description, Integrity, Eligibility:**

Fairview School #4 is a one room prairie school that was moved to its current location for use as a display building in a museum complex. It sits on a newer poured concrete foundation and there are newer wood steps leading up the entry. The hip roof is covered with green metal and that runs right on to the gable part of the entry roof. At the gable end of the entry there is a wide trim board just under the peak and then a small, decorative roof piece that goes from side to side just about the soffit. All the soffits are closed. There is no chimney.

A wide trim board runs around all side of the school just under the roof. The remainder of the siding is 6 inch wood lap with 6 inch corner trim. Yet another wider trim board directly under a waterboard finishes the siding at the bottom. The building is painted white. There are 4 double hung windows on the south side, one on the north along with another small two pane fixed window near the west end of the north side and three more double hung windows on the east side, all with intact glass. There is a combination storm door opening up to a 5 panel wood door which leads into the entry of the school. The walls in the entry are covered with wall board. There is another wood door giving entry to small room that might have been used as more coat room space and further into this area is yet another door which leads to a storeroom. All the doors and windows have decorative cornices above them. This might have been used for fuel at one point. An opening to the left just inside the first door from the entry leads into the school proper. All the windows have shade which pull down from the top and they all have curtains on the bottom half of the window. The walls in this part of the school are all covered with paneling above beadboard wainscot. The ceiling is covered with wallboard panels and there are light fixtures indicative of electricity. The floor is tongue and groove and wood.

The school measures 24 feet north to south and 30 feet east to west. The entry is part of the 30 foot measurement and is 5 feet wide.

This building is used for display. Earliest notes indicated it was the office for the museum complex at one point. A display in the school has this to say about it: "School house #4 was built on the southeast corner of Section 23 and was known as the Windhorst School. In 1949 it was moved to the northeast corner of Section 22 along Highway 31. This was the only school open in the district at this time and it was kept open until 1967 when it was annexed to the New Salem School District. The school was moved to New Salem near the museum at the North Park."

Recorded By Kathy Wilner Date Recorded 10/29/2016  
(First Name & Last Name) (mm/dd/year)

*Instructions to complete a digital version of this form: (1) Download a copy to your hard drive; (2) Open the saved blank copy; (3) Fill out the form; (4) Use the Save As command to rename the form appropriately and save; (5) Print and submit to SHSND.*

**NDCRS ARCHITECTURAL SITE FORM  
PAGE 4—SITE DESCRIPTION**

Field Code Fairview School #4

SITS# 32 MO

**Complete one Page 4 for the entire site.**

2. Owner's Contact Information:

New Salem Historical Society Museum  
New Salem ND 58563

3. Access (to rural areas):

New Salem, Exit 127 off of Interstate Highway 94 going south you will find yourself on North 8th Street (Highway 31). The complex is about 1 mile south and the buildings are on the west side of the street. There is a collection of buildings and this school is the south most building.

4. Site Area (ft<sup>2</sup>): \_\_\_\_\_

5. Description of **SETTING**:

The school is located in a museum complex and it is the south most building with another one room school located just north. The area south of the museum complex is a football field, there are crops just to the east and trees and other building to the west.

Recorded By Kathy Wilner Date Recorded 10/29/2016  
(First Name & Last Name) (mm/dd/year)

*Instructions to complete a digital version of this form: (1) Download a copy to your hard drive; (2) Open the saved blank copy; (3) Fill out the form; (4) Use the Save As command to rename the form appropriately and save; (5) Print and submit to SHSND.*

**NDCRS ARCHITECTURAL SITE FORM  
PAGE 5—SITE DESCRIPTION**

Field Code Fairview School #4

SITS# 32 MO

**6. Summary of ALL Site Features & Evaluation of Significance:**

**7. References/Comments:**

Kathy Wilner  
366 43rd Ave SE  
Bowdon ND 58418

Recorded By Kathy Wilner Date Recorded 10/29/2016  
(First Name & Last Name) (mm/dd/year)

*Instructions to complete a digital version of this form: (1) Download a copy to your hard drive; (2) Open the saved blank copy; (3) Fill out the form; (4) Use the Save As command to rename the form appropriately and save; (5) Print and submit to SHSND.*



East Side

Fairview School #4

6/6/2016

Kathy Wilner

MO

North Side





South Side

Fairview School #4

6/6/2016

Kathy Wilner

MO

West Side



bing maps

Notes

Fairview School #4

6/6/2016

Kathy Wilner

MO

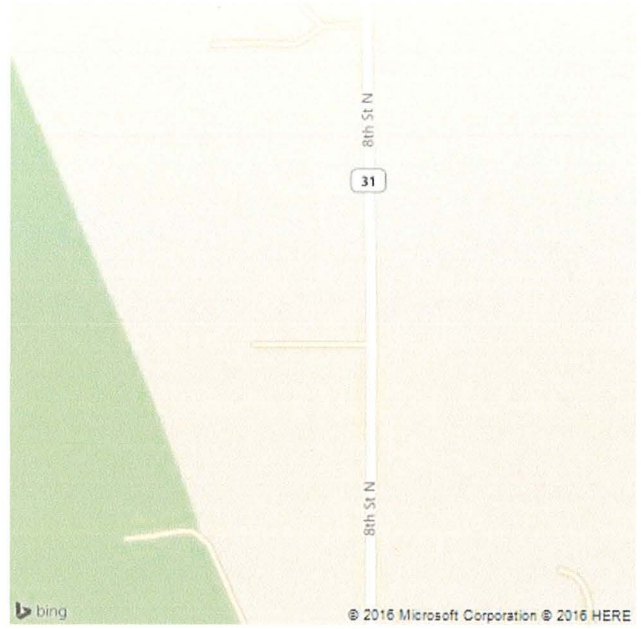

Feature