

NDCRS ARCHITECTURAL SITE FORM PAGE 1

SITS# 32 MT 388

SITE IDENTIFICATION

Field Code Iowa Township School #1

Site Name Iowa Township School #1
Site Name _____

Map Quad Coldwater Lake SW
Map Quad _____

LTL	TWP	<u>130</u>	R	<u>68</u>	SEC	<u>11</u>	QQQ	<u>7</u>	QQ	<u>8</u>	Q	<u>7</u>
LTL	TWP	_____	R	_____	SEC	_____	QQQ	_____	QQ	_____	Q	_____
LTL	TWP	_____	R	_____	SEC	_____	QQQ	_____	QQ	_____	Q	_____
LTL	TWP	_____	R	_____	SEC	_____	QQQ	_____	QQ	_____	Q	_____

UTM _____ N ZONE _____
UTM _____ E NAD 1927 _____ NAD 1983 _____

City: _____

Street Number: _____

Street Name: 58th Ave SE

Urban Legal Description: _____

Subsection:
1 = N $\frac{1}{2}$
2 = E $\frac{1}{2}$
3 = S $\frac{1}{2}$
4 = W $\frac{1}{2}$
5 = NE $\frac{1}{4}$
6 = SE $\frac{1}{4}$
7 = SW $\frac{1}{4}$
8 = NW $\frac{1}{4}$

SITE DATA

Total # **Architectural** Features: 1

Fieldwork Date: 8/12/2016

Reconnaissance Survey Intensive Survey

Project Title & Supervisor:
Country Schoolhouse Project

Report Title & Author(s):

Additional Information: _____

SHSND USE

Area of Significance <u>2</u>	Ecozone <u>19</u>	Verified Site <u>1</u>	CR Type <u>2</u>
Area of Significance _____	Ecozone _____	Non-Site _____	
Area of Significance _____			

Recorded By Kathy Wilner Date Recorded 1/22/2017
(First Name & Last Name) (mm/dd/year)

Instructions to complete a digital version of this form: (1) Download a copy to your hard drive; (2) Open the saved blank copy; (3) Fill out the form; (4) Use the Save As command to rename the form appropriately and save; (5) *Print* and submit to SHSND.

NDCRS ARCHITECTURAL SITE FORM
PAGE 2—Feature Data

Field Code Iowa Township School #1SITS# 32 MT**Complete one Page 2 for each architectural feature at the site.****Architectural Feature #** 1

Construction Date _____

Feature Type 9Condition 4Feature Date 2Context 7Plan Shape 5Structural System 25Primary Exterior 26Style Other Style

Original Owner's Ethnicity _____

Secondary Exterior _____

Architect/Builder _____

Other Information:

Foundation Concrete Stories 1Roof/Cornice HipWindow Double hung, most closed openings, two farming and some glassDating Method(s): Estimate**Feature Preservation Recommendation(s) (Check all that apply):** Individual nomination Contributes to a potential district No nomination potential Will not contribute to a district Potential district—feature would be a contributing element if other properties constitute a district Thematic nomination potential Component of a historic site or landscape

Moved (specify all applicable choices)—a) relocation occurred within a historic period; b) recreates original site, orientation, landscape, & spatial relationships; c) compatible in context with neighboring structures; d) relocation has damaged eligibility

 Historical associations require further investigation

Recorded By Kathy Wilner Date Recorded 1/22/2017
(First Name & Last Name) (mm/dd/year)

Instructions to complete a digital version of this form: (1) Download a copy to your hard drive; (2) Open the saved blank copy; (3) Fill out the form; (4) Use the Save As command to rename the form appropriately and save; (5) *Print* and submit to SHSND.

**NDCRS ARCHITECTURAL SITE FORM
PAGE 3—Feature Data**Field Code Iowa Township School #1SITS# 32 MT**Complete a Page 3 for each feature.****1. Feature Description, Integrity, Eligibility:**

The feature is a one room prairie school on a concrete foundation. The hip roof has very few wood shakes on the roof planking and the planking is also quite compromised. The soffits are open and there is no chimney. The building measures 28 feet north to south and 18 feet east to west.

Wide trim boards runs under the soffits on all four sides. The remainder of the siding is 6 inch wood lap with metal corner caps. Near the lower part of the siding there is a wide trim board with water table. On the north wall of the school there is a fuel door. There is an entry without a door, reached by a concrete pad. There are coat rooms to either side of the entry foyer. One double hung, two over two, window is in each coat room, the west window is covered and has glass, the east window is uncovered and has some framing and glass. The window openings in the main body of the school are all covered with particle board and there is no glass or framing. The walls are partially covered with lathe and plaster. The ceiling only has lathe remaining and the daylight shines through. The building was used for grain storage. The floor is tongue and groove hardwood, in bad shape. There are no blackboards but the north wall shows where it was. No wainscot or electricity.

Recorded By Kathy Wilner Date Recorded 1/22/2017
(First Name & Last Name) (mm/dd/year)

Instructions to complete a digital version of this form: (1) Download a copy to your hard drive; (2) Open the saved blank copy; (3) Fill out the form; (4) Use the Save As command to rename the form appropriately and save; (5) *Print* and submit to SHSND.

**NDCRS ARCHITECTURAL SITE FORM
PAGE 4—SITE DESCRIPTION**Field Code Iowa Township School #1SITS# 32 MT**Complete one Page 4 for the entire site.**

2. Owner's Contact Information:

3. Access (to rural areas):

East of Ashley on Highway 11 9 miles to 58th Ave SE, turn left and drive north 3 1/2 miles to see the school on your right. It is 1/2 mile south of 91st St SE.

4. Site Area (ft²): _____5. Description of **SETTING**:

The land around this school is hilly with pasture west and south and sloughs to the southeast as well as the southwest. Farm fields north and east.

Recorded By Kathy Wilner Date Recorded 1/22/2017
(First Name & Last Name) (mm/dd/year)

Instructions to complete a digital version of this form: (1) Download a copy to your hard drive; (2) Open the saved blank copy; (3) Fill out the form; (4) Use the Save As command to rename the form appropriately and save; (5) Print and submit to SHSND.

**NDCRS ARCHITECTURAL SITE FORM
PAGE 5—SITE DESCRIPTION**

Field Code Iowa Township School #1

SITS# 32 MT

6. Summary of ALL Site Features & Evaluation of Significance:

7. References/Comments:

Kathy Wilner
366 43rd Ave SE
Bowdon ND 58418

Recorded By Kathy Wilner Date Recorded 1/22/2017
(First Name & Last Name) (mm/dd/year)

Instructions to complete a digital version of this form: (1) Download a copy to your hard drive; (2) Open the saved blank copy; (3) Fill out the form; (4) Use the Save As command to rename the form appropriately and save; (5) Print and submit to SHSND.



East Side

Iowa
Township
School #1

8/12/2016

Kathy Wilner

MT

North Side





South Side

Iowa Township School #1

8/12/2016

Kathy Wilner

MT

West Side



bing maps

Notes

Iowa Township School #1

8/12/2016

Kathy Wilner

MT

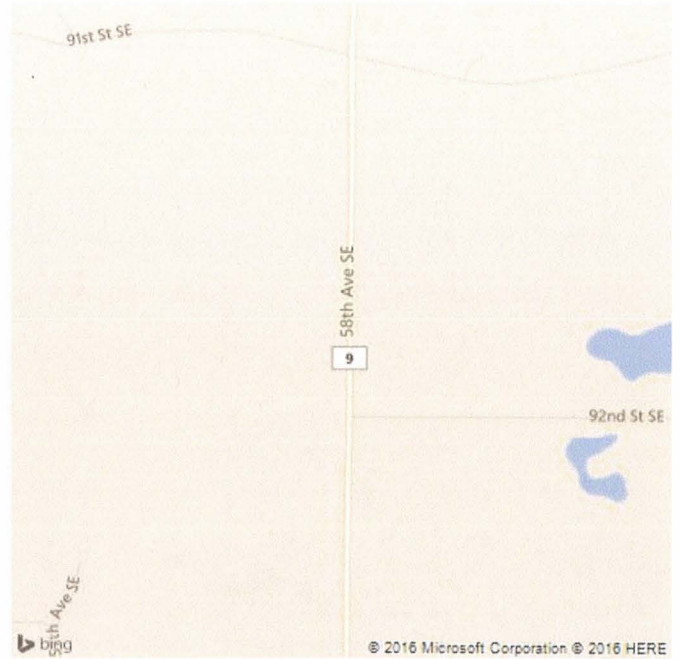

Feature