

NDCRS ARCHITECTURAL SITE FORM PAGE 1

SITS# 32 NE 89

SITE IDENTIFICATION

Field Code Leval Township School Site Name Leval Township School

Map Quad Tolna Site Name _____

Map Quad _____

LTL	TWP	<u>151</u>	R	<u>61</u>	SEC	<u>28</u>	QQQ	<u>7</u>	QQ	<u>7</u>	Q	<u>7</u>
LTL	TWP	_____	R	_____	SEC	_____	QQQ	_____	QQ	_____	Q	_____
LTL	TWP	_____	R	_____	SEC	_____	QQQ	_____	QQ	_____	Q	_____
LTL	TWP	_____	R	_____	SEC	_____	QQQ	_____	QQ	_____	Q	_____

UTM _____ N ZONE _____
UTM _____ E NAD 1927 _____ NAD 1983 _____

City: Tolna

Street Number: _____

Street Name: 32nd St NE

Urban Legal Description: _____

Subsection:
1 = N $\frac{1}{2}$
2 = E $\frac{1}{2}$
3 = S $\frac{1}{2}$
4 = W $\frac{1}{2}$
5 = NE $\frac{1}{4}$
6 = SE $\frac{1}{4}$
7 = SW $\frac{1}{4}$
8 = NW $\frac{1}{4}$

SITE DATA

Total # *Architectural* Features: 1

Fieldwork Date: 10/24/2014

Reconnaissance Survey Intensive Survey

Project Title & Supervisor:

Country Schoolhouse Project

Report Title & Author(s):

Additional Information: _____

SHSND USE

Area of Significance <u>2</u>	Ecozone <u>17</u>	Verified Site <u>1</u>	CR Type <u>2</u>
Area of Significance _____	Ecozone _____	Non-Site _____	
Area of Significance _____			

Recorded By Kathy Wilner Date Recorded 2/16/2014
(First Name & Last Name) (mm/dd/year)

Instructions to complete a digital version of this form: (1) Download a copy to your hard drive; (2) Open the saved blank copy; (3) Fill out the form; (4) Use the Save As command to rename the form appropriately and save; (5) Print and submit to SHSND.

NDCRS ARCHITECTURAL SITE FORM
PAGE 2—Feature Data

Field Code Leval Township School

SITS# 32 NE

Complete one Page 2 for each architectural feature at the site.

Architectural Feature # 1

Construction Date Feature Type 9 Condition 5
Feature Date 4 Context 7 Plan Shape 7
Structural System 25 Primary Exterior 26 Style Other Style
Original Owner's Ethnicity Secondary Exterior Architect/Builder

Other Information:

Foundation Concrete Stories 1

Roof/Cornice Gable, hip

Window Double hung

Dating Method(s): professional estimate

Feature Preservation Recommendation(s) (Check all that apply):

- Individual nomination
Contributes to a potential district
No nomination potential
Will not contribute to a district
Potential district—feature would be a contributing element if other properties constitute a district
Thematic nomination potential
Component of a historic site or landscape
Moved (specify all applicable choices)—a) relocation occurred within a historic period; b) recreates original site, orientation, landscape, & spatial relationships; c) compatible in context with neighboring structures; d) relocation has damaged eligibility
Historical associations require further investigation

Recorded By Kathy Wilner Date Recorded 2/16/2014
(First Name & Last Name) (mm/dd/year)

Instructions to complete a digital version of this form: (1) Download a copy to your hard drive; (2) Open the saved blank copy; (3) Fill out the form; (4) Use the Save As command to rename the form appropriately and save; (5) Print and submit to SHSND.

NDCRS ARCHITECTURAL SITE FORM
PAGE 3—Feature DataField Code Leval Township SchoolSITS# 32 NE**Complete a Page 3 for each feature.****1. Feature Description, Integrity, Eligibility:**

The feature is two framed one room schools attached to make a two room school. It appears that a gable roofed school was moved to the west side of a hip roofed school and they were attached and roofed to enclose the opening. The buildings sit on concrete foundation. The roofing is asphalt with the gable roof of the western building tied into the west slope of the eastern, hip roofed building. There is also an entry with a gable roof tied into the south slope of the east part of the building. There is a tall red bricked chimney on the north side, tucked into the corner where the two buildings meet. The chimney is entirely outside of the building and tied to the roof to keep it from tipping away. All eaves are have finished soffits. The north part of the building measures 16 1/2 feet north to south and 34 feet east to west. The south part of the building is 24 feet square with an 8 X 8 entry.

There are headers under the north peak of the school and around the existing sides of the eastern part. Also a header under the peak of the entry. Siding is 6 inch wood lap with 4 inch wood corner trim. Many areas show the underlying wood lumber where siding as fallen away or been removed. There are two sets of two double hung windows on the south wall of the north part of the school, most of the glass is broken. No windows on the northern part of the west end. On the east end there are two pairs of windows, glass broken, in the south facing wall, either side of the entry. Another window opening on the north side has no glass or framing. There is a door opening on the north side of the east part of the school. The east wall has two opening that were filled in with wood lap and perhaps were windows. The entry has a 5 panel wood door allowing entry into the school. On the east side of the entry is a covered opening that may have been a window. The flooring is hard wood tongue and groove. The walls are of different materials, paneling on most walls, wall board on others, wainscot is behind some of the paneling. The ceiling is a falling-in dropped ceiling with lathe and plaster above it. There are no blackboards left. There is electricity in the school and the heat was fuel oil.

Recorded By Kathy Wilner Date Recorded 2/16/2014
(First Name & Last Name) (mm/dd/year)

Instructions to complete a digital version of this form: (1) Download a copy to your hard drive; (2) Open the saved blank copy; (3) Fill out the form; (4) Use the Save As command to rename the form appropriately and save; (5) *Print* and submit to SHSND.

**NDCRS ARCHITECTURAL SITE FORM
PAGE 4—SITE DESCRIPTION**

Field Code Leval Township School

SITS# 32 NE

Complete one Page 4 for the entire site.

2. Owner's Contact Information:

Harris Forde
9991 29th ST NE
Tolna ND 58380

3. Access (to rural areas):

Driving north of Tolna on County Road 23 2 miles, turn left onto County Road or 31st St NE and drive two miles west to see the school on the north side of the road.

4. Site Area (ft²): _____

5. Description of **SETTING**:

The building sits in a farm field with fields in all directions. There is a farm sit far to the west.

Recorded By Kathy Wilner Date Recorded 2/16/2014
(First Name & Last Name) (mm/dd/year)

Instructions to complete a digital version of this form: (1) Download a copy to your hard drive; (2) Open the saved blank copy; (3) Fill out the form; (4) Use the Save As command to rename the form appropriately and save; (5) Print and submit to SHSND.

**NDCRS ARCHITECTURAL SITE FORM
PAGE 5—SITE DESCRIPTION**

Field Code Leval Township School

SITS# 32 NE

6. Summary of ALL Site Features & Evaluation of Significance:

7. References/Comments:

Kathy Wilner
366 43rd Ave SE
Bowdon ND 58418

Recorded By Kathy Wilner Date Recorded 2/16/2014
(First Name & Last Name) (mm/dd/year)

Instructions to complete a digital version of this form: (1) Download a copy to your hard drive; (2) Open the saved blank copy; (3) Fill out the form; (4) Use the Save As command to rename the form appropriately and save; (5) Print and submit to SHSND.



South Side

Leval Township School

10/24/2014

Kathy Wilner

NE

West Side





North Side

Leval Township School

10/24/2014

Kathy Wilner

NE

East Side



LEVAL DIRECTORY

T-151-N

CODE: AO

R-61-W

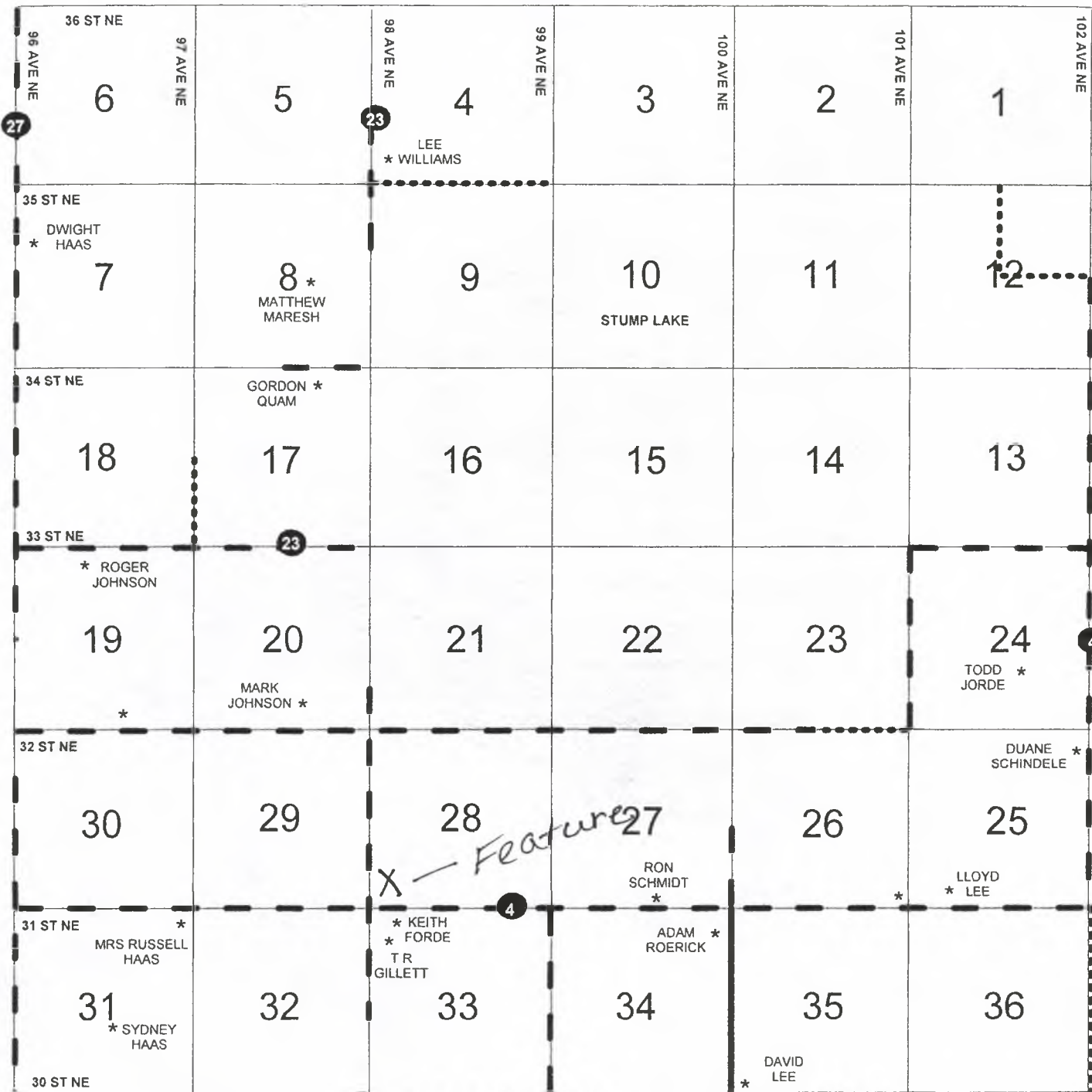

Leval Township School 10-24-2014 Kathy Wilne- N

AD	AH	BA	AE		
AM	AY	AQ	AS		
AL	AG	BC	AR	AW	AX
AO	BB	AC	AP	AA	
AF	AV	AK	AI	AZ	
AJ	AB	AT	AN	AU	