

NDCRS ARCHITECTURAL SITE FORM PAGE 1

SITS# 32 NE 91

SITE IDENTIFICATION

Field Code Rugh #1 Site Name Rugh #1

Map Quad Niagara NW
Map Quad _____
Site Name _____

LTL	TWP	<u>150</u>	R	<u>57</u>	SEC	<u>29</u>	QQQ	<u>5</u>	QQ	<u>5</u>	Q	<u>8</u>
LTL	TWP	_____	R	_____	SEC	_____	QQQ	_____	QQ	_____	Q	_____
LTL	TWP	_____	R	_____	SEC	_____	QQQ	_____	QQ	_____	Q	_____
LTL	TWP	_____	R	_____	SEC	_____	QQQ	_____	QQ	_____	Q	_____

UTM _____ N ZONE _____
UTM _____ E NAD 1927 _____ NAD 1983 _____

Subsection:
1 = N½
2 = E½
3 = S½
4 = W½
5 = NE¼
6 = SE¼
7 = SW¼
8 = NW¼

City: Aneta

Street Number: _____

Street Name: 26th St NE

Urban Legal Description: _____

SITE DATA

Total # *Architectural* Features: 1

Fieldwork Date: 10/24/2014

Reconnaissance Survey Intensive Survey

Project Title & Supervisor:
Country Schoolhouse Project

Report Title & Author(s): _____

Additional Information: _____

SHSND USE

Area of Significance <u>2</u>	Ecozone <u>17</u>	Verified Site <u>1</u>	CR Type <u>2</u>
Area of Significance _____	Ecozone _____	Non-Site _____	
Area of Significance _____			

Recorded By Kathy Wilner Date Recorded 2/19/2015
(First Name & Last Name) (mm/dd/year)

Instructions to complete a digital version of this form: (1) Download a copy to your hard drive; (2) Open the saved blank copy; (3) Fill out the form; (4) Use the Save As command to rename the form appropriately and save; (5) *Print* and submit to SHSND.

NDCRS ARCHITECTURAL SITE FORM PAGE 2—Feature Data

Field Code Rugh #1

SITS# 32 NE

Complete one Page 2 for each architectural feature at the site.

Architectural Feature # 1

Construction Date _____

Feature Type 9

Condition 5

Feature Date 4

Context 7

Plan Shape 5

Structural System 25

Primary Exterior 26

Style ~~Other Style~~ Hipped Roof Box

Original Owner's Ethnicity _____

Secondary Exterior _____

Architect/Builder _____

Other Information:

Foundation Concrete

Stories 1.5

Roof/Cornice Hip

Window Double hung

Dating Method(s): professional estimate

Feature Preservation Recommendation(s) (Check all that apply):

- Individual nomination
- Contributes to a potential district
- No nomination potential
- Will not contribute to a district
- Potential district—feature would be a contributing element if other properties constitute a district
- Thematic nomination potential
- Component of a historic site or landscape
- Moved (specify all applicable choices)—a) relocation occurred within a historic period; b) recreates original site, orientation, landscape, & spatial relationships; c) compatible in context with neighboring structures; d) relocation has damaged eligibility
- Historical associations require further investigation

Recorded By Kathy Wilner
(First Name & Last Name)

Date Recorded 2/19/2015
(mm/dd/year)

Instructions to complete a digital version of this form: (1) Download a copy to your hard drive; (2) Open the saved blank copy; (3) Fill out the form; (4) Use the Save As command to rename the form appropriately and save; (5) Print and submit to SHSND.

NDCRS ARCHITECTURAL SITE FORM
PAGE 3—Feature DataField Code Rugh #1SITS# 32 NE**Complete a Page 3 for each feature.****1. Feature Description, Integrity, Eligibility:**

The feature is a wood framed one room prairie school sitting on a concrete foundation. There is a flagpole at the east end of the building at the peak of the dormer. The dormer and school have wood shakes over wood sheathing. There is metal capping on the peak and all four seams of the roof. Some of the shakes have fallen away. A tilting, brick chimney is at the west end of the school on that slope of the hip roof. There is a pipe out of the east slope of the roof from the bathrooms. The eaves have closed soffits. The building measures 20 feet north to south and 34 feet east to west.

There is a wide header under the eaves on all side of the school. The siding is 6 inch wood lap with 4 inch wood corner trim. About half of the paint is worn away. There is broken 5 panel wood door at the entry with a transom above it. Just inside the school there are two 5 panel wood doors to the left that go into bathrooms with a wall on the right. I am guessing that is where the coat room was. There is a 4 panel wood door going into the main body of the school. To the side of the entry door there is an opening that has remnants of framing for a window. On the south wall of the school there are two smaller double hung windows that are in the bathrooms. Also on the south wall there is a bank of 6 double hung windows with about half the glass present.

There is wall board on the walls and ceiling of the bathrooms and entry. Walls inside the main body of the school are of wood panel, painted yellow. The ceiling has 12 inch ceiling tiles. Flooring is a mix of hardwood tongue and groove and tile over wood floor. There is a blackboard on the south half of the west wall and another on the north wall. The west wall has a fuel oil burning stove. There is electricity present evidenced by an outdoor light as well as light fixtures in the school.

Recorded By Kathy Wilner Date Recorded 2/19/2015
(First Name & Last Name) (mm/dd/year)

Instructions to complete a digital version of this form: (1) Download a copy to your hard drive; (2) Open the saved blank copy; (3) Fill out the form; (4) Use the Save As command to rename the form appropriately and save; (5) Print and submit to SHSND.

**NDCRS ARCHITECTURAL SITE FORM
PAGE 4—SITE DESCRIPTION**

Field Code Rugh #1

SITS# 32 NE

Complete one Page 4 for the entire site.

2. Owner's Contact Information:

Sherman and Acta Mandt Trust

3. Access (to rural areas):

North of Aneta on Highway 32 6 miles to 26th St NE. Turn right (east) and drive about 1/2 mile. The school is on the south side of the road.

4. Site Area (ft²): _____

5. Description of **SETTING**:

There is a small abandoned farm to the north and farm fields in all other direction.

Recorded By Kathy Wilner Date Recorded 2/19/2015
(First Name & Last Name) (mm/dd/year)

Instructions to complete a digital version of this form: (1) Download a copy to your hard drive; (2) Open the saved blank copy; (3) Fill out the form; (4) Use the Save As command to rename the form appropriately and save; (5) Print and submit to SHSND.

**NDCRS ARCHITECTURAL SITE FORM
PAGE 5—SITE DESCRIPTION**

Field Code Rugh #1

SITS# 32 NE

6. Summary of ALL Site Features & Evaluation of Significance:

7. References/Comments:

Kathy Wilner
366 43rd Ave SE
Bowdon ND 58418

Recorded By Kathy Wilner Date Recorded 2/19/2015
(First Name & Last Name) (mm/dd/year)

Instructions to complete a digital version of this form: (1) Download a copy to your hard drive; (2) Open the saved blank copy; (3) Fill out the form; (4) Use the Save As command to rename the form appropriately and save; (5) Print and submit to SHSND.



East Side

Rugh Township School #1

10/24/2014

Kathy Wilner

NE

North Side





South Side

Rugh Township School #1

10/24/2014

Kathy Wilner

NE

West Side



RUGH DIRECTORY

T-150-N

CODE: AZ

R-57-W

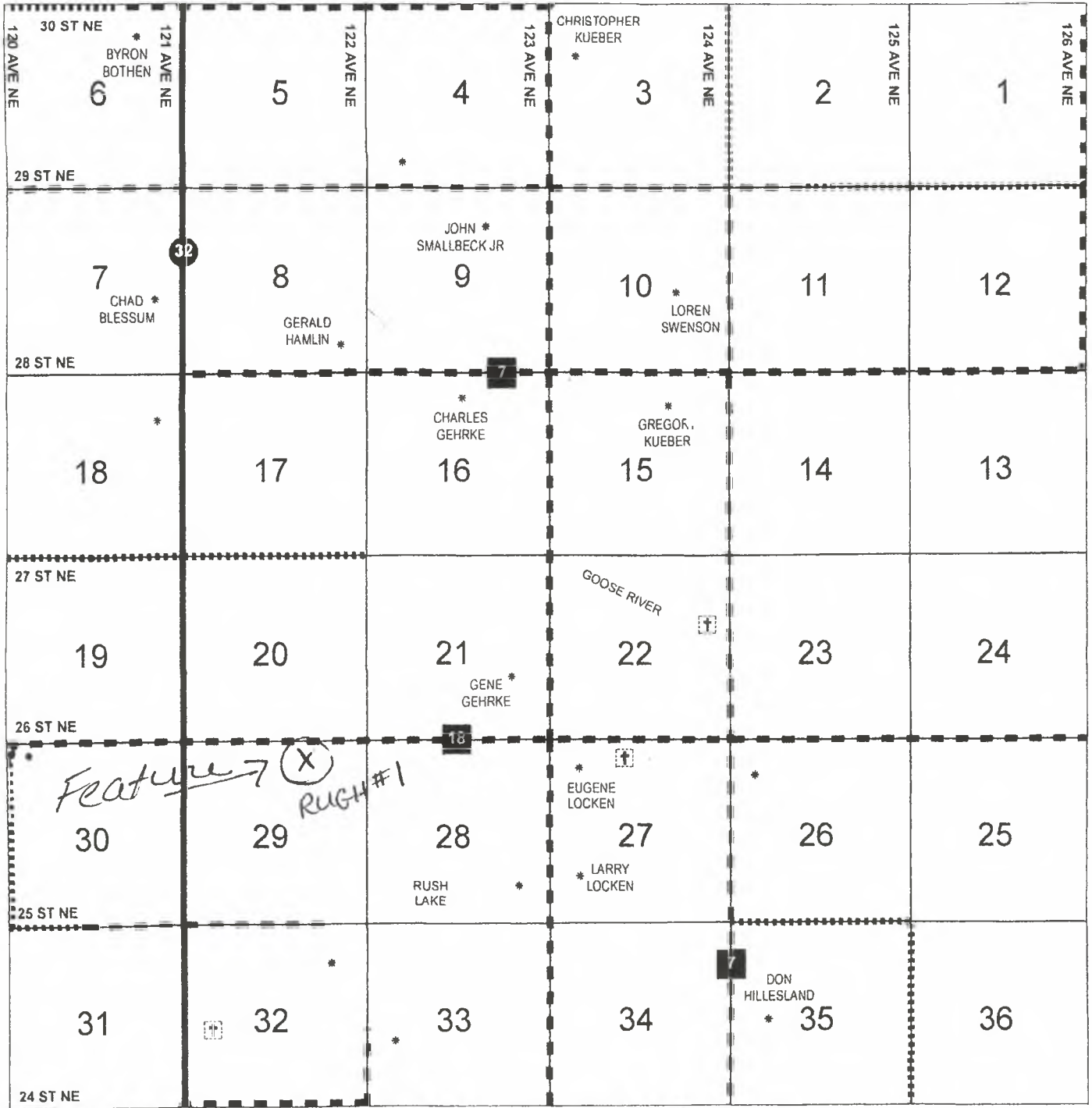

Rugh #1

10-24-2014 Kathy Wilner

	R-61-W	R-60-W	R-59-W	R-58-W	R-57-W	
N-151-N	AD	AH	BA	AE		
N-150-N	AM	AY	AQ	AS		
N-149-N	AL	AG	BC	AR	AW	AX
N-148-N	AO	BB	AC	AP	AA	
N-147-N	AF	AV	AK	AI	AZ	
N-146-N	AJ	AB	AT	AN	AU	