

# NDCRS ARCHITECTURAL SITE FORM

## PAGE 1

Field Code \_\_\_\_\_

SITS# 32 PB 229

### SITE IDENTIFICATION

Map Quad Hanks Corner Site Name Lamoure Township Grey School #99  
Map Quad \_\_\_\_\_ Site Name \_\_\_\_\_

LTL	TWP	<u>162</u>	R	<u>56</u>	SEC	<u>30</u>	QQQ	<u>6</u>	QQ	<u>6</u>	Q	<u>5</u>
LTL	TWP	_____	R	_____	SEC	_____	QQQ	_____	QQ	_____	Q	_____
LTL	TWP	_____	R	_____	SEC	_____	QQQ	_____	QQ	_____	Q	_____
LTL	TWP	_____	R	_____	SEC	_____	QQQ	_____	QQ	_____	Q	_____

UTM 578702 N ZONE 14N  
UTM 5408731 E NAD 1927 \_\_\_\_\_ NAD 1983

Subsection:
1 = N½
2 = E½
3 = S½
4 = W½
5 = NE¼
6 = SE¼
7 = SW¼
8 = NW¼

City: \_\_\_\_\_

Street Number: \_\_\_\_\_

Street Name: Highway 32

Urban Legal Description: \_\_\_\_\_

### SITE DATA

Total # **Architectural** Features: 1

Fieldwork Date: 9/21/2012

Reconnaissance Survey  Intensive Survey \_\_\_\_\_

Project Title & Supervisor: \_\_\_\_\_

Report Title & Author(s): \_\_\_\_\_

Additional Information: \_\_\_\_\_

### SHSND USE

Area of Significance <u>2</u>	Ecozone <u>16</u>	Verified Site <u>1</u>	CR Type <u>2</u>
Area of Significance _____	Ecozone _____	Non-Site _____	
Area of Significance _____	Ecozone _____		

Recorded By Lorna Meidinger Date Recorded 10/9/2012  
(First Name & Last Name) (mm/dd/year)

Instructions to complete a digital version of this form: (1) Download a copy to your hard drive; (2) Open the saved blank copy; (3) Fill out the form; (4) Use the Save As command to rename the form appropriately and save; (5) Print and submit to SHSND.

**NDCRS ARCHITECTURAL SITE FORM  
PAGE 2—Feature Data**

Field Code \_\_\_\_\_ SITS# 32 PB \_\_\_\_\_  
 Complete one Page 2 for each architectural feature at the site.

Architectural Feature # 1

Construction Date \_\_\_\_\_ Feature Type 9 Condition 6  
 Feature Date 4 Context 7 Plan Shape 5  
 Structural System 25 Primary Exterior 26 Style Hipped Roof Box  
 Original Owner's Ethnicity \_\_\_\_\_ Secondary Exterior \_\_\_\_\_ Architect/Builder \_\_\_\_\_

Other Information:

Foundation concrete Stories 1  
 Window original, some boarded  
 Roof/Cornice hip  
 Dating Method(s): professional estimate

**Feature Preservation Recommendation(s) (Check all that apply):**

- Individual nomination
- Contributes to a potential district
- No nomination potential
- Will not contribute to a district
- Potential district—feature would be a contributing element if other properties constitute a district
- Thematic nomination potential
- Component of a historic site or landscape
- Moved (specify all applicable choices)—a) relocation occurred within a historic period; b) recreates original site, orientation, landscape, & spatial relationships; c) compatible in context with neighboring structures; d) relocation has damaged eligibility
- Historical associations require further investigation

Recorded By Lorna Meidinger Date Recorded 10/9/2012  
 (First Name & Last Name) (mm/dd/year)

*Instructions to complete a digital version of this form: (1) Download a copy to your hard drive; (2) Open the saved blank copy; (3) Fill out the form; (4) Use the Save As command to rename the form appropriately and save; (5) Print and submit to SHSND.*

**NDCRS ARCHITECTURAL SITE FORM**  
**PAGE 3—Feature Data**

Field Code \_\_\_\_\_ SITS# 32 PB \_\_\_\_\_

**1. Feature Description, Integrity, Eligibility:**

Grey School 99 has wood shingles on a hip roof with metal ridges and two metal vent pipes from the peak. A blond brick chimney is just southeast of the peak. The eaves have exposed rafter tails. The hip roof over the south entrance is the same materials and style. The siding is narrow lap siding above a painted concrete basement. The east wall has three 3:1 windows on the main level and one window to the basement. The north wall has one 3:1 window near the east corner of the main level and a central 2:2 window to the basement. The west wall has a band of five windows with the three north windows 3:1 and the other two covered. The basement has two two lite windows. The south end has the entrance centered and is an enclosed entrance with a three lite window on the east above a two lite window to the basement and the door has a three lite window above three wood panels. The concrete steps up to the entrance have six steps and then it takes another step to enter the door. The steps have concrete sidewalls. The main body of the south has a 3:1 window on the east of the entrance above a small three lite window in the basement. West of the entrance, the basement has a two lite window. A concrete walk leads to the school from a white picket fence. Trees line the west and north sides of the school. East of the school, facing the highway is a sign that reads "Lamoure Township Grey School 99" in front of a flagpole.

Recorded By Lorna Meidinger Date Recorded 10/9/2012  
(First Name & Last Name) (mm/dd/year)

*Instructions to complete a digital version of this form:* (1) Download a copy to your hard drive; (2) Open the saved blank copy; (3) Fill out the form; (4) Use the Save As command to rename the form appropriately and save; (5) *Print* and submit to SHSND.

### NDCRS ARCHITECTURAL SITE FORM PAGE 4—SITE DESCRIPTION

Field Code \_\_\_\_\_

SITS# 32 PB \_\_\_\_\_

Complete one Page 4 for the entire site.

2. Owner's Contact Information:

3. Access (to rural areas):

From the Pembina River, go south along Highway 32 for approximately six miles. The school is on the west side of the highway.

4. Site Area (ft<sup>2</sup>): \_\_\_\_\_

5. Site Description:

A power station is to the south of the school and the rest of the surrounding area is cultivated fields.

Recorded By Lorna Meidinger  
(First Name & Last Name)

Date Recorded 10/9/2012  
(mm/dd/year)

*Instructions to complete a digital version of this form:* (1) Download a copy to your hard drive; (2) Open the saved blank copy; (3) Fill out the form; (4) Use the Save As command to rename the form appropriately and save; (5) *Print* and submit to SHSND.

**NDCRS ARCHITECTURAL SITE FORM  
PAGE 5—SITE DESCRIPTION**

Field Code \_\_\_\_\_ SITS# 32 PB \_\_\_\_\_

**6. Summary of All Site Features & Evaluation of Site Significance:**

The school has a high level of integrity for the building. The trees, sign, and flagpole appear much younger than the building. Some research should be done as to whether the building was ever moved but the context of its current surroundings are compatible with a historic school location.

**7. References/Comments:**Recorded By Lorna Meidinger Date Recorded 10/9/2012  
(First Name & Last Name) (mm/dd/year)

*Instructions to complete a digital version of this form:* (1) Download a copy to your hard drive; (2) Open the saved blank copy; (3) Fill out the form; (4) Use the Save As command to rename the form appropriately and save; (5) *Print* and submit to SHSND.

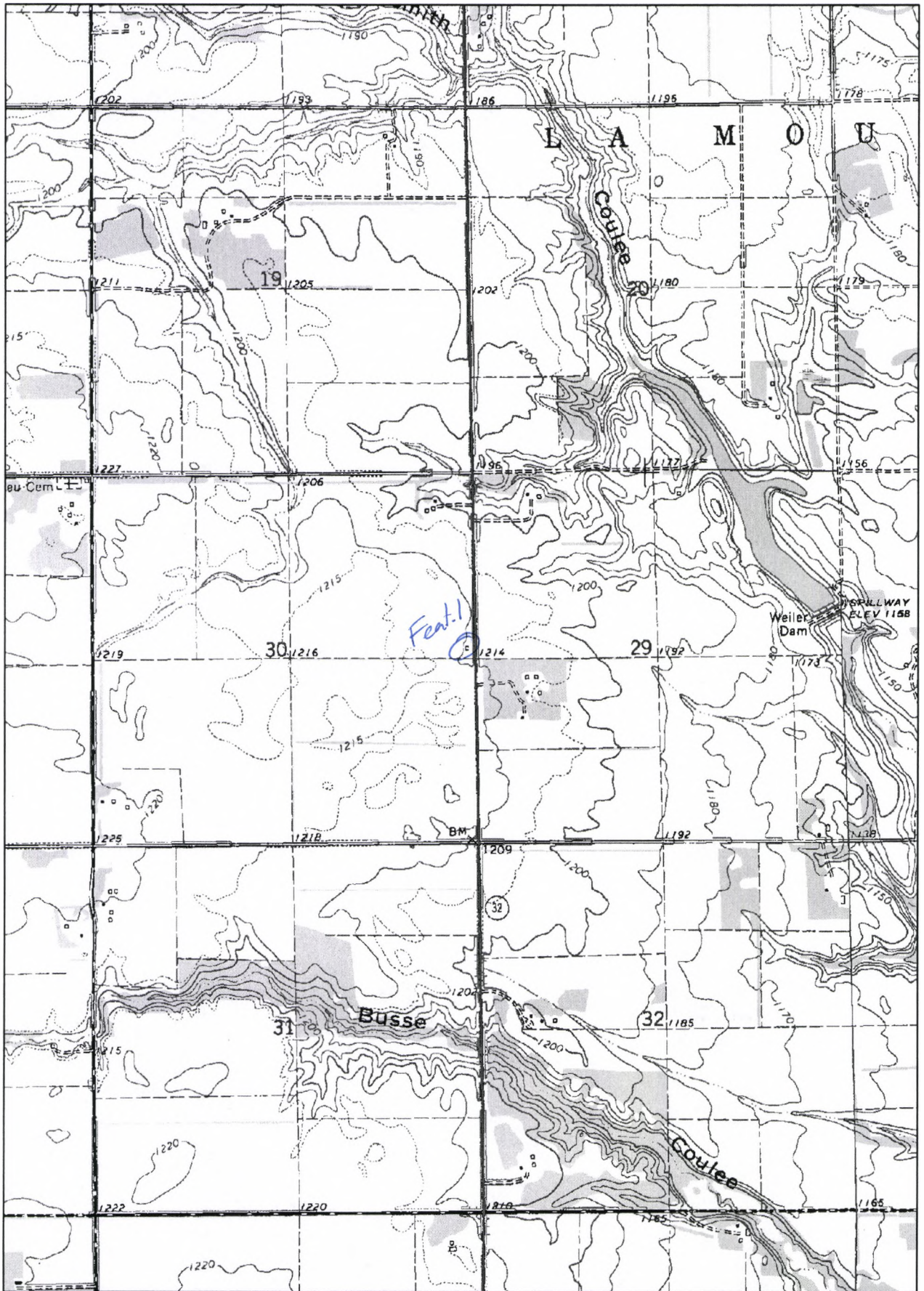



16205619

16205620

Pembina

Feat 1

16205630

16205625

16205631

16205632

### NDCRS SITE FORM ATTACHMENTS SECTION

Field Code

SITS# 32 PB

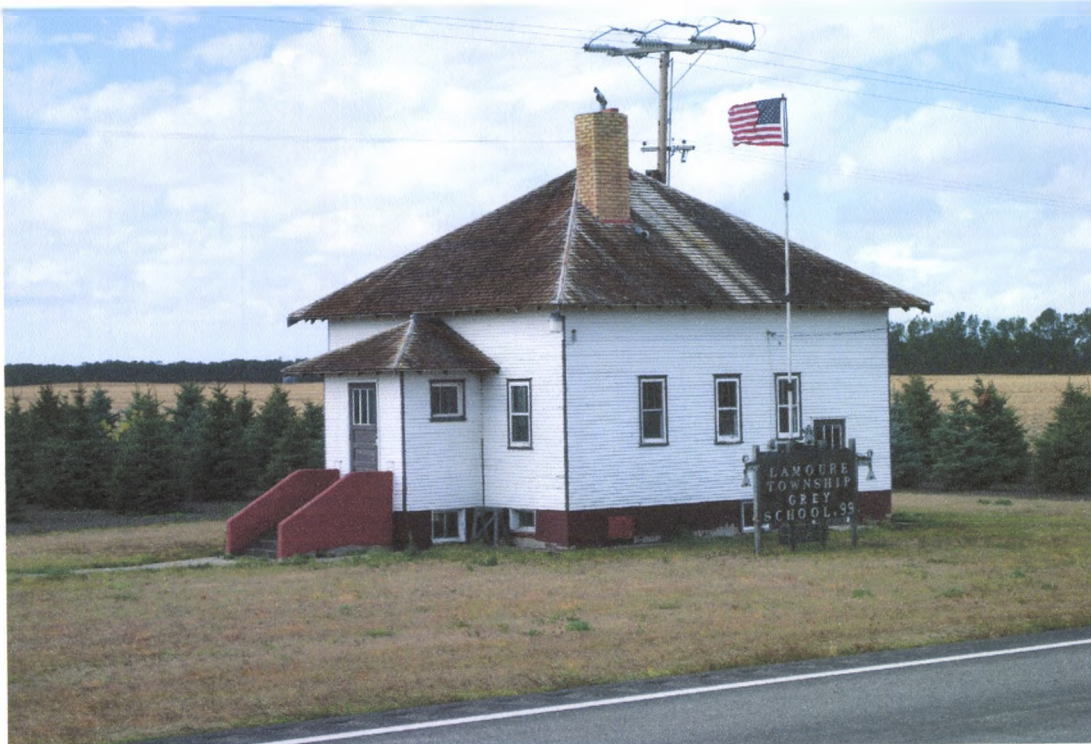

southeast



south

Recorded By Lorna Meidinger  
(First Name & Last Name)

Date Recorded

10/9/2012  
(mm/dd/year)





southwest



north

**Recorded By** Lorna Meidinger  
(First Name & Last Name)

**Date Recorded**

10/9/2012  
(mm/dd/year)