

NDCRS ARCHITECTURAL SITE FORM
PAGE 1

SITS# 32 PB 246

SITE IDENTIFICATION

Field Code Backoo School Site Name
Map Quad Backoo Site Name

Map Quad
Map Quad

LTL TWP 162 R 55 SEC 26 QQQ 5 QQ 6 Q 5
LTL TWP R SEC QQQ QQ Q
LTL TWP R SEC QQQ QQ Q
LTL TWP R SEC QQQ QQ Q

UTM N ZONE
UTM E NAD 1927 NAD 1983

Subsection:
1 = N 1/2
2 = E 1/2
3 = S 1/2
4 = W 1/2
5 = NE 1/4
6 = SE 1/4
7 = SW 1/4
8 = NW 1/4

City: Backoo

Street Number: 9777

Street Name: Co Rd 12

Urban Legal Description:

SITE DATA

Total # Architectural Features: 1

Fieldwork Date: 9/19/2016

Reconnaissance Survey [checked] Intensive Survey

Project Title & Supervisor:
Country Schoolhouse Project

Report Title & Author(s):

Additional Information:

SHSND USE

Area of Significance 2 Ecozone 16 Verified Site 1 CR Type 2
Area of Significance Ecozone Non-Site
Area of Significance

Recorded By Kathy Wilner Date Recorded 2/18/2017
(First Name & Last Name) (mm/dd/year)

Instructions to complete a digital version of this form: (1) Download a copy to your hard drive; (2) Open the saved blank copy; (3) Fill out the form; (4) Use the Save As command to rename the form appropriately and save; (5) Print and submit to SHSND.

NDCRS ARCHITECTURAL SITE FORM PAGE 2—Feature Data

Field Code Backoo School

SITS# 32 PB

Complete one Page 2 for each architectural feature at the site.

Architectural Feature # 1

Construction Date _____

Feature Type 9

Condition 4

Feature Date 2

Context 7

Plan Shape 5

Structural System 25

Primary Exterior 26

Style Other Style

Original Owner's Ethnicity _____

Secondary Exterior _____

Architect/Builder _____

Other Information:

Foundation Concrete basement Stories 1

Roof/Cornice Hip

Window Double hung openings, some glass and framing

Dating Method(s): Estimate

Feature Preservation Recommendation(s) (Check all that apply):

- Individual nomination
- Contributes to a potential district
- No nomination potential
- Will not contribute to a district
- Potential district—feature would be a contributing element if other properties constitute a district
- Thematic nomination potential
- Component of a historic site or landscape
- Moved (specify all applicable choices)—a) relocation occurred within a historic period; b) recreates original site, orientation, landscape, & spatial relationships; c) compatible in context with neighboring structures; d) relocation has damaged eligibility
- Historical associations require further investigation

Recorded By Kathy Wilner Date Recorded 2/18/2017
(First Name & Last Name) (mm/dd/year)

Instructions to complete a digital version of this form: (1) Download a copy to your hard drive; (2) Open the saved blank copy; (3) Fill out the form; (4) Use the Save As command to rename the form appropriately and save; (5) Print and submit to SHSND.

**NDCRS ARCHITECTURAL SITE FORM
PAGE 3—Feature Data**Field Code Backoo SchoolSITS# 32 PB**Complete a Page 3 for each feature.****1. Feature Description, Integrity, Eligibility:**

The feature is a one room prairie school on a poured concrete basement. The hip roof of the main body and half hip of the entry are covered with a mixture of wood shakes and asphalt shingles. The asphalt shingles can be seen on the west slope of the roof where a large yellow brick chimney is located. Just off the edge of the roof, along the west wall, there is another chimney and this one is concrete block. There is also a fuel tank along that wall. The roof is falling away in many places. The soffits were closed with beadboard. There is a bell tower on the east slope of the entry roof, it has a wood base with lap siding and four corner posts holding up a pyramidal roof with no shingles. The building measures 34 feet east to west and 26 feet north to south with the entry measuring 8 feet by 10 feet.

There is a wide trim board located under the soffits on all side of the school. The remainder of the siding is 6 inch wood lap with 6 inch corner trim with waterboard and skirting board at the bottom. There are various sizes of windows beginning with 5 large, dougle hung windows on the north wall. Some of them have a bit of framing with some glass and others none and yet another covered. There is a small four pane fixed glass window near the east end of the north wall, located in what I believe to be a bathroom as vents are on the roof at those window locations. A similar window is covered on the south side. An opening on the west wall may have been a window. At the southwest corner on the south wall is a 5 panel wood door reached by three small concrete steps. At the east entry a 3 panel wood door, with a broken glass window at the top, is reached up several concrete steps. The entry floor is falling in and the walls are beadboard. There are double hung, covered windows either side of the door which are located in the coat room. The interior of the school walls and ceiling were covered with lather and plaster, much of that is falling in. The floor is tongue and groove hardwood. There is a blackboard on the south wall. Light fixtures suggest electricity.

Recorded By Kathy Wilner Date Recorded 2/18/2017
(First Name & Last Name) (mm/dd/year)

Instructions to complete a digital version of this form: (1) Download a copy to your hard drive; (2) Open the saved blank copy; (3) Fill out the form; (4) Use the Save As command to rename the form appropriately and save; (5) Print and submit to SHSND.

**NDCRS ARCHITECTURAL SITE FORM
PAGE 4—SITE DESCRIPTION**

Field Code Backoo School

SITS# 32 PB

Complete one Page 4 for the entire site.

2. Owner's Contact Information:

3. Access (to rural areas):

Backoo is a spot on the road but it is marked on maps. It is on 137th Ave NE 1/4 mile south of 98th St NE.

4. Site Area (ft²): _____

5. Description of **SETTING**:

The school is sitting in a heavily treed location with trees all directions.

Recorded By Kathy Wilner Date Recorded 2/18/2017
(First Name & Last Name) (mm/dd/year)

Instructions to complete a digital version of this form: (1) Download a copy to your hard drive; (2) Open the saved blank copy; (3) Fill out the form; (4) Use the Save As command to rename the form appropriately and save; (5) Print and submit to SHSND.

**NDCRS ARCHITECTURAL SITE FORM
PAGE 5—SITE DESCRIPTION**

Field Code Backoo School

SITS# 32 PB

6. Summary of ALL Site Features & Evaluation of Significance:

7. References/Comments:

Kathy Wilner
366 43rd Ave SE
Bowdon ND 58418

Recorded By Kathy Wilner Date Recorded 2/18/2017
(First Name & Last Name) (mm/dd/year)

Instructions to complete a digital version of this form: (1) Download a copy to your hard drive; (2) Open the saved blank copy; (3) Fill out the form; (4) Use the Save As command to rename the form appropriately and save; (5) Print and submit to SHSND.



North Side

Backoo Schoo

9/19/2016

Kathy Wilner

PB

East Side





South Side

Backoo School

9/19/2016

Kathy Wilner

PB

West Side



bing maps

Notes

Backoo School

9/19/2016

Kathy Wilner

9/19/2016

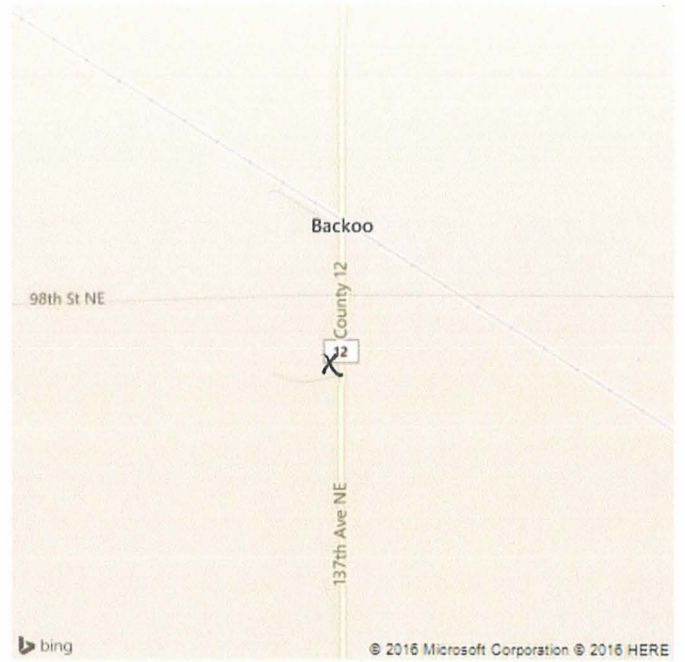

Feature