

NDCRS ARCHITECTURAL SITE FORM

PAGE 1

Field Code _____

SITS# 32 RI 881

SITE IDENTIFICATION

Map Quad Wyndmere Site Name Danton School #1

Map Quad _____ Site Name _____

LTL ___ TWP 132 R 51 SEC 7 QQQ 8 QQ 5 Q 8

LTL ___ TWP _____ R _____ SEC _____ QQQ _____ QQ _____ Q _____

LTL ___ TWP _____ R _____ SEC _____ QQQ _____ QQ _____ Q _____

LTL ___ TWP _____ R _____ SEC _____ QQQ _____ QQ _____ Q _____

NAD 1983, UTM 5125405 N ZONE 14N

NAD 1983, UTM 644128 E

Subsection:
1 = N½
2 = E½
3 = S½
4 = W½
5 = NE¼
6 = SE¼
7 = SW¼
8 = NW¼

City: Wyndmere

Street Number: 300

Street Name: Ash Ave

Urban Legal Description: _____

SITE DATA

Total # Architectural Features: 1

Fieldwork Date: 4/8/2014

Reconnaissance Survey Intensive Survey

Project & Principal Investigator:

Report Title & Author(s):

Contracting firm or Agency completing the form:

SHSND

Additional Information:

moved to 300 Ash Ave in Wyndmere either late 2014 or early 2015, formerly 32RI876. verified by Brad Abel and aerial photographs dated 8/2015

SHSND USE

Area of Significance 2 Ecozone 14 Verified Site 1 CR Type 2

Area of Significance _____ Ecozone _____

Area of Significance _____ Ecozone _____

Recorded By Lorna Meidinger Date Recorded 04/08/2016

(First Name & Last Name)

(mm/dd/year)

Instructions to complete a digital version of this form: (1) Download a copy; (2) Open the saved blank copy; (3) Fill out the form; (4) Use the Save As command to rename the form appropriately, and save; (5) **Print** and submit to SHSND.

NDCRS SITE FORM ATTACHMENTS SECTION

Field Code LM-RI876-16

SITS# 32 RI

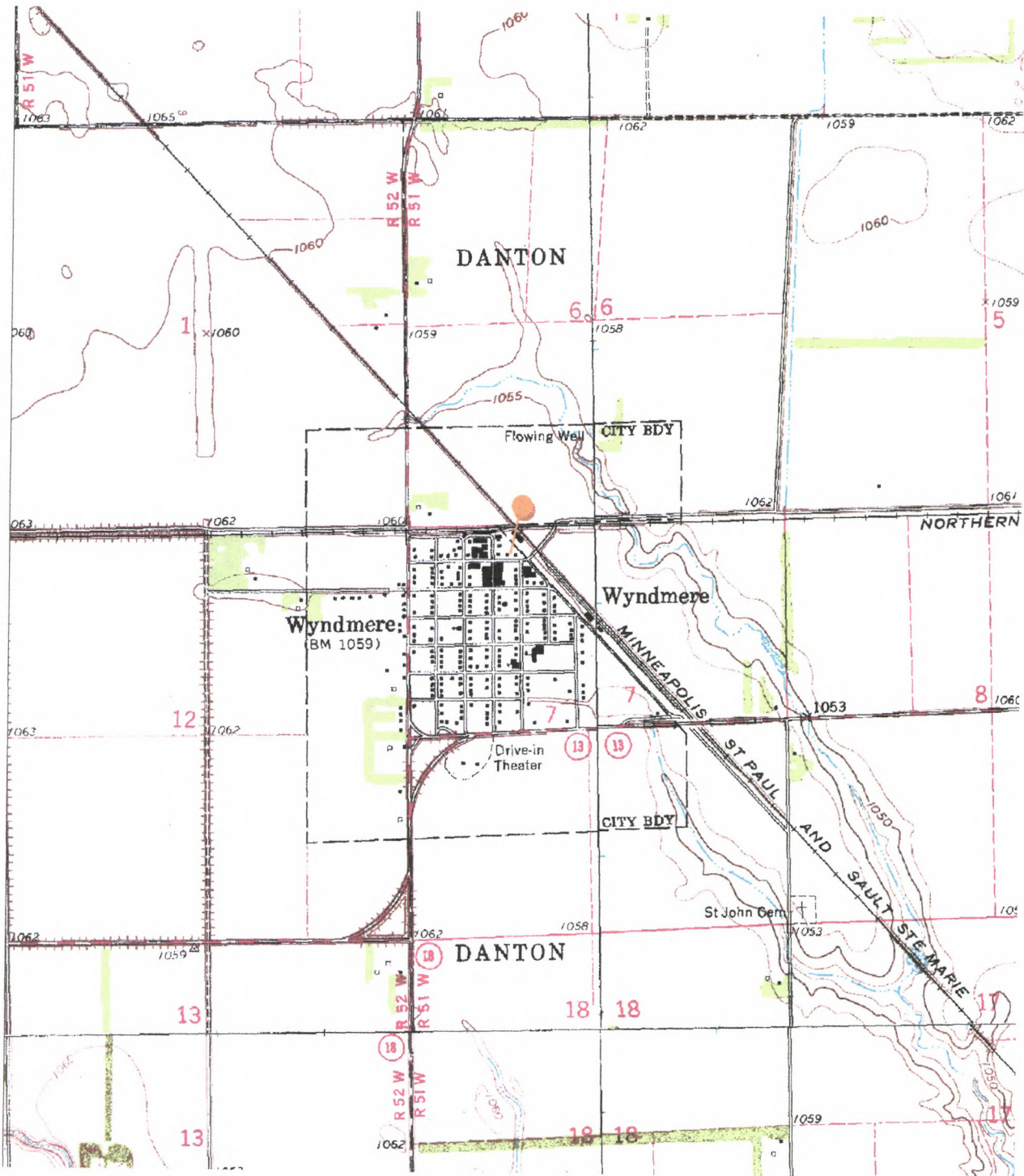

Recorded By Lorna Meidinger
(First Name & Last Name)

Date Recorded

4/8/2016
(mm/dd/year)

*Instructions to complete a digital version of this form: (1) Download a copy; (2) Open the saved blank copy; (3) Fill out the form; (4) Use the Save As command to rename the form appropriately, and save; (5) **Print** and submit to SHSND.*

NDCRS ARCHITECTURAL SITE FORM PAGE 1

Field Code _____

SITS# 32 RI 876

SITE IDENTIFICATION

Map Quad Wyndmere SE Site Name Danton School #1

Map Quad _____ Site Name _____

LTL ___ TWP 132 R 51 SEC 11 QQQ 5 QQ 5 Q 6

LTL ___ TWP _____ R _____ SEC _____ QQQ _____ QQ _____ Q _____

LTL ___ TWP _____ R _____ SEC _____ QQQ _____ QQ _____ Q _____

LTL ___ TWP _____ R _____ SEC _____ QQQ _____ QQ _____ Q _____

UTM 5124935 N

ZONE 14N

UTM 651680 E

NAD 1927 ___ NAD 1983

City: _____

Street Number: _____

Street Name: 161 Ave SE and Hwy 13

Urban Legal Description: _____

Subsection:
1 = N $\frac{1}{2}$
2 = E $\frac{1}{2}$
3 = S $\frac{1}{2}$
4 = W $\frac{1}{2}$
5 = NE $\frac{1}{4}$
6 = SE $\frac{1}{4}$
7 = SW $\frac{1}{4}$
8 = NW $\frac{1}{4}$

SITE DATA

Total # Architectural Features: 1

Fieldwork Date: 8/28/2013

Reconnaissance Survey Intensive Survey

Project Title & Supervisor: _____

Report Title & Author(s): _____

Additional Information: _____

SHSND USE

Area of Significance 2 Ecozone 14 Verified Site 1 CR Type 2

Area of Significance _____ Ecozone _____ Non-Site _____

Area of Significance _____ Ecozone _____

Recorded By Lorna Meidinger Date Recorded 10/15/2013
(First Name & Last Name) (mm/dd/year)

Instructions to complete a digital version of this form: (1) Download a copy to your hard drive; (2) Open the saved blank copy; (3) Fill out the form; (4) Use the Save As command to rename the form appropriately and save; (5) Print and submit to SHSND.

NDCRS ARCHITECTURAL SITE FORM
PAGE 2—Feature Data

Field Code _____ SITS# 32 RI _____
Complete one Page 2 for each architectural feature at the site.

Architectural Feature # 1

Construction Date 1889 Feature Type 9 Condition 6
Feature Date 2 Context 7 Plan Shape 5
Structural System 25 Primary Exterior 26 Style Other Style
Original Owner's Ethnicity _____ Secondary Exterior _____ Architect/Builder _____

Other Information:

Foundation concrete Stories 1

Window openings appear original, glass likely replaced

Roof/Cornice hip

Dating Method(s): local lady on committee of the school

Feature Preservation Recommendation(s) (Check all that apply):

- Individual nomination
Contributes to a potential district
No nomination potential
Will not contribute to a district
Potential district—feature would be a contributing element if other properties constitute a district
Thematic nomination potential
Component of a historic site or landscape
Moved (specify all applicable choices)—a) relocation occurred within a historic period; b) recreates original site, orientation, landscape, & spatial relationships; c) compatible in context with neighboring structures; d) relocation has damaged eligibility
Historical associations require further investigation

Recorded By Lorna Meidinger Date Recorded 10/15/2013
(First Name & Last Name) (mm/dd/year)

Instructions to complete a digital version of this form: (1) Download a copy to your hard drive; (2) Open the saved blank copy; (3) Fill out the form; (4) Use the Save As command to rename the form appropriately and save; (5) Print and submit to SHSND.

NDCRS ARCHITECTURAL SITE FORM
PAGE 3—Feature Data

Field Code _____ SITS# 32 RI _____

1. Feature Description, Integrity, Eligibility:

The school has a full basement that houses metal vents and has wood support poles under a beam on a cracked concrete floor. A three-lite window to the basement is visible on the west side of the school and the interior photo shows two six-lite windows that have been covered, one on the north wall at the west end and one on the west end near the center. On the east end, front, there is a five-panel wood door at ground level that opens to a half flight of stairs to the basement. Stairs also lead up into the classroom. A second door is a modern flush steel door and has concrete steps (with a metal pipe rail) outside the entrance so the door opens directly onto the main floor. Above this door is a single pane transom and a 1:1 window is on each side. A hipped dormer has vertical siding covering it and there is no longer an opening. The north side has a band of six 1:1 windows that begins at the west end and runs the length of the interior classroom. The west end has two shed-roofed additions that housed the toilets. The south side has one 1:1 window near the east end. All of the roofs have the same asphalt shingles covering them.

The Danton School #1 was moved a couple miles west of its original location to where it sits now around 1900. The building operated as a school until 1960 and then housed meetings until around 2000. While the building is eligible for the National Register of Historic Places now, a committee has formed and there are plans to move the school in the next year or so to Gateway Park in Wyndmere. The setting would be completely changed and remove eligibility.

Recorded By Lorna Meidinger Date Recorded 10/15/2013
 (First Name & Last Name) (mm/dd/year)

Instructions to complete a digital version of this form: (1) Download a copy to your hard drive; (2) Open the saved blank copy; (3) Fill out the form; (4) Use the Save As command to rename the form appropriately and save; (5) *Print* and submit to SHSND.

**NDCRS ARCHITECTURAL SITE FORM
PAGE 4—SITE DESCRIPTION**

Field Code _____

SITS# 32 RI _____

Complete one Page 4 for the entire site.

2. Owner's Contact Information:

3. Access (to rural areas):

From Wyndmere, go east along Hwy 13 approximately five miles to 161 Ave SE. The school is on the southwest corner of this intersection.

4. Site Area (ft²): _____

5. *Site* Description:

The school is surrounded mostly by cultivated fields but there are a couple farmstead in the vicinity with tree rows visible in the background of the school to the east and west. A couple trees are on the property just south of the school.

Recorded By Lorna Meidinger
(First Name & Last Name)

Date Recorded 10/15/2013
(mm/dd/year)

Instructions to complete a digital version of this form: (1) Download a copy to your hard drive; (2) Open the saved blank copy; (3) Fill out the form; (4) Use the Save As command to rename the form appropriately and save; (5) *Print* and submit to SHSND.

**NDCRS ARCHITECTURAL SITE FORM
PAGE 5—SITE DESCRIPTION**

Field Code _____ SITS# 32 RI _____

6. Summary of All Site Features & Evaluation of Site Significance:

While the school is in good shape and currently eligible, the current owner wants it removed. A local group has formed and plans to move the school into a city park in Wyndmere. The setting and orientation of the building will be changed and integrity lost with this move so that it will no longer be eligible for the National Register of Historic Places.

7. References/Comments:Recorded By Lorna Meidinger Date Recorded 10/15/2013
(First Name & Last Name) (mm/dd/year)

Instructions to complete a digital version of this form: (1) Download a copy to your hard drive; (2) Open the saved blank copy; (3) Fill out the form; (4) Use the Save As command to rename the form appropriately and save; (5) *Print* and submit to SHSND.

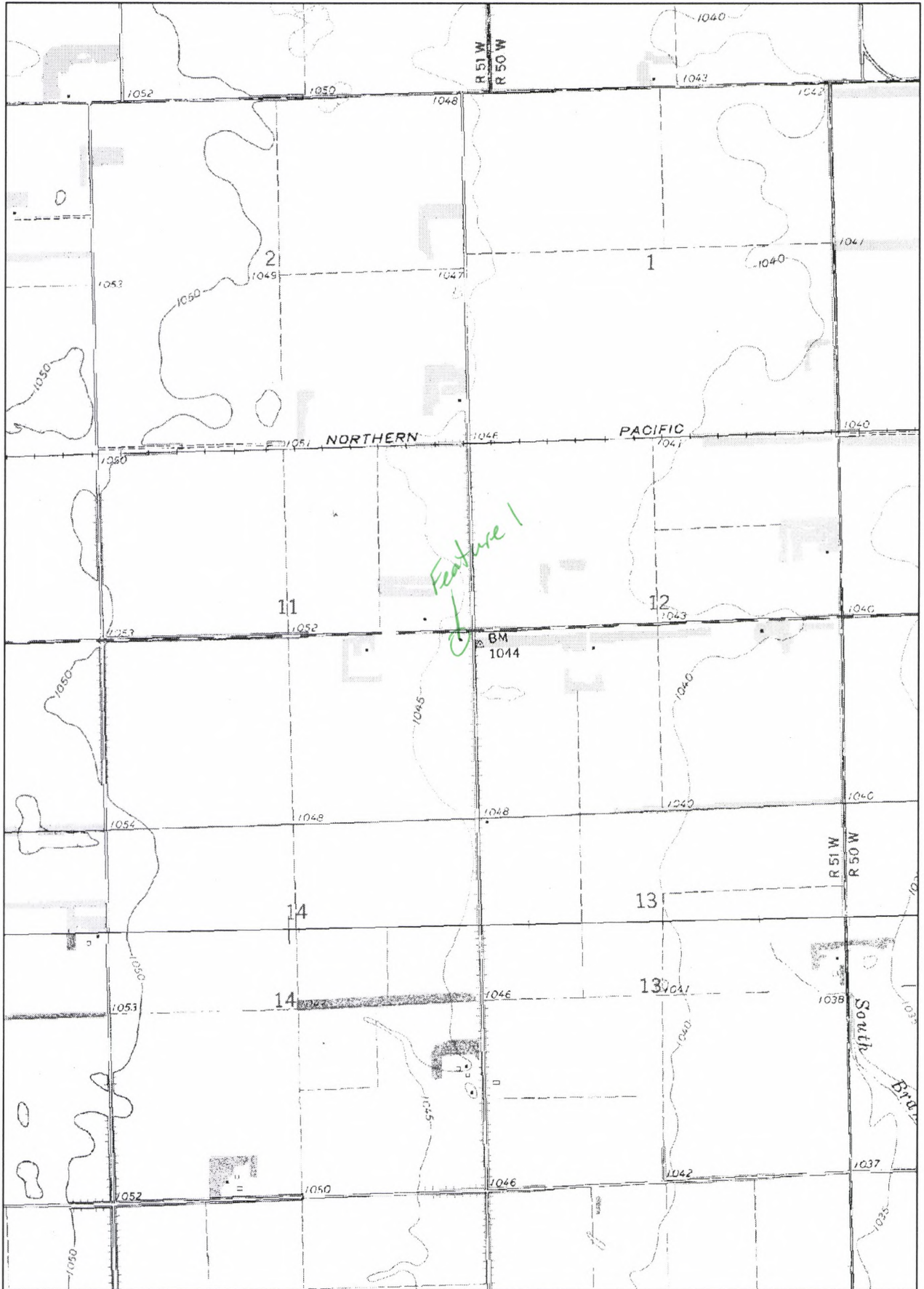

NDCRS SITE FORM ATTACHMENTS SECTION

Field Code

SITS# 32 RI



Danton School front, east

Recorded By Lorna Meidinger
(First Name & Last Name)

Date Recorded

10/15/2013
(mm/dd/year)



Danton School, *south*



Danton School, west

Recorded By Lorna Meidinger
(First Name & Last Name)

Date Recorded

10/15/2013
(mm/dd/year)



Danton School, *NE*



Danton School, *NE*

Recorded By Lorna Meidinger
(First Name & Last Name)

Date Recorded

10/15/2013
(mm/dd/year)



Danton School, interior NW



Danton School, interior SW

Recorded By Lorna Meidinger
(First Name & Last Name)

Date Recorded

10/15/2013
(mm/dd/year)



Danton School, interior east wall



Danton School, interior basement, west wall

Recorded By Lorna Meidinger
(First Name & Last Name)

Date Recorded

10/15/2013
(mm/dd/year)