

# NDCRS ARCHITECTURAL SITE FORM PAGE 1

SITS# 32 RI 895

### SITE IDENTIFICATION

Field Code Brightwood Township School Site Name \_\_\_\_\_

Map Quad Hankinson Site Name \_\_\_\_\_

Map Quad \_\_\_\_\_

LTL	TWP	<u>130</u>	R	<u>50</u>	SEC	<u>18</u>	QQQ	<u>6</u>	QQ	<u>6</u>	Q	<u>6</u>
LTL	TWP	_____	R	_____	SEC	_____	QQQ	_____	QQ	_____	Q	_____
LTL	TWP	_____	R	_____	SEC	_____	QQQ	_____	QQ	_____	Q	_____
LTL	TWP	_____	R	_____	SEC	_____	QQQ	_____	QQ	_____	Q	_____

UTM \_\_\_\_\_ N ZONE \_\_\_\_\_  
 UTM \_\_\_\_\_ E NAD 1927 \_\_\_\_\_ NAD 1983 \_\_\_\_\_

Subsection:
1 = N $\frac{1}{2}$
2 = E $\frac{1}{2}$
3 = S $\frac{1}{2}$
4 = W $\frac{1}{2}$
5 = NE $\frac{1}{4}$
6 = SE $\frac{1}{4}$
7 = SW $\frac{1}{4}$
8 = NW $\frac{1}{4}$

City: Hankinson

Street Number: \_\_\_\_\_

Street Name: 93rd St SE

Urban Legal Description: \_\_\_\_\_

### SITE DATA

Total # **Architectural** Features: 1

Fieldwork Date: 5/4/2016

Reconnaissance Survey  Intensive Survey

Project Title & Supervisor:  
Country Schoolhouse Project

Report Title & Author(s):

Additional Information: \_\_\_\_\_

### SHSND USE

Area of Significance <u>2</u>	Ecozone <u>H</u>	Verified Site <u>1</u>	CR Type <u>2</u>
Area of Significance _____	Ecozone _____	Non-Site _____	
Area of Significance _____			

Recorded By Kathy Wilner Date Recorded 1/11/2017  
 (First Name & Last Name) (mm/dd/year)

*Instructions to complete a digital version of this form: (1) Download a copy to your hard drive; (2) Open the saved blank copy; (3) Fill out the form; (4) Use the Save As command to rename the form appropriately and save; (5) Print and submit to SHSND.*

**NDCRS ARCHITECTURAL SITE FORM  
PAGE 2—Feature Data**

Field Code Brightwood Township School

SITS# 32 RI

**Complete one Page 2 for each architectural feature at the site.**

**Architectural Feature #** 1

Construction Date \_\_\_\_\_

Feature Type 9

Condition 5

Feature Date 2

Context 7

Plan Shape 5

Structural System 25

Primary Exterior 5

Style Hipped Roof Box

Original Owner's Ethnicity \_\_\_\_\_

Secondary Exterior \_\_\_\_\_

Architect/Builder \_\_\_\_\_

Other Information:

Foundation Concrete block covered with stucco, basement Stories 1

Roof/Cornice Hip Roof

Window Double hung, no glass

Dating Method(s): Estimate

**Feature Preservation Recommendation(s) (Check all that apply):**

- Individual nomination
- Contributes to a potential district
- No nomination potential
- Will not contribute to a district
- Potential district—feature would be a contributing element if other properties constitute a district
- Thematic nomination potential
- Component of a historic site or landscape
- Moved (specify all applicable choices)—a) relocation occurred within a historic period; b) recreates original site, orientation, landscape, & spatial relationships; c) compatible in context with neighboring structures; d) relocation has damaged eligibility
- Historical associations require further investigation

Recorded By Kathy Wilner Date Recorded 1/11/2017  
(First Name & Last Name) (mm/dd/year)

*Instructions to complete a digital version of this form: (1) Download a copy to your hard drive; (2) Open the saved blank copy; (3) Fill out the form; (4) Use the Save As command to rename the form appropriately and save; (5) Print and submit to SHSND.*

**NDCRS ARCHITECTURAL SITE FORM**  
**PAGE 3—Feature Data**

Field Code Brightwood Township SchoolSITS# 32 RI**Complete a Page 3 for each feature.****1. Feature Description, Integrity, Eligibility:**

The feature is a one room prairie school sitting on a concrete block basement. The blocks above ground are covered with stucco. The hip roof is covered with asphalt shingles in deteriorating condition. There is a large, red brick chimney with a pipe inside on the south slant of the roof. Soffits were closed but much of the beadboard is falling away. The oprn porch roof is gable with asphalt shingles. The building measures 224 feet north to south and 30 feet east to west. There is a small porch on the east side of the school, reached by several wooden steps with a pipe railing. This measures 6 1/2 feet side by 3 feet deep.

The siding is deteriorating 10 inch fiber board over narrow wood. Corner trim is gone or covered. The porch is finished with the same siding on the north and south sides. The entry door is 5 panel wood with a transom window above it. Inside the entry there are doors to either side giving access to the coat rooms as well as a door into the school room and there is a transom above this one as well. There are three windows on the south side towards the west end of the building, double hung with no glass and they appear to be replacments. There are more older windows inside the building, covered by siding. There is a door on the wouth side of the building that gives access to the basement stairway as well as into the school itself. The walls and the ceiling are lathe and plaster and some of it is falling away. The flooring is tongue and groove hardwood. There are blackboards on the north and west wall. Light fixtures and wires on the outside of the building give proof of electricity.

The basement is mostly emphy space with some old desks stored there. There is a small fuel door on the north wall and windows to the basement, some covered.

Recorded By Kathy Wilner Date Recorded 1/11/2017  
(First Name & Last Name) (mm/dd/year)

*Instructions to complete a digital version of this form:* (1) Download a copy to your hard drive; (2) Open the saved blank copy; (3) Fill out the form; (4) Use the Save As command to rename the form appropriately and save; (5) *Print* and submit to SHSND.

**NDCRS ARCHITECTURAL SITE FORM  
PAGE 4—SITE DESCRIPTION**

Field Code Brightwood Township School

SITS# 32 RI

**Complete one Page 4 for the entire site.**

2. Owner's Contact Information:

Brightwood Township

3. Access (to rural areas):

This school is located on Highway 11 4 miles west of Hankinson, it is on the north side of the highway.

4. Site Area (ft<sup>2</sup>): \_\_\_\_\_

5. Description of **SETTING**:

There are trees north and west, a farm to east as well as another farm to the west.

Recorded By Kathy Wilner Date Recorded 1/11/2017  
(First Name & Last Name) (mm/dd/year)

*Instructions to complete a digital version of this form: (1) Download a copy to your hard drive; (2) Open the saved blank copy; (3) Fill out the form; (4) Use the Save As command to rename the form appropriately and save; (5) Print and submit to SHSND.*

**NDCRS ARCHITECTURAL SITE FORM  
PAGE 5—SITE DESCRIPTION**

Field Code Brightwood Township School

SITS# 32 RI

**6. Summary of ALL Site Features & Evaluation of Significance:**

7. References/Comments:

Kathy Wilner  
366 43rd Ave SE  
Bowdon ND 58418

Recorded By Kathy Wilner Date Recorded 1/11/2017  
(First Name & Last Name) (mm/dd/year)

*Instructions to complete a digital version of this form: (1) Download a copy to your hard drive; (2) Open the saved blank copy; (3) Fill out the form; (4) Use the Save As command to rename the form appropriately and save; (5) Print and submit to SHSND.*





East Side

Brightwood Township School    5/4/2016    Kathy Wilner    RI

North Side







South Side

Brightwood Township School

5/4/2016

Kathy Wilner

RI

West Side





 bing maps

Notes

Brightwood Township School

5/4/2016

Kathy Wilner

RI

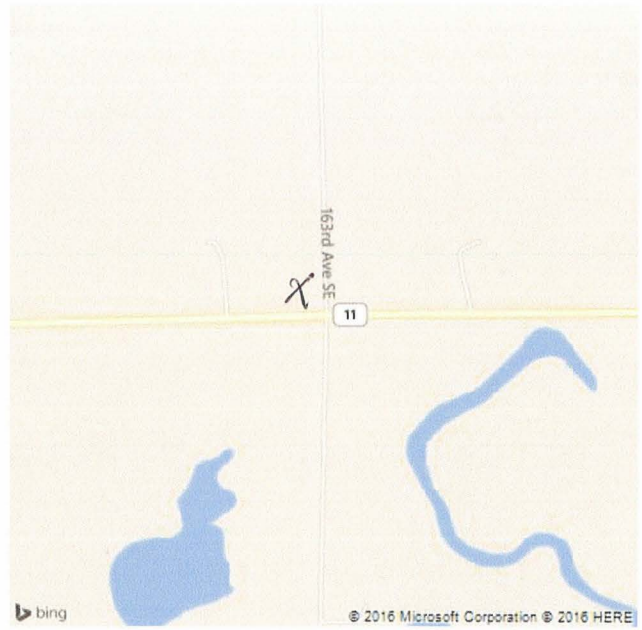

*Feature*