

NDCRS ARCHITECTURAL SITE FORM

PAGE 1

SITS# 32 SH 279

SITE IDENTIFICATION

Field Code Boone Township School #1

Site Name Boone Township School #1
Site Name _____

Map Quad Mertz Slough
Map Quad _____

LTL	TWP	<u>147</u>	R	<u>74</u>	SEC	<u>5</u>	QQQ	<u>6</u>	QQ	<u>6</u>	Q	<u>6</u>
LTL	TWP	_____	R	_____	SEC	_____	QQQ	_____	QQ	_____	Q	_____
LTL	TWP	_____	R	_____	SEC	_____	QQQ	_____	QQ	_____	Q	_____
LTL	TWP	_____	R	_____	SEC	_____	QQQ	_____	QQ	_____	Q	_____

UTM _____ N ZONE _____
UTM _____ E NAD 1927 _____ NAD 1983 _____

Subsection:
1 = N $\frac{1}{2}$
2 = E $\frac{1}{2}$
3 = S $\frac{1}{2}$
4 = W $\frac{1}{2}$
5 = NE $\frac{1}{4}$
6 = SE $\frac{1}{4}$
7 = SW $\frac{1}{4}$
8 = NW $\frac{1}{4}$

City: Goodrich ND

Street Number: Approx. 1101

Street Name: 20th Ave NE

Urban Legal Description: _____

SITE DATA

Total # **Architectural** Features: 1

Fieldwork Date: 5/22/2012

Reconnaissance Survey Intensive Survey

Project Title & Supervisor:
Country Schoolhouse Project

Report Title & Author(s):

Additional Information: _____

SHSND USE	<u>2</u>	Ecozone	<u>18</u>	Verified Site	_____	CR Type	<u>2</u>
Area of Significance	_____	Ecozone	_____	Non-Site	_____		
Area of Significance	_____						

Recorded By Kathy Wilner Date Recorded 11/15/2012
(First Name & Last Name) (mm/dd/year)

Instructions to complete a digital version of this form: (1) Download a copy to your hard drive; (2) Open the saved blank copy; (3) Fill out the form; (4) Use the Save As command to rename the form appropriately and save; (5) Print and submit to SHSND.

**NDCRS ARCHITECTURAL SITE FORM
PAGE 2—Feature Data**

Field Code Boone Township School #1

SITS# 32 SH

Complete one Page 2 for each architectural feature at the site.

Architectural Feature # 1

Construction Date _____	Feature Type <u>9</u>	Condition <u>3</u>
Feature Date <u>3</u>	Context <u>7</u>	Plan Shape <u>5</u>
Structural System <u>25</u>	Primary Exterior <u>26</u>	Style <u>Other Style</u>
Original Owner's Ethnicity _____	Secondary Exterior _____	Architect/Builder _____

Other Information:

Foundation Poured Concrete Stories 1

Roof/Cornice Hip

Window All covered

Dating Method(s): School Records

Feature Preservation Recommendation(s) (Check all that apply):

- Individual nomination
- Contributes to a potential district
- No nomination potential
- Will not contribute to a district
- Potential district—feature would be a contributing element if other properties constitute a district
- Thematic nomination potential
- Component of a historic site or landscape
- Moved (specify all applicable choices)—a) relocation occurred within a historic period; b) recreates original site, orientation, landscape, & spatial relationships; c) compatible in context with neighboring structures; d) relocation has damaged eligibility
- Historical associations require further investigation

Recorded By Kathy Wilner **Date Recorded** 11/15/2012
(First Name & Last Name) (mm/dd/year)

Instructions to complete a digital version of this form: (1) Download a copy to your hard drive; (2) Open the saved blank copy; (3) Fill out the form; (4) Use the Save As command to rename the form appropriately and save; (5) *Print* and submit to SHSND.

**NDCRS ARCHITECTURAL SITE FORM
PAGE 3—Feature Data**Field Code Boone Township School #1SITS# 32 SH**Complete a Page 3 for each feature.****1. Feature Description, Integrity, Eligibility:**

The feature is a one room prairie school sitting next to several bins. The school has shakes on the roof, siding is 6 inch lap with metal corner trim. The roof has metal roof cap on each angle of the hip roof. This school sits on a basement with some windows along the east side. All along each wall are anchors as they gutted the school and tied it together with large cable attached to these anchors. There is no floor and no ceiling. the entry porch fell away from the school as well. According to school records this school closed in 1950.

Recorded By Kathy Wilner Date Recorded 11/15/2012
(First Name & Last Name) (mm/dd/year)

Instructions to complete a digital version of this form: (1) Download a copy to your hard drive; (2) Open the saved blank copy; (3) Fill out the form; (4) Use the Save As command to rename the form appropriately and save; (5) *Print* and submit to SHSND.

**NDCRS ARCHITECTURAL SITE FORM
PAGE 4—SITE DESCRIPTION**

Field Code Boone Township School #1

SITS# 32 SH

Complete one Page 4 for the entire site.

2. Owner's Contact Information:

Gene Tessmann
1191 19th Ave NE
Goodrich ND 58444

3. Access (to rural areas):

Highway 200 north of Goodrich, go north on 20th Ave NE 6 miles. The school is no longer there, it was torn down.

4. Site Area (ft²): _____

5. Description of **SETTING**:

There is a farm yard to south and open, flat farm land all around.

Recorded By Kathy Wilner Date Recorded 11/15/2012
(First Name & Last Name) (mm/dd/year)

Instructions to complete a digital version of this form: (1) Download a copy to your hard drive; (2) Open the saved blank copy; (3) Fill out the form; (4) Use the Save As command to rename the form appropriately and save; (5) *Print* and submit to SHSND.

**NDCRS ARCHITECTURAL SITE FORM
PAGE 5—SITE DESCRIPTION**

Field Code Boone Township School #1

SITS# 32 SH

6. Summary of ALL Site Features & Evaluation of Significance:

7. References/Comments:

Kathy Wilner
366 43rd Ave SE
Bowdon ND 58418

Recorded By Kathy Wilner Date Recorded 11/15/2012
(First Name & Last Name) (mm/dd/year)

Instructions to complete a digital version of this form: (1) Download a copy to your hard drive; (2) Open the saved blank copy; (3) Fill out the form; (4) Use the Save As command to rename the form appropriately and save; (5) Print and submit to SHSND.



Boone Twsp. School #1 South Side 05/20/2012 Kathy Wilner SH

Boone Twsp. School #1 East Side 05/20/2012 Kathy Wilner SH





Boone Twsp. School #1 West Side 05/20/2012 Kathy Wilner SH



Boone Twsp. School #1 North Side 05/29/2012 Kathy Wilner SH

BOONE DIRECTORY

T-147-N

FAIRVIEW

CODE: AB

R-74-W

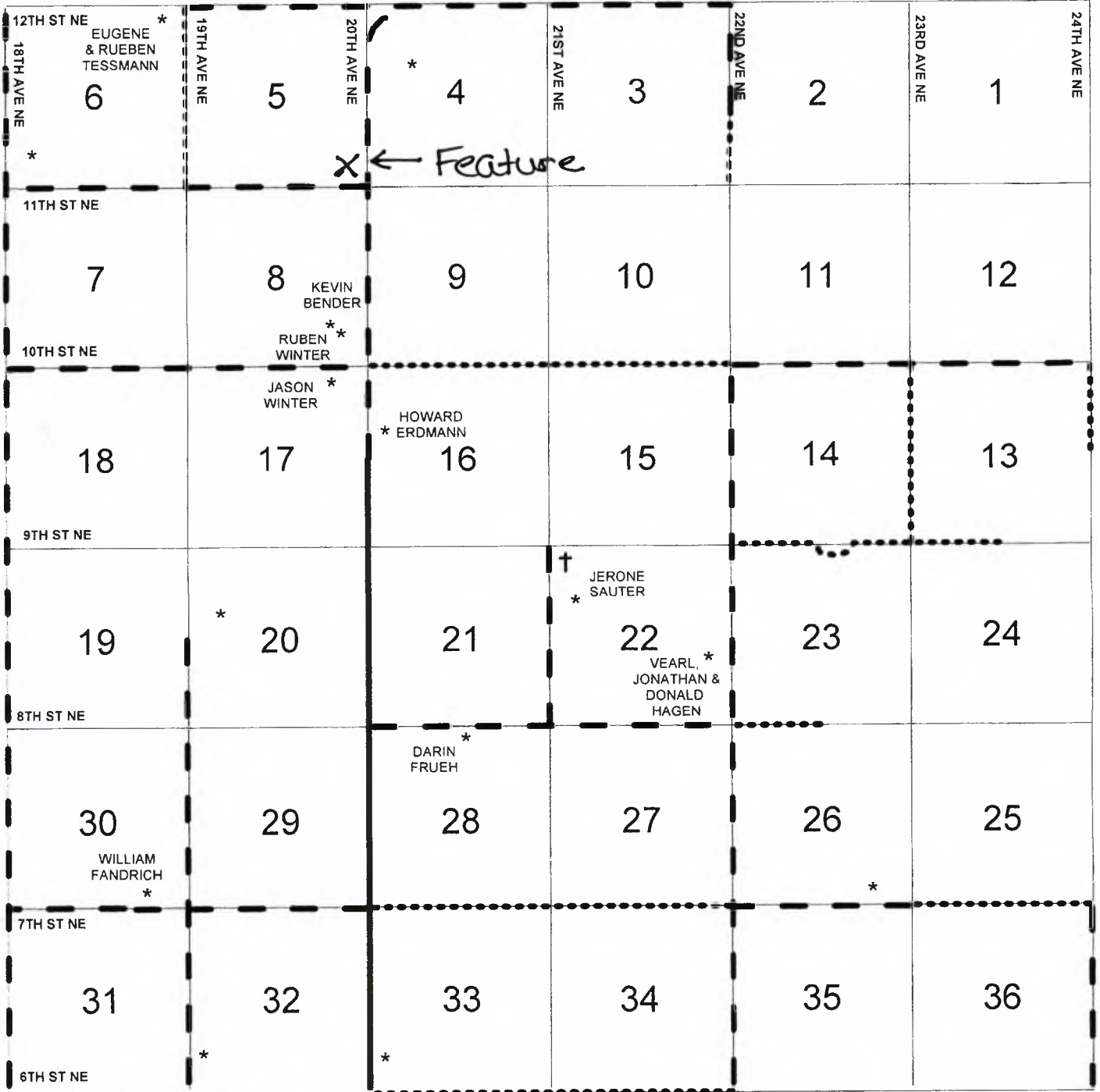

Boone Township School #1 5/22/2012 Kathy Wilner SH

BA	AX	AF	AP	
AK	AH	AU	AA	
AL	AI	AO	AY	AE
AW	AT	AJ	AS	AB
AV	AR	AN	AC	AG
AD	AM	BB	AZ	AQ