

NDCRS ARCHITECTURAL SITE FORM
PAGE 2—Feature Data

UPDATE

Field Code _____ SITS# 32 SH 310

Complete one Page 2 for each architectural feature at the site.

Architectural Feature # 1-2

Construction Date _____	Feature Type _____	Condition <u>1</u>
Feature Date _____	Context _____	Plan Shape _____
Structural System _____	Primary Exterior _____	Style _____
Original Owner's Ethnicity _____	Secondary Exterior _____	Architect/Builder _____

Other Information:

Based on 2009 aerial

Foundation _____ Stories _____

Window _____

Roof/Cornice _____

Dating Method(s): _____

Feature Preservation Recommendation(s) (Check all that apply):

- Individual nomination
- Contributes to a potential district
- No nomination potential
- Will not contribute to a district
- Potential district—feature would be a contributing element if other properties constitute a district
- Thematic nomination potential
- Component of a historic site or landscape
- Moved (specify all applicable choices)—a) relocation occurred within a historic period; b) recreates original site, orientation, landscape, & spatial relationships; c) compatible in context with neighboring structures; d) relocation has damaged eligibility
- Historical associations require further investigation

Recorded By Lorna Meidinger Date Recorded 9/16/2010
(First Name & Last Name) (mm/dd/year)

Instructions to complete a digital version of this form: (1) Download a copy to your hard drive; (2) Open the saved blank copy; (3) Fill out the form; (4) Use the Save As command to rename the form appropriately and save; (5) Print and submit to SHSND.

I. SITE I.D.

Field Code	SITS #		State	County	Site Number		
<u>CRM LT. 15.</u>			<u>32</u>	<u>SH</u>	<u>31</u>	<u>0</u>	
1 _____ 10			11	13	15	18	
Site Name	LTL	Twp	R	Sec	QQQ	QQ	Q
<u>LINCOLN SCHOOL #1</u>	<u>0</u>	<u>148</u>	<u>76</u>	<u>11</u>	<u>5</u>	<u>5</u>	<u>6</u>
19 _____ 38	39	40		47	48	49	50
Map Quad	LTL ^a	Twp ^a	R ^a	Sec ^a	QQQ ^a	QQ ^a	Q ^a
<u>LINCOLN VALLEY</u>	<u>0</u>	<u>148</u>	<u>76</u>	<u>11</u>	<u>6</u>	<u>6</u>	<u>5</u>
51 _____ 68	69	70		77	78	79	80

1. N $\frac{1}{2}$
2. E $\frac{1}{2}$
3. S $\frac{1}{2}$
4. W $\frac{1}{2}$
5. NE $\frac{1}{4}$
6. SE $\frac{1}{4}$
7. SW $\frac{1}{4}$
8. NW $\frac{1}{4}$
9. C

II. SITE DESCRIPTION

City	Site Area		
_____ 15	<u>340</u> m ²		
1 _____ 15	16	23	
Street #	Steet Name		
_____ 29	_____ 49		
24 _____ 29	30		
Feature #	# of Features	Theme 1	Theme 2
<u>1</u>	<u>4</u>	<u>8</u>	
50 51	52 53	54 55	56 57
Orig Use 1	Orig Use 2	Pres Use 1	Pres Use 2
<u>6C</u>		<u>0</u>	
58 60	61 63	64 66	67 69
Year Constructed	Dating Technique	Ethnic	Style
_____ 73	<u>0</u>	<u>0</u>	<u>26</u>
70 _____ 73	74	75 76	77 78
Structural Comp	Exterior Finish 1	Exterior Finish 2	
<u>15</u>	<u>19</u>		
79 80	1 2	3 4	
Architect/Builder	_____ 37		
_____ 5			

IV. C.R.M.

Ownership	Site Condition	Collection	Test	Excavation
<u>0</u>	<u>6</u>	<u>1</u>	<u>0</u>	<u>0</u>
38	39	40	41	42
Fieldwork Date	Management Recommendation			
<u>080/89</u>	<u>1</u>			
43 _____ 48	49			
Additional Information	_____ 40			
_____ 1				

OFFICE USE ONLY

OFFICE USE ONLY	Ecozone	Area Signf	CR Type	Verified Site	Non-Site
Soil Association	<u>7</u>	<u>2</u>	<u>2</u>	<u>1</u>	<u>0</u>
_____ 43	44 45	46	47	48	49
State Registry	National Register	E C F	T F	MS Number	
<u>4</u>	<u>4</u>	<u>2</u>	<u>2</u>	_____ 60	
50	51	52	53	54	60

Coder _____ h

Date Coded 2/25/85

I. SITE I.D.

Field Code <u>CRM LT. 15.</u>	SITS #		State <u>32</u>	County <u>S.H.</u>	Site Number <u>310</u>
1 _____ 10	LTL	Twp	R	Sec	QQQ QQ Q
Site Name _____	_____	_____	_____	_____	_____
19 _____ 38	39	40	_____	47	48 49 50
Map Quad _____	LTL _a	Twp _a	R _a	Sec _a	QQQ _a QQ _a Q _a
51 _____ 68	_____	_____	_____	_____	_____
	69	70	_____	77	78 79 80

1. N $\frac{1}{2}$
2. E $\frac{1}{2}$
3. S $\frac{1}{2}$
4. W $\frac{1}{2}$
5. NE $\frac{1}{4}$
6. SE $\frac{1}{4}$
7. SW $\frac{1}{4}$
8. NW $\frac{1}{4}$
9. C

II. SITE DESCRIPTION

City _____	Site Area _____ m ²		
1 _____ 15	16 _____ 23		
Street # _____	Street Name _____		
24 _____ 29	30 _____ 49		
Feature # _____	# of Features _____	Theme 1 _____	Theme 2 _____
<u>2</u>	<u>4</u>	<u>8</u>	_____
50 51	52 53	54 55	56 57
Orig Use 1 _____	Orig Use 2 _____	Pres Use 1 _____	Pres Use 2 _____
<u>10F</u>	_____	<u>18F</u>	_____
58 60	61 63	64 66	67 69
Year Constructed _____	Dating Technique _____	Ethnic _____	Style _____
70 73	<u>0</u>	<u>0</u>	<u>26</u>
74	75 76	77 78	_____
Structural Comp _____	Exterior Finish 1 _____	Exterior Finish 2 _____	_____
<u>15</u>	<u>19</u>	_____	_____
79 80	1 2	3 4	_____
Architect/Builder _____	_____	_____	_____
5 _____ 37	_____	_____	_____

IV. C.R.M.

Ownership _____	Site Condition _____	Collection _____	Test _____	Excavation _____
38	39	40	41	42
Fieldwork Date _____	Management Recommendation _____			
43 _____ 48	_____			
49	_____			
Additional Information _____	_____			
1 _____ 40	_____			

OFFICE USE ONLY.

OFFICE USE ONLY	Ecozone	Area Signf	CR Type	Verified Site	Non-Site
Soil Association _____	_____	_____	_____	_____	_____
41 43	44 45	46	47	48	49
State Registry _____	National Register _____	E C F	T F	MS Number _____	_____
50	51	52	53	54	60

Coder _____

Date Coded _____

I. SITE I.D.

Field Code <u>CRM LT 15</u>		SITS #		State	County	Site Number		
<u>1</u> _____ <u>10</u>		<u>3</u>	<u>2</u>	<u>SH</u>	<u>310</u>			
Site Name		LTL	Twp	R	Sec	QQ	QQ	Q
<u>19</u> _____ <u>38</u>		<u>39</u>	<u>40</u>		<u>47</u>	<u>48</u>	<u>49</u>	<u>50</u>
Map Quad		LTL _a	Twp _a	R _a	Sec _a	QQ _a	QQ _a	Q _a
<u>51</u> _____ <u>68</u>		<u>69</u>	<u>70</u>		<u>77</u>	<u>78</u>	<u>79</u>	<u>80</u>

1. N
2. E
3. S
4. W
5. NE
6. SE
7. SW
8. NW
9. C

II. SITE DESCRIPTION

Theme 1	Site Type	Cultural Material	Site Area
<u>1</u> _____ <u>2</u>	<u>3</u> <input type="checkbox"/> CM Scatter	<u>4</u> <input type="checkbox"/> Bone (worked)	<u>5</u> _____ <u>12</u> m ²
Theme 2	<u>13</u> <input type="checkbox"/> Chimney	<u>14</u> <input type="checkbox"/> Ceramics (Euro Am)	Cultural Depth
<u>17</u> _____ <u>18</u>	<u>15</u> <input checked="" type="checkbox"/> Depression	<u>16</u> <input type="checkbox"/> Charcoal	<u>21</u> _____ <u>23</u>
	<u>19</u> <input type="checkbox"/> Dump	<u>20</u> <input type="checkbox"/> Cloth	Depth Indicator
	<u>24</u> <input type="checkbox"/> Earthworks	<u>25</u> <input type="checkbox"/> Faunal Remains	<u>30</u> _____
	<u>26</u> <input type="checkbox"/> Fortification	<u>27</u> <input type="checkbox"/> Fire Cracked Rock	Occupation Date
	<u>28</u> <input type="checkbox"/> Foundation	<u>29</u> <input type="checkbox"/> Floral Remains	Begin _____ End _____
	<u>31</u> <input type="checkbox"/> Grave	<u>32</u> <input type="checkbox"/> Glass	<u>39</u> _____ <u>42</u> <u>43</u> _____ <u>46</u>
	<u>33</u> <input type="checkbox"/> Hearth	<u>34</u> <input type="checkbox"/> Hide, Hair, Fur	Basis for Dating
	<u>35</u> <input type="checkbox"/> Machinery	<u>36</u> <input type="checkbox"/> Human Remains	<u>53</u> _____ <u>54</u>
	<u>37</u> <input type="checkbox"/> Quarry/Mine	<u>38</u> <input type="checkbox"/> Masonry	CM Density Isolated Find
	<u>47</u> <input type="checkbox"/> Rock Art	<u>48</u> <input type="checkbox"/> Metal	<u>59</u> _____ <u>60</u> _____
	<u>49</u> <input type="checkbox"/> Trail	<u>50</u> <input type="checkbox"/> Plastic	
	<u>51</u> <input type="checkbox"/> Wreck (ship)	<u>52</u> <input type="checkbox"/> Rubber	
	<u>55</u> <input type="checkbox"/> Other	<u>56</u> <input type="checkbox"/> Shell (worked)	
		<u>57</u> <input type="checkbox"/> Wood (worked)	
		<u>58</u> <input type="checkbox"/> Other	

III. ENVIRONMENT

Landform 1	Landform 2	Slope/Exposure	View, degree	View, distance
<u>61</u> _____	<u>62</u> _____ <u>63</u> _____	<u>64</u> _____ <u>65</u> _____	<u>66</u> _____	<u>67</u> _____
Elevation	Drainage System			Dist Perm Water
<u>68</u> _____ <u>72</u> _____	<u>1</u> _____		<u>21</u> _____	<u>22</u> _____ <u>26</u> _____
Perm Water Type	Dist Seas Water	Seas Water Type	Ecosystem	
<u>27</u> _____	<u>28</u> _____ <u>32</u> _____	<u>33</u> _____	<u>34</u> _____ <u>37</u> _____	

IV. C.R.M.

Ownership	Site Condition	Collection	Test	Excavation
<u>38</u> _____	<u>39</u> _____	<u>40</u> _____	<u>41</u> _____	<u>42</u> _____
Fieldwork Date	Management Recommendation			
<u>43</u> _____ <u>48</u> _____	<u>49</u> _____			
Additional Information				
<u>FEATURES 3, 4</u>				
				<u>40</u>

OFFICE USE ONLY

Soil Association	Ecozone	Area Signf	CR Type	Verified Site	Non-Site
<u>41</u> _____ <u>43</u> _____	<u>44</u> _____ <u>45</u> _____	<u>46</u> _____	<u>47</u> _____	<u>48</u> _____	<u>49</u> _____
State Registry	National Register	E C F	T F	MS Number	
<u>50</u> _____	<u>51</u> _____	<u>52</u> _____	<u>53</u> _____	<u>54</u> _____ <u>60</u> _____	

Coder _____

Date Coded _____

1. ACCESS:

NE NE SE of Section 11, T148N, R76W. From the intersection of ND 200 and ND 14 drive north on ND 14 for 11 miles, then drive west on county gravel roads 3 miles, then drive north on county gravel roads 0.5 miles. The site is a standing obvious schoolhouse on the west side of the road.

2. DESCRIPTION OF SITE:

This site is schoolhouse and privy, ⁿLincoln School #1.

FEATURE 1: A 1-story wood-frame gabled schoolhouse with gabled wood-frame entry addition on the east end. The structure has clapboard siding on exterior walls and cornerboards. It has wood shingles on the roof, poured concrete foundation. No basement is evident. The structure has been electrified. Three 2/2 double hung windows are on each of the north and south sides; these windows are covered with 4-pane storm windows. The entry addition also has a 2/2 double hung window on each side and has a five horizontal pattern door at center of east end. The building is in a fair degree of maintenance and may still be used as a township meeting hall, voting place. (photo 6:11 from SW, 6:12 from NE)

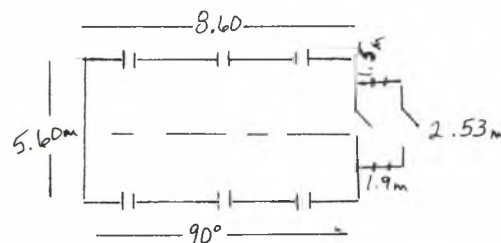

FEATURE 2: A shed-roofed wood-frame outhouse, apparently a two- or three-holer. The structure has fitted horizontal lap siding and wood shingles on the roof.

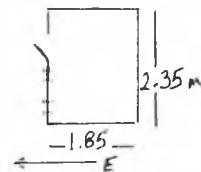

FEATURE 3: A rectangular outhouse depression to the north of Feature 1. This feature may be the location that the outhouse was recently moved from, as evidenced by relatively recent trash in the hole including used toilet paper. The depression now has fieldstone in it and some cut lumber. It has apparently been partially filled with earth. (photo 6:13 from S)

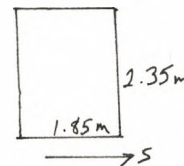

FEATURE 4: A second apparent outhouse depression or possibly a well, which has a poured concrete foundation around it. It is roughly the same dimensions as the other outhouse depression. It now has some cut lumber and fieldstone pushed into it. (photo 6:14 from S)

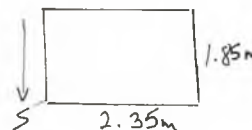

NDCRS ARCHEOLOGICAL AND HISTORICAL SITE FORM
SKETCH MAP

FIELD CODE: CRM-LT-15

SITS# _____

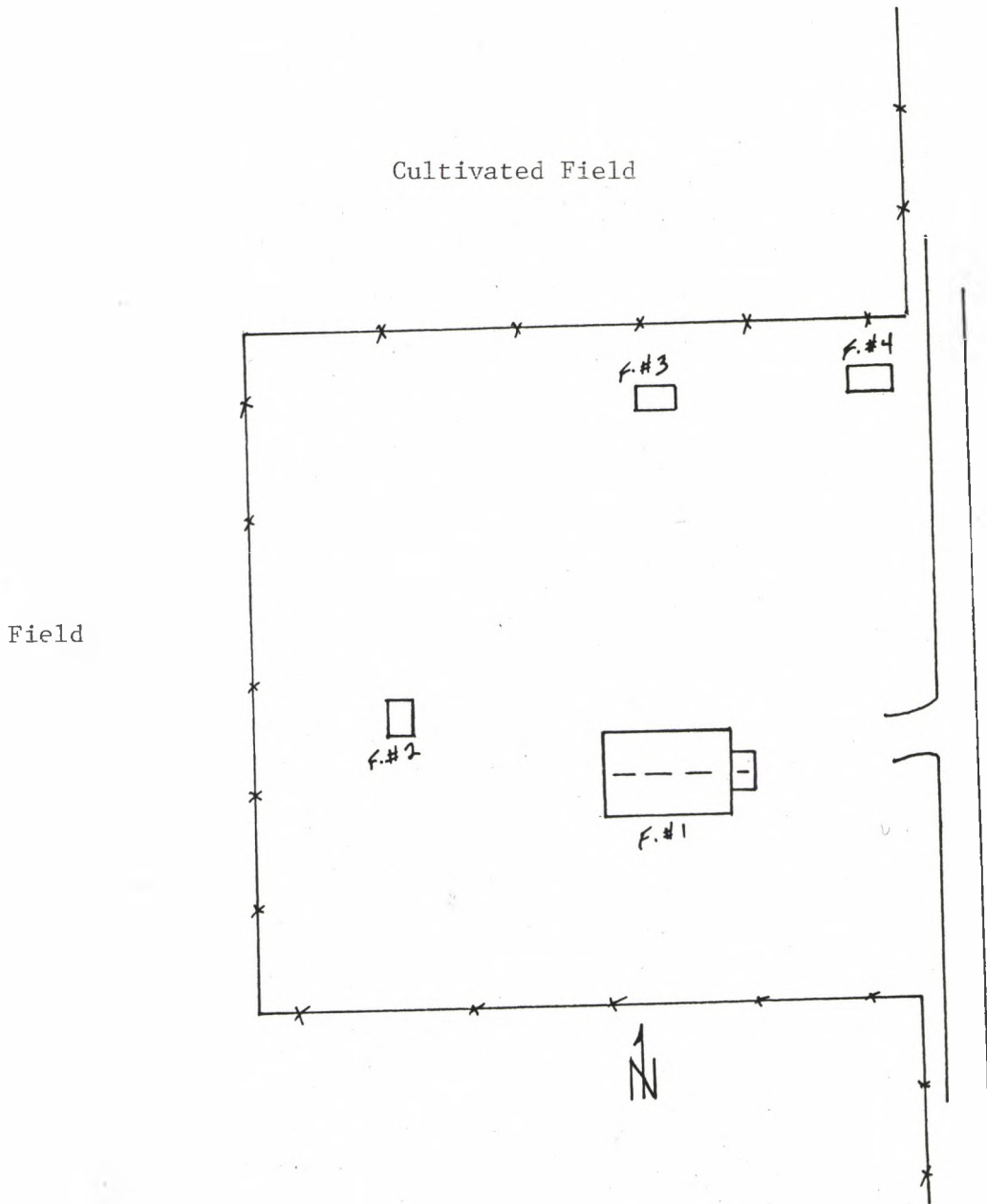

Scale: 1" = 40'

3. DESCRIPTION OF CULTURAL MATERIALS:
There are some pieces of clear window glass on the site. No other cultural materials were observed.
4. ARTIFACT REPOSITORY: No artifacts collected.
5. DESCRIPTION OF SUBSURFACE TESTING: No testing.
6. CURRENT USE OF SITE: School/township hall
7. OWNER'S NAME/ADDRESS: Frey Brothers, Denhoff
8. VEGETATION: Short mowed grass
9. COVER (% OF VISIBLE GROUND): 5%
10. MAN-HOURS SPENT ON SITE: 1
11. PROJECT TITLE: 1984 Lonetree/Lincoln Valley Survey
P.I.: Deaver and Schweigert
12. REPORT TITLE:
A Class II Intensive Inventory of the Lincoln Valley Irrigation Area and the Recordation of Historic Farmsteads in the Lonetree Reservoir Project, Garrison Diversion Unit, Sheridan and Wells Counties, North Dakota. (1985)

AUTHOR(S): Sherry Deaver and Kurt P. Schweigert
13. OTHER PUBLISHED REFERENCES:
14. DESCRIPTION OF COLLECTIONS OBSERVED: None observed
15. OWNER-ADDRESS OF COLLECTIONS OBSERVED: No collections observed
16. STATEMENT OF INTEGRITY:
This site retains fair integrity. The schoolbuilding and outhouse are in good condition. However, the two outhouse depressions indicate that other structures once stood on the site.
- 17: STATEMENT OF SIGNIFICANCE:
This school is a standard-plan rural school and may have been constructed at any date between 1900 and about 1950. Although this school represents a vanishing architectural form in the region, it is not of sufficient significance to warrant nomination to the National Register of Historic Places. The property was patented to Martin Frey on November 1, 1904. Subsequent owners were Margarethe Frey, Christina Wahl, August Frey, Pauline Wagner, and John Frey (1930), and the Frey Brothers (Lloyd, Donald and Duane 1976). None of these persons appears to have been outstanding in the history of the local area, state or nation, and archival sources do not indicate other possible historical significance for the site. This site is therefore not eligible for nomination to the National Register of Historic Places, and no further cultural research is recommended.

18: COMMENTS/REFERENCES:

RECORDED BY: Schweigert and MacDonald

DATE: August 7, 1984

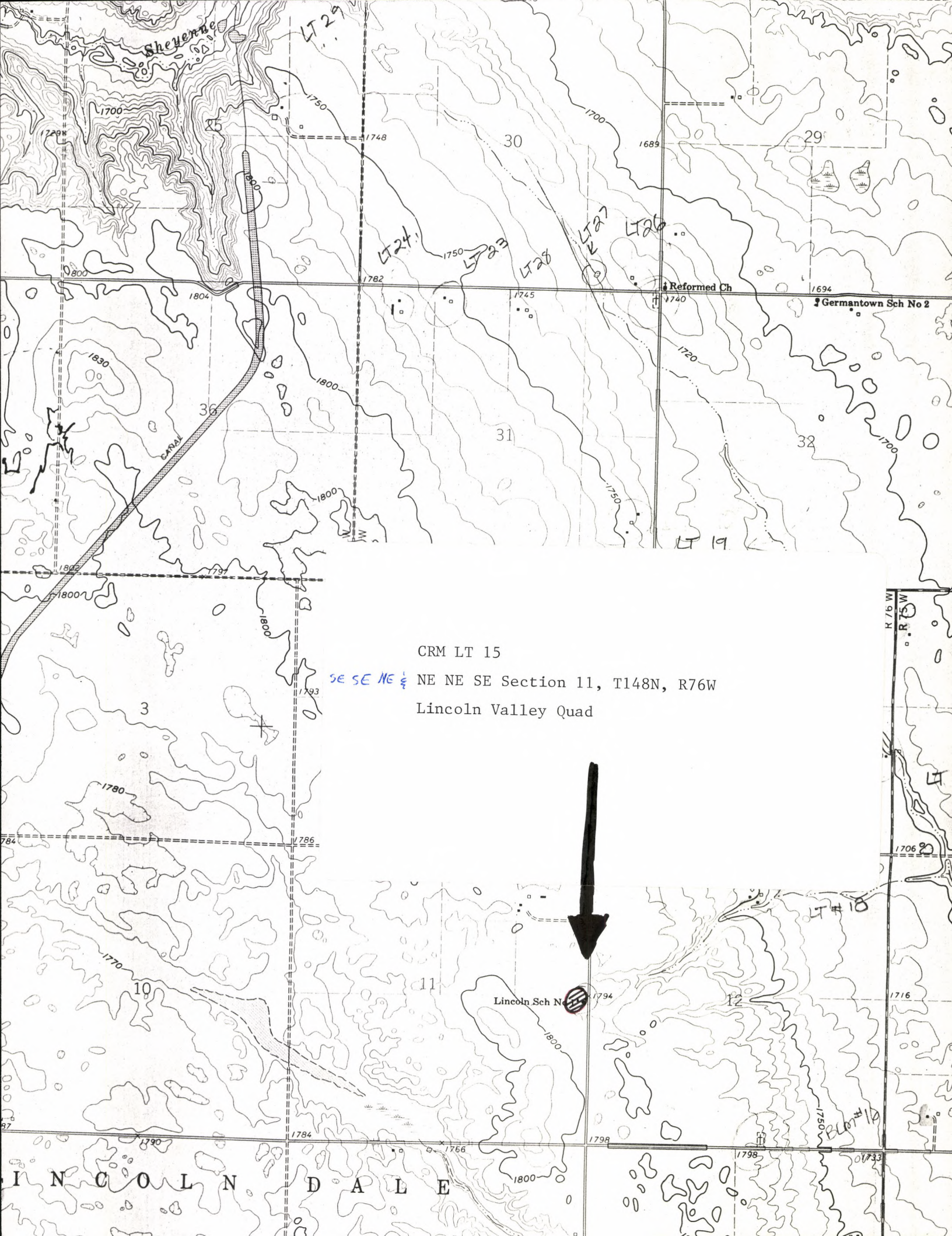

CRM LT 15

SE SE NE 1/4 NE NE SE Section 11, T148N, R76W

Lincoln Valley Quad

Lincoln Sch No 11

L I N C O L N N E B R A S K A

5:13 FEATURE 3, PRIVY
HOLE, FROM SOUTH



6:14 FEATURE 4, PRIVY
HOLE FROM SOUTH



A:2 Feature 2 from NE



6:11 SCHOOLHOUSE FROM THE SW



6:12 SCHOOLHOUSE FROM THE NE

