

NDCRS ARCHITECTURAL FORM PAGE 1

Field Code _____

SITS# 32 TR X106 _____

Map Quad Buxton _____

Site Name Lerom School _____

Map Quad _____

Site Name _____

LTL ___ T. 148 N., R. 50 W., Sec. 26 QQQ 7 of the QQ 7 of the Q 7

LTL ___ T. ___ N., R. ___ W., Sec. ___ QQQ ___ of the QQ ___ of the Q ___

LTL ___ T. ___ N., R. ___ W., Sec. ___ QQQ ___ of the QQ ___ of the Q ___

LTL ___ T. ___ N., R. ___ W., Sec. ___ QQQ ___ of the QQ ___ of the Q ___

NAD 1983 UTM 5273761 Zone 14N

NAD 1983 UTM 649968

City: _____

Subsection
1 = N½
2 = E½
3 = S½
4 = W½
5 = NE¼
6 = SE¼
7 = SW¼
8 = NW¼

Street Number: _____

Street Name: County Hwy 13 _____

Urban Legal Description: _____

Total Number of **Architectural** Features: 1 _____

Fieldwork Date: _____

Reconnaissance Survey _____

Intensive Survey _____

Project & Principal Investigator: _____

Contracting Firm or Agency Completing the Form:

State Historical Society of North Dakota

Additional Information:

SHSND USE

Component _____ Study Unit _____ Verified Site _____ CR Type _____

Component _____

Component _____

Recorded By: Amy Bleier Date Recorded: 08/10/2020

Form instructions: (1) Download; (2) Save A Copy; (3) Submit a paper copy of the form to the SHSND and upload the PDF version of the form and corresponding GIS shapefiles to the ND SHPO-run FTP site.

**NDCRS ARCHITECTURAL FORM
PAGE 2 – Feature Data**

Field Code _____

SITS# 32 TR X106 _____

Complete one Page 2 for each architectural feature at the site.

Architectural Feature # 1

Construction Date _____

Feature Date _____

Structural System _____

Original Owner's Ethnicity _____

Feature Type 9 - School; Church school _____

Context Education _____

Primary Exterior _____

Secondary Exterior _____

Condition _____

Plan Shape _____

Style _____

Architect/Builder _____

Foundation _____ Stories _____

Roof/Cornice _____

Window _____

Dating Method(s) _____

Miscellaneous Information _____

Feature Preservation Recommendation(s) (Check all that apply):

Individual nomination

Contributes to a potential district

No nomination potential

Will not contribute to a district

Potential district—feature would be a contributing element if other properties constitute a district

Thematic nomination potential

Component of a historic site or landscape

Moved (specify all applicable choices)—a) relocation occurred within a historic period; b) recreates original site, orientation, landscape, and spatial relationships; c) compatible in context with neighboring structures; d) relocation has damaged eligibility

Historical associations require further investigation

Recorded By: Amy Bleier **Date Recorded:** 08/10/2020

From: [Sally Hoffman](#)
Sent: Monday, August 16, 2021 1:48 PM
To: ["Historical Society, Pennsylvania State University"](#)

From: Sally Hoffman <sh34@psu.edu>
Sent: Monday, August 16, 2021 1:48 PM
To: ["Historical Society, Pennsylvania State University"](#)
Subject: One-room school project

CAUTION: This email originated from an outside source. Do not click links or open attachments unless you know they are safe.

Hello, Since things are all electronic now, is there any reason the school project list cannot continue to be updated? Can you document schools that were part of history even if they are no longer there?

I have some photos of my grandma's school. One photo was taken May of 1968.

Lewis School
(It's listed as Lewis by Ada Lewis)

St. Quaker
School #6

Strawport Township
York County

Thank you,
Sally Hoffman



• MAY • 68



LEROM RURAL SCHOOL

Mom's home
school

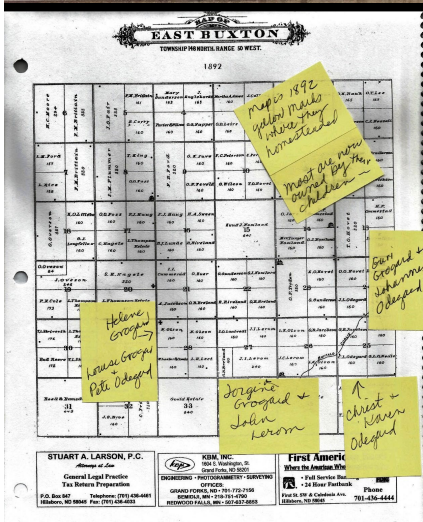



32TRX106

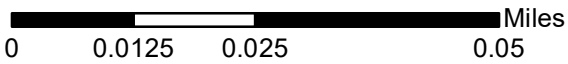

School

1957_1962 Aerial Imagery
ND GIS Hub

**RESTRICTED DATA - PROTECTED BY
THE NORTH DAKOTA CENTURY CODE**

32TRX106
Sec. 26, T148N, R50W
Traill County
NAD 1983; 1:1,250
Data: ND SHPO
A. Bleier; 08/10/2020



14805027

14805026

32TRX106

14805034

14805035

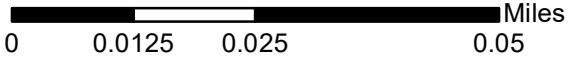

● School

RESTRICTED DATA - PROTECTED BY THE NORTH DAKOTA CENTURY CODE

32TRX106
Sec. 26, T148N, R50W
Trail County
NAD 1983; 1:1,250
Data: ND SHPO
A. Bleier; 08/10/2020