

I. SITE I.D.

SITS # 32 WA 7
State County Site Number

Field Code G.P.R.-2.1 Site Name _____
Field Code WAX184 Site Name _____

Map Quad B.IG. WOODS, NW
Map Quad _____

LTL	<input type="checkbox"/>	Twp	<u>157</u>	R	<u>51</u>	Sec	<u>25</u>	QQQ	<input type="checkbox"/>	QQ	<u>7</u>	Q	<u>8</u>
LTL	<input type="checkbox"/>	Twp	<u>157</u>	R	<u>51</u>	Sec	<u>25</u>	QQQ	<u>6</u>	QQ	<u>8</u>	Q	<u>8</u>
LTL	<input type="checkbox"/>	Twp	_____	R	_____	Sec	_____	QQQ	<input type="checkbox"/>	QQ	_____	Q	<input type="checkbox"/>
LTL	<input type="checkbox"/>	Twp	_____	R	_____	Sec	_____	QQQ	<input type="checkbox"/>	QQ	_____	Q	<input type="checkbox"/>
LTL	<input type="checkbox"/>	Twp	_____	R	_____	Sec	_____	QQQ	<input type="checkbox"/>	QQ	_____	Q	<input type="checkbox"/>
LTL	<input type="checkbox"/>	Twp	_____	R	_____	Sec	_____	QQQ	<input type="checkbox"/>	QQ	_____	Q	<input type="checkbox"/>

1. N $\frac{1}{2}$
2. E $\frac{1}{2}$
3. S $\frac{1}{2}$
4. W $\frac{1}{2}$
5. NE $\frac{1}{4}$
6. SE $\frac{1}{4}$
7. SW $\frac{1}{4}$
8. NW $\frac{1}{4}$
9. C

II. SITE DESCRIPTION

<input type="checkbox"/> Cm Scatter	<input type="checkbox"/> Bone	<input checked="" type="checkbox"/> <u>7</u> Site Type
<input type="checkbox"/> Chimney	<input checked="" type="checkbox"/> Ceramics	<input checked="" type="checkbox"/> <u>3.1</u> Context
<input checked="" type="checkbox"/> Depression	<input type="checkbox"/> Charcoal	<input type="checkbox"/> <u>1.6, 1.0, 0.0</u> Site Area
<input type="checkbox"/> Dump	<input type="checkbox"/> Cloth	<small>m. x m.</small>
<input checked="" type="checkbox"/> Earthworks	<input checked="" type="checkbox"/> Faunal Remains	<input type="checkbox"/> <u>2.0</u> Cultural Depth <small>cm.</small>
<input type="checkbox"/> Fortification	<input type="checkbox"/> Fire Cracked Rock	<input checked="" type="checkbox"/> <u>7</u> Depth Indicator
<input type="checkbox"/> Foundation	<input type="checkbox"/> Floral Remains	Occupation Date
<input type="checkbox"/> Grave	<input checked="" type="checkbox"/> Glass	Begin <u>1.0.71</u> End <u>1.9.56</u>
<input type="checkbox"/> Hearth	<input type="checkbox"/> Hide, Hair, Fur	Basis For Dating <u>1.0</u>
<input type="checkbox"/> Machinery	<input type="checkbox"/> Human Remains	<input checked="" type="checkbox"/> <u>2</u> Cm Density
<input type="checkbox"/> Quarry/Mine	<input type="checkbox"/> Masonry	<input type="checkbox"/> Isolated Find
<input type="checkbox"/> Rock Art	<input type="checkbox"/> Metal	
<input checked="" type="checkbox"/> Trail	<input type="checkbox"/> Plastic	
<input type="checkbox"/> Wreck	<input type="checkbox"/> Rubber	
<input type="checkbox"/> Other	<input type="checkbox"/> Shell	
	<input type="checkbox"/> Wood	
	<input type="checkbox"/> Other	

III. ENVIRONMENT

Landform 1 15 Landform 2 3 Slope/Exposure 1.9 Ecosystem

Landform 1 _____ Landform 2 _____ Slope/Exposure _____ Ecosystem

Elevation 24.1 m. Drainage System RED RIVER View, Degree 3 View, Distance 2

Dist Perm Water 1.0 m. Perm Water Type 3 Dist Seas Water 5.00 m. Seas Water Type 5

IV. C.R.M.

3 Ownership Ownership

0510594 Fieldwork Date _____ Fieldwork Date _____

Site Condition 3 Collection 0 Test/Probe 0 Excavation

Additional Information _____ Management Recommendation 6

Location from SW corner of W. 1/4

SHSND USE

17.9 Soil Association 16 Ecozone 3 Area Signf _____ MS Number _____

Soil Association _____ Ecozone _____ Area Signf _____ MS Number _____

CR Type Verified Site Non-Site 2 E C F T F

State Registry National Register

FIELD MANUAL
NDCRS HISTORICAL ARCHEOLOGICAL SITE FORM

FEATURE TYPE 0 or blank, Absent 1. Present 2. Probable CULTURAL MATERIAL 0 or blank, Absent 1. Present 2. Probable DEPTH INDICATOR 0. Not applicable 1. Auger 2. Cutbank or erosional feature 3. Excavation 4. Guess 5. Shovel 6. Soil Probe 7. Other BASIS FOR DATING 0. Unknown 1. Date Unknown 2. Radiocarbon	3. Typology 4. Dendrochronology 5. Thermoluminescence 6. Geology 7. Patination 8. Professional Judgement 9. Both Absolute & Relative 10. Documentation 11. Interview 12. Other CM DENSITY 0. No cultural material 1. Sparse distribution 2. Medium distribution 3. Dense distribution 4. (Category eliminated) 5. Medium-dense concentration(s) within a sparse scatter 6. Dense concentration(s) within a medium scatter 7. Denser concentration(s) within a dense scatter 8. Isolate	AGRICULTURE 82 Animal Shelter/Stable 62 Barn 92 Blacksmith Shop 66 Chicken Coop/Poultry House 3 Clinic, Animal/Veterinarian 43 Corral/Enclosure/Pen 70 Experiment Station 5 Farm, Dairy 1 Farm/Farmstead 61 Barnyard/Bin 91 Greenhouse/Nursery 12 Hatchery, Am'l/Bird/Fish 67 Ice/Smoke House/Root Cellar 64 Linn. Shack 14 Pump/Well 77 Pump House/Well House 4 Ranch 6 Silo/Silage Pit 13 Stock Dam 15 Storage Building 16 Storage Yard 69 Summer Kitchen 14 Well/Pump 17 Windmill 71 Work shop ARTS AND ENTERTAINMENT 75 Auditorium/Lecture Hall 74 Cinema/Theater 75 Lecture Hall 99 Museum/Gallery 75 Opera House 73 Studio, Photo/Art/Sculpt 74 Theater COMMERCE 76 Bank/S & L/Financial 68 General Store 47 Shopping Center/Mall 47 Store, Retail 68 Trading Post 15 Warehouse COMMUNICATIONS 87 Newspaper Office 87 Print Shop 85 Radar Facility 93 Radio/TV Station 89 Teleph./Telegr. Facil. 17 Tower, Radio/TV/Microwave EDUCATION 19 Business College 75 Class Room/Lecture Hall 19 College/University 70 Laboratory 20 Library 9 School 19 Seminary 19 Trade/Technical School ENGINEERING 21 Bridge/Trestle 22 Canal/Flume	SITE TYPE 13 Dam 17 Tower FOOD SERVICE 90 Bakery 28 Bar/Tavern 24 Bottling Plant 24 Brewery/Distillery 90 Butcher Shop 25 Cannery 97 Creamery 97 Dairy Processing Plant 25 Frozen Food Locker 26 Grocery Store 90 Meat Packing Plant 27 Mill, Grist/Flour 23 Restaurant/Cafe/Mess Hall 25 Sugar Refinery FUNERARY 29 Cemetery 78 Gravestone 78 Memorial 78 Monument 29 Mortuary GOVERNMENT 32 Border Crossing Station 30 City Hall 84 Correctional Facility/Jail 59 Courthouse 32 Customs House 58 Fire Station 59 Government Office 86 Indigent Home 86 Orphanage 33 Pest House 32 Police Station 18 Post Office/Mail Station 10 Sanitary Land Fill 10 Sewage Treatment Plant 32 Sheriff's Office 73 Township Hall 9A Water Treatment Plant HEALTH CARE 33 Clinic/Dispensary 33 Hospital/Infirmary 86 Nursing Home INDUSTRIAL 34 Brick Manufacturing Plant 88 Bulk Plant 34 Concrete Mfg. Plant 31 Elect. Gener. Facility 36 Elect. Transform. Facility 38 Elect. Transmiss. Facility 34 Factory/Laundry 96 Gas Storage 96 Gas Transmission Facility 11 Gas Well 11 Grain Storage, Commercial 36 Lumber Yard 37 Mill, Saw 37 Mill, Stamp/Minerals Refin.	35 Mine/Quarry 96 Oil Refinery 58 Oil Tank Battery 96 Oil Transmission Facility 14 Oil Well 96 Pipeline 71 Repair Shop 16 Storage Yard 38 Tipline 15 Warehouse 92 Welding/Blacksmith Shop LANDSCAPE ARCHITECTURE 78 Fountain 78 Garden 78 Monument 39 Park MILITARY 79 Armory 60 Battlefield 79 Bastion 79 Blockhouse 44 Camp Site, Temporary R Camp, Semi-Permanent 79 Defensive Works 8 Fort/Cantonment/Post/Base 79 Missile Site 79 Pallisade 39 Parade Ground 59 Post/Base Exchange (PI/BI) 79 Powder Magazine 51 Rifle Range 68 Sutter's Store 48 Trail OFFICE/HEADQUARTERS 45 Administrative 45 Business 80 Fraternal/Sororal 80 Lodge 45 Organizational 46 Professional 80 Social RECREATION/SPORTS 57 Arcade/Casino 32 Billiard Parlor/Pool Hall 57 Boat Landing, Recreational 51 Camp/Picnic Grounds 94 Fairgrounds 91 Grandstand 51 Play ground 52 Recreation Area, Indoor 51 Recreation Area, Outdoor 51 Resort 94 Rodeo Grounds 95 Sport Facility, Indoor 81 Sport Facility, Outdoor RELIGIOUS 54 Chapel, Non-Denom. 9 Church School 53 Church, Catholic 63 Church, Protestant 42 Convent/Monastery 30 Fellowship Hall 40 Parsonage/Manse/Rectory 19 Seminary 78 Shrine 54 Synagog RESIDENTIAL 42 Barracks/Dorm./Bunk House 41 Dwelling, Double Unit 42 Dwelling, Multiple Unit 40 Dwelling, Single Unit 55 Garage/Carriage House 64 Hotel/Motel/Inn 65 Mobile Home 50 Privy TRANSPORTATION 49 Airport/Airfield/Land. Fld. 56 Boat Landing, Com'l/Steam 57 Boat Landing, Recreational 21 Bridge/Trestle 59 Depot/Terminal 82 Ferry 82 Ford 72 Freight Yard 8R Fuel Station/Yard, Coal/Wood, etc. RR Gasoline Station 55 Hanger 48 Highway 62 Livery 70 Loading Platform 4R Railroad Grade/Tracks 56 Rest Stop 4R Road 73 Roundhouse 48 Staging 78 Signal 62 Stable 48 Spur 56 Stage Station 72 Switch Yard 48 Trail 82 Tunnel 83 Turn-around MISCELLANEOUS 2 Accident/Disaster Site 10 Dump 73 Spring 77 Spring House 17 Tower 7 Town/City/Colony/Settlement 99 Other
II. SITE DESCRIPTION 1 Aviation 2 Bridges 3 Colonization 4 Commerce 5 Communications 6 Depression, the Great 7 Education 8 Energy Development 9 Entertainment 10 Exploration 11 Farming, Bonanza 12 Farming, Dairy 13 Farming 14 Fur Trade 15 Governmental, National 16 Governmental, Territorial	CONTEXT 17 Government, State 18 Government, Local 19 Horticulture 20 Industrial Development 21 Irrigation and Conserv. 22 Military 23 Mining, Coal 24 Petroleum 25 Railroads 26 Ranching, Open Range 27 Ranching, Fee Simple 28 Religion 29 Roads, Trails, and Hwy. 30 Rural Settlement 31 Urban Settlement 32 Water Navigation			
III. ENVIRONMENT 1. Top of 2. Bottom of 3. Side of 4. 5. Top and Bottom of 6. Top and Side of 7. Bottom and Side of 8. Top, Bottom, & Side VIEW, DISTANCE 1. Excellent (5-7miles) 2. Good (2-5 miles) 3. Fair (1-2 miles) 4. Poor (less than 1 mile) 5. No View OWNERSHIP 1. State 2. Federal 3. Private 4. Local Government 5. Reservation MANAGEMENT RECOMM. 1. No Further Work 2. Further Work 3. Impact Analysis 4. Both 2 & 3 5. Avoidance-Mitigation 6. Exclusion-Preservation AREA SIGNF. 1. Archeological 2. Architectural 3. Historical 4. Paleontological	LANDFORM 1 1. Top of 2. Bottom of 3. Side of 4. 5. Top and Bottom of 6. Top and Side of 7. Bottom and Side of 8. Top, Bottom, & Side VIEW, DISTANCE 1. Excellent (5-7miles) 2. Good (2-5 miles) 3. Fair (1-2 miles) 4. Poor (less than 1 mile) 5. No View OWNERSHIP 1. State 2. Federal 3. Private 4. Local Government 5. Reservation MANAGEMENT RECOMM. 1. No Further Work 2. Further Work 3. Impact Analysis 4. Both 2 & 3 5. Avoidance-Mitigation 6. Exclusion-Preservation AREA SIGNF. 1. Archeological 2. Architectural 3. Historical 4. Paleontological	LANDFORM 2 10. Ridge 1. Beachline (glacial) 2. Beach or riverbank 3. Canyon 4. Island 5. Delta 6. Draw 7. Upland plain 8. Floodplain 9. Hill-Knoll-Bluff PERM & SEAS WATER TYPE 21. Lacustrine Plain 22. River Levee 0. Unknown 1. Bottomland 2. Terraces 3. Toe Slope 4. Scoria 5. Badlands 6. Upland Grassland	SLOPE/EXPOSURE 1. North 2. Northeast 3. East 4. Southeast 5. South 6. Southwest 7. West 8. Northwest 9. Closed 10. Open ECOSYSTEM 7. Wetting Grassland 8. Hardwood Drain 9. Marsh 10. Ponderosa Pine 11. Hilly Scoria 12. Upland Breaks 13. River Breaks 14. Rockland 15. Choppy Sandhills 16. Savanna 17. Mixed Grass Prairie-Dry 18. Mixed Grass Prairie-Wet 19. River Terrace and Bottom Lands	VIEW, DEGREE 1. 90° 2. 180° 3. 270° 4. 360° 5. No View
IV. C.R.M. 1. No Further Work 2. Further Work 3. Impact Analysis 4. Both 2 & 3 5. Avoidance-Mitigation 6. Exclusion-Preservation AREA SIGNF. 1. Archeological 2. Architectural 3. Historical 4. Paleontological	SITE CONDITION 1. Destroyed 2. Inundated 3. Very Poor 4. Poor 5. Fair 6. Good 7. Excellent COLLECTION 0. No Cultural Material 1. CM but No Collection 2. Systematic Collection 3. Non-Systematic 4. Completely Collected TEST & EXCAVATION 0. No 1. Yes, Results Positive 2. Yes, Results Negative	NATIONAL & STATE REGISTER 0. Undetermined 1. Listed 2. Nominated 3. Eligible 4. Not Eligible 5. Determined Eligible 6. Eligible as Part of a District E C F AND T F 1. Exclusion Area 2. Avoidance Area 3. Area of Concern		

NDCRS SITE FORM
HISTORICAL ARCHEOLOGICAL SITES

SITS # 3,2, 4, 7
State County Site Number

- 1. N $\frac{1}{2}$
- 2. E $\frac{1}{2}$
- 3. S $\frac{1}{2}$
- 4. W $\frac{1}{2}$
- 5. NE $\frac{1}{4}$
- 6. SE $\frac{1}{4}$
- 7. SW $\frac{1}{4}$
- 8. NW $\frac{1}{4}$
- 9. C

I. SITE I.D.

Field Code _____ Site Name _____
 Field Code _____ Site Name _____
 Map Quad _____
 Map Quad _____
 LTL Twp _____ R _____ Sec _____ QQQ QQ Q
 LTL Twp _____ R _____ Sec _____ QQQ QQ Q
 LTL Twp _____ R _____ Sec _____ QQQ QQ Q
 LTL Twp _____ R _____ Sec _____ QQQ QQ Q
 LTL Twp _____ R _____ Sec _____ QQQ QQ Q
 LTL Twp _____ R _____ Sec _____ QQQ QQ Q

II. SITE DESCRIPTION

FEATURE TYPE	CULTURAL MATERIAL	<u>48</u> Site Type
<input type="checkbox"/> Cm Scatter	<input type="checkbox"/> Bone	<u>29</u> Context
<input type="checkbox"/> Chimney	<input type="checkbox"/> Ceramics	_____ Site Area
<input type="checkbox"/> Depression	<input type="checkbox"/> Charcoal	_____ m. x m.
<input type="checkbox"/> Dump	<input type="checkbox"/> Cloth	_____ Cultural Depth cm.
<input type="checkbox"/> Earthworks	<input type="checkbox"/> Faunal Remains	<input type="checkbox"/> Depth Indicator
<input type="checkbox"/> Fortification	<input type="checkbox"/> Fire Cracked Rock	Occupation Date
<input type="checkbox"/> Foundation	<input type="checkbox"/> Floral Remains	Begin _____ End _____
<input type="checkbox"/> Grave	<input type="checkbox"/> Glass	_____ Basis For Dating
<input type="checkbox"/> Hearth	<input type="checkbox"/> Hide, Hair, Fur	<input type="checkbox"/> Cm Density
<input type="checkbox"/> Machinery	<input type="checkbox"/> Human Remains	<input type="checkbox"/> Isolated Find
<input type="checkbox"/> Quarry/Mine	<input type="checkbox"/> Masonry	
<input type="checkbox"/> Rock Art	<input type="checkbox"/> Metal	
<input type="checkbox"/> Trail	<input type="checkbox"/> Plastic	
<input type="checkbox"/> Wreck	<input type="checkbox"/> Rubber	
<input type="checkbox"/> Other	<input type="checkbox"/> Shell	
	<input type="checkbox"/> Wood	
	<input type="checkbox"/> Other	

III. ENVIRONMENT

Landform 1 _____ Landform 2 _____ Slope/Exposure _____ Ecosystem _____
 Landform 1 _____ Landform 2 _____ Slope/Exposure _____ Ecosystem _____
 Elevation _____ Drainage System _____ View, Degree _____ View, Distance _____
 _____ m. _____
 Dist Perm Water _____ Perm Water Type _____ Dist Seas Water _____ Seas Water Type _____
 _____ m. _____

IV. C.R.M.

Ownership _____ Ownership _____
 _____ Fieldwork Date _____ Fieldwork Date _____
 Site Condition _____ Collection _____ Test/Probe _____ Excavation _____
 Additional Information _____ Management Recommendation _____

SHSND USE

_____ Soil Association _____ Ecozone _____ Area Signf _____ MS Number _____
 _____ Soil Association _____ Ecozone _____ Area Signf _____ MS Number _____
 CR Type Verified Site Non-Site E C F T F
 State Registry National Register

FIELD MANUAL
NDCRS HISTORICAL ARCHEOLOGICAL SITE FORM

FEATURE TYPE	0 or blank. Absent 1. Present 2. Probable	CULTURAL MATERIAL 0 or blank. Absent 1. Present 2. Probable	DEPTH INDICATOR 0. Not applicable 1. Auger 2. Cutbank or erosional feature 3. Excavation 4. Guess 5. Shovel 6. Soil Probe 7. Other	BASIS FOR DATING 0. Unknown 1. Date Unknown 2. Radiocarbon	3. Typology 4. Dendrochronology 5. Thermoluminescence 6. Geology 7. Patination 8. Professional Judgement 9. Both Absolute & Relative 10. Documentation 11. Interview 12. Other	CM DENSITY 0. No cultural material 1. Sparse distribution 2. Medium distribution 3. Dense distribution 4. (Category eliminated) 5. Medium-dense concentration(s) within a sparse scatter 6. Dense concentration(s) within a medium scatter 7. Denser concentration(s) within a dense scatter 8. Isolate	CONTEXT 1 Aviation 2 Bridges 3 Colonization 4 Commerce 5 Communications 6 Depression, the Great 7 Education 8 Energy Development 9 Entertainment 10 Exploration 11 Farming, Bonanza 12 Farming, Dairy 13 Farming 14 Fur Trade 15 Governmental, National 16 Governmental, Territorial 17 Government, State 18 Government, Local 19 Horticulture 20 Industrial Development 21 Irrigation and Conserv. 22 Military 23 Mining, Coal 24 Petroleum 25 Railroads 26 Ranching, Open Range 27 Ranching, Fee Simple 28 Religion 29 Roads, Trails, and Hwy. 30 Rural Settlement 31 Urban Settlement 32 Water Navigation	AGRICULTURE 82 Animal Shelter/Stable 82 Barn 82 Blacksmith Shop 66 Chicken Coop/Poultry House 3 Clinic, Animal/Veterinarian 43 Corral/Enclosure/Pen 70 Experiment Station 5 Farm, Dairy 1 Farm/Farmstead 61 Granary/Bin 91 Greenhouse/Nursery 12 Hatchery, Am'l/Bird/Fish 67 Ice/Smoke House/Root Cellar 64 Line Shack 14 Pump/Well 77 Pump House/Well House 4 Ranch 61 Silo/Silage Pit 13 Stock Dam 15 Storage Building 16 Storage Yard 69 Summer Kitchen 14 Well/Pump 17 Windmill 71 Work shop	ARTS AND ENTERTAINMENT 75 Auditorium/Lecture Hall 74 Cinema/Theater 75 Lecture Hall 99 Museum/Gallery 75 Opera House 73 Studio, Photo/Art/Sculpt 74 Theater	COMMERCE 76 Bank/S & L/Financial 68 General Store 47 Shopping Center/Mall 47 Store, Retail 68 Trading Post 15 Warehouse	COMMUNICATIONS 87 Newspaper Office 87 Print Shop 85 Radar Facility 93 Radio/TV Station 89 Teleph./Telegr. Facil. 17 Tower, Radio/TV/Microwave	EDUCATION 19 Business College 75 Class Room/Lecture Hall 19 College/University 70 Laboratory 20 Library 19 Seminary 19 Trade/Technical School	ENGINEERING 21 Bridge/Trestle 22 Canal/Flume	SITE TYPE 13 Dam 17 Tower FOOD SERVICE 91 Bakery 28 Bar/Tavern 24 Bottling Plant 24 Brewery/Distillery 90 Butcher Shop 25 Cannery 97 Creamery 97 Dairy Processing Plant 25 Frozen Food Locker 26 Grocery Store 90 Meat Packing Plant 27 Mill, Grist/Flour 23 Restaurant/Cafe/Mess Hall 25 Sugar Refinery	FUNERARY 29 Cemetery 78 Gravestone 78 Memorial 78 Monument 29 Mortuary	GOVERNMENT 37 Border Crossing Station 30 City Hall 84 Correctional Facility/Jail 59 Courthouse 32 Customs House 58 Fire Station 59 Government Office 86 Indigent Home 86 Orphanage 33 Post House 32 Police Station 18 Post Office/Hall Station 10 Sanitary Land Fill 10 Sewage Treatment Plant 32 Sheriff's Office 73 Township Hall 98 Water Treatment Plant	LANDSCAPE ARCHITECTURE 78 Fountain 78 Garden 78 Monument 39 Park	MILITARY 79 Armory 60 Battlefield 79 Bastion 79 Blockhouse 44 Camp Site, Temporary 8 Camp Site, Semi-Permanent 79 Defensive Works 8 Fort/Cantonment/Post/Base 79 Missile Site 79 Pallisade 39 Parade Ground 59 Post/Base Exchange (PI/BI) 79 Powder Magazine 51 Rifle Range 68 Suttler's Store 48 Trail	OFFICE/HEADQUARTERS 45 Administrative 45 Business 80 Fraternal/Sororal 80 Lodge 45 Organizational 46 Professional 80 Social	RECREATION/SPORTS 52 Arcade/Casino 32 Billiard Parlor/Pool Hall 57 Boat Landing, Recreational 51 Camp/Picnic Grounds 94 Fairgrounds 91 Grandstand 51 Play ground 52 Recreation Area, Indoor 51 Recreation Area, Outdoor 51 Resort 94 Rodeo Grounds 95 Sport Facility, Indoor 81 Sport Facility, Outdoor	RELIGIOUS 58 Chapel, Non-Denom. 9 Church School 53 Church, Catholic 63 Church, Protestant 42 Convent/Monastery 30 Fellowship Hall 40 Parsonage/Manse/Rectory 19 Seminary 78 Shrine 54 Synagog	RESIDENTIAL 42 Barracks/Dorm./Bunk House 41 Dwelling, Double Unit 41 Dwelling, Multiple Unit 40 Dwelling, Single Unit 55 Garage/Carriage House 64 Hotel/Motel/Inn 65 Mobile Home 50 Privy	TRANSPORTATION 49 Airport/Airfield/Land. Fld. 56 Boat Landing, Com'l/Steam 57 Boat Landing, Recreational 23 Bridge/Trestle 59 Depot/Terminal 82 Ferry 82 Ford 72 Freight Yard 88 Fuel Station/Yard, Coal/Wood, etc. 88 Gasoline Station 55 Hanger 48 Highway 62 Livery 70 Loading Platform 48 Railroad Grade/Tracks 56 Rest Stop 48 Road 73 Roundhouse 48 Siding 78 Signal 62 Stable 48 Spur 56 Stage Station 72 Switch Yard 48 Trail 82 Tunnel 83 Turn-around	MISCELLANEOUS 7 Accident/Disaster Site 10 Dump 73 Spring 77 Spring House 17 Tower 7 Town/City/Colony/Settlement 99 Other
II. SITE DESCRIPTION																								
III. ENVIRONMENT																								
IV. C.R.M.																								
OFFICE																								

NDCRS SITE FORM
HISTORICAL ARCHEOLOGICAL SITES

SITS # 32 WA 7
State County Site Number

Field Code _____ Site Name _____
Field Code _____ Site Name _____

Map Quad _____
Map Quad _____

LTL Twp _____ R _____ Sec _____ QQQ QQ Q
LTL Twp _____ R _____ Sec _____ QQQ QQ Q
LTL Twp _____ R _____ Sec _____ QQQ QQ Q
LTL Twp _____ R _____ Sec _____ QQQ QQ Q
LTL Twp _____ R _____ Sec _____ QQQ QQ Q
LTL Twp _____ R _____ Sec _____ QQQ QQ Q

1. N $\frac{1}{2}$
2. E $\frac{1}{2}$
3. S $\frac{1}{2}$
4. W $\frac{1}{2}$
5. NE $\frac{1}{4}$
6. SE $\frac{1}{4}$
7. SW $\frac{1}{4}$
8. NW $\frac{1}{4}$
9. C

I. SITE I.D.

II. SITE DESCRIPTION

FEATURE TYPE	CULTURAL MATERIAL	<u>32</u> Site Type
<input type="checkbox"/> Cm Scatter	<input type="checkbox"/> Bone	<u>56</u> Context
<input type="checkbox"/> Chimney	<input type="checkbox"/> Ceramics	_____ Site Area
<input type="checkbox"/> Depression	<input type="checkbox"/> Charcoal	<i>m. x m.</i>
<input type="checkbox"/> Dump	<input type="checkbox"/> Cloth	_____ Cultural Depth <i>cm.</i>
<input type="checkbox"/> Earthworks	<input type="checkbox"/> Faunal Remains	<input type="checkbox"/> Depth Indicator
<input type="checkbox"/> Fortification	<input type="checkbox"/> Fire Cracked Rock	Occupation Date
<input type="checkbox"/> Foundation	<input type="checkbox"/> Floral Remains	Begin _____ End _____
<input type="checkbox"/> Grave	<input type="checkbox"/> Glass	_____ Basis For Dating
<input type="checkbox"/> Hearth	<input type="checkbox"/> Hide, Hair, Fur	<input type="checkbox"/> Cm Density
<input type="checkbox"/> Machinery	<input type="checkbox"/> Human Remains	<input type="checkbox"/> Isolated Find
<input type="checkbox"/> Quarry/Mine	<input type="checkbox"/> Masonry	
<input type="checkbox"/> Rock Art	<input type="checkbox"/> Metal	
<input type="checkbox"/> Trail	<input type="checkbox"/> Plastic	
<input type="checkbox"/> Wreck	<input type="checkbox"/> Rubber	
<input type="checkbox"/> Other	<input type="checkbox"/> Shell	
	<input type="checkbox"/> Wood	
	<input type="checkbox"/> Other	

III. ENVIRONMENT

Landform 1 _____ Landform 2 _____ Slope/Exposure _____ Ecosystem _____
 Landform 1 _____ Landform 2 _____ Slope/Exposure _____ Ecosystem _____
 Elevation _____ Drainage System _____ View, Degree _____ View, Distance _____
 _____ m. _____
 Dist Perm Water _____ Perm Water Type _____ Dist Seas Water _____ Seas Water Type _____
 _____ m. _____

IV. C.R.M.

Ownership _____ Ownership _____
 _____ Fieldwork Date _____ Fieldwork Date _____
 Site Condition _____ Collection _____ Test/Probe _____ Excavation _____
 Additional Information _____ Management Recommendation _____

SHSND USE

Soil Association _____ Ecozone _____ Area Signf _____ MS Number _____
 Soil Association _____ Ecozone _____ Area Signf _____ MS Number _____
 CR Type _____ Verified Site _____ Non-Site _____ E C F _____ T F _____
 State Registry _____ National Register _____

Coder _____ Date Coded _____

**FIELD MANUAL
NDCRS HISTORICAL ARCHEOLOGICAL SITE FORM**

I. SITE DESCRIPTION
II. ENVIRONMENT
III. C.R.M.
IV. OFFICE

- FEATURE TYPE**
0 or blank. Absent
1. Present
2. Probable
- CULTURAL MATERIAL**
0 or blank. Absent
1. Present
2. Probable
- DEPTH INDICATOR**
0. Not applicable
1. Auger
2. Cutbank or erosional feature
3. Excavation
4. Guess
5. Shovel
6. Soil Probe
7. Other
- BASIS FOR DATING**
0. Unknown
1. Date Unknown
2. Radiocarbon

3. Typology
4. Dendrochronology
5. Thermoluminescence
6. Geology
7. Patination
8. Professional Judgement
9. Both Absolute & Relative
10. Documentation
11. Interview
12. Other
- CM DENSITY**
0. No cultural material
1. Sparse distribution
2. Medium distribution
3. Dense distribution
4. (Category eliminated)
5. Medium-dense concentration(s) within a sparse scatter
6. Dense concentration(s) within a medium scatter
7. Denser concentration(s) within a dense scatter
8. Isolate

- AGRICULTURE**
62 Animal Shelter/Stable
62 Barn
92 Blacksmith Shop
66 Chicken Coop/Poultry House
3 Clinic, Animal/Veterinarian
43 Corral/Enclosure/Pen
70 Experiment Station
5 Farm, Dairy
1 Farm/Armsstead
61 Granary/Bin
91 Greenhouse/Nursery
12 Hatchery, Ann'l/Blrd/Fish
67 Ice/Saute House/Root Cellar
64 Line Shack
14 Pump/Well
77 Pump House/Well House
4 Ranch
61 Silo/Silage Pit
13 Stock Dam
15 Storage Building
16 Storage Yard
69 Summer Kitchen
14 Well/Pump
17 Windmill
71 Work shop
30 Workshop
- ARTS AND ENTERTAINMENT**
75 Auditorium/Lecture Hall
74 Cinema/Theater
75 Lecture Hall
99 Museum/Gallery
75 Opera House
73 Studio, Photo/Art/Sculpt
74 Theater
- COMMERCE**
76 Bank/S & L/Financial
68 General Store
47 Shopping Center/Mall
47 Store, Retail
68 Trading Post
15 Warehouse
- COMMUNICATIONS**
87 Newspaper Office
87 Print Shop
85 Radar Facility
93 Radio/TV Station
89 Teleph./Telegr. Facil.
17 Tower, Radio/TV/Microwave
- EDUCATION**
19 Business College
75 Class Room/Lecture Hall
19 College/University
70 Laboratory
20 Library
19 School
19 Seminary
19 Trade/Technical School
- ENGINEERING**
21 Bridge/Trestle
22 Canal/Flume

- SITE TYPE**
13 Dam
17 Tower
- FOOD SERVICE**
91 Bakery
28 Bar/Tavern
24 Bottling Plant
24 Brewery/Distillery
90 Butcher Shop
25 Cannery
97 Creamery
97 Dairy Processing Plant
25 Frozen Food Locker
26 Grocery Store
90 Meat Packing Plant
27 Mill, Grist/Flour
23 Restaurant/Cafe/Mess Hall
25 Sugar Refinery
- FUNERARY**
29 Cemetery
78 Gravestone
78 Memorial
78 Monument
29 Mortuary
- GOVERNMENT**
37 Border Crossing Station
30 City Hall
84 Correctional Facility/Jail
59 Courthouse
32 Customs House
58 Fire Station
59 Government Office
86 Indigent Home
86 Orphanage
33 Pest House
32 Police Station
18 Post Office/Mail Station
10 Sanitary Land Fill
10 Sewage Treatment Plant
32 Sheriff's Office
73 Township Hall
9R Water Treatment Plant
- HEALTH CARE**
33 Clinic/Dispensary
33 Hospital/Infirmary
86 Nursing Home
- INDUSTRIAL**
34 Brick Manufacturing Plant
88 Bulk Plant
34 Concrete Mfg. Plant
31 Elect. Gen. Facility
36 Elect. Transform. Facility
38 Elect. Transmiss. Facility
34 Factory/Foundry
96 Gas Storage
96 Gas Transmission Facility
14 Gas Well
11 Grain Storage, Commercial
36 Lumber Yard
37 Mill, Saw
37 Mill, Stamp/Minerals Refin.

- 35 Mine/Quarry
96 Oil Refinery
58 Oil Tank Battery
96 Oil Transmission Facility
14 Oil Well
96 Pipeline
71 Repair Shop
16 Storage Yard
38 Tipple
15 Warehouse
92 Welding/Blacksmith Shop
- LANDSCAPE ARCHITECTURE**
78 Fountain
78 Garden
78 Monument
39 Park
- MILITARY**
75 Armory
60 Battlefield
79 Bastion
79 Blockhouse
44 Camp Site, Temporary
8 Camp, Semi-Permanent
79 Defensive Works
8 Fort/Cantonment/Post/Base
79 Missile Site
39 Pallisade
39 Parade Ground
59 Post/Base Exchange (PI/BX)
79 Powder Magazine
51 Rifle Range
68 Suttler's Store
48 Trail
- OFFICE/HEADQUARTERS**
45 Administrative
45 Business
80 Fraternal/Sororal
80 Lodge
45 Organizational
46 Professional
80 Social
- RECREATION/SPORTS**
57 Arcade/Casino
32 Billiard Parlor/Pool Hall
57 Boat Landing, Recreational
51 Camp/Picnic Grounds
94 Fairgrounds
91 Grandstand
51 Playground
52 Recreation Area, Indoor
51 Recreation Area, Outdoor
51 Resort
94 Rodeo Grounds
95 Sport Facility, Indoor
81 Sport Facility, Outdoor
- RELIGIOUS**
54 Chapel, Non-Denom.
9 Church School
53 Church, Catholic
63 Church, Protestant
42 Convent/Monastery
30 Fellowship Hall
40 Parsonage/Manse/Rectory
19 Seminary
78 Shrine
54 Synagog
- RESIDENTIAL**
41 Barracks/Dorm./Bunk House
41 Dwelling, Double Unit
42 Dwelling, Multiple Unit
40 Dwelling, Single Unit
55 Garage/Carriage House
64 Hotel/Motel/Inn
65 Mobile Home
50 Privy
- TRANSPORTATION**
49 Airport/Airfield/Land, Fld.
56 Boat Landing, Com'l/Steam
57 Boat Landing, Recreational
21 Bridge/Trestle
59 Depot/Terminal
82 Ferry
82 Ford
72 Freight Yard
8R Fuel Station/Yard, Coal/Wood, etc.
RR Gasoline Station
55 Hanger
48 Highway
62 Livery
70 Loading Platform
48 Railroad Grade/Tracks
56 Rest Stop
4R Road
73 Roundhouse
48 Siding
78 Signal
62 Stable
48 Spur
56 Stage Station
72 Switch Yard
48 Trail
82 Tunnel
83 Turn-around
- MISCELLANEOUS**
72 Accident/Disaster Site
10 Dump
73 Spring
77 Spring House
17 Tower
7 Town/City/Colony/Settlement
99 Other

- CONTEXT**
- | | |
|------------------------------|----------------------------|
| 1 Aviation | 17 Government, State |
| 2 Bridges | 18 Government, Local |
| 3 Colonization | 19 Horticulture |
| 4 Commerce | 20 Industrial Development |
| 5 Communications | 21 Irrigation and Conserv. |
| 6 Depression, the Great | 22 Military |
| 7 Education | 23 Mining, Coal |
| 8 Energy Development | 24 Petroleum |
| 9 Entertainment | 25 Railroads |
| 10 Exploration | 26 Ranching, Open Range |
| 11 Farming, Bonanza | 27 Ranching, Fee Simple |
| 12 Farming, Dairy | 28 Religion |
| 13 Farming | 29 Roads, Trails, and Hwy. |
| 14 Fur Trade | 30 Rural Settlement |
| 15 Governmental, National | 31 Urban Settlement |
| 16 Governmental, Territorial | 32 Water Navigation |

LANDFORM 1	LANDFORM 2	SLOPE/EXPOSURE	VIEW, DEGREE
1. Top of	1. Beachline (glacial)	10. Ridge	1. 90°
2. Bottom of	2. Beach or riverbank	11. Saddle	2. 180°
3. Side of	3. Canyon	12. Sandbar	3. 270°
4.	4. Island	13. Spur	4. 360°
5. Top and Bottom of	5. Delta	14. Swale	5. No View
6. Top and Side of	6. Draw	15. Terrace	
7. Bottom and Side of	7. Upland plain	16. A. Fan	
8. Top, Bottom, & Side	8. Floodplain	17. Butte	
VIEW, DISTANCE	9. Hill-Knoll-Bluff	18. F. Slope	8. Northwest
1. Excellent (5-7miles)	9. Hill-Knoll-Bluff	19. Other	9. Closed
2. Good (2-5 miles)	20. Dune	20. Dune	10. Open
3. Fair (1-2 miles)	21. Lacustrine Plain		
4. Poor (less than 1 mile)	22. River Levee		
5. No View			
OWNERSHIP	1. Lake	ECOSYSTEM	15. Chopy Sandhills
1. State	2. Spring	0. Unknown	16. Savanna
2. Federal	3. Moving Water (Stream)	1. Bottomland	17. Mixed Grass Prairie-Dry
3. Private	4. Intermittent Stream	2. Terraces	18. Mixed Grass Prairie-Wet
4. Local Government	5. Intermittent Pond	3. Toe Slope	19. River Terrace and Bottom Lands
5. Reservation	6. Marsh	4. Scarps	
MANAGEMENT RECOMM.		5. Bedlands	
1. No Further Work	SITE CONDITION	6. Upland Grassland	
2. Further Work	0. No Cultural Material		
3. Impact Analysis	1. Destroyed	COLLECTION	
4. Both 2 & 3	2. Inundated	0. No Cultural Material	
5. Avoidance-Mitigation	3. Very Poor	1. CM but No Collection	
6. Exclusion-Preservation	4. Poor	2. Systematic Collection	
AREA SIGNF.	5. Fair	3. Non-Systematic	
1. Archeological	6. Good	4. Completely Collected	
2. Architectural	7. Excellent		
3. Historical		TEST & EXCAVATION	
4. Paleontological		0. No	
	CR TYPE	1. Yes, Results Positive	
	0. Unknown	2. Yes, Results Negative	
	1. Site		
	2. Building		
	3. Structure		
	4. Object		
	5. District		
		NATIONAL & STATE REGISTER	
		0. Undetermined	
		1. Listed	
		2. Nominated	
		3. Eligible	
		4. Not Eligible	
		5. Determined Eligible	
		6. Eligible as Part of a District	
		E C F AND T F	
		1. Exclusion Area	
		2. Avoidance Area	
		3. Area of Concern	

NDCRS ARCHEOLOGICAL AND HISTORICAL SITE FORM

Field Code 32WAX184

Descriptive Section

SITS Number 32WA7 - UPDATE

Page 2

1. **Access** Proceed north from Grand Forks on Interstate 29 to the Highway 17/Grafton exit. Go one mile east, then 1.5 miles south, passing an old school house on the east side of the road. Turn east on the first approach past the school house and follow this trail into the farm yard. This area is the southeast portion of the Acton townsite.
2. **Description of Site** This site consists of the Acton townsite (32WA7, site lead 32WAX75), the remnants of the Acton steamboat landing, and a small portion of a trail that is believed to be part of the Winnipeg to Fargo stage line, originally probably part of the "River Trail" oxcart trail (site lead 32WAX184). The community of Acton also contained the Blakely and Carpenter Stage Line's Acton Stage Station (site lead WAX76).

This form is intended mainly to update the information on the archaeological remains of Acton; the townsite once covered a larger area than was mapped in detail by the Larson-Tibesar crew. Architectural remains, including a school house and the abandoned Hoenke farmstead, are present within the townsite and the information on this part of the site also needs to be updated. These, however, were beyond the scope of the present oxcart trail study. These areas have been indicated on the attached maps and included within the site area calculations.

3. **Description of Cultural Materials (Quantify and identify)** An area of raised earth (Feature 1; probably representing the footprint of a large commercial building), at least two depressions (Features 2 and 4), and a rubble mound (Feature 3; probably associated with the demolition of the building at Feature 2), were noted within the mapped area of the townsite. Feature 1 is approximately 60 by 60 feet. Feature 2 is 36 feet in diameter and 15 inches deep. Feature 3 is 20 by 33 feet. Feature 4 is 21 feet in diameter and 16 inches deep. What is believed to be a segment of the stage road enters Acton from the north. This segment is 25 meters long. The trough to trough width of this ruts is 48 inches and they are approximately 6 inches deep. The Acton landing, approximately 90 meters long, is still clearly visible in the form of a trail leading from the east side of the townsite northeast down the river bank and terminating at the Red River. In addition to these trail and building remains, a small but fairly dense scatter of historic artifacts was noted in the southeastern corner of a cultivated field, in between the intact portions of the townsite and the trail ruts recorded. These artifacts include bone fragments, white glazed crockery and aquamarine tinted bottle fragments, at least one of which has a hand applied finish. A small sample of the crockery and bottle glass was collected.

of items of cultural material observed 100+

Collected 3

4. **Artifact Repository** to be returned to the landowner

NDCRS ARCHEOLOGICAL AND HISTORICAL SITE FORM

Field Code 32WAX184

Descriptive Section

SITS Number 32WA7 - UPDATE

Page 3

5. Description of Subsurface Testing none
6. Field Conditions dry, bright sun
7. Technique(s) Used to Estimate Site Area transit and historic records
8. Rational for Site Boundary Determination materials, features, and historic records
9. Current Use of Site hay meadow, farmstead, cultivated field, and river bank
10. Owner's Name/Address Earl and Grace Schultz, Rural Route, Grafton.
11. Vegetation hay meadow, cultivated field, shelterbelts, and riverside timber and brush
12. Vegetation Cover (% of visible ground) 60 percent visible ground
13. Snow Cover (% visible) no snow, 100 % visible
14. Man-hours spent on site 12
15. Project Title A Phase II Investigation of Oxcart Trails, Pembina and Walsh Counties, North Dakota; LTA Project 931012a
P.I. Thomas K. Larson and Dori M. Penny
16. Report Title Same as above
Author Larson et al.
17. Other Published References
Biggs, Barbara, Kenneth L. Brown, and Marie E. Brown
1984 Phase I Archaeological and Historical Resources Investigations for the Red River of the North Ring Levee Project, Pembina and Walsh Counties. Submitted to the St. Paul District, US Army Corps of Engineers.

Ritterbush, Lauren W.
1991 The Fur Trade of Northeastern North Dakota: The 1990 Fur Trade Sites Project. Department of Anthropology, University of North Dakota, Grand Forks. Submitted to the State Historical Society of North Dakota, Bismarck.

Vyzralek, Frank E.
1993 Red River Oxcart Trails in Pembina and Walsh Counties, North Dakota. Great Plains Research, Bismarck, North Dakota. Report submitted to the Red River Regional Council, Grafton, North Dakota.

NDCRS ARCHEOLOGICAL AND HISTORICAL SITE FORM

Field Code 32WAX184

Descriptive Section

SITS Number 32WA7 - UPDATE

Page 4

18. Description of Collections Observed none
19. Owner-Address of Collections Observed none
20. Statement of Integrity Major portions of the Acton Townsite, including the landing, have never been in cultivation and are being preserved by the Schultz family; only a small portion of the original townsite appears to be in cultivation. Approximately 25 meters of intact trail ruts were recorded on the north end of the site. These are reasonably well preserved. Their appearance is probably more related to the trail's use as a stage line rather than the original oxcart trail. It is very likely, however, that this line closely followed the earlier oxcart trail.
21. Statement of Significance The Acton townsite retains very good physical integrity and the site's history is important to the settlement of northeastern North Dakota. This entire site area is believed to be eligible for nomination to the National Register of Historic Places. Additional recording should be undertaken here. Archaeological testing may be warranted to determine the nature of the subsurface deposits in the northern part of the site, especially those areas that have been disturbed by cultivation.
22. Comments/References

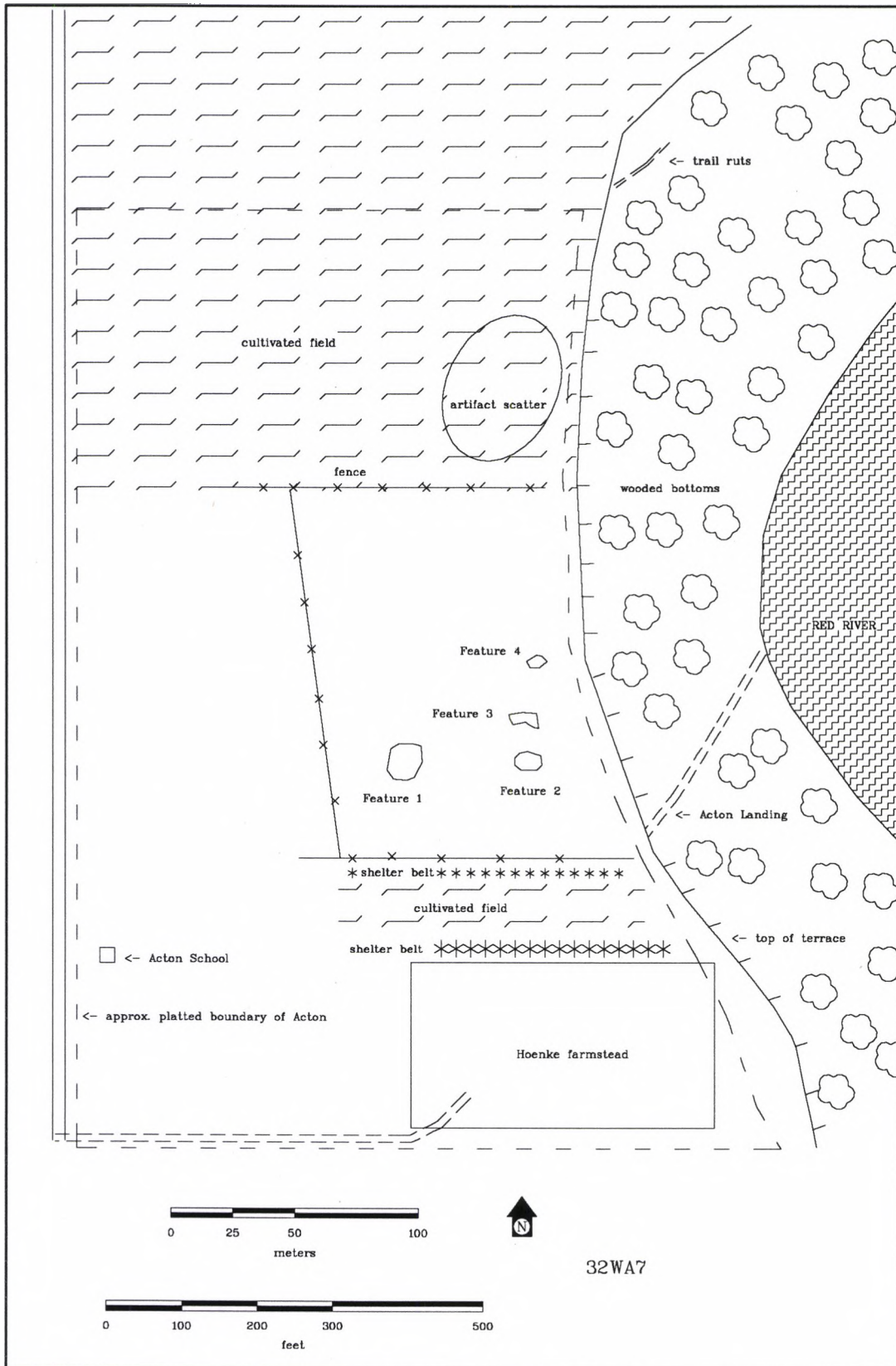

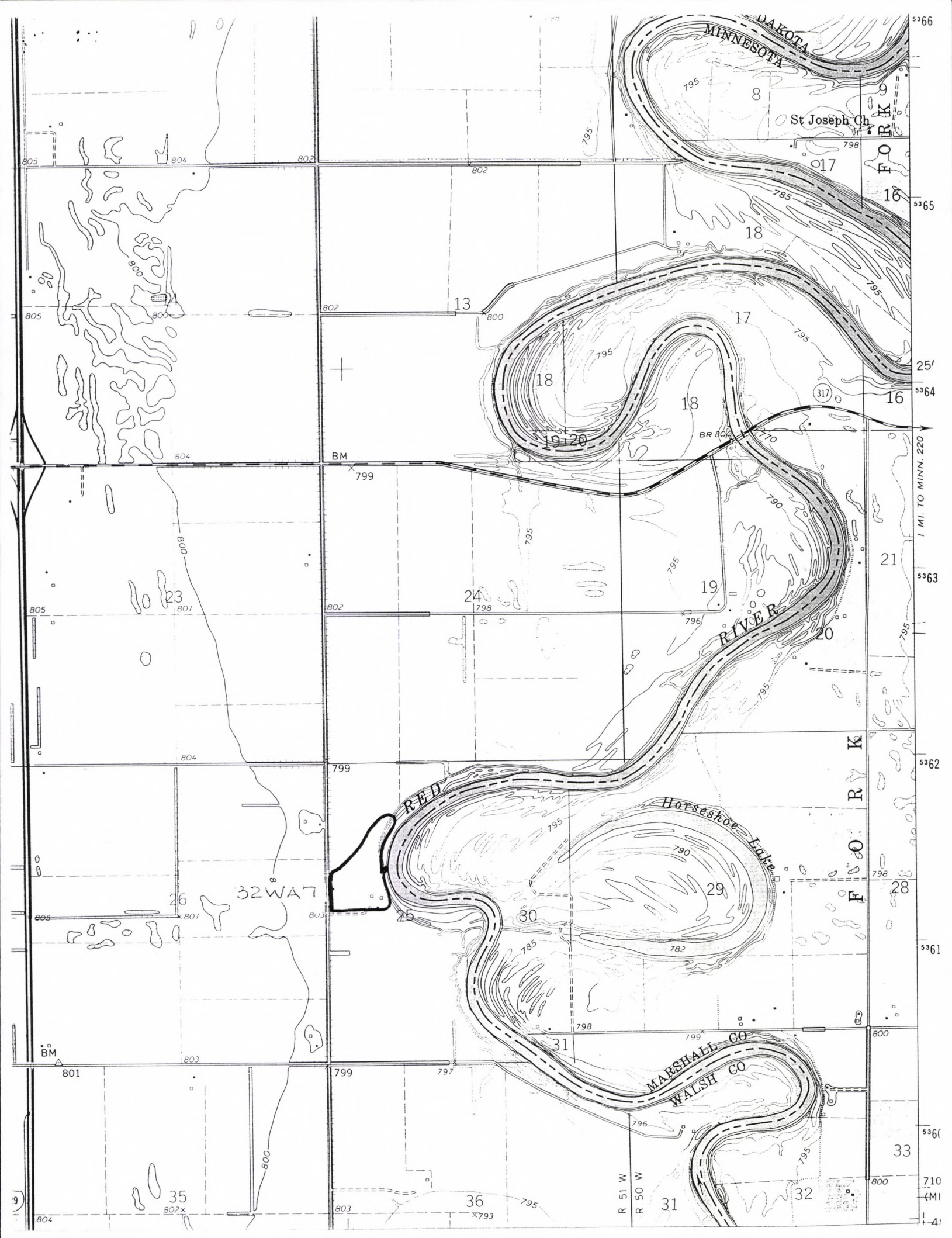

Photo I.D. Code 931012a, Roll 1

Storage Location Larson-Tibesar Associates, Inc., 421 S. Cedar St., Laramie, WY 82070



overview of central portion of Acton townsite, frame 7, view northwest



trail segment, frame 3, view north

Photo I.D. Code 931012a. Roll 1

Storage Location Larson-Tibesar Associates, Inc., 421 S. Cedar St., Laramie, WY 82070



Acton landing, frame 2, view northeast



Feature 1, frame 4, view southwest

Photo I.D. Code 931012a, Roll 1

Storage Location Larson-Tibesar Associates, Inc., 421 S. Cedar St., Laramie, WY 82070



Features 2 and 3, frame 5, view northwest



Feature 4, frame 6, view northwest

UPDATE

UPDATE

SITS # 32 WA 7
State County Site Number

- 1. N
- 2. E
- 3. S
- 4. W
- 5. NE
- 6. SE
- 7. SW
- 8. NW
- 9. C

Field Code _____ Site Name ACTION TOWNSITE

Field Code _____ Site Name _____

Map Quad B.I.G. WOODS, N.W.

Map Quad _____

LTL	<input type="checkbox"/>	Twp	<u>5.7</u>	R	<u>5.1</u>	Sec	<u>2.5</u>	QQQ	<input type="checkbox"/>	QQ	<u>7</u>	Q	<u>8</u>
LTL	<input type="checkbox"/>	Twp	_____	R	_____	Sec	_____	QQQ	<u>3</u>	QQ	<u>8</u>	Q	<u>8</u>
LTL	<input type="checkbox"/>	Twp	_____	R	_____	Sec	_____	QQQ	<input type="checkbox"/>	QQ	<input type="checkbox"/>	Q	<input type="checkbox"/>
LTL	<input type="checkbox"/>	Twp	_____	R	_____	Sec	_____	QQQ	<input type="checkbox"/>	QQ	<input type="checkbox"/>	Q	<input type="checkbox"/>
LTL	<input type="checkbox"/>	Twp	_____	R	_____	Sec	_____	QQQ	<input type="checkbox"/>	QQ	<input type="checkbox"/>	Q	<input type="checkbox"/>
LTL	<input type="checkbox"/>	Twp	_____	R	_____	Sec	_____	QQQ	<input type="checkbox"/>	QQ	<input type="checkbox"/>	Q	<input type="checkbox"/>

I. SITE I.D.

FEATURE TYPE	CULTURAL MATERIAL	<input type="checkbox"/> <u>7</u> Site Type
<input checked="" type="checkbox"/> Cm Scatter	<input type="checkbox"/> Bone	
<input type="checkbox"/> Chimney	<input checked="" type="checkbox"/> Ceramics	<input checked="" type="checkbox"/> <u>3.1</u> Context
<input checked="" type="checkbox"/> Depression	<input type="checkbox"/> Charcoal	
<input type="checkbox"/> Dump	<input type="checkbox"/> Cloth	<input type="checkbox"/> <u>243.065</u> Site Area
<input type="checkbox"/> Earthworks	<input checked="" type="checkbox"/> Faunal Remains	<i>m. x m.</i>
<input type="checkbox"/> Fortification	<input checked="" type="checkbox"/> Fire Cracked Rock	<input type="checkbox"/> Cultural Depth <i>cm.</i>
<input type="checkbox"/> Foundation	<input type="checkbox"/> Floral Remains	
<input checked="" type="checkbox"/> Grave	<input checked="" type="checkbox"/> Glass	<input type="checkbox"/> Depth Indicator
<input type="checkbox"/> Hearth	<input type="checkbox"/> Hide, Hair, Fur	
<input type="checkbox"/> Machinery	<input type="checkbox"/> Human Remains	Occupation Date
<input type="checkbox"/> Quarry/Mine	<input checked="" type="checkbox"/> Masonry	Begin <u>1871</u> End <u>1923</u>
<input type="checkbox"/> Rock Art	<input checked="" type="checkbox"/> Metal	Basis For Dating
<input type="checkbox"/> Trail	<input type="checkbox"/> Plastic	<u>1.0</u>
<input type="checkbox"/> Wreck	<input type="checkbox"/> Rubber	<input checked="" type="checkbox"/> <u>5</u> Cm Density
<input type="checkbox"/> Other	<input type="checkbox"/> Shell	
	<input checked="" type="checkbox"/> Wood	
	<input type="checkbox"/> Other	<input type="checkbox"/> Isolated Find

II. SITE DESCRIPTION

<input checked="" type="checkbox"/> Landform 1 <u>2.1</u>	Landform 2 <u>1.0</u>	Slope/Exposure	<input type="checkbox"/> <u>1.8</u> Ecosystem
<input type="checkbox"/> Landform 1 _____	Landform 2 _____	Slope/Exposure	<input type="checkbox"/> _____ Ecosystem
Elevation	Drainage System	View, Degree	View, Distance
<u>243</u> m.	<u>RED RIVER</u>	<u>4</u>	<u>1</u>
Dist Perm Water	Perm Water Type	Dist Seas Water	Seas Water Type
<u>1.0</u> m.	<u>3</u>	<u>1.0</u> m.	<u>3</u>

III. ENVIRONMENT

<input checked="" type="checkbox"/> <u>3</u> Ownership	<input type="checkbox"/> Ownership
<u>10711719.0</u> Fieldwork Date	<u>10910619.0</u> Fieldwork Date
<u>5</u> Site Condition	<input checked="" type="checkbox"/> Collection
	<input type="checkbox"/> Test/Probe
	<input checked="" type="checkbox"/> Excavation
Additional Information	<u>5</u> Management Recommendation

IV. C.R.M.

<input type="checkbox"/> Soil Association	<input checked="" type="checkbox"/> <u>1.0</u> Ecozone	<input checked="" type="checkbox"/> <u>3</u> Area Signf	MS Number
<input type="checkbox"/> Soil Association	<input type="checkbox"/> Ecozone	<input type="checkbox"/> Area Signf	MS Number
<input checked="" type="checkbox"/> CR Type	<input checked="" type="checkbox"/> Verified Site	<input type="checkbox"/> Non-Site	<input checked="" type="checkbox"/> <u>2</u> E C F
	<input type="checkbox"/> State Registry	<input type="checkbox"/> National Register	<input checked="" type="checkbox"/> <u>3</u> T F

SHSND USE

Coder L. Ritterbush + C. Kordocki

Date Coded Sept. 19, 1990

NDCRS ARCHEOLOGICAL AND HISTORICAL SITE FORMS

Field Code

Descriptive Section

SITS Number 32WA7

Page 2

1. Access From U.S. Interstate I-29 exit onto North Dakota highway 17 (south of the crossing of the Park River). Drive one mile east on highway 17. Turn south onto gravel county road 2. Drive south 1 1/4-1 1/2 miles. Acton occupied the east side of the road between county road 2 and a bend in the Red River.

2. Description of Site This is the site of an abandoned town dating to the late nineteenth and early twentieth centuries. Nearly all of the original structures have been removed from the site, although the schoolhouse still stands and some building foundations are still evident as depressions at the site. Much of the townsite of Acton remains uncultivated through the preservation efforts of the current and past landowners. Most of the original 40 acre townsite is now in prairie grass, which is mowed annually by the present landowner, and dense stands of trees. The 20 acre "Girard Addition" to the north is in cultivation, as well as portions of the more central part of the townsite. A light scatter of historic artifacts in the field north of the unplowed central section of the town, especially atop the bank of the lower terrace of the Red River, documents the extent of the townsite into the "Girard Addition". The schoolhouse still stands on Lot 19 and is probably the only original structure still standing on the site. A recently collapsed wooden building (store?) is reported to also have been an original structure. An abandon house, barn, sheds, and outbuildings also stand at the site, but they form the Hoenke farmyard, which postdates Acton's history as a thriving river town.

3. Description of Cultural Materials (quantify and identify)

of items of cultural material observed

collected

4. Artifact Repository

5. Description of Subsurface Testing

Recorded by C. Kordecki & L. Ritterbush

Date 7/17 & 9/6/1990

NDCRS ARCHEOLOGICAL AND HISTORICAL SITE FORMS

Field Code

Descriptive Section

SITS Number 32WA7

Page 3

6. Field Conditions

Wet___, Dry_X_, Windy___, Raining___, Snowing___, Overcast___,
Bright Sun_X_, Twilight___

7. Technique(s) Used to Estimate Site Area

Transit___, Tape Measure___, Paced___, Visual Estimate___,
Other (explain)

8. Rationale for Site Boundary Determination

Surface Cultural Materials_X_, Features_X_, Topography___,
Continuous Stratigraphic Exposure___,
Systematic Subsurface Probing___, Subsurface Testing___,
Other (explain) documentation

9. Current Use of Site Much of the site is uncultivated, except for a small portion near its center, around the school, and in the northern portion of the site.

10. Owner's Name/Address

Earl and Grace Schultz & Loren Schultz
RR3 Box 82; Grafton, ND

11. Vegetation

prairie grass, trees, wheat and barley stubble

12. Cover (% of visible ground)

0% grass/trees, 40-100% cultivated

13. Snow Cover (% visible)

none

14. Person-hours spent on site

4 (estimated)

15. Project Title

Survey of Fur Trade Sites in Northeastern North Dakota
P.I. Drs. Lauren W. Ritterbush & Fred Schneider

16. Report Title

Authors

17. Other Published References

Biggs, Barbara, Kenneth L. Brown, and Marie E. Brown 1984 Phase I Archaeological and Historical Resources Investigations for the Red River of the North Ring Levee Project, Pembina and Walsh Counties, North Dakota. Report submitted to the U.S. Army Corps of Engineers, St. Paul District.

Berg, Gunder V. (editor) 1976 Walsh Heritage, Walsh County, North Dakota. Volume one. Grafton: Walsh County Historical Society.

18. Description of Collections Observed

none

19. Owner-Address of Collections Observed

NDCRS ARCHEOLOGICAL AND HISTORICAL SITE FORMS

Field Code

Descriptive Section

SITS Number 32WA7

Page 4

20. **Statement of Integrity** All the original buildings of Acton, except the schoolhouse (built in 1882) have been moved or have collapsed. Nonetheless, much of the site area has not experienced surface or subsurface disturbance. The potential for intact surface remains is high as evident from several depressions and artifact scatters at the site. The present landowners try to maintain the land with little disturbance, thus, integrity is good.

21. **Statement of Significance** Acton played an important role in the early Euroamerican settlement and expansion in Walsh County and northeastern North Dakota. As a major steamboat stop on the Red River, Acton had an active role in the transportation of people and goods into the Red River region during the years from about 1880 to the earliest 1900s. It has been noted (Berg 1976) that Viljhamer Stefanson, a well-known Arctic explorer, taught in the Acton school (School District 15) in 1900 and 1901. This school continued to be used until 1956 and the building is still intact. The possibility of human burials within the townsite property (Biggs et. al 1984) lends the site additional significance, as does the possibility that this was also the site of Roy's fur trade post from 1797-1798, as documented in the journals of Charles Chaboillez and David Thompson of the North West Company.

22. **Comments/References** This site was revisited by this project in order to look for possible fur trade artifacts or features that may be related to Roy's post. It is likely that Roy's post was located at or near this site although no material evidence for this could be found. It may be buried beneath or destroyed by the town of Acton, although this has not been definitely ascertained from historic documents or archaeological survey.

Together Acton and the townsite of St. Andrew to the north (at the mouth of the Park River) form an interesting part of North Dakota's history, which is often overlooked.

The book To the Arctic by Jeannette Mirsky (and others) document the contribution of the individual Viljhamer Stefanson, who spent some time at Acton and who later was an very important arctic explorer.

Photos taken at the site of Acton include BW1-1,2,3,4 (attached) and CS1-1,2,3,4 (on file at the State Historical Society of North Dakota).

Photocopy the portion of the 7.5' U.S.G.S. topographic quadrangle that shows the location of the site and surrounding area. Mark the boundaries of the site on the photocopy. Photocopy of the portion of the topographic quadrangle must be actual size, reductions or enlargements are unacceptable.

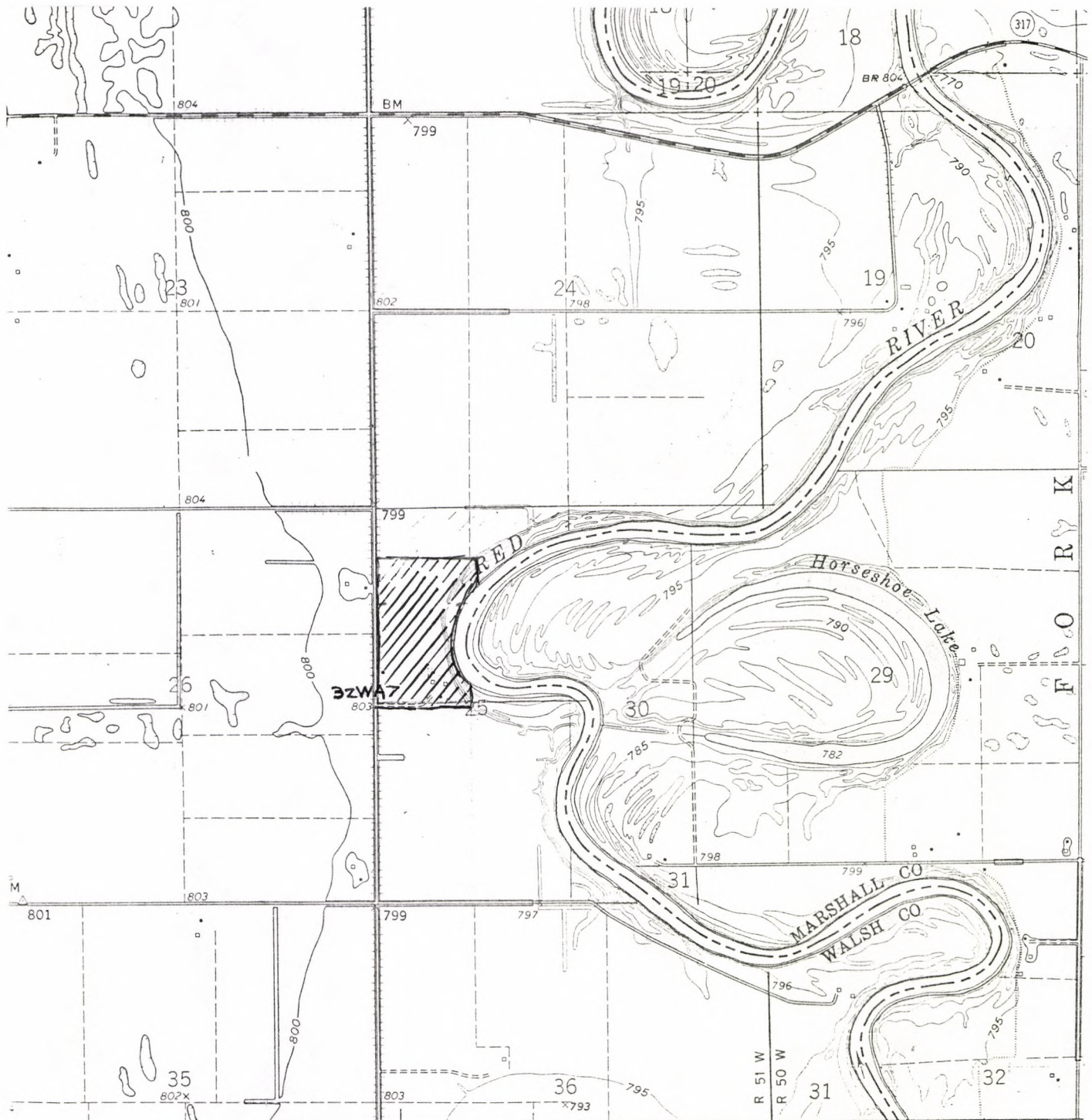

BIG WOODS N.W., N.DAK. Quadrangle 7.5'

1 mile



HPB-90-BW1

Photo I.D. Code 1990 Fur Trade Sites Project: Black & White roll 1, negatives 1-2
Storage Location State Historical Society of North Dakota
Include direction facing, feature number, . and photo caption for each submitted photograph.



ABOVE: BW1-1 Acton townsite (Hoenke farmstead), 32WA7. View NE of farmstead. Abandoned house to right. Fallen structure reported to be original town building. July 17, 1990

BELOW: BW1-2 Acton townsite (Hoenke farmstead), 32WA7. View WSW of outbuildings. (Fallen structure off left side of photo. July 17, 1990



Photo I.D. Code 1990 Fur Trade Sites Project; Black & White roll 1, negatives 3-4
Storage Location State Historical Society of North Dakota
Include direction facing, feature number, and photo caption for each submitted photograph.



ABOVE: BW1-3 Acton townsite, 32WA7. View NE of depression (north of Hoenke farmstead).
July 17, 1990

BELOW: BW1-4 Acton townsite, 32WA7. View E, close-up of depression (same as above.).
July 17, 1990



I. SITE I.D.

Field Code <u>USD-177</u>	SITS # State <u>32</u> County <u>WA</u> Site Number <u>7</u>
Site Name <u>ACTON</u>	LTL Twp R Sec QQQ QQ Q <u>157</u> <u>51</u> <u>25</u> <u>—</u> <u>Z</u> <u>8</u>
Map Quad <u>BIG WOODS NW</u>	LTL _a Twp _a R _a Sec _a QQQ _a QQ _a Q _a <u>—</u> <u>—</u> <u>—</u> <u>—</u> <u>—</u> <u>—</u> <u>—</u>

1. N½
2. E½
3. S½
4. W½
5. NE¼
6. SE¼
7. SW¼
8. NW¼
9. C

II. SITE DESCRIPTION

City <u>ACTON</u>	Site Area <u>988000</u> m ²		
Street # <u>—</u>	Street Name <u>—</u>		
Feature # <u>—</u>	# of Features <u>4</u>	Theme 1 <u>10</u>	Theme 2 <u>—</u>
Orig Use 1 <u>10A</u>	Orig Use 2 <u>20</u>	Pres Use 1 <u>1</u>	Pres Use 2 <u>—</u>
Year Constructed <u>1879</u>	Dating Technique <u>6</u>	Ethnic <u>18</u>	Style <u>3</u>
Structural Comp <u>15</u>	Exterior Finish 1 <u>19</u>	Exterior Finish 2 <u>—</u>	
Architect/Builder <u>—</u>			

IV. C.R.M.

Ownership <u>3</u>	Site Condition <u>6</u>	Collection <u>1</u>	Test <u>0</u>	Excavation <u>—</u>
Fieldwork Date <u>5.15.83</u>	Management Recommendation <u>4</u>			
Additional Information <u>TOWN SITE</u>				

OFFICE USE ONLY

Soil Association <u>—</u>	Ecozone <u>—</u>	Area Signf <u>Z</u>	CR Type <u>1</u>	Verified Site <u>1</u>	Non-Site <u>—</u>
State Registry <u>—</u>	National Register <u>—</u>	E C F <u>Z</u>	T F <u>Z</u>	MS Number <u>—</u>	

Coder _____

Date Coded _____

1. Access Go 3 miles south on Interstate 29 where it crosses the Park River.
Exit, go east 1 mile, turn south on gravel road, go south 1 mile. Site is
along west edge of the Red River, Between the river and the North-South section
road. The town site is in pasture and grass. An abandoned school stands
along side the section road, (east of road).
2. Description of Site The site covers an area of about 40 acres. The site
is in pasture and trees. A school and some town buildings are all that remain
standing of the town. An unmarked grave yard is reported to exist somewhere
within the town area. Acton was founded in 1879 and was the largest town
in North Dakota in 1881, but was abandoned by most residents 10 years later
when the railroad by-passed the town 8 miles further west at Minto. Most
of the town buildings were moved on sleds during the winter season, late 1880's.
3. List Feature(s) by Type & Number school-1, store-2, house-3, barn-4
4. Location Integrity: Original Site Moved (Note Dates) _____
5. Plan Shape: Apse & Narthex _____ Apse & Transept _____ Apical _____
 Circular _____ Cruciform _____ H-Shaped _____ Irregular _____ L-Shaped _____
 Narthex & Transept _____ Polygonal _____ Rectangular Square _____
 T-Shaped _____ U-Shaped _____ Other _____
6. Number of Stories all buildings are 1 story
7. Roof Shape: Dome _____ False Front _____ Flat _____ Gable Gable,
 Bellcast _____ Gable, Center _____ Gable, Cross _____ Gable, Hipped _____
 Gable, Offset _____ Gambrel _____ Hip _____ Hip, Bellcast _____ Hip,
 Gabled _____ Hip, Truncated _____ Mansard _____ Mansard, Bellcast _____
 Pyramidal _____ Quonset _____ Saltbox _____ Sawtooth _____ Shed _____
 Valuted/Arched _____ Other _____
8. Roof Material: Unknown _____ Asbestos Shingles _____ Asphalt, Roll
 Roofing _____ Asphalt, Shingles _____ Clay Tile _____ Earth/Clay _____
 Metal _____ Tarpaper _____ Wood Shingles Other _____
9. Basement : Yes _____ No Partial _____ Unknown _____
10. Basement or Foundation Material: Unknown _____ Brick _____ Clay Tile _____
 Concrete, Block _____ Concrete, Poured/Precast _____ Concrete,
 Simulated Stone Block _____ Earthen Brick/Adobe _____ Log _____
 Rammed Earth/Puddled Clay _____ Sod _____ Steel Frame _____ Stone, Cut _____
 Stone, Random _____ Stone, Slab Wood Other _____

11. Describe Alterations (Note Dates) Town founded 1879, abandoned in late 1880's/

12. Samples Collected none

13. Location of Samples _____

14. Owner's Name, Address, & Phone # Earl Schultz, Minto, N.D.

15. Previous Owners (Note Dates) _____

16. Map Sources Checked (Note Dates): Plat Map xxx County Atlas _____ Topographic
 Map xxx Sanborn Map _____ Other Insurance Map _____ Other _____
17. Other Historical Information _____

18. Project Title Red River Ring Levee Survey Project Supervisor(s) Kenneth Brown
19. Report Title Red River Ring Levee Survey Author(s) Ken and Marie Brown
20. Statement of Integrity Most of the town has been moved to other locations.
 A store, barn, house and school remain on the original town site. The house
 is abandoned. The house, barn and school appear to be in good condition, while
 the store is in poor condition.
21. Statement of Significance Acton was a major town for the first homesteaders who
 settled in northeastern North Dakota. It was a major town for steamboats on
 the Red River. The town, in 1881. had a population of over 400 people.
There is reported to be an unmarked cemetery in the town. This should be investigated
22. Comments/References It is recommended that further field investigations be made at the town site
 to locate the cemetery and placement of major buildings.

Recorded by Kenneth and Marie BrownDate June 5, 1983

**NDCRS SITE FORM
HISTORICAL ARCHEOLOGICAL SITES**

SITS # 32 WA X0075
State County Site Number

Field Code Site Name ACTON TOWNSITE
Field Code Site Name

Map Quad
Map Quad

LTL 0 Twp 157 Range 051 Section 25 QQQ 0 QQ 7 Q 8

1. N 1/2
2. E 1/2
3. S 1/2
4. W 1/2
5. NE 1/4
6. SE 1/4
7. SW 1/4
8. NW 1/4
9. C

FEATURE TYPE	CULTURAL MATERIAL	SiteType
0 CM Scatter	0 Bone	Context
0 Chimney	0 Ceramics	0 SiteArea
0 Depression	0 Charcoal	m. x m.
0 Dump	0 Cloth	0 Cultural Depth cm.
0 Earthworks	0 Faunal Remains	0 Depth Indicator
0 Fortification	0 Fire Cracked Rock	Occupation Date
0 Foundation	0 Floral Remains	Begin End
0 Graves	0 Glass	0 0
0 Hearth	0 Hide,Hair,Fur	Basis for Dating
0 Machinery	0 Human Remains	0 CM Density
0 Quarry/Mine	0 Masonry	0 Isolated Find
0 Rock Art	0 Metal	
0 Trail	0 Plastic	
0 Wreck	0 Rubber	
0 Other	0 Shell	
	0 Wood	
	0 Other	

Landform 1	Landform 2	Slope/Exposure	Ecosystem
Landform 1	Landform 2	Slope/Exposure	Ecosystem
Elevation:	Drainage System	View, Degree	View, Distance
0 m.	RED RIVER		
Dist Perm Water	Perm Water Type	Dist Seas Water	Seas Water Type
0 m.		0 m.	

Ownership	Ownership		
Fieldwork Date	Fieldwork Date		
Site Condition	Collection	Test/Probe	Excavation
Additional Information	Management Recommendation		
ANDREAS HISTORIC ATLAS DAKOTA 1884			

0 Soils	16 Ecozone	3 Area Signif	
0 Soils	Ecozone	Area Signif	E BENSON Coder
2 CR Type	0 Verified Site	0 Non-Site	3/10/1980 DateCoded
0 State Registry	0 National Register	3 E C F	3 T F
			Update

**NDCRS SITE FORM
HISTORICAL ARCHEOLOGICAL SITES**

SITS # 32 WA X0076
State County Site Number

Field Code Site Name STAGE STATION OF BYR

Field Code Site Name

Map Quad
Map Quad

LTL 0 Twp 157 Range 051 Section 25 QQQ 0 QQ 7 Q 8

1. N 1/2
2. E 1/2
3. S 1/2
4. W 1/2
5. NE 1/4
6. SE 1/4
7. SW 1/4
8. NW 1/4
9. C

FEATURE TYPE

CULTURAL MATERIAL

0 CM Scatter	0 Bone	SiteType
0 Chimney	0 Ceramics	Context
0 Depression	0 Charcoal	
0 Dump	0 Cloth	0 SiteArea
0 Earthworks	0 Faunal Remains	m. x m.
0 Fortification	0 Fire Cracked Rock	0 Cultural Depth cm.
0 Foundation	0 Floral Remains	
0 Graves	0 Glass	0 Depth Indicator
0 Hearth	0 Hide,Hair,Fur	Occupation Date
0 Machinery	0 Human Remains	Begin End
0 Quarry/Mine	0 Masonry	0 0
0 Rock Art	0 Metal	
0 Trail	0 Plastic	Basis for Dating
0 Wreck	0 Rubber	
0 Other	0 Shell	
	0 Wood	0 CM Density
	0 Other	0 Isolated Find

Landform 1 Landform 2 Slope/Exposure Ecosystem
Landform 1 Landform 2 Slope/Exposure Ecosystem

Elevation: Drainage System View, Degree View, Distance
0 m. RED RIVER

Dist Perm Water Perm Water Type Dist Seas Water Seas Water Type
0 m. 0 m.

Ownership

Ownership

Fieldwork Date

Fieldwork Date

Site Condition

Collection

Test/Probe

Excavation

Additional Information

Management Recommendation

REAP 1978

0 Soils 16 Ecozone 3 Area Signif
0 Soils Ecozone Area Signif E BENSON Coder
1 CR Type 0 Verified Site 0 Non-Site 3 E C F 3 T F 3/10/1980 DateCoded
0 State Registry 0 National Register Update