

NDCRS SITE FORM
ARCHITECTURAL SITES
Page 1

SITS # 32 WA 203

Field Code JKA02-1-1 Site Name 4 MILE SCHOOL
Field Code _____ Site Name _____

Map Quad Grafton
Map Quad _____

LTL	<input type="checkbox"/>	Twp	<u>157</u>	R	<u>53</u>	Sec	<u>16</u>	QQQ	<input checked="" type="checkbox"/>	QQ	<input checked="" type="checkbox"/>	Q	<input checked="" type="checkbox"/>	1. N $\frac{1}{2}$
LTL	<input type="checkbox"/>	Twp	_____	R	_____	Sec	_____	QQQ	<input type="checkbox"/>	QQ	<input type="checkbox"/>	Q	<input type="checkbox"/>	2. E $\frac{1}{2}$
LTL	<input type="checkbox"/>	Twp	_____	R	_____	Sec	_____	QQQ	<input type="checkbox"/>	QQ	<input type="checkbox"/>	Q	<input type="checkbox"/>	3. S $\frac{1}{2}$
LTL	<input type="checkbox"/>	Twp	_____	R	_____	Sec	_____	QQQ	<input type="checkbox"/>	QQ	<input type="checkbox"/>	Q	<input type="checkbox"/>	4. W $\frac{1}{2}$
LTL	<input type="checkbox"/>	Twp	_____	R	_____	Sec	_____	QQQ	<input type="checkbox"/>	QQ	<input type="checkbox"/>	Q	<input type="checkbox"/>	5. NE $\frac{1}{4}$
LTL	<input type="checkbox"/>	Twp	_____	R	_____	Sec	_____	QQQ	<input type="checkbox"/>	QQ	<input type="checkbox"/>	Q	<input type="checkbox"/>	6. SE $\frac{1}{4}$
LTL	<input type="checkbox"/>	Twp	_____	R	_____	Sec	_____	QQQ	<input type="checkbox"/>	QQ	<input type="checkbox"/>	Q	<input type="checkbox"/>	7. SW $\frac{1}{4}$
LTL	<input type="checkbox"/>	Twp	_____	R	_____	Sec	_____	QQQ	<input type="checkbox"/>	QQ	<input type="checkbox"/>	Q	<input type="checkbox"/>	8. NW $\frac{1}{4}$
LTL	<input type="checkbox"/>	Twp	_____	R	_____	Sec	_____	QQQ	<input type="checkbox"/>	QQ	<input type="checkbox"/>	Q	<input type="checkbox"/>	9. C

City _____

Street # _____ Street # _____

Street Name _____ Street Name _____

of Features 1

<u>1</u> Feature #	<u>9</u> Feature Type	<u>4</u> Condition
_____ Construction Date	<u>7</u> Context *	
<u>3</u> Feature Date	<u>26</u> Primary Exterior *	<u>5</u> Plan Shape *
<u>25</u> Structural System **	<u>31</u> Style *	_____ Secondary Exterior
_____ Ethnic		_____ Architect/Builder
<u>1012102</u> Fieldwork Date		_____ Other Information

_____ Soil Association	<u>16</u> Ecozone	<u>2</u> Area Signf	_____ MS Number
_____ Soil Association	_____ Ecozone	_____ Area Signf	_____ MS Number
<u>3</u> CR Type	<input checked="" type="checkbox"/> Verified Site	<input type="checkbox"/> Non-Site	<u>2</u> E C F <u>2</u> T F
<u>6</u> State Registry		<u>6</u> National Register	

Coder Jeff Kinney

Date Coded 3-10-03

Reconnaissance Survey _____

Intensive Survey

Manuscript/Report Title: _____

Author(s): _____

SITE DATA

FEATURE DATA

SHSND USE

NDCRS ARCHITECTURAL SITE FORM

page 1A

Field Code JKA-2002-1-1

Feature Number 1

SITS # 32WA

DESCRIPTIVE SECTION

FOUNDATION	STORIES	ROOF TYPE/CORNICE
<u>brick</u>	<u>1</u>	<u>Hip, truncated</u>

WINDOW CONDITION	DATING METHOD
<u>original surrounds</u> <u>Poor, boarded up</u>	<u>Informant</u>

PRESERVATION RECOMMENDATION (check all that apply)

- 1) Individual Nomination
- 2) Contributes to a potential district
- 3) No nomination potential
- 4) Will not contribute to district
- 5) Potential district not known at this time: feature would be a contributing element if neighboring properties constitute a district
- 6) Thematic nomination potential
- 7) Component of historic site/landscape
- *****
- 8) Feature has an important physical, spatial, functional, historic or architectural relationship to the site/complex/farmstead
- 9) Moved: A) relocation occurred within historic period. B) recreates original site, orientation, landscape and spatial relationships. C) compatible in context with neighboring structures. D) relocation has damaged eligibility.
- 10) Request comparative study of neighboring properties
- 11) Historical associations require further investigation

DESCRIPTION/INTEGRITY/ELIGIBILITY

Feature 1, known as the "4 Mile" school is a small rectangular, wood frame, one-room schoolhouse located in the SW corner of section 16. This structure has a brick foundation and a truncated hip roof with cedar shingles. The exterior is clad with horizontal wood siding. It has three windows on each side and they are currently boarded up. The chimney (missing) was on the north end of the building. There is a small entrance on the south end of the building, also with a truncated hip roof. The overall condition of the building is poor.

A local informant, Lillian Larson of rural Grafton, said that her husband's grandfather, Paul Larson, donated the land for the schoolhouse in the early 1900's. She said that the school closed in the 1930's and was possibly opened again for a few years in the late 1940's. It was then used as a township hall until the mid-1960's and has been unused since then.

The structural integrity of the building is poor and it is not believed to be significant nor is it believed to be eligible for nomination to the National Register of Historic Places.

Urban Legal Description:

 SEE CONTINUATION SHEET

NDCRS ARCHITECTURAL SITE FORM

Page 3

Field Code JKA-2002-1-1

SITS # 32WA

OWNER'S NAME, ADDRESS, PHONE #: Oliver Ordahl, Grafton, ND, (701)352-0933

PROJECT TITLE: Phase I Cultural Resources Investigation of a Proposed Tieback Levee and Disposal Areas at the City of Grafton, Walsh County, North Dakota

REPORT TITLE: Phase I Cultural Resources Investigation of a Proposed Tieback Levee and Disposal Areas at the City of Grafton, Walsh County, North Dakota

SITE AREA (in square feet): 2,500 square feet

ACCESS: From the intersection of ND 81 and ND 17 in Grafton, ND, proceed west on ND 17 for approximately 3.9 miles west to the crossroad. The site is located immediately north of this point.

DESCRIPTION: Feature 1, known as the "4 Mile" school is a small rectangular, wood frame, one-room schoolhouse located in the SW corner of section 16. This structure has a brick foundation and a truncated hip roof with cedar shingles. The exterior is clad with horizontal wood siding. It has three windows on each side and they are currently boarded up. The chimney (missing) was on the north end of the building. There is a small entrance on the south end of the building, also with a truncated hip roof. The overall condition of the building is poor.

SUMMARY OF SITE FEATURES AND EVALUATION OF SIGNIFICANCE:

This site consists of a single feature, the one-room schoolhouse known locally as the "4 Mile" schoolhouse. No other out buildings or other features remain at the site. The overall physical condition of the building is poor. The brick foundation is deteriorating and the roof is in poor condition. The windows are in very poor condition and have been boarded up. This site is not believed to be significant and it is not considered to be eligible for nomination to the National Register of Historic Places.

NDCRS SITE FORM

Photograph Form

Field Number JKA-2002-1-1

SITS # 32WA

Photo I.D. Code: JKA-2002-1/5, 8, 11

Storage Location: JKA, P.O. Box 43, Manvel, ND 58256

Include direction facing, feature number, and photo caption for each submitted photograph.



Schoolhouse closeup. View to the southwest. (Roll 1, neg. 11)



Schoolhouse overview. View to the northeast. (Roll 1, neg. 8)

NDCRS SITE FORM
Photograph Form

Field Number JKA-2002-1-1

SITS # 32WA

Photo I.D. Code: JKA-2002-1/5, 8, 11

Storage Location: JKA, P.O. Box 43, Manvel, ND 58256

Include direction facing, feature number, and photo caption for each submitted photograph.



Schoolhouse closeup. View to the northeast. (Roll 1, neg. 5)

NDCRS SITE FORM

Topographic Map

Field Number JKA-2002-1-1

SITS # 32WA

Photocopy the portion of the 7.5' U.S.G.S. topographic quadrangle that shows the location of the site and the surrounding area. Mark the boundaries of the site on the photocopy. Photocopy of the portion of the topographic quadrangle must be actual size, reduction or enlargements are unacceptable.

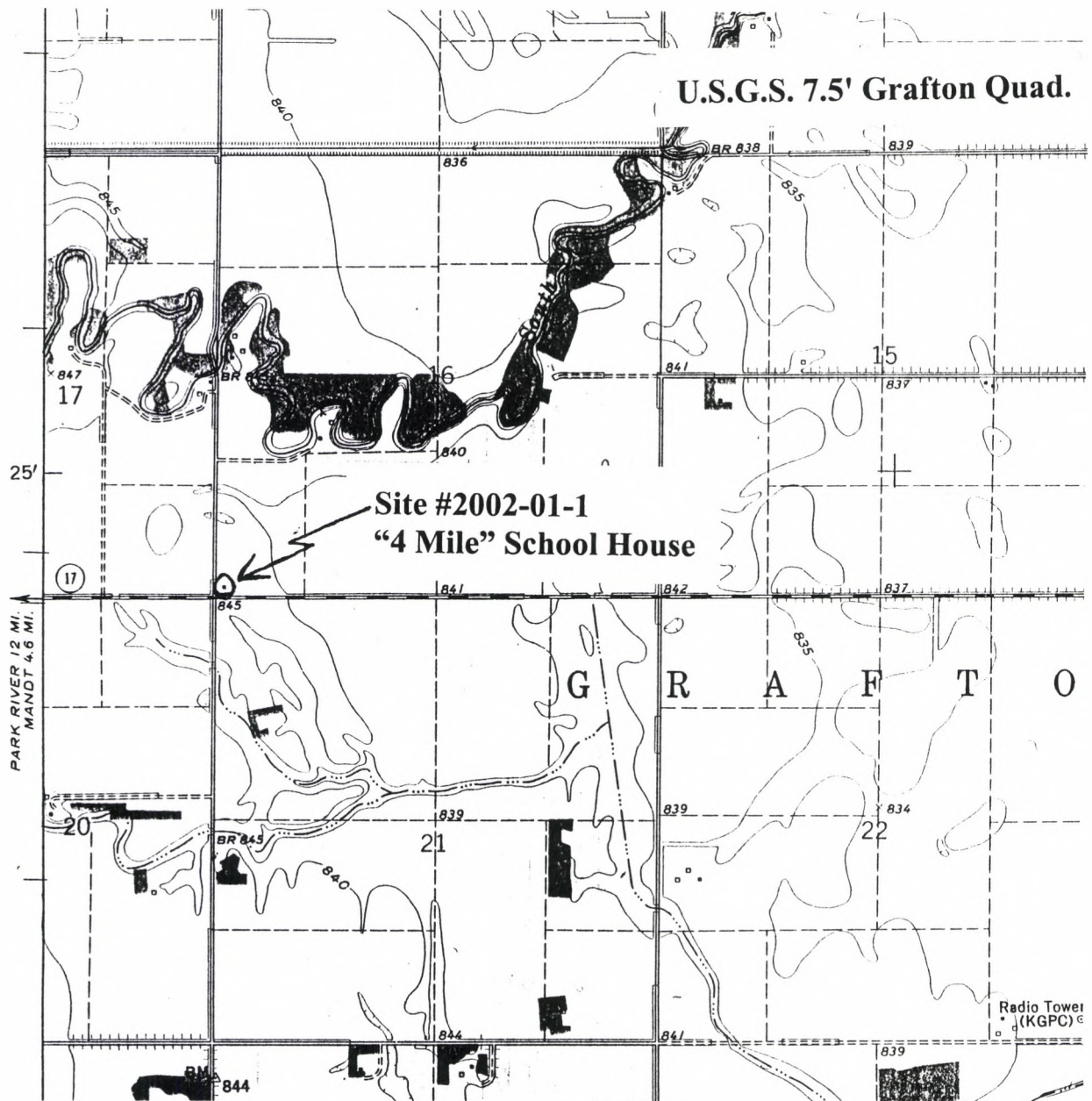

NDCRS SITE FORM
Sketch Map

Field # JKA=2002-1-1

SITS # 32WA

Include a north arrow, site boundaries, road or street names, locations of artifacts, features, buildings, structures, objects, and depressions with each item individually numbered and keyed to the Map Key, and road or street name(s).

Map Key: 157/53 Sec. 16 SW¼, SW¼, SW¼

Map Scale: 1 in. = 10 feet

