

NDCRS ARCHITECTURAL SITE FORM
PAGE 2—Feature Data

UPDATE

Field Code \_\_\_\_\_ SITS# 32 WE 9

Complete one Page 2 for each architectural feature at the site.

Architectural Feature # 1-2

Construction Date \_\_\_\_\_ Feature Type \_\_\_\_\_ Condition 1
Feature Date \_\_\_\_\_ Context \_\_\_\_\_ Plan Shape \_\_\_\_\_
Structural System \_\_\_\_\_ Primary Exterior \_\_\_\_\_ Style \_\_\_\_\_
Original Owner's Ethnicity \_\_\_\_\_ Secondary Exterior \_\_\_\_\_ Architect/Builder \_\_\_\_\_

Other Information:

Informed by Kathy Wilner the school was gone, verified that with 2009 aerial.
She found in 2010 it had been moved to 147-72 Sec 22 and it is now recorded as 32WE231

Foundation \_\_\_\_\_ Stories \_\_\_\_\_
Window \_\_\_\_\_
Roof/Cornice \_\_\_\_\_
Dating Method(s): \_\_\_\_\_

Feature Preservation Recommendation(s) (Check all that apply):

- Individual nomination
Contributes to a potential district
No nomination potential
Will not contribute to a district
Potential district—feature would be a contributing element if other properties constitute a district
Thematic nomination potential
Component of a historic site or landscape
Moved (specify all applicable choices)—a) relocation occurred within a historic period; b) recreates original site, orientation, landscape, & spatial relationships; c) compatible in context with neighboring structures; d) relocation has damaged eligibility
Historical associations require further investigation

Recorded By Lorna Meidinger Date Recorded 9/15/2010
(First Name & Last Name) (mm/dd/year)

Instructions to complete a digital version of this form: (1) Download a copy to your hard drive; (2) Open the saved blank copy; (3) Fill out the form; (4) Use the Save As command to rename the form appropriately and save; (5) Print and submit to SHSND.

NDCRS SITE FORM  
ARCHITECTURAL SITES

SITS # 32 WE 00009  
State County Site Number

Field Code CANAL #1 Site Name WHITBY SCHOOL NO. 3  
Field Code Site Name

Map Quad MANFRED NW  
Map Quad

LTL 0 Twp 149 Range 072 Section 20 QQQ 7 QQ 7 Q 7

- 1. N 1/2
- 2. E 1/2
- 3. S 1/2
- 4. W 1/2
- 5. NE 1/4
- 6. SE 1/4
- 7. SW 1/4
- 8. NW 1/4
- 9. C

City:

Street # and Name

Street # and Name

# of Features 2

0 Soils 18 Ecozone 2 Area Signif  
0 Soils Ecozone Area Signif T BANKS, G HANLEY Coder  
2 CR Type 1 Verified Site 0 Non-Site 2 E C F 2 T F 6/8/1980 Date Coded  
0 State Registry 2 National Register Update

1 Feature #	9 Feature Type	1-7 Condition
Construction Date	7 Context	Integrity
Feature Date		5 Plan Shape*
25 Structural System **	26 Primary Exterior *	Secondary Exterior
0 Ethnic	14 Style *	
06/08/80 Fieldwork Date	Fieldwork Date	0 Architect/Builder
	SCHOOL HOUSE	Other Information
2 Feature #	50 Feature Type	1-7 Condition
Construction Date	7 Context	Integrity
Feature Date		5 Plan Shape*
25 Structural System **	26 Primary Exterior *	Secondary Exterior
0 Ethnic	Style *	
06/08/80 Fieldwork Date	Fieldwork Date	0 Architect/Builder
	OUTHOUSE	Other Information

Base Data Form

32WE9

1. County Wells 2. Site Number \_\_\_\_\_ Canal # 1
3. Site Name (s) Whitby School No. 3
4. Type of Resource: A. Archaeological  Historical  Architectural  Paleontological   
 B. District  Site  Building  Structure  Object
5. Map Reference: Manfred NW 7.5 minute quad
6. Location: SW/SW/SW Sec. 20 T 149 N / R 72 W  
 Plat: \_\_\_\_\_ Block \_\_\_\_\_ Lot \_\_\_\_\_  
 UTMG: A. \_\_\_\_\_ B. \_\_\_\_\_  
 C. \_\_\_\_\_ D. \_\_\_\_\_
7. Access: At intersection of Highway 3/52 and Section Road to the town of Manfred at the NE quadrangle.
8. A. General description of site: School house - used as a voting place now.
- B. Condition of site: good
9. Owner's name/address: unknown
10. Occupant's name/address: none
11. Historic Register value: Nat.  State  Undt.  None  On Reg.  In District  District
12. Open to public: Yes  No  13. Preservation Underway: Yes  No
14. Endangered by: New Rockford Canal
15. Survey Project: Title Garrison Diversion Project Director D. Starr  
 Other surveys in which included none
16. Recommendations: move the structure away from Canal route if determined to be pre-1930 in age.
17. Environment: Elevation 1622' Nearest Water: Type unknown  
 Name \_\_\_\_\_ Distance \_\_\_\_\_ Direction \_\_\_\_\_  
 Soil conditions: sod  
 Soil Texture: sandy and black

17. Environment, Cont.

Ground Cover: mowed grass  
Terrain: flat

18. Local contact person or organization: none

19. Photos: No 3/W XColor Prints XSlides Comments/ID code \_\_\_\_\_  
Roll 40, exposures 9 and 10

Negatives stored at: ESCA-Tech

In space below attach and identify a picture or contact print of the site.

20. Sketch Map of Site:

Scale: 1cm = 40m

True North

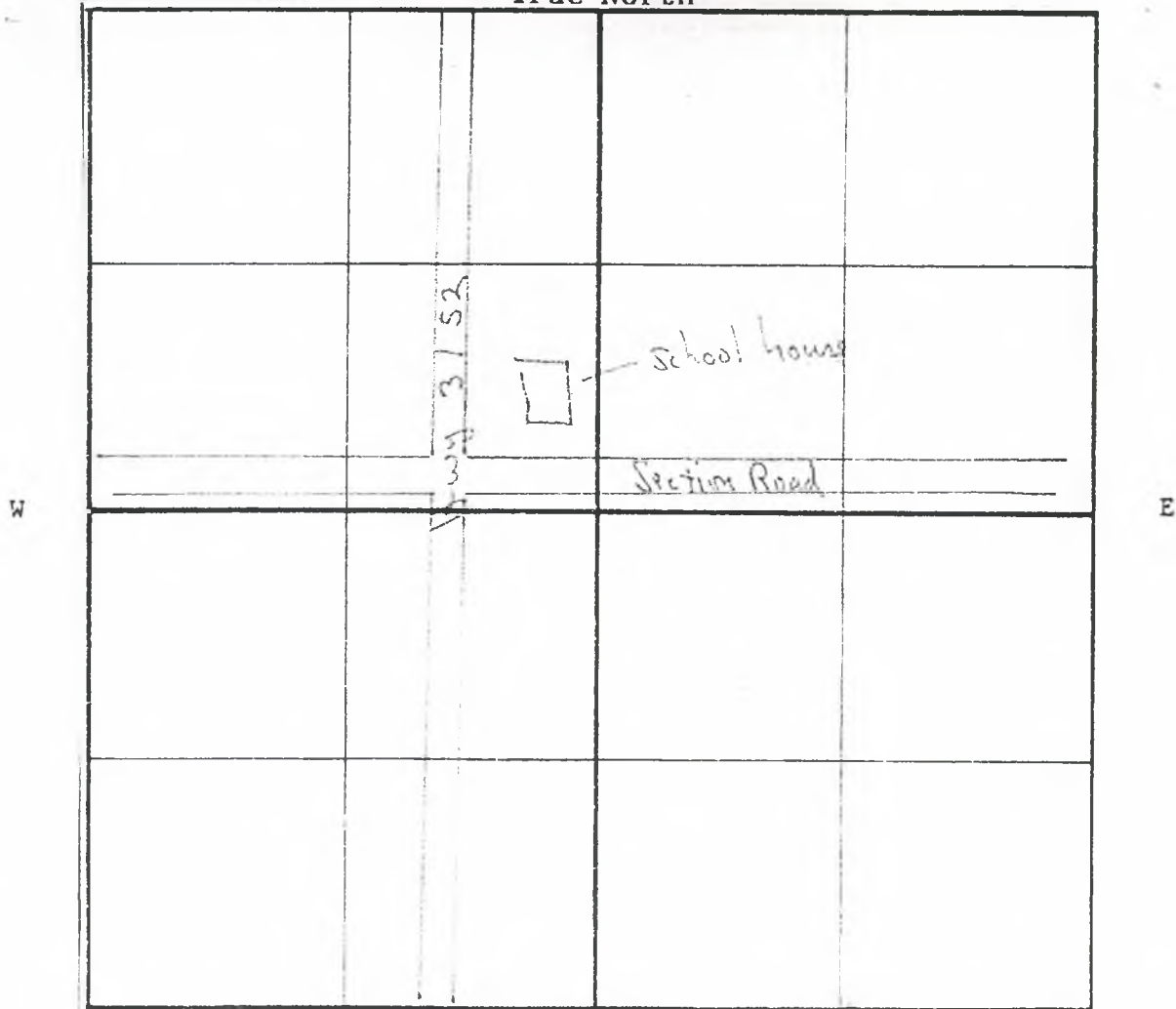

See Page 3 for Key

Recorded by: Thomas J. Banks/ Geoff Hanley Date 6/8/80

Revised by: \_\_\_\_\_ Date \_\_\_\_\_

KEY TO SITE SKETCH MAP ON PAGE 2

- |                 |           |
|-----------------|-----------|
| 1. school house | 16. _____ |
| 2. _____        | 17. _____ |
| 3. _____        | 18. _____ |
| 4. _____        | 19. _____ |
| 5. _____        | 20. _____ |
| 6. _____        | 21. _____ |
| 7. _____        | 22. _____ |
| 8. _____        | 23. _____ |
| 9. _____        | 24. _____ |
| 10. _____       | 25. _____ |
| 11. _____       | 26. _____ |
| 12. _____       | 27. _____ |
| 13. _____       | 28. _____ |
| 14. _____       | 29. _____ |
| 15. _____       | 30. _____ |

TOTAL NUMBER OF STRUCTURES 1

Method of Dating Site (informant, artifact, etc.--explain) \_\_\_\_\_  
age unknown - on U.S.G.S. 1950 quad map

Reason For Significance unknown

Ethnic Association unknown

Homestead Information (D. J. Starr): the SW 1/4 was selected by the state  
for the purpose of raising funds for the agricultural college.

Camel #1



ESCA-Teek, North Dakota  
Historic Site Survey (1980)

Roll No: 40

Exp. No: 10

Negative No: 10

Project Area: New Rockford  
Canal

Site No: 1

Description: See Photo Record



This site is on Manfred NW, 7.5' Quad Map.  
Our topographic map is missing for  
New Rockford Canal - #1.





ESCA Tech, North Dakota  
Historic Site Survey (1980)

Roll No: 40

Exp. No: 9

Negative No: 9

Project Area: New Rockford Canal

Site No: 1

Description: see photo record



ESCA- Tech, North Dakota Historic  
Site Survey (1980)

Roll No: 31

Exp. No: 20

Negative No: Last negative; no negative  
no.

Project Area: New Rockford Canal

Site No: 2

Description: See Photo Record



ESCA-Tech, North Dakota Historic  
Site Survey (1980)

Roll No: 31

Exp. No: 19

Negative No: 20

Project Area: New Rockford Canal

Site No: 2

Description: See Photo Record



ESCA-Tech, North Dakota Historic  
Site Survey (1990)

Roll No: 31

Exp. No: 18

Negative No: 19

Project Area: New Rockford Canal

Site No: 2

Description: See Photo Record

