

NDCRS ARCHITECTURAL FORM

PAGE 1

UPDATE

Field Code Berlin Township School #1

SITS# 32 WE 194

Map Quad Heaton

Site Name

Map Quad

Site Name

LTL T. 145 N., R. 70 W., Sec. 7 QQQ X 8 of the QQ X 7 of the Q X 6

LTL T. N., R. W., Sec. QQQ of the QQ of the Q

LTL T. N., R. W., Sec. QQQ of the QQ of the Q

LTL T. N., R. W., Sec. QQQ of the QQ of the Q

Subsection
1 = N½
2 = E½
3 = S½
4 = W½
5 = NE¼
6 = SE¼
7 = SW¼
8 = NW¼

NAD 1983 UTM 5248376 Zone 14N

NAD 1983 UTM 451821

City: Bowdon

Street Number: 4263

Street Name: 2nd St SE

Urban Legal Description:

Total Number of Architectural Features: 1

Fieldwork Date: 2/27/2021

Reconnaissance Survey

Intensive Survey

Project & Principal Investigator:

Country School House Project
Kathy Wilner
366 43rd Ave SE
Bowdon ND 58418

Contracting Firm or Agency Completing the Form:

Additional Information:

SHSND USE

Component Study Unit Verified Site CR Type

Component

Component

Recorded By: Kathy Wilner Date Recorded: 2/27/2021

NDCRS ARCHITECTURAL FORM  
PAGE 2 – Feature Data

Field Code Berlin Township School #1

SITS# 32 WE 194

Complete one Page 2 for each architectural feature at the site.

Architectural Feature # 1

Construction Date \_\_\_\_\_

Feature Date \_\_\_\_\_

Structural System \_\_\_\_\_

Original Owner's Ethnicity \_\_\_\_\_

Feature Type 9 - School; Church school

Context Education

Primary Exterior \_\_\_\_\_

Secondary Exterior \_\_\_\_\_

Condition Fair

Plan Shape \_\_\_\_\_

Style Other Style

Architect/Builder \_\_\_\_\_

Foundation \_\_\_\_\_ Stories \_\_\_\_\_

Roof/Cornice \_\_\_\_\_

Window \_\_\_\_\_

Dating Method(s) School records

Miscellaneous Information \_\_\_\_\_

**Feature Preservation Recommendation(s) (Check all that apply):**

Individual nomination

Contributes to a potential district

No nomination potential

Will not contribute to a district

Potential district—feature would be a contributing element if other properties constitute a district

Thematic nomination potential

Component of a historic site or landscape

Moved (specify all applicable choices)—a) relocation occurred within a historic period; b) recreates original site, orientation, landscape, and spatial relationships; c) compatible in context with neighboring structures; d) relocation has damaged eligibility

Historical associations require further investigation

Recorded By: Kathy Wilner Date Recorded: 2/27/2021

**NDCRS ARCHITECTURAL FORM**

**PAGE 3 – Feature Data**

**Field Code** Berlin Township School #1

**SITS#** 32 **WE** 194

Complete one Page 3 for *each* architectural feature at the site.

**1. Feature Description, Integrity, Eligibility:**

This school was moved about 3/4 mile from it's original location in June, 2019.

**2. Owner's Contact Information:**

Karl and Samantha Tebelius  
4263 2nd St SE  
Bowdon ND 58418

**Recorded By:** Kathy Wilner **Date Recorded:** 2/27/2021

**NDCRS ARCHITECTURAL FORM**  
**PAGE 4 – Site Description****Field Code** Berlin Township School #1**SITS# 32** WE 1943. Site Area (ft<sup>2</sup>):

4. Description of Access and Site Setting:

The school now sits in trees on the west edge of the Tebelius farm yard. All the farm building are locted to the south and east with an open field west. Access is from 43rd Ave SE, south of the juntion of Highways 200 and 52 5 miles. It is on the west side of the road.

5. Summary of ALL Site Features and Evaluation of Significance:

6. References/Comments:

**Recorded By:** Kathy Wilner **Date Recorded:** 2/27/2021

Form instructions: (1) Download; (2) Save A Copy; (3) Submit a paper copy of the form to the SHSND and upload the PDF version of the form and corresponding GIS shapefiles to the ND SHPO-run FTP site.

Feature sits here.



Imagery ©2021 Maxar Technologies, USDA Farm Service Agency, Map data ©2021 200 ft

Berlin Township School #1

2/25/2021

Kathy Wilner

WE

This school was moved to the Tebelius Farm June, 2019.

# NDCRS ARCHITECTURAL SITE FORM PAGE 1

SITS# 32 WE 194

## SITE IDENTIFICATION

Field Code Berlin Township School #1

Site Name Berlin Township School #1

Site Name

Map Quad Heaton  
Map Quad

LTL	TWP	145	R	70	SEC	8	QQQ	<del>X</del> 7	QQ	<del>X</del> 7	Q <del>X</del> 6
LTL	TWP		R		SEC		QQQ		QQ		Q
LTL	TWP		R		SEC		QQQ		QQ		Q
LTL	TWP		R		SEC		QQQ		QQ		Q

UTM		N	ZONE	
UTM		E	NAD 1927	NAD 1983

Subsection:
1 = N $\frac{1}{2}$
2 = E $\frac{1}{2}$
3 = S $\frac{1}{2}$
4 = W $\frac{1}{2}$
5 = NE $\frac{1}{4}$
6 = SE $\frac{1}{4}$
7 = SW $\frac{1}{4}$
8 = NW $\frac{1}{4}$

City: Rural Bowdon

Street Number:

Street Name: 4351 2<sup>nd</sup> St SE

Urban Legal Description:

## SITE DATA

Total # **Architectural** Features: 1 X - Did not complete paperwork for outhouse - did include pics.

Fieldwork Date: 9/29/2009

Reconnaissance Survey X Intensive Survey

Project Title & Supervisor:

Country Schoolhouse Project

Report Title & Author(s):

Additional Information:

## SHSND USE

Area of Significance	2	Ecozone	19	CR Type	2	ECF
Area of Significance		Ecozone		Verified Site		TF
				Non-Site		

Recorded By Kathy Wilner

Date Recorded 2/26/2010

(First Name & Last Name)

(mm/dd/year)

Instructions to complete a digital version of this form: (1) Download a copy to your hard drive; (2) Open the saved blank copy; (3) Fill out the form; (4) Use the Save As command to rename the form appropriately and save; (5) Print and submit to SHSND.

**NDCRS ARCHITECTURAL SITE FORM  
PAGE 2—Feature Data**

Field Code

**SITS# 32 WE**

**Complete one Page 2 for each architectural feature at the site.**

**Architectural Feature # 1**

Construction Date	1897	Feature Type	9	Condition	7
Feature Date	2	Context	7	Plan Shape	5
Structural System	25	Primary Exterior	26	Style	Other Style
Original Owner's Ethnicity		Secondary Exterior	<del>26</del>	Architect/Builder	

Other Information:

Foundation Stone and poured concrete Stories 1

Roof/Cornice Gable

Window Windows appear to be original, openings intact

Dating Method(s): History recorded for school, county maps, county school records

**Feature Preservation Recommendation(s) (Check all that apply):**

Individual nomination

Contributes to a potential district

No nomination potential

Will not contribute to a district

Potential district—feature would be a contributing element if other properties constitute a district

Thematic nomination potential

Component of a historic site or landscape

Moved (specify all applicable choices)—a) relocation occurred within a historic period; b) recreates original site, orientation, landscape, & spatial relationships; c) compatible in context with neighboring structures; d) relocation has damaged eligibility

Historical associations require further investigation

**Recorded By** Kathy Wilner  
(First Name & Last Name)

**Date Recorded** 2/26/2010  
(mm/dd/year)

*Instructions to complete a digital version of this form:* (1) Download a copy to your hard drive; (2) Open the saved blank copy; (3) Fill out the form; (4) Use the Save As command to rename the form appropriately and save; (5) *Print* and submit to SHSND.

**NDCRS ARCHITECTURAL SITE FORM**  
**PAGE 3—Feature Data**

Field Code

SITS# 32 WE

**1. Feature Description, Integrity, Eligibility:**

Feature one is a one-room wood frame school built on a stone foundation. Wood lap siding covers the walls on the outside and it is in need of paint. It is difficult in the winter to see if mortar was poured around the stones. There is a small cement piece (poured long after the school was built) at the door to step on before entering the building. The roofing is cedar shakes. The chimney is made of chimney blocks, built to accommodate a coal burning stove and later converted for a fuel oil furnace. The south end of the building has an entry room. Just inside the door, to the left (west), there is a small room that held coal for heating before the fuel oil stove was installed. This room has an opening, at the southwest corner, just under the roof, for dumping the coal into that storage area. It looks to be very tired today, holes through the outside walls of this portion of the building. The entry door appears to be original and is held closed with a hook latch today. There is a window next to the door of the entry that is covered with a piece of metal. Another small window looks east. In nice weather this room was used for coat and lunch box storage. It was also the washroom. All of that activity was moved inside the main room of the school in the winter. The entry is not insulated and heated. The west and east sides of the main body of the school have three double hung windows. The glass is intact in all the windows and they also have storm windows. There are no windows on the north side. A fuel oil barrel sits at the northwest corner of the school.

*+ Some  
Poured  
Concrete*

There is another door into the main body of the school. It is insulated and finished with lath and plaster throughout. All the wall and ceiling were painted schoolhouse white. In later years parents of the students screwed sheet rock on the ceiling as it was falling away. Electricity was brought in at the time they did some of the finishing work on the interior. There is lighting with naked bulbs in simple electric ceiling fixtures. A light was also mounted over the entry door.

The inside of the building is in good shape. There are two small black boards, one on the west wall and one on the east wall toward the north end of the building. There is another larger blackboard on most of the north



wall. The schoolhouse has had benches brought in for simulating the old school house look. A desk and chair complete this picture. Inside the main boday entry door, to the right, there are coat hooks on the wall. To the left there is a more modern cupboard. At one time this cupboard probably held supplies, today there is mouse poison. In the northwest corner of the school it the fuel oil stove.

Tin pieces were attached to all the corners of the building to keep the raccoons from climbing the walls to gain access to the attic space.

Built in 1897, Berlin Township School #1 was operational until 1959. There is a small swing set in the schoolyard.

**Recorded By** Kathy Wilner  
(First Name & Last Name)

**Date Recorded** 2/26/2010  
(mm/dd/year)

*Instructions to complete a digital version of this form:* (1) Download a copy to your hard drive; (2) Open the saved blank copy; (3) Fill out the form; (4) Use the Save As command to rename the form appropriately and save; (5) *Print* and submit to SHSND.

**NDCRS ARCHITECTURAL SITE FORM  
PAGE 4—SITE DESCRIPTION**

Field Code

SITS# 32 WE

**Complete one Page 4 for the entire site.**

## 2. Owner's Contact Information:

Berlin Township Board Member  
Charles Bruer  
4412 3<sup>rd</sup> St SE  
Bowdon ND 58418

## 3. Access (to rural areas):

From the junction of Hwy 200 and Hwy 52, 13 miles south of Fessenden, proceed south on Wells County Road 71 for a distance of about 5 miles. A street sign at the corner of the gravel road reads 2<sup>nd</sup> Street SE. Turn left (east) onto the gravel road and proceed about ½ mile and the school will be on the north side of the road.

4. Site Area (ft<sup>2</sup>): 214.5X203.5=43,650.74

## 5. Site Description:

A short distance to the east and southeast are two farmyards. The north and south are open to fields on gently rolling hills, with another farmyard a longer distance to the northwest. It sits in tall prairie grass.

**Recorded By** Kathy Wilner  
(First Name & Last Name)

**Date Recorded** 2/26/2010  
(mm/dd/year)

*Instructions to complete a digital version of this form:* (1) Download a copy to your hard drive; (2) Open the saved blank copy; (3) Fill out the form; (4) Use the Save As command to rename the form appropriately and save; (5) *Print* and submit to SHSND.

**NDCRS ARCHITECTURAL SITE FORM  
PAGE 5—SITE DESCRIPTION**

Field Code

SITS# 32 WE

**6. Summary of ALL Site Features & Evaluation of Significance:**

Berlin Township School #1 is sitting in the same spot it was built 113 years ago. It has been preserved by interested persons in the community and it has been available for touring when there is an all-school reunion in Bowdon or celebrations where folks return and want to see historic buildings. Interested parties associated with the school today are interested in keeping it painted and open to the public.

7. References/Comments:

Jim Buchmiller  
Charles Bruer

**Recorded By** Kathy Wilner  
(First Name & Last Name)

**Date Recorded** 2/26/2010  
(mm/dd/year)

*Instructions to complete a digital version of this form:* (1) Download a copy to your hard drive; (2) Open the saved blank copy; (3) Fill out the form; (4) Use the Save As command to rename the form appropriately and save; (5) *Print* and submit to SHSND.

Send To Printer Back To MSR Maps Change to 11x17 Print Size Show Grid Lines Change to Landscape

USGS 109 km NE of Bismarck, North Dakota, United States 01 Jul 1994

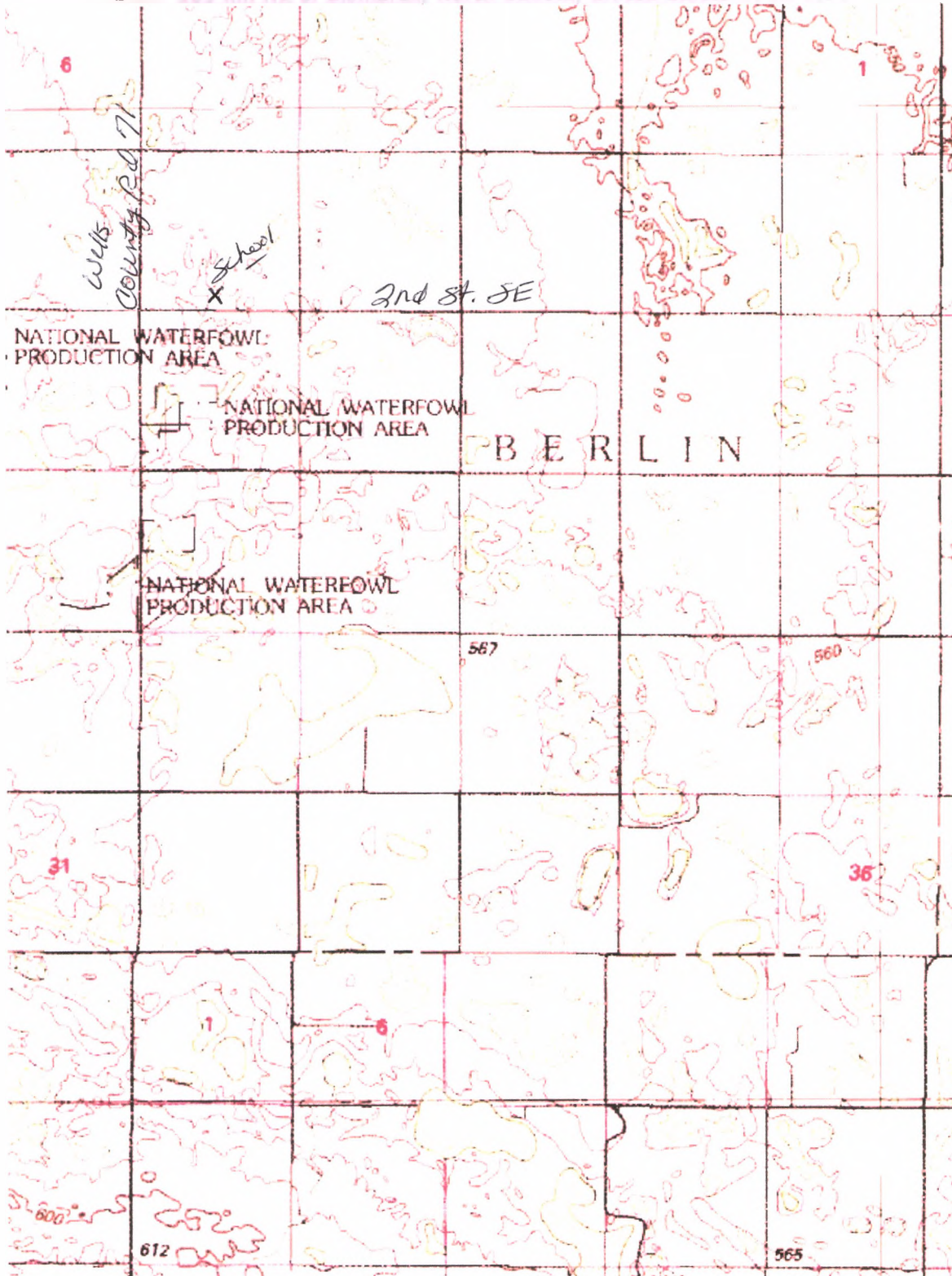

Image courtesy of the U.S. Geological Survey

© 2010 Microsoft Corporation. Terms of Use Privacy Statement

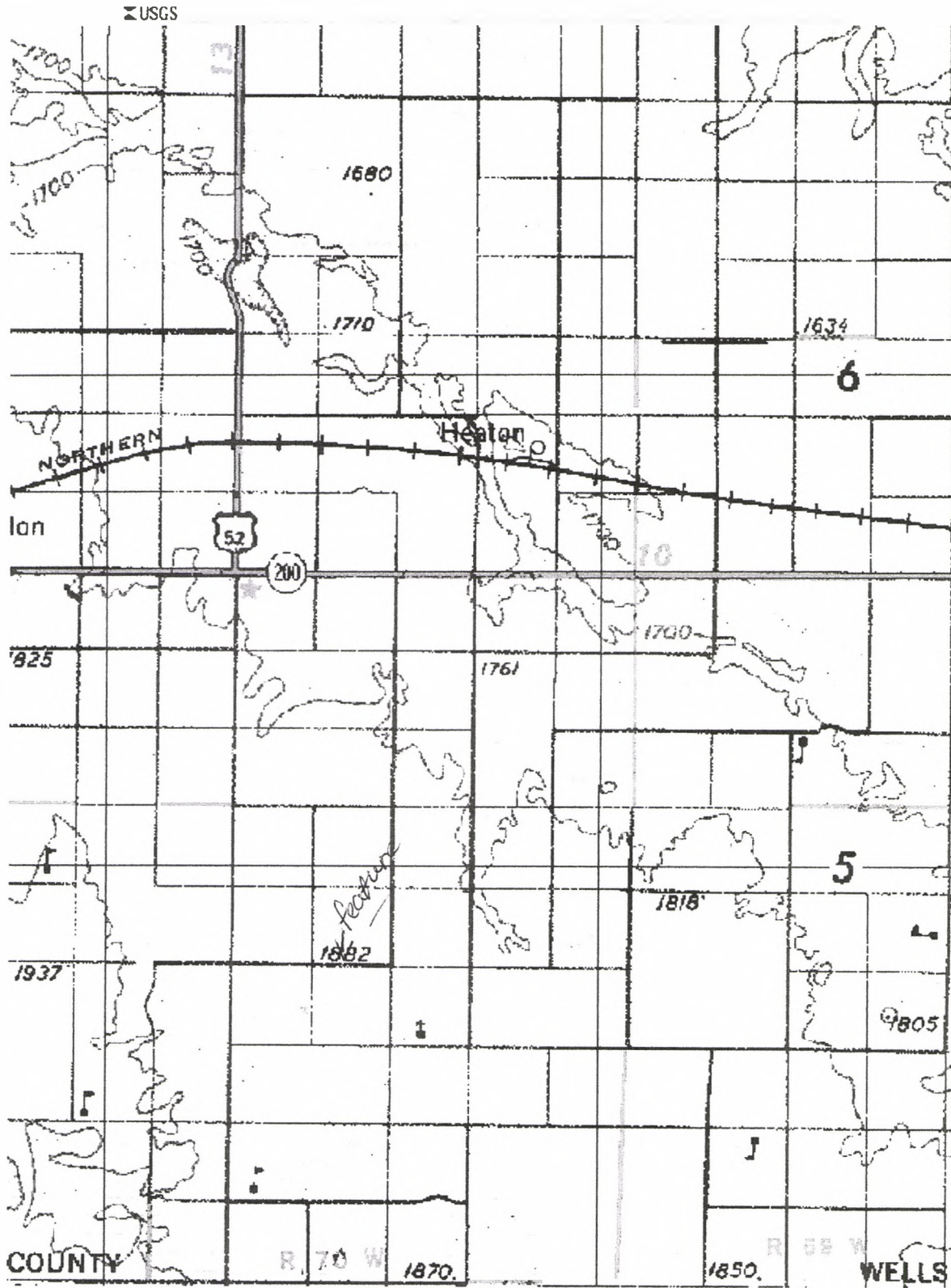

Image courtesy of the U.S. Geological Survey

© 2010 Microsoft Corporation. Terms of Use. Privacy Statement

Wells County - Berlin Township School #1

Kathy Wilner Sept 2009

Berlin Township School #1

Kathy Wilner

Sept. 2009

South side Entry

WE



Berlin Township School #1 East side of school Sept. 2009 Kathy Wilner

WE



Berlin Township School #1

Kathy Wilner North Side

Sept. 2009

WE





Berlin Township School #1

West side of school

Sept. 2009

Kathy Wilner

WE



Berlin Township School #1

Interior

Sept. 2009

Kathy Wilner

WE

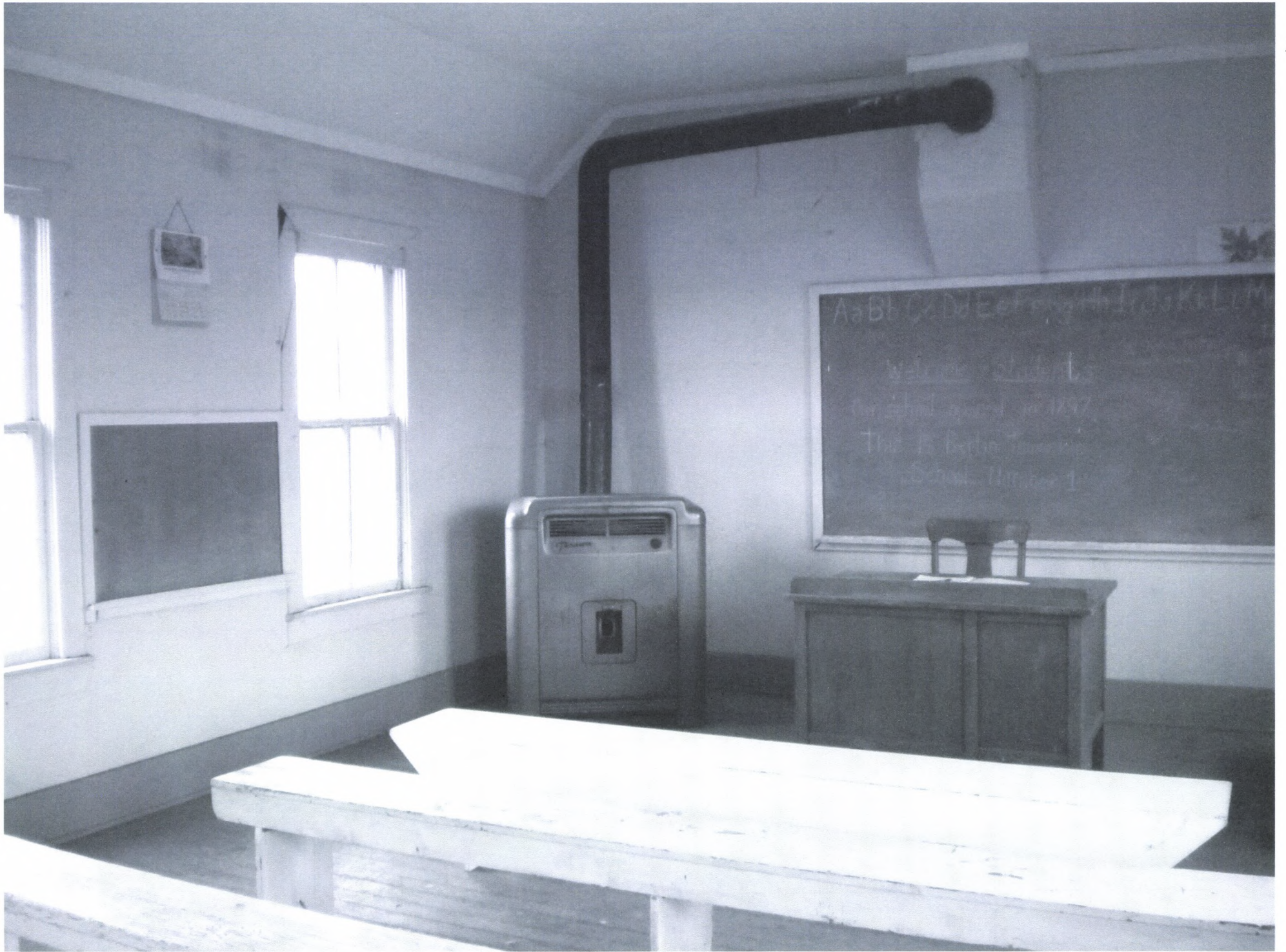

Berlin Township School #1 outhouse - south side

Sept. 2009

Kathy Wilner

WE



Berlin Township School #1 outhouse east side

Sept. 2009 Kathy Wilner WE



Berlin Township School #1 outhouse north side

Sept. 2009

Kathy Wilner

W/E



Berlin Township School #1 outside/outhouse SW Corner Sept. 2009

Kathy Wilner

WE

