

NDCRS ARCHITECTURAL SITE FORM

PAGE 1

SITS# 32 WE 217

SITE IDENTIFICATION

Field Code Hillsdale Township School #3

Site Name
Site Name

Hillsdale Township School #3

Map Quad Martin ~~150~~
Map Quad

LTL	TWP	150 150	R	73W	SEC	28	QQQ	X 8	QQ	X 8	Q	X 7
LTL	TWP		R		SEC		QQQ		QQ		Q	
LTL	TWP		R		SEC		QQQ		QQ		Q	
LTL	TWP		R		SEC		QQQ		QQ		Q	

UTM		N	ZONE	
UTM		E	NAD 1927	NAD 1983

Subsection:
1 = N $\frac{1}{2}$
2 = E $\frac{1}{2}$
3 = S $\frac{1}{2}$
4 = W $\frac{1}{2}$
5 = NE $\frac{1}{4}$
6 = SE $\frac{1}{4}$
7 = SW $\frac{1}{4}$
8 = NW $\frac{1}{4}$

City: Harvey ND

Street Number:

Street Name: 2500 block of 26th Ave. NE

Urban Legal Description:

SITE DATA

Total # **Architectural** Features: 1

Fieldwork Date: 5/19/2010

Reconnaissance Survey Intensive Survey

Project Title & Supervisor:

Country Schoolhouse Project

Report Title & Author(s):

Additional Information:

SHSND USE

Area of Significance 2 Ecozone 18

CR Type 2
Verified Site
Non-Site

ECF 2
TF

Recorded By Kathy Wilner
(First Name & Last Name)

Date Recorded 9/18/2010
(mm/dd/year)

Instructions to complete a digital version of this form: (1) Download a copy to your hard drive; (2) Open the saved blank copy; (3) Fill out the form; (4) Use the Save As command to rename the form appropriately and save; (5) Print and submit to SHSND.

NDCRS ARCHITECTURAL SITE FORM
PAGE 2—Feature Data

Field Code Hillsdale Township School #3

SITS# 32 WE

Complete one Page 2 for each architectural feature at the site.

Architectural Feature # 1

Construction Date after 1895 Feature Type 9 Condition 4
Feature Date 2 Context 7 Plan Shape
Structural System 25 Primary Exterior 26 Style other style
Original Owner's Ethnicity Secondary Exterior Architect/Builder unknown

Other Information:

Foundation poured concrete Stories 1
Roof/Cornice hip roof, main body/pyramid hip roof entry
Window appear to be double hung, all glass gone
Dating Method(s): School records, county records

Feature Preservation Recommendation(s) (Check all that apply):

- Individual nomination
Contributes to a potential district
No nomination potential
Will not contribute to a district
Potential district—feature would be a contributing element if other properties constitute a district
Thematic nomination potential
Component of a historic site or landscape
a Moved (specify all applicable choices)—a) relocation occurred within a historic period; b) recreates original site, orientation, landscape, & spatial relationships; c) compatible in context with neighboring structures; d) relocation has damaged eligibility
Historical associations require further investigation

Recorded By Kathy Wilner
(First Name & Last Name)

Date Recorded 9/18/2010
(mm/dd/year)

Instructions to complete a digital version of this form: (1) Download a copy to your hard drive; (2) Open the saved blank copy; (3) Fill out the form; (4) Use the Save As command to rename the form appropriately and save; (5) Print and submit to SHSND.

NDCRS ARCHITECTURAL SITE FORM
PAGE 3—Feature Data

Field Code Hillsdale Township School #3

SITS# 32 WE

1. Feature Description, Integrity, Eligibility:

This Hillsdale Township School was moved to its present location because the township wanted the school more centrally located. A former student remembers it being located 1 mile west of the present location and said it was in the SW corner of the NWQ of section 29. The school was placed on a cement foundation with fairly large, curved concrete steps leading up to a landing that gave entry to the school. I do not have information about when the school was moved but it had to be before 1941 when this same student started school in the present location.

This is another very tired school. The roof is shingled with wood shakes over wood roofing. The shingles appeared quite weathered and some are missing. The corners of the roof appeared to be covered with a piece of metal. I can see a piece of wood that look like quarter round running along the seam where the roof meets the walls. On the south side of the roof of the mail body of the school there is a small opening that looks like it might be a vent for the attic space. There is a fairly new looking brick chimney on the slope of the roof toward the north end. Two pipes are sticking out the top of the chimney.

Wood lap siding covers the outside walls with 7 windows on the east side, one window on the northwest corner, another window in an ante room on the west side of the entry and one more small opening on the east side of the entry, mostly likely used to unload coal into the coal storage room, this opening is covered with a piece of wood. The glass is missing from all the east windows but the openings remain intact with the wood frames for the windows still in place. The window on the north appears to be covered with something from the inside. The window to the west in the entry is also void of glass.

The door to the entry, which faces south, is leaning against the steps. The inside of the entry shows wood lap siding on the wall of the main body of the school leading me to speculate that the entry was added at a later time. There is a door to the right in the entry, this for coal storage. Another door leads into the small addition on the west side of the entry. Entering the main body of the school I could see lath in the ceiling that was mostly covered with wallboard or sheetrock with wood stripping covering the seams. The same treatment was used on the upper portion of the walls. The lower part of the walls had wainscoating on them. I saw coat hooks to my right as I walked into the main portion of the school with chalkboards on the west wall wrapping around to a part of the south wall. I could see where the stove pipe entered the chimney.

There are light fixtures in the ceiling, electricity came to that area in 1949/1950.

The main body of the school measures 24 feet north to south and 24 feet east to west with the entry measuring 12 feet north to south by 24 feet east to west.

Recorded By Kathy Wilner
(First Name & Last Name)

Date Recorded 9/18/2010
(mm/dd/year)

**NDCRS ARCHITECTURAL SITE FORM
PAGE 4—SITE DESCRIPTION**

Field Code Hillsdale Township School #3

SITS# 32 WE

Complete one Page 4 for the entire site.

2. Owner's Contact Information:

Hillsdale Township

Contact Information:

Grace Erickson, township clerk

2950 25th St. NE

Harvey ND 58341

3. Access (to rural areas):

Go northwest out of Harvey ND on Highway 52 (approximately 3 ½ miles) to 26th Ave NE. Turn left onto 26th Avenue and drive south about 1 ½ miles. The school will be on your left.

4. Site Area (ft²):

5. Site Description:

To the north of the school is a small grove of trees, all three other sides of the school look out over crop fields.

Recorded By Kathy Wilner
(First Name & Last Name)

Date Recorded

9/18/2010
(mm/dd/year)

Instructions to complete a digital version of this form: (1) Download a copy to your hard drive; (2) Open the saved blank copy; (3) Fill out the form; (4) Use the Save As command to rename the form appropriately and save; (5) *Print* and submit to SHSND.

**NDCRS ARCHITECTURAL SITE FORM
PAGE 5—SITE DESCRIPTION**

Field Code Hillsdale Township School #3

SITS# 32 WE

6. Summary of ALL Site Features & Evaluation of Significance:

7. References/Comments:

Recorder contact information:

Kathy Wilner
366 43rd Ave SE
Bowdon ND 58418

Recorded By Kathy Wilner
(First Name & Last Name)

Date Recorded 9/18/2010
(mm/dd/year)

Instructions to complete a digital version of this form: (1) Download a copy to your hard drive; (2) Open the saved blank copy; (3) Fill out the form; (4) Use the Save As command to rename the form appropriately and save; (5) *Print* and submit to SHSND.

Microsoft Research Maps

Home | Advanced Find | Famous Places | Web Services | About | Bing Maps

Search MSR Maps

Street

The National Map 8 km NE of Harvey North Dakota United States

Download | E-mail | Info | Print | Order Map | Bing Maps

City

Harvey

State

ND

Longitude

Latitude

-100.03654

47.79847

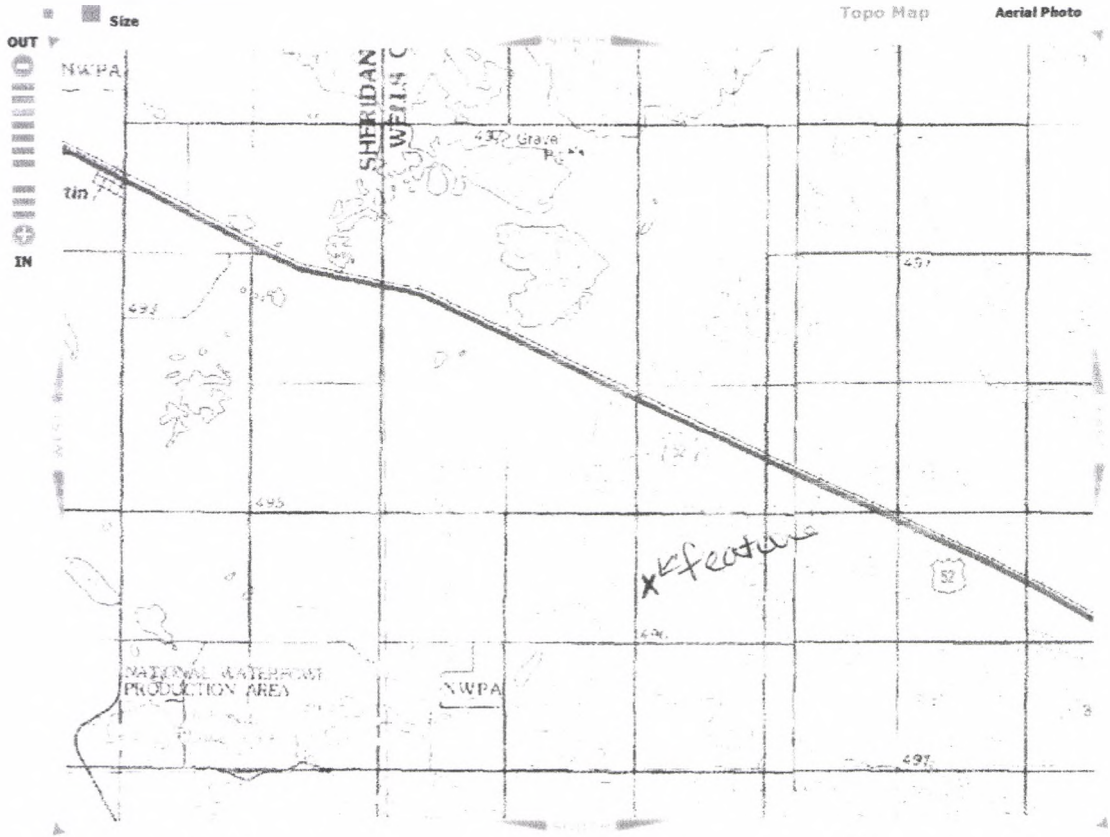

Image courtesy of the U.S. Geological Survey

Source=243327 Running Time 46.88 ms

© 2010 Microsoft Corporation. Terms of Use Privacy Statement Sponsored by USGS Research Bing
Server=TK2TERRAWE22

Hillsdale Twsp. School # 3 9/18/2010 Kathy Wilmer WE



1 - Hillsdale Township School #3 West side 5/19/2010 Kathy Wilner WE

2 - Hillsdale Township School #3 South side 5/19/2010 Kathy Wilner WE





3 - Hillsdale Township School# 3 North side 5/19/2010 Kathy Wilner WE

4 - Hillsdale Township School# 3 East side 5/19/2010 Kathy Wilner WE

