

NDCRS ARCHITECTURAL SITE FORM

PAGE 1

SITS# 32 WE 219

SITE IDENTIFICATION

Field Code Myron Thon School Site Name Myron Thon School
 Site Name
 Map Quad Manfred NW, ~~SE~~
 Map Quad

LTL	TWP	148N	R	72 23 W	SEC	18	QQQ	6	QQ	5	Q	5
LTL	TWP		R		SEC		QQQ		QQ		Q	
LTL	TWP		R		SEC		QQQ		QQ		Q	
LTL	TWP		R		SEC		QQQ		QQ		Q	

UTM N ZONE
 UTM E NAD 1927 NAD 1983

Subsection:
1 = N½
2 = E½
3 = S½
4 = W½
5 = NE¼
6 = SE¼
7 = SW¼
8 = NW¼

City: Harvey ND

Street Number:

Street Name: 1517-1519 31st Ave NE

Urban Legal Description:

SITE DATA

Total # *Architectural* Features: 1

Fieldwork Date: 9/22/2010

Reconnaissance Survey Intensive Survey

Project Title & Supervisor:

Country Schoolhouse Project

Report Title & Author(s):

Additional Information:

SHSND USE

Area of Significance 2 Ecozone 18
 Area of Significance Ecozone

CR Type 2
 Verified Site
 Non-Site

ECF 2
 TF

Recorded By Kathy Wilner
 (First Name & Last Name)

Date Recorded 9/23/2010
 (mm/dd/year)

Instructions to complete a digital version of this form: (1) Download a copy to your hard drive; (2) Open the saved blank copy; (3) Fill out the form; (4) Use the Save As command to rename the form appropriately and save; (5) Print and submit to SHSND.

**NDCRS ARCHITECTURAL SITE FORM
PAGE 2—Feature Data**

Field Code Myron Thon School **SITS# 32 WE**

Complete one Page 2 for each architectural feature at the site.

Architectural Feature #

Construction Date	X	Feature Type	9	Condition	5
Feature Date	X2	Context	7	Plan Shape	5
Structural System	25	Primary Exterior	26	Style	other style
Original Owner's Ethnicity		Secondary Exterior		Architect/Builder	unknown

Other Information:

Foundation bricks, concrete blocks, Stories 1

Roof/Cornice gable

Window one over one, double hung

Dating Method(s): other schools I have recorded

Feature Preservation Recommendation(s) (Check all that apply):

- Individual nomination
- Contributes to a potential district
- No nomination potential
- Will not contribute to a district
- Potential district—feature would be a contributing element if other properties constitute a district
- Thematic nomination potential
- Component of a historic site or landscape
- Moved (specify all applicable choices)—a) relocation occurred within a historic period; b) recreates original site, orientation, landscape, & spatial relationships; c) compatible in context with neighboring structures; d) relocation has damaged eligibility
- Historical associations require further investigation

Recorded By Kathy Wilner
(First Name & Last Name)

Date Recorded 9/23/2010
(mm/dd/year)

Instructions to complete a digital version of this form: (1) Download a copy to your hard drive; (2) Open the saved blank copy; (3) Fill out the form; (4) Use the Save As command to rename the form appropriately and save; (5) Print and submit to SHSND.

NDCRS ARCHITECTURAL SITE FORM
PAGE 3—Feature Data

Field Code

Myron Thon School

SITS# 32 WE

1. Feature Description, Integrity, Eligibility:

This school building is very tired. It was moved onto the present farm site many years ago and the owner doesn't know when it came or where it came from. It measures about 24' by 10', actual measurement wasn't done because of weeds and debris.

The school building is typical of a small one-room schoolhouse built on the prairie in the late 1800's. The walls are wood sided with wood shake shingles. Some of the shingles are missing showing board lumber underneath for the roofing. There are trim boards where the roof meets the walls and that is in good shape as it is protected by the overhang. Two windows on the north are boarded up while the two on the south are not and the glass is intact. Glass appears to be old as it has waves. There is a window on the north side of the entry that is boarded up. I could see into the entry and the exterior walls of the main body of the school are lap siding like the outside. Perhaps the entry was added at a later time. The entry is about 8' wide and has two doors. The door to the smaller end of the entry might have been access for coal or wood. The entry door could be original.

A look into the interior with a camera poked around the corner of the door shows wood floors and not much else. Looking into one window I could see a division in the middle of the school. At some point someone put up a wall. I was told that it was used for grain storage.

Recorded By Kathy Wilner
(First Name & Last Name)**Date Recorded**9/23/2010
(mm/dd/year)

Instructions to complete a digital version of this form: (1) Download a copy to your hard drive; (2) Open the saved blank copy; (3) Fill out the form; (4) Use the Save As command to rename the form appropriately and save; (5) *Print* and submit to SHSND.

**NDCRS ARCHITECTURAL SITE FORM
PAGE 4—SITE DESCRIPTION**

Field Code

Myron Thon School

SITS# 32

WE

Complete one Page 4 for the entire site.

2. Owner's Contact Information:

Myron Thon
804 Birch Ave
Harvey ND 58341

3. Access (to rural areas):

Highway 3 north of Hurdsfield to 16th St NE or Old Highway 52. Turn right and go east 2 miles. Turn right again and go about ½ mile south. You will see the school on a farm site to your right.

4. Site Area (ft²):

5. Site Description:

The school sits on a farm site with trees to the north. Some trees around the farm yard and there are two old house on the site. To the west are several grain bins and to the east is a farm field.

Recorded By Kathy Wilner
(First Name & Last Name)

Date Recorded9/23/2010
(mm/dd/year)

Instructions to complete a digital version of this form: (1) Download a copy to your hard drive; (2) Open the saved blank copy; (3) Fill out the form; (4) Use the Save As command to rename the form appropriately and save; (5) *Print* and submit to SHSND.

**NDCRS ARCHITECTURAL SITE FORM
PAGE 5—SITE DESCRIPTION**

Field Code

Myron Thon School

SITS# 32 WE

6. Summary of ALL Site Features & Evaluation of Significance:

7. References/Comments:

Recorder contact information:

Kathy Wilner
366 43rd Ave SE
Bowdon ND 58418

Recorded By Kathy Wilner
(First Name & Last Name)

Date Recorded

9/23/2010
(mm/dd/year)

Instructions to complete a digital version of this form: (1) Download a copy to your hard drive; (2) Open the saved blank copy; (3) Fill out the form; (4) Use the Save As command to rename the form appropriately and save; (5) Print and submit to SHSND.

Microsoft Research Maps

Search MSR Maps

Home | Advanced Find | Famous Places | Web Services | About | Bing Maps

Street
1580 31st Ave NE
City
Harvey
State
ND

The National Map

1580 31st Ave NE, Harvey, ND 58341-9368
13 km SW of Manfred, North Dakota, United States 7/17/2001

Download | E-mail | Info | Print | Order Map | Bing Maps

Longitude Latitude
-99.88378 47.64103

16th ST NE ← (60)

Section 18
Ruoland Township

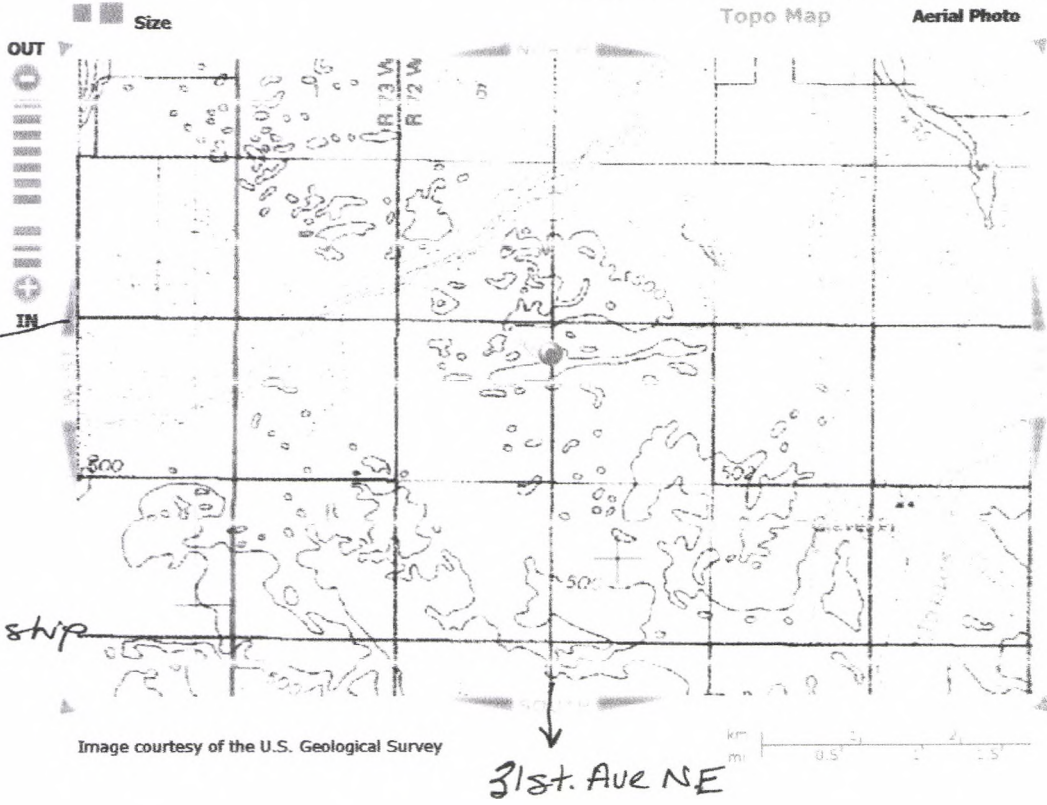

Source=243325 Running Time 0.00 ms

© 2010 Microsoft Corporation. Terms of Use | Privacy Statement | Sponsored By USGS Microsoft Research Bing
Server=TK2TERRAWE22



1 – Myron Thon School West side 9/22/2010 Kathy Wilner WE

2 – Myron Thon School South side 9/22/2010 Kathy Wilner WE





3 – Myron Thon School North side 9/22/2010 Kathy Wilner WE

4 – Myron Thon School East side 9/22/2010 Kathy Wilner WE

