

NDCRS ARCHITECTURAL SITE FORM PAGE 1

SITS# 32 WE 225

SITE IDENTIFICATION

Field Code Wiley School

Site Name Wiley School
Site Name _____

Map Quad Dover
Map Quad _____

LTL	TWP	<u>145</u>	R	<u>68</u>	SEC	<u>1</u>	QQQ	<u>7</u>	QQ	<u>8</u>	Q	<u>8</u>
LTL	TWP	_____	R	_____	SEC	_____	QQQ	_____	QQ	_____	Q	_____
LTL	TWP	_____	R	_____	SEC	_____	QQQ	_____	QQ	_____	Q	_____
LTL	TWP	_____	R	_____	SEC	_____	QQQ	_____	QQ	_____	Q	_____

UTM _____ N ZONE _____
 UTM _____ E NAD 1927 _____ NAD 1983 _____

Subsection:
1 = N½
2 = E½
3 = S½
4 = W½
5 = NE¼
6 = SE¼
7 = SW¼
8 = NW¼

City: Carrington ND

Street Number: _____

Street Name: corner of Main St. and 59th Ave. SE

Urban Legal Description: _____

SITE DATA

Total # *Architectural* Features: 1

Fieldwork Date: 9/10/2012

Reconnaissance Survey Intensive Survey

Project Title & Supervisor:
Country Schoolhouse Project

Report Title & Author(s):

Additional Information: _____

SHSND USE

Area of Significance 2 Ecozone 18 Verified Site _____ CR Type 2
 Area of Significance _____ Ecozone _____ Non-Site _____
 Area of Significance _____

Recorded By Kathy Wilner Date Recorded 9/11/2012
 (First Name & Last Name) (mm/dd/year)

Instructions to complete a digital version of this form: (1) Download a copy to your hard drive; (2) Open the saved blank copy; (3) Fill out the form; (4) Use the Save As command to rename the form appropriately and save; (5) *Print* and submit to SHSND.

**NDCRS ARCHITECTURAL SITE FORM
PAGE 2—Feature Data**

Field Code Willey School

SITS# 32 WE

Complete one Page 2 for each architectural feature at the site.

Architectural Feature # 1

Construction Date _____	Feature Type <u>9</u>	Condition <u>4</u>
Feature Date <u>2</u>	Context <u>7</u>	Plan Shape <u>5</u>
Structural System <u>25</u>	Primary Exterior <u>26</u>	Style <u>Other Style</u>
Original Owner's Ethnicity _____	Secondary Exterior _____	Architect/Builder _____

Other Information:

Foundation Poured Concrete footings Stories 1

Roof/Cornice Hip

Window All covered and most of the glass is gone

Dating Method(s): county history and school records estimate by K. Wilner

Feature Preservation Recommendation(s) (Check all that apply):

- Individual nomination
- Contributes to a potential district
- No nomination potential
- Will not contribute to a district
- Potential district—feature would be a contributing element if other properties constitute a district
- Thematic nomination potential
- Component of a historic site or landscape
- Moved (specify all applicable choices)—a) relocation occurred within a historic period; b) recreates original site, orientation, landscape, & spatial relationships; c) compatible in context with neighboring structures; d) relocation has damaged eligibility
- Historical associations require further investigation

Recorded By Kathy Wilner Date Recorded 9/11/2012
(First Name & Last Name) (mm/dd/year)

Instructions to complete a digital version of this form: (1) Download a copy to your hard drive; (2) Open the saved blank copy; (3) Fill out the form; (4) Use the Save As command to rename the form appropriately and save; (5) Print and submit to SHSND.

**NDCRS ARCHITECTURAL SITE FORM
PAGE 3—Feature Data**Field Code Willey SchoolSITS# 32 WE**Complete a Page 3 for each feature.****1. Feature Description, Integrity, Eligibility:**

A one-room prairie school built on the same plan as many in this area. Larger schools with a hip roof and small dormer on the roof at the entry end of the school. The roofing material of this school is asphalt shingle over shakes. Some of the angles of the roof have metal cap trim while other ridges are covered with metal ridge caps. The also installed eaves troughs on this building. The siding is 6 inch lap with 8 inche trimboards under the eaves and 6 inch corner trim boards. The west end has a garage door, most likely replacing the entry door. There is a concrete pad just outside the door. The inside of the school has been totally stripped to the outside walls. All I can see are stud walls, no evidence of what it might have looked like inside. This building measures 34 feet from east to west and 24 feet north to south. The school was moved onto the farm site and no one knows where it came from.

Recorded By Kathy Wilner Date Recorded 9/11/2012
(First Name & Last Name) (mm/dd/year)

Instructions to complete a digital version of this form: (1) Download a copy to your hard drive; (2) Open the saved blank copy; (3) Fill out the form; (4) Use the Save As command to rename the form appropriately and save; (5) Print and submit to SHSND.

**NDCRS ARCHITECTURAL SITE FORM
PAGE 4—SITE DESCRIPTION**

Field Code Willey School

SITS# 32 WE

Complete one Page 4 for the entire site.

2. Owner's Contact Information:

Cindy Willey
1119 Hwy. 30
Cathay ND 58422

3. Access (to rural areas):

Highway 200, west of Carrington ND, to 59th Ave NE. Turn to the left, south, and drive three miles. The school is on a farm site on the left just past the section line.

4. Site Area (ft²): _____

5. Description of **SETTING**:

The school sits in an abandoned farm site. The house has been moved off the farm. There are trees to the west and farm fields to the north, east and south.

Recorded By Kathy Wilner Date Recorded 9/11/2012
(First Name & Last Name) (mm/dd/year)

Instructions to complete a digital version of this form: (1) Download a copy to your hard drive; (2) Open the saved blank copy; (3) Fill out the form; (4) Use the Save As command to rename the form appropriately and save; (5) *Print* and submit to SHSND.

**NDCRS ARCHITECTURAL SITE FORM
PAGE 5—SITE DESCRIPTION**

Field Code Willey School

SITS# 32 WE

6. Summary of ALL Site Features & Evaluation of Significance:

7. References/Comments:

Kathy Wilner
366 43rd Ave SE
Bowdon ND 58418

Recorded By Kathy Wilner Date Recorded 9/11/2012
(First Name & Last Name) (mm/dd/year)

Instructions to complete a digital version of this form: (1) Download a copy to your hard drive; (2) Open the saved blank copy; (3) Fill out the form; (4) Use the Save As command to rename the form appropriately and save; (5) Print and submit to SHSND.



North Side

Willey School

9/10/2012

Kathy Wilner

WE

East Side





West Side

Willey School

9/10/2012

Kathy Wilner

WE

South Side



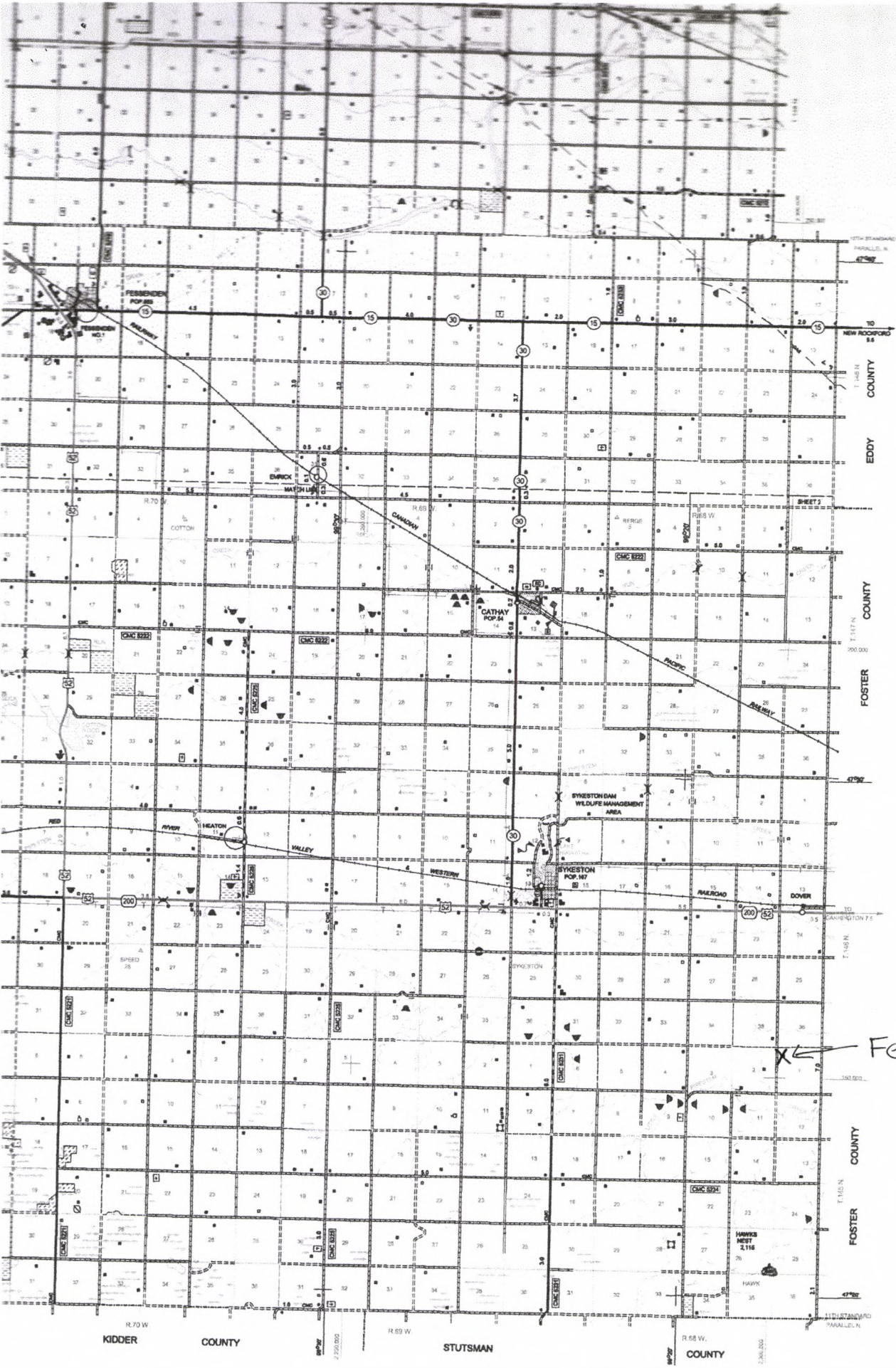

- ROADS AND ROADWAY FEATURES**
- BELOW USED TRAILS
 - PRIMITIVE ROAD
 - UNIMPROVED ROAD
 - GRAVEL AND DRAINED ROAD
 - GRAVEL, GRAVEL AND DRAINED ROAD
 - BITUMINOUS ROAD - LOW TYPE
 - BITUMINOUS ROAD - HIGH TYPE
 - DIVIDED HIGHWAY
 - STREETS IN UNINCORPORATED TOWNS
 - COUNTY MAJOR COLLECTOR ROUTE NUMBER
 - POINTS BETWEEN WHICH DISTANCES ARE MEASURED
 - INTERSTATE NUMBERED HIGHWAY
 - U.S. NUMBERED HIGHWAY
 - STATE HIGHWAY SYSTEM
- STRUCTURES**
- HIGHWAY BRIDGE, GENERAL
 - MINOR DRAINAGE STRUCTURE
 - CONCRETE FORD OR DIP
 - FORD - ROAD ESTABLISHED
- RAILROADS**
- RAILROAD (ANY NUMBER OF TRACKS USED BY A SINGLE OPERATING CO.)
 - RAILROAD STATION
 - RAILROAD ABOVE
 - RAILROAD BELOW
 - RAILROAD BRIDGE
- BOUNDARIES**
- COUNTY LINE
 - TOWNSHIP LINE
 - CORPORATE LINE
 - SECTION LINE
 - MATCH LINE BETWEEN ADJOINING SHEETS OF SAME COUNTY
 - BOUNDARY TO MARK ENLARGEMENT INSET
 - NATIONAL PARKS, REFUGES, AND OTHER RESERVATIONS
 - MONUMENT - SMALL, HISTORIC SITE
 - WILDLIFE MANAGEMENT AREA
 - WATERFOWL PRODUCTION AREA
 - STATE SCHOOL LAND
- DRAINAGE**
- INTERMITTENT STREAM (NARROW)
 - NARROW STREAM
 - WIDE STREAM
 - WIDE STREAM WITH DAM
 - LAKE, RESERVOIR, OR POND WITH DAM
 - MARKS OR SWAMP LAND
 - DRAINAGE DITCH
 - CANAL
- NAVIGATION**
- DOCK, PIER, OR LANDING
- CITY AND VILLAGE CENTERS**
- COUNTY SEAT
 - OTHER CITIES AND VILLAGES
 - INCORPORATED CITY OR VILLAGE (GENERALIZED)
- AIRPORTS**
- AIRFIELD, LIMITED FACILITIES
 - LANDING AREA OR STRIP
 - AIRPORT, GENERAL

X ← Feature

Willey School

9/10/2012

Kathy Wilner WE