

# NDCRS ARCHITECTURAL SITE FORM

## PAGE 1

SITS# 32 WE 231

### SITE IDENTIFICATION

Field Code Whitby School #3

Site Name Whitby School #3  
Site Name \_\_\_\_\_

Map Quad Manfred SE  
Map Quad \_\_\_\_\_

LTL	TWP	<u>147</u>	R	<u>72</u>	SEC	<u>22</u>	QQQ	<u>7</u>	QQ	<u>5</u>	Q	<u>6</u>
LTL	TWP	_____	R	_____	SEC	_____	QQQ	_____	QQ	_____	Q	_____
LTL	TWP	_____	R	_____	SEC	_____	QQQ	_____	QQ	_____	Q	_____
LTL	TWP	_____	R	_____	SEC	_____	QQQ	_____	QQ	_____	Q	_____

UTM \_\_\_\_\_ N ZONE \_\_\_\_\_  
UTM \_\_\_\_\_ E NAD 1927 \_\_\_\_\_ NAD 1983 \_\_\_\_\_

Subsection:
1 = N½
2 = E½
3 = S½
4 = W½
5 = NE¼
6 = SE¼
7 = SW¼
8 = NW¼

City: Chaseley ND

Street Number: 835

Street Name: 34th Ave NE

Urban Legal Description: \_\_\_\_\_

### SITE DATA

Total # **Architectural** Features: 1

Fieldwork Date: 9/6/2012

Reconnaissance Survey  Intensive Survey

Project Title & Supervisor:  
Country Schoolhouse Project

Report Title & Author(s): \_\_\_\_\_

Additional Information: \_\_\_\_\_

### SHSND USE

Area of Significance <u>2</u>	Ecozone <u>18</u>	Verified Site _____	CR Type <u>2</u>
Area of Significance _____	Ecozone _____	Non-Site _____	
Area of Significance _____			

Recorded By Kathy Wilner Date Recorded 9/9/2012  
(First Name & Last Name) (mm/dd/year)

Instructions to complete a digital version of this form: (1) Download a copy to your hard drive; (2) Open the saved blank copy; (3) Fill out the form; (4) Use the Save As command to rename the form appropriately and save; (5) Print and submit to SHSND.

**NDCRS ARCHITECTURAL SITE FORM**  
**PAGE 2—Feature Data**

Field Code Whitby School #3SITS# 32 WE

**Complete one Page 2 for each architectural feature at the site.**

Architectural Feature # 1

Construction Date \_\_\_\_\_

Feature Type 9Condition 6Feature Date 2Context 7Plan Shape 5Structural System 25Primary Exterior 26Style Other Style

Original Owner's Ethnicity \_\_\_\_\_

Secondary Exterior \_\_\_\_\_

Architect/Builder \_\_\_\_\_

Other Information:

Foundation railroad ties Stories 1Roof/Cornice gableWindow double hung, all coveredDating Method(s): county history and school records

**Feature Preservation Recommendation(s) (Check all that apply):**

 Individual nomination Contributes to a potential district No nomination potential Will not contribute to a district Potential district—feature would be a contributing element if other properties constitute a district Thematic nomination potential Component of a historic site or landscape

Moved (specify all applicable choices)—a) relocation occurred within a historic period; b) recreates original site, orientation, landscape, & spatial relationships; c) compatible in context with neighboring structures; d) relocation has damaged eligibility

 Historical associations require further investigation

Recorded By Kathy Wilner Date Recorded 9/9/2012  
(First Name & Last Name) (mm/dd/year)

*Instructions to complete a digital version of this form:* (1) Download a copy to your hard drive; (2) Open the saved blank copy; (3) Fill out the form; (4) Use the Save As command to rename the form appropriately and save; (5) Print and submit to SHSND.

**NDCRS ARCHITECTURAL SITE FORM  
PAGE 3—Feature Data**Field Code Whitby School #3SITS# 32 WE**Complete a Page 3 for each feature.****1. Feature Description, Integrity, Eligibility:**

A one room school that was moved to this location about 8 years ago. Shakes cover the roof with plans by the owner to put metal on it one day. At this point few of the shakes are missing. The chimney is no longer there, torn down at the time of the move. The double hung windows on the south side still have glass in them but are covered on the inside by insulation. The south end of the building has a small, metal addition on it. As you step through the door in the addition you can see the lines of the porch that used to be on the school. The lap siding is gone on that wall showing horizontal wood planks. Outside the building the siding is 6 inch lap wood siding on the south, west and north sides with 4 inch wood trim boards at the corners. On the north side there is another window with a shutter covering it from the outside. Inside the school the original tongue and groove wood floor is still there as well as the stage at the north end of the building. More tongue and groove flooring there. Just to the right, on the east wall, there are still some coat hooks and a shelf above the hooks. It has electricity today and was wired when it was moved to the present location. The school measures 24 feet east to west and 18 feet north to south.

Recorded By Kathy Wilner Date Recorded 9/9/2012  
(First Name & Last Name) (mm/dd/year)

*Instructions to complete a digital version of this form: (1) Download a copy to your hard drive; (2) Open the saved blank copy; (3) Fill out the form; (4) Use the Save As command to rename the form appropriately and save; (5) Print and submit to SHSND.*

**NDCRS ARCHITECTURAL SITE FORM  
PAGE 4—SITE DESCRIPTION**

Field Code Whitby School #3

SITS# 32 WE

**Complete one Page 4 for the entire site.**

2. Owner's Contact Information:

Henry Heintz  
835 34th Ave NE  
Chaseley ND 58423

3. Access (to rural areas):

At Highway 200 go north on 34th Ave NE 6 1/2 miles. The farm will be on the left (west) side of the road.

4. Site Area (ft<sup>2</sup>): \_\_\_\_\_

5. Description of **SETTING**:

The school sits in a farm yard with the house to the northeast, large she and a tree line to the south, yard and farmland to the west and animal inclosures and pasture to the east.

Recorded By Kathy Wilner Date Recorded 9/9/2012  
(First Name & Last Name) (mm/dd/year)

*Instructions to complete a digital version of this form: (1) Download a copy to your hard drive; (2) Open the saved blank copy; (3) Fill out the form; (4) Use the Save As command to rename the form appropriately and save; (5) Print and submit to SHSND.*

**NDCRS ARCHITECTURAL SITE FORM  
PAGE 5—SITE DESCRIPTION**

Field Code Whitby School #3

SITS# 32 WE

**6. Summary of ALL Site Features & Evaluation of Significance:**

**7. References/Comments:**

Kathy Wilner  
366 43rd Ave SE  
Bowdon ND 58418

Recorded By Kathy Wilner Date Recorded 9/9/2012  
(First Name & Last Name) (mm/dd/year)

*Instructions to complete a digital version of this form:* (1) Download a copy to your hard drive; (2) Open the saved blank copy; (3) Fill out the form; (4) Use the Save As command to rename the form appropriately and save; (5) *Print* and submit to SHSND.



South Side

Whitby School #3

9/6/2012

Kathy Wilner WE

East Side





Whitby  
School #3

Both are  
North side

9/6/2012

Kathy  
Wilner

WE



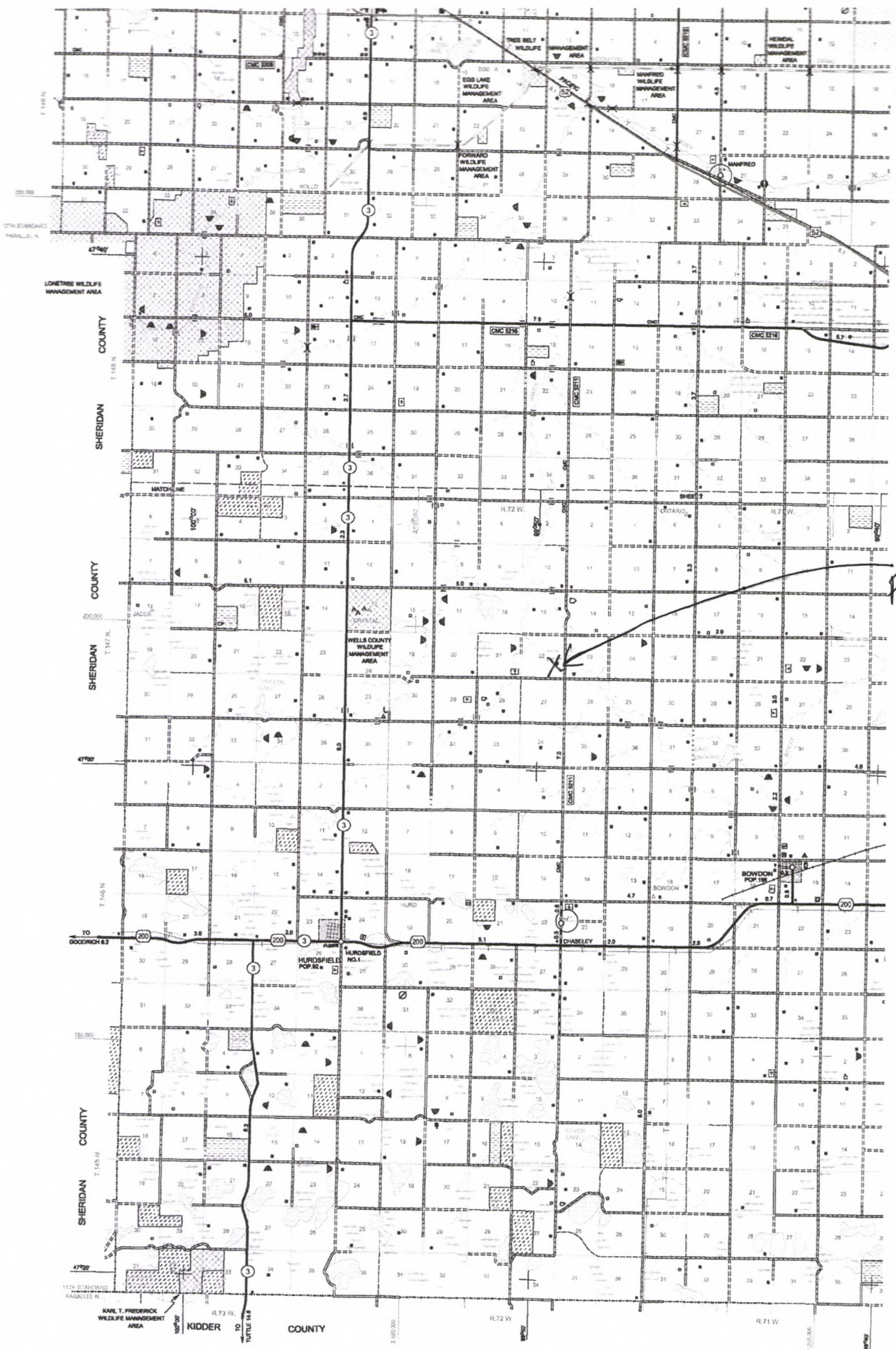

Feature



Whitby School #3

9/6/2012

Kathy Wilner WE



NDCRS ARCHITECTURAL SITE FORM
PAGE 2—Feature Data

UPDATE

Field Code \_\_\_\_\_ SITS# 32 WE 9

Complete one Page 2 for each architectural feature at the site.

Architectural Feature # 1-2

Construction Date \_\_\_\_\_ Feature Type \_\_\_\_\_ Condition 1
Feature Date \_\_\_\_\_ Context \_\_\_\_\_ Plan Shape \_\_\_\_\_
Structural System \_\_\_\_\_ Primary Exterior \_\_\_\_\_ Style \_\_\_\_\_
Original Owner's Ethnicity \_\_\_\_\_ Secondary Exterior \_\_\_\_\_ Architect/Builder \_\_\_\_\_

Other Information:

Informed by Kathy Wilner the school was gone, verified that with 2009 aerial.

She found in 2012 it had been moved to 147-72 Sec 22 and it is now recorded as 32WE231

Foundation \_\_\_\_\_ Stories \_\_\_\_\_

Window \_\_\_\_\_

Roof/Cornice \_\_\_\_\_

Dating Method(s): \_\_\_\_\_

Feature Preservation Recommendation(s) (Check all that apply):

- Individual nomination
Contributes to a potential district
No nomination potential
Will not contribute to a district
Potential district—feature would be a contributing element if other properties constitute a district
Thematic nomination potential
Component of a historic site or landscape
Moved (specify all applicable choices)—a) relocation occurred within a historic period; b) recreates original site, orientation, landscape, & spatial relationships; c) compatible in context with neighboring structures; d) relocation has damaged eligibility
Historical associations require further investigation

Recorded By Lorna Meidinger Date Recorded 9/15/2010
(First Name & Last Name) (mm/dd/year)

Instructions to complete a digital version of this form: (1) Download a copy to your hard drive; (2) Open the saved blank copy; (3) Fill out the form; (4) Use the Save As command to rename the form appropriately and save; (5) Print and submit to SHSND.