

NDCRS ARCHITECTURAL SITE FORM PAGE 1

SITS# 32 WE 232

SITE IDENTIFICATION

Field Code Eddy School #1, Entry/Porch

Site Name Eddy School #1
Site Name _____

Map Quad Manfred SE, ND
Map Quad _____

LTL	TWP	<u>147</u>	R	<u>72</u>	SEC	<u>14</u>	QQQ	<u>8</u>	QQ	<u>8</u>	Q	<u>8</u>
LTL	TWP	_____	R	_____	SEC	_____	QQQ	_____	QQ	_____	Q	_____
LTL	TWP	_____	R	_____	SEC	_____	QQQ	_____	QQ	_____	Q	_____
LTL	TWP	_____	R	_____	SEC	_____	QQQ	_____	QQ	_____	Q	_____

UTM	_____	N	ZONE	_____
UTM	_____	E	NAD 1927	_____ NAD 1983 _____

Subsection:
1 = N½
2 = E½
3 = S½
4 = W½
5 = NE¼
6 = SE¼
7 = SW¼
8 = NW¼

City: Chaseley ND

Street Number: 851

Street Name: 34th Ave NE

Urban Legal Description: _____

SITE DATA

Total # *Architectural* Features: 1

Fieldwork Date: 5/18/2010

Reconnaissance Survey Intensive Survey

Project Title & Supervisor:
Country Schoolhouse Project

Report Title & Author(s): _____

Additional Information: _____

SHSND USE

Area of Significance	<u>2</u>	Ecozone	<u>18</u>	Verified Site	_____	CR Type	<u>2</u>
Area of Significance	_____	Ecozone	_____	Non-Site	_____		
Area of Significance	_____						

Recorded By Kathy Wilner Date Recorded 9/8/2012
(First Name & Last Name) (mm/dd/year)

Instructions to complete a digital version of this form: (1) Download a copy to your hard drive; (2) Open the saved blank copy; (3) Fill out the form; (4) Use the Save As command to rename the form appropriately and save; (5) *Print* and submit to SHSND.

NDCRS ARCHITECTURAL SITE FORM
PAGE 2—Feature Data

Field Code Eddy School #1, Entry/Porch

SITS# 32 WE

Complete one Page 2 for each architectural feature at the site.

Architectural Feature # 1

Construction Date Feature Type 9 Condition 5
Feature Date 2 Context 7 Plan Shape 5
Structural System 25 Primary Exterior 26 Style Other Style
Original Owner's Ethnicity Secondary Exterior Architect/Builder

Other Information:

Foundation perhaps poured concrete Stories 1
Roof/Cornice Gable
Window replaced with newer double hung
Dating Method(s): county history and school records

Feature Preservation Recommendation(s) (Check all that apply):

- Individual nomination
Contributes to a potential district
No nomination potential
Will not contribute to a district
Potential district—feature would be a contributing element if other properties constitute a district
Thematic nomination potential
Component of a historic site or landscape
Moved (specify all applicable choices)—a) relocation occurred within a historic period; b) recreates original site, orientation, landscape, & spatial relationships; c) compatible in context with neighboring structures; d) relocation has damaged eligibility
Historical associations require further investigation

Recorded By Kathy Wilner Date Recorded 9/8/2012
(First Name & Last Name) (mm/dd/year)

Instructions to complete a digital version of this form: (1) Download a copy to your hard drive; (2) Open the saved blank copy; (3) Fill out the form; (4) Use the Save As command to rename the form appropriately and save; (5) Print and submit to SHSND.

**NDCRS ARCHITECTURAL SITE FORM
PAGE 3—Feature Data**Field Code Eddy School #1, Entry/PorchSITS# 32 WE**Complete a Page 3 for each feature.****1. Feature Description, Integrity, Eligibility:**

This building is the entry/porch that was left in the original location of the entire school to be used as a township meeting place. The building has asphalt shingles on the roof and 6 inch wood, lap siding with 4 inch corner trim boards. It has relatively good paint. They have electricity in the building evidenced by wires going to the school. I did not go inside this building. The school was built in the 1880's and closed in 1959.

Recorded By Kathy Wilner Date Recorded 9/8/2012
(First Name & Last Name) (mm/dd/year)

Instructions to complete a digital version of this form: (1) Download a copy to your hard drive; (2) Open the saved blank copy; (3) Fill out the form; (4) Use the Save As command to rename the form appropriately and save; (5) *Print* and submit to SHSND.

**NDCRS ARCHITECTURAL SITE FORM
PAGE 4—SITE DESCRIPTION**

Field Code Eddy School #1, Entry/Porch

SITS# 32 WE

Complete one Page 4 for the entire site.

2. Owner's Contact Information:

Steven Flick
998 34th Ave NE
Chaseley ND 58413

3. Access (to rural areas):

From Highway 200 drive north on 34th Ave NE 8 miles and you will see the small building on the right at the corner of 34th Ave NE and 10th St NE.

4. Site Area (ft²): _____

5. Description of **SETTING**:

This small part of the school is backed on the east by many bins and other storage units. A shop is south of the school with farm fields to the west and north. Just northwest is a large farm site.

Recorded By Kathy Wilner Date Recorded 9/8/2012
(First Name & Last Name) (mm/dd/year)

Instructions to complete a digital version of this form: (1) Download a copy to your hard drive; (2) Open the saved blank copy; (3) Fill out the form; (4) Use the Save As command to rename the form appropriately and save; (5) Print and submit to SHSND.

**NDCRS ARCHITECTURAL SITE FORM
PAGE 5—SITE DESCRIPTION**

Field Code Eddy School #1, Entry/Porch

SITS# 32 WE

6. Summary of ALL Site Features & Evaluation of Significance:

7. References/Comments:

Kathy Wilner
366 43rd Ave SE
Bowdon ND 58418

Recorded By Kathy Wilner Date Recorded 9/8/2012
(First Name & Last Name) (mm/dd/year)

Instructions to complete a digital version of this form: (1) Download a copy to your hard drive; (2) Open the saved blank copy; (3) Fill out the form; (4) Use the Save As command to rename the form appropriately and save; (5) Print and submit to SHSND.

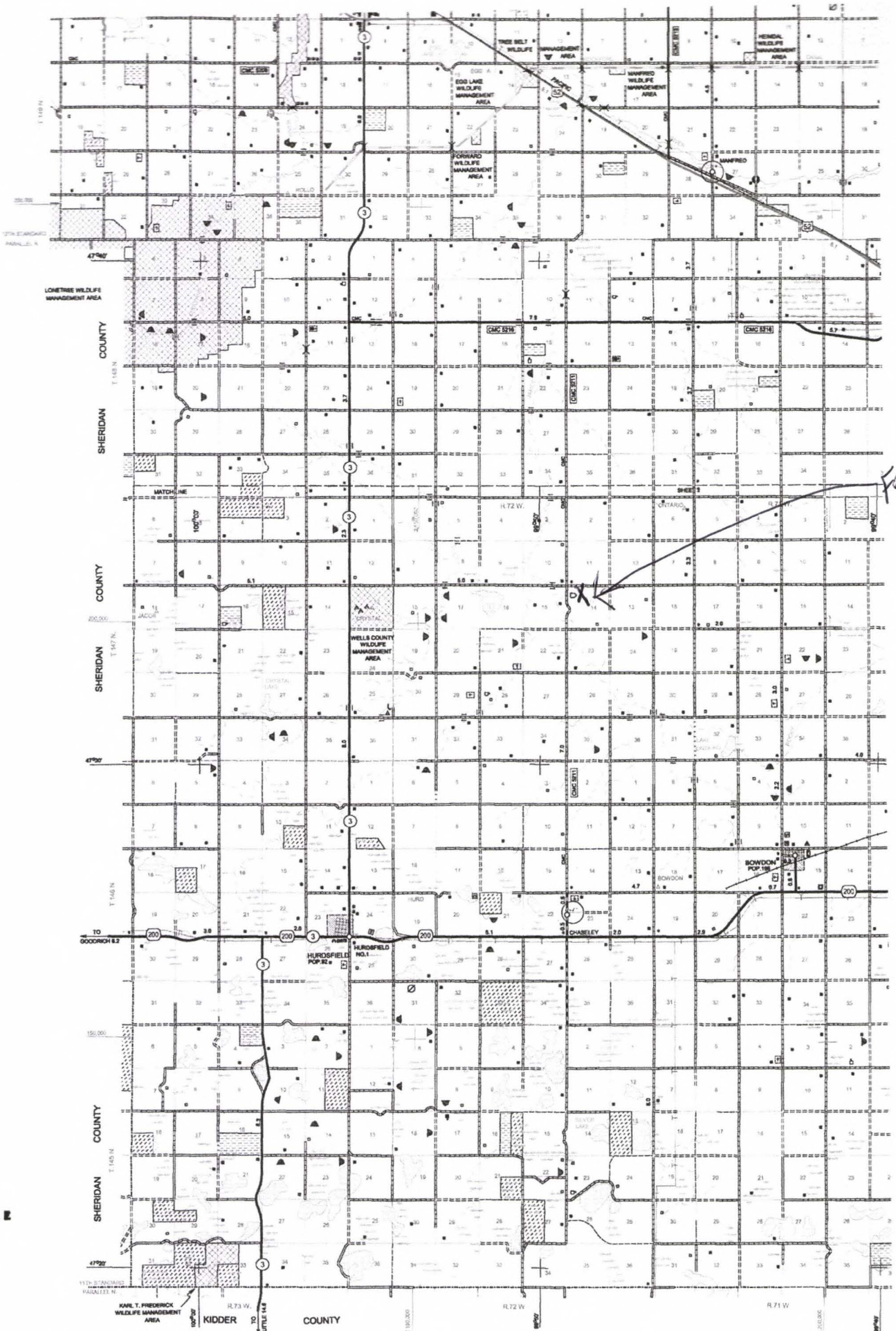

Eddy School #1, Entry/Porch

5/18/2010

Kathy Wilner WE



West Side

Eddy School #1 - Porch 5/18/2010

South Side





Eddy School #1 – Porch East and North Sides 5/18/2010 Kathy Wilner WE

The north side has the door.