

NDCRS ARCHITECTURAL SITE FORM PAGE 1

SITS# 32 WI 2186

SITE IDENTIFICATION

Field Code New Home Township School Site Name _____

Map Quad Tom Berg Lake Site Name _____
Map Quad _____

LTL	TWP	<u>158</u>	R	<u>97</u>	SEC	<u>8</u>	QQQ	<u>8</u>	QQ	<u>8</u>	Q	<u>5</u>
LTL	TWP	_____	R	_____	SEC	_____	QQQ	_____	QQ	_____	Q	_____
LTL	TWP	_____	R	_____	SEC	_____	QQQ	_____	QQ	_____	Q	_____
LTL	TWP	_____	R	_____	SEC	_____	QQQ	_____	QQ	_____	Q	_____

UTM _____ N ZONE _____
UTM _____ E NAD 1927 _____ NAD 1983 _____

City: _____

Street Number: _____

Street Name: 77th St NW

Urban Legal Description: _____

Subsection:
1 = N $\frac{1}{2}$
2 = E $\frac{1}{2}$
3 = S $\frac{1}{2}$
4 = W $\frac{1}{2}$
5 = NE $\frac{1}{4}$
6 = SE $\frac{1}{4}$
7 = SW $\frac{1}{4}$
8 = NW $\frac{1}{4}$

SITE DATA

Total # **Architectural** Features: 1

Fieldwork Date: 8/22/2016

Reconnaissance Survey Intensive Survey _____

Project Title & Supervisor:

Country Schoolhouse Project

Report Title & Author(s):

Additional Information: _____

SHSND USE

Area of Significance <u>2</u>	Ecozone <u>21</u>	Verified Site <u>1</u>	CR Type <u>2</u>
Area of Significance _____	Ecozone _____	Non-Site _____	
Area of Significance _____			

Recorded By Kathy Wilner Date Recorded 2/4/2017
(First Name & Last Name) (mm/dd/year)

Instructions to complete a digital version of this form: (1) Download a copy to your hard drive; (2) Open the saved blank copy; (3) Fill out the form; (4) Use the Save As command to rename the form appropriately and save; (5) Print and submit to SHSND.

NDCRS ARCHITECTURAL SITE FORM
PAGE 2—Feature Data

Field Code New Home Township SchoolSITS# 32 WI**Complete one Page 2 for each architectural feature at the site.****Architectural Feature #** 1

Construction Date _____

Feature Type 9Condition 5Feature Date 3Context 7Plan Shape 3Structural System 25Primary Exterior 26Style Other Style

Original Owner's Ethnicity _____

Secondary Exterior _____

Architect/Builder _____

Other Information:

Foundation Poured concrete basement Stories 1Roof/Cornice Intersecting Gable with salt box lineWindow Glass block, some coveredDating Method(s): Estimate**Feature Preservation Recommendation(s) (Check all that apply):** Individual nomination Contributes to a potential district No nomination potential Will not contribute to a district Potential district—feature would be a contributing element if other properties constitute a district Thematic nomination potential Component of a historic site or landscape

Moved (specify all applicable choices)—a) relocation occurred within a historic period; b) recreates original site, orientation, landscape, & spatial relationships; c) compatible in context with neighboring structures; d) relocation has damaged eligibility

 Historical associations require further investigation

Recorded By Kathy Wilner Date Recorded 2/4/2017
(First Name & Last Name) (mm/dd/year)

Instructions to complete a digital version of this form: (1) Download a copy to your hard drive; (2) Open the saved blank copy; (3) Fill out the form; (4) Use the Save As command to rename the form appropriately and save; (5) Print and submit to SHSND.

**NDCRS ARCHITECTURAL SITE FORM
PAGE 3—Feature Data**Field Code New Home Township SchoolSITS# 32 WI**Complete a Page 3 for each feature.****1. Feature Description, Integrity, Eligibility:**

The feature is a one room prairie school on a poured concrete foundation. The intersecting gable roofs and the salt line extension on the entry are covered with wood shakes. Several bricks from the chimney lay in the alley on the west side. The stub of the chimney is at the west end of the school room peak. There are also wood shakes on the pyramidal roof of the bell tower, located on the peak of the entry. The base of the tower sweeps down the east and west slopes of the entry roof and supports four corner post to hold up the pyramidal roof. That tower roof extends out from the corner support in a skirting manner. There is no bell. The soffits are closed. The building measures 20 feet east to west and 28 feet north to south with the entry measuring 20 feet east to west and 8 feet north to south.

There is a wide trim board under the soffits at all the peak ends. The remainder of the siding is 6 inch wood lap with 6 inch wood corner trim. There are attic vents at both the west and east ends. There are two glass block windows on the west wall of the school room and another on the west end of the entry. There is a small window on both the south and east side of the addition for where the toilets are located. Two large vented glass block windows on the north side are covered from the outside. Many of the glass blocks have been broken. There are broken venetian blinds on the school room windows. Concrete steps, with pipe railings, lead to a concrete stoop where a broken 5 panel wood door gives entry to the school. There is a transom above the door and still higher on the south wall is a round window opening without glass. The toilets are to the right as you walk into the entry and the school room door is to the left. The walls in the school are lathe and plaster, the floor is tongue and groove hardwood and the ceiling is covered with wallboard panels. Light fixtures suggest electricity. There are blackboards on the east wall cornering around to the south wall.

Recorded By Kathy Wilner Date Recorded 2/4/2017
(First Name & Last Name) (mm/dd/year)

Instructions to complete a digital version of this form: (1) Download a copy to your hard drive; (2) Open the saved blank copy; (3) Fill out the form; (4) Use the Save As command to rename the form appropriately and save; (5) Print and submit to SHSND.

**NDCRS ARCHITECTURAL SITE FORM
PAGE 4—SITE DESCRIPTION**

Field Code New Home Township School

SITS# 32 WI

Complete one Page 4 for the entire site.

2. Owner's Contact Information:

Jean Leone Halverson
1705 3rd Ave W Apt 102
Williston ND 58801

3. Access (to rural areas):

From Wildrose, south on County Road 17 3 miles to cross Highway 50 and continue south 3 more miles to 77th St NW, turn right and go west 1 1/2 miles to see the school on your left.

4. Site Area (ft²): _____

5. Description of **SETTING**:

There is a large slough to the west and farm fields all directions.

Recorded By Kathy Wilner Date Recorded 2/4/2017
(First Name & Last Name) (mm/dd/year)

Instructions to complete a digital version of this form: (1) Download a copy to your hard drive; (2) Open the saved blank copy; (3) Fill out the form; (4) Use the Save As command to rename the form appropriately and save; (5) Print and submit to SHSND.

**NDCRS ARCHITECTURAL SITE FORM
PAGE 5—SITE DESCRIPTION**

Field Code New Home Township School

SITS# 32 WI

6. Summary of ALL Site Features & Evaluation of Significance:

7. References/Comments:

Kathy Wilner
366 43rd Ave SE
Bowdon ND 58418

Recorded By Kathy Wilner Date Recorded 2/4/2017
(First Name & Last Name) (mm/dd/year)

Instructions to complete a digital version of this form: (1) Download a copy to your hard drive; (2) Open the saved blank copy; (3) Fill out the form; (4) Use the Save As command to rename the form appropriately and save; (5) Print and submit to SHSND.



South Side

New Home Township School

8/22/2016

Kathy Wilner

WI

East Side





West Side

New Home Township School

8/22/2016

Kathy Wilner

WI

North Side





Notes

New Home Township School

8/22/2016

Kathy Wilner

WI

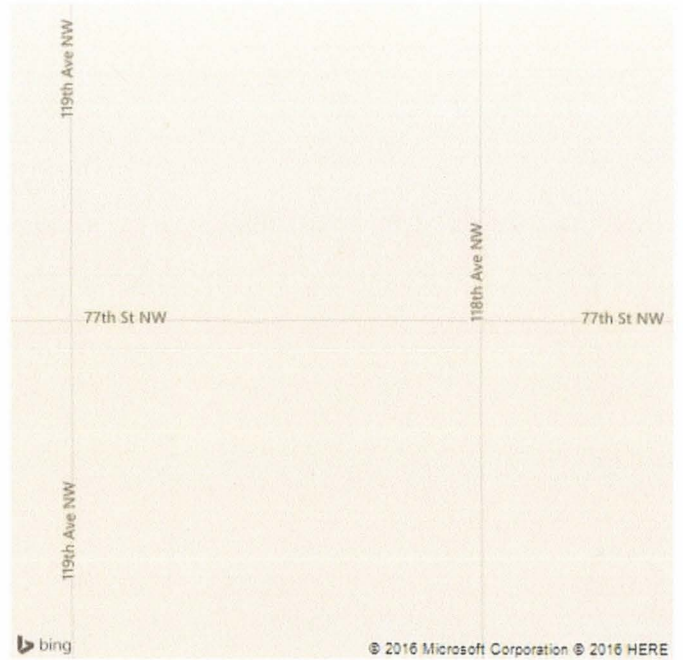

Feature

